

## Product Datasheet

### MRS5005

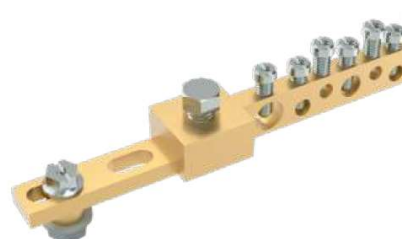
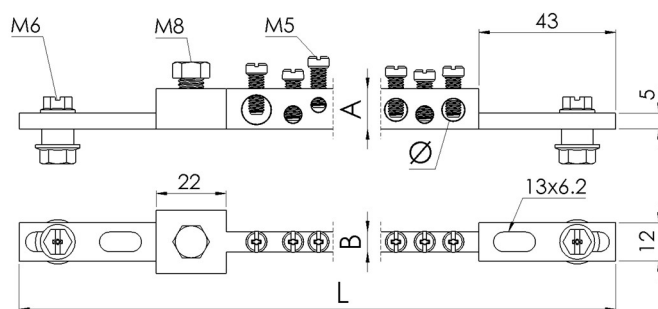

#### Main

Family	Earthing and Neutral Terminals
Version	Earthing terminals with connections for housing
Code	MRS5005
Reference	MRS 13-6-56
Number per package	1
Weight (kg)	0.330
L (mm)	462
A (mm)	13
B (mm)	6
Rated current (A)	80

#### Holes

Ø (mm)	n° holes	Stripped wire (mm <sup>2</sup> )	Wire with ferrule (mm <sup>2</sup> )	Torque (Nm)
9.1	1	16 ÷ 35	10 ÷ 35	2
7.0	1	4 ÷ 16	2.5 ÷ 16	2
4.5	54	1.5 ÷ 4	0.75 ÷ 4	1.5

## Technical Features

**Material:** Brass, electrical conductivity 27% IACS

Connection with cable lug up to 95 mm<sup>2</sup>

Universal fixing with 2 eyelet holes: direct fixing on structure, fixing on copper bars, fixing on spacers and extension 2 connectors.

Complete with M6 fixing screws, M8 screws for eyelet terminals M5 connection screws in galvanized steel.

Rated current: 80 A

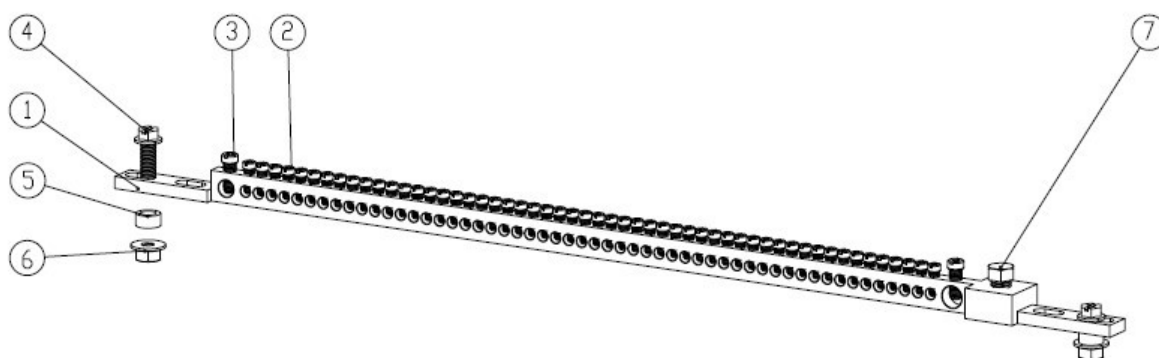

Position	Description	No.
1	Brass bar 56 holes	1
2	PH with slot head screw M4X10	54
3	Hexagon flange screw M5X12.5	2
4	Hexagon flange screw M616	2
5	Sleeve bushing M6	2
6	Hexagon flange nut M6	2
7	Hexagon screw SW10 M8X16	1

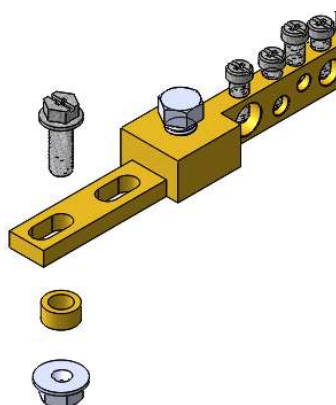

Please contact Teknomega for non-specified tolerances.