

Product Datasheet

MRS2000

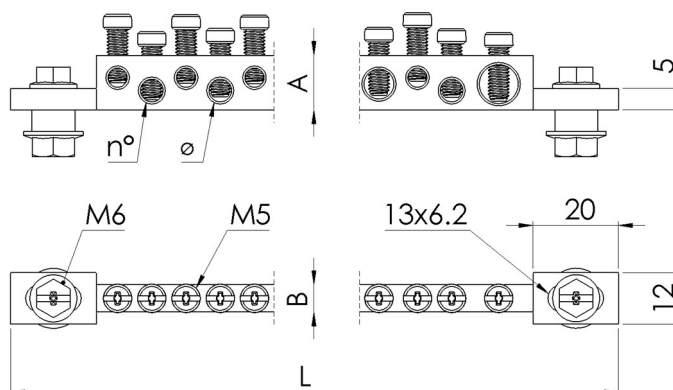

Main

Family	Earthing and Neutral Terminals
Version	Earthing terminals
Code	MRS2000
Reference	MRS 13-6-20
Number per package	1
Weight (kg)	0.165
L (mm)	215
A (mm)	13
B (mm)	6
Rated current (A)	80

Holes

Ø (mm)	n° holes	Stripped wire (mm ²)	Wire with ferrule (mm ²)	Tight. Torque (Nm)
9.1	1	16 ÷ 35	10 ÷ 35	2
7.0	3	4 ÷ 16	2.5 ÷ 16	2
5.3	8	2.5 ÷ 6	1.5 ÷ 6	1.5
4.5	8	1.5 ÷ 4	0.75 ÷ 4	1.5

Technical Features

Material: Brass, electrical conductivity 27% IACS

Complete with M6 fixing screws and M5 connection screws in galvanized steel

Rated current: 80 A

Universal fixing: direct fixing, fixing on copper bar, fixing on spacers and extension 2 connectors.

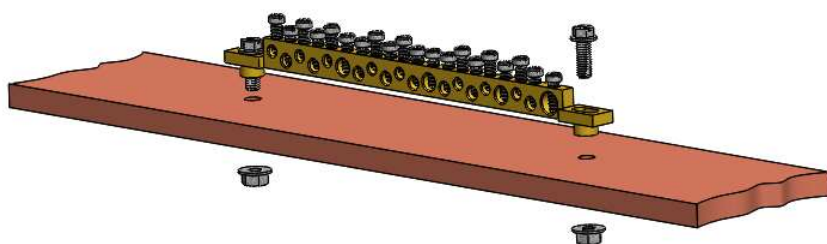

Fixing on copper bar

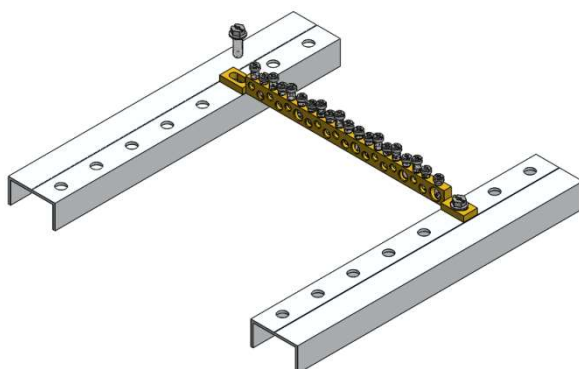

Fixing on profiles

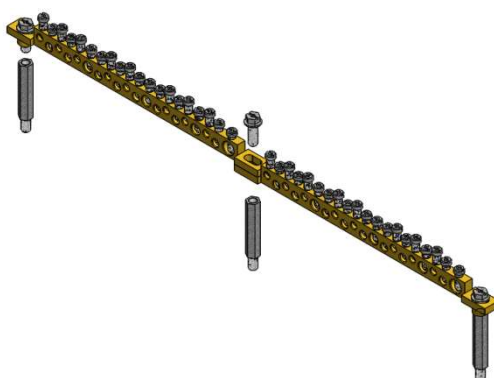

Fixing on spacers

Please contact Teknomega for non-specified tolerances.