

mostrina frontale copriforo 139,6x 45,65mm (LaxA) accessori per: interruttori automatici a 4 poli senza accesso TMTU 3VA12 per modulo differenziale montato in basso RCD520 250 a 4 poli 3VA9214-0RL20 RCD820 160 a 4 poli 3VA9124-0RL30 RCD820 250 a 4 poli 3VA9224-0RL30 RCD820B 160 a 4 poli 3VA9124-0RL40 RCD820B 250 a 4 poli 3VA9224-0RL40

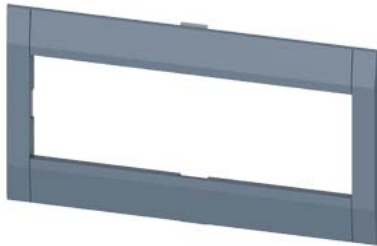

Versione	
marca del prodotto	SETRON
denominazione del prodotto	mostrina frontale copriforo
accessori	mostrina frontale copriforo
Dati tecnici generali	
Peso netto per UQ	48 g
Certificati	
General Product Approval	EMV

[Miscellaneous](#)



[Confirmation](#)



Test Certificates	Maritime application	other	Environment		
Type Test Certificates/Test Report		Miscellaneous	Confirmation	Environmental Conformations	Environmental Conformations

Ulteriori informazioni

Informazioni sull'imballaggio

<https://support.industry.siemens.com/cs/ww/it/view/109813875>

Information for data generation and storage

<https://support.industry.siemens.com/cs/ww/en/view/109995012>

Information- and Downloadcenter (Cataloghi, Opuscoli,...)

<https://www.siemens.com/lowvoltage/catalogs>

Industry Mall (sistema di ordinazione Online)

<https://mall.industry.siemens.com/mall/it/it/Catalog/product?mlfb=3VA9254-0SB10>

Service&Support (Manuali, Certificati, Caratteristiche, FAQ, ...)

<https://support.industry.siemens.com/cs/ww/it/ps/3VA9254-0SB10>

Banca dati immagini (foto prodotto, disegni dimensionali 2D, modelli 3D, schemi delle connessioni, ...)

https://www.automation.siemens.com/bilddb/cax_en.aspx?mlfb=3VA9254-0SB10

CAX-Online-Generator

<https://www.siemens.com/cax>

Tender specifications

<https://www.siemens.com/specifications>

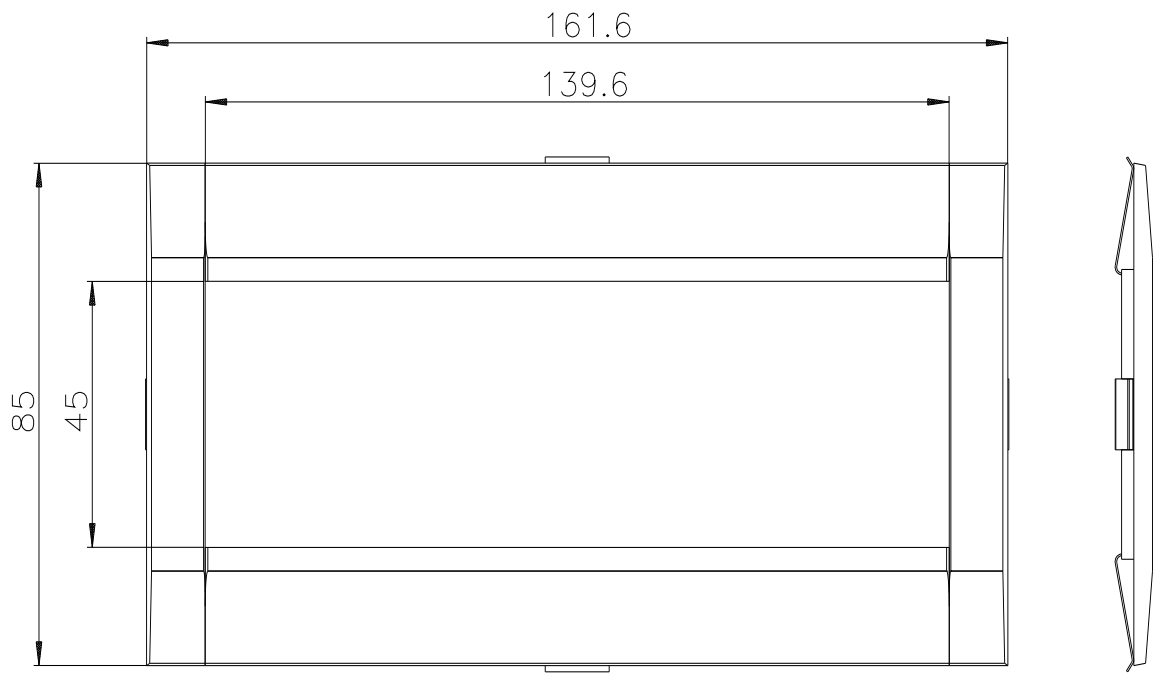

Ultima modifica:

03/04/2025 