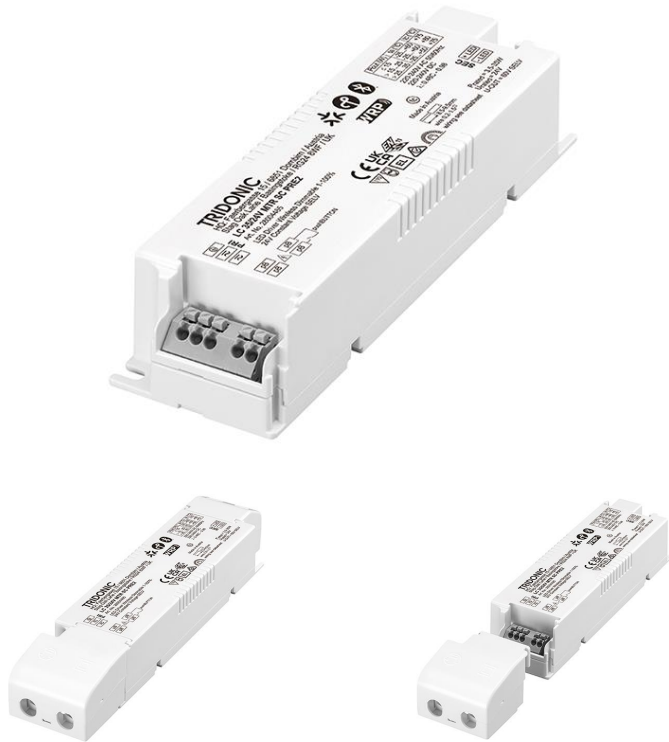

Driver LC 35W 24V MTR SC PRE2

premium series 24 V – dimmable (IP20)

**Product description**

- _ Matter certified device
- _ Communication via an IPv6 Thread Network
- _ Thread Border Router is required (e.g. Apple HomePod mini or Google NestHub)
- _ Independent push-button input for free configuration
- _ Wireless firmware updates possible
- _ Dimmable 24 V constant voltage LED driver for flexible constant voltage strips
- _ Can be either used built-in or independent with clip-on strain-relief (see data sheet chapter: 1. Standards)
- _ The strain relief is included in both packaging variants. In the single packaging (SP) each Driver has also an individual packaging
- _ Dimming range 1 to 100 %
- _ No additional external dimmer is needed
- _ Suitable for emergency escape lighting systems acc. to EN 50172
- _ Nominal lifetime up to 50,000 h
- _ 5 years guarantee (conditions at <https://www.tridonic.com/en/int/services/manufacture-guarantee-conditions>)
- _ We will provide security updates for the next five years after the date of purchase of this product

Typical applications

- _ Cove lighting, facade accent lighting, ceiling integration

Technical details

- _ 24 V, 35 W
- _ Small design (195 x 43 x 30.2 mm) with stretched-compact strain relief
- _ Small cross section
- _ Push terminals for simple wiring
- _ 1 output channel (+/-)

Interfaces

- _ Matter
- _ Terminal blocks: 45° push terminals

System solution

- _ Tridonic LLE-FLEX ADV 600, 1,200, 1,800 lm/m
- _ Tridonic LLE-FLEX EXC 600, 1,200, 1,800, 2,500 lm/m
- _ In connection with Flex accessories wire to PCB plug
- _ Test the function of third party light sources before use at low dimming levels to ensure the dimming function works perfectly

Website
<http://www.tridonic.com/28004485>

Spotlights



Downlights



Linear



Area



Floor | Wall



Free-standing



Street



Decorative



High bay

Driver LC 35W 24V MTR SC PRE2

premium series 24 V – dimmable (IP20)

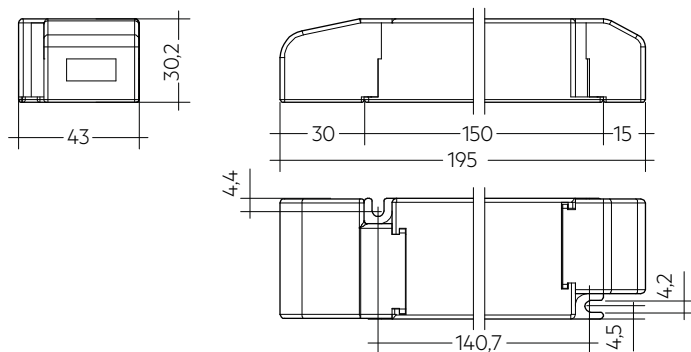

With strain-relief

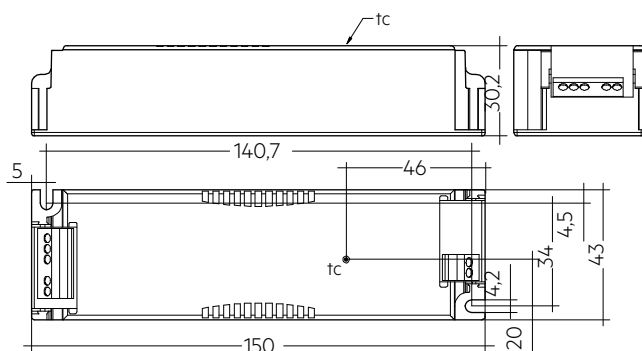

Without strain-relief

Ordering data

| Type | Article number | Packaging, carton ^④ | Packaging, pallet | Weight per pc. |
|--------------------------|----------------|--------------------------------|-------------------|----------------|
| Multi packaging | | | | |
| LC 35/24V MTR SC PRE2 | 28004485 | 10 pc(s). | 390 pc(s). | 0.15 kg |
| Single packaging | | | | |
| LC 35/24V MTR SC PRE2 SP | 28004489 | 10 pc(s). | 480 pc(s). | 0.15 kg |

Technical data

| | |
|---|--------------------|
| Rated supply voltage | 220 – 240 V |
| AC voltage range | 198 – 264 V |
| DC voltage range | 176 – 280 V |
| Mains frequency | 0 / 50 / 60 Hz |
| Typ. rated current (at 230 V, 50 Hz, full load) ^① | 176 mA |
| Typ. current (220 V, 0 Hz, full load, 15 % dimming level) | 37 mA |
| Leakage current (at 230 V, 50 Hz, full load) ^① | < 320 µA |
| Max. input power | 40 W |
| Output power range (P _{rated}) | 3.5 – 35 W |
| Typ. efficiency (at 230 V, 50 Hz, full load) | 89 % |
| λ over full operating range (max.) ^① | 0.98 |
| λ over full operating range (min.) | 0.48C |
| Typ. power consumption on stand-by | < 0.35 W |
| Typ. input current in no-load operation | 26.5 mA |
| Typ. input power in no-load operation | 1.78 W |
| In-rush current (peak / duration) | 21.6 A / 136 µs |
| THD (at 230 V, 50 Hz, full load) ^① | < 6.7 % |
| Starting time (at 230 V, 50 Hz, full load) ^① | < 0.6 s |
| Starting time (DC mode) | < 0.3 s |
| Switchover time (AC/DC) ^② | < 0.3 s |
| Turn off time (at 230 V, 50 Hz, full load) | < 3 ms |
| Output voltage tolerance | ± 1 V |
| Output LF voltage ripple (< 120 Hz) | ± 5 % |
| Max. output voltage (U-OUT) | 60 V |
| PWM frequency | ~ 1 kHz |
| Dimming range | 1 – 100 % |
| Mains surge capability (between L - N) | 1 kV |
| Mains surge capability (between L/N - PE) | 2 kV |
| Type of protection | IP20 |
| Radio transceiver operating frequencies | 2.4 – 2.483 GHz |
| Max. output power radio transceiver (E.I. R.P.) [®] | < + 20 dBm |
| Lifetime | up to 50,000 h |
| Guarantee (conditions at www.tridonic.com) | 5 Year(s) |
| Dimensions L x W x H | 195 x 43 x 30.2 mm |

Approval marks**Standards**

EN 55015, EN 61000-3-2, EN 61000-3-3, EN 61347-1, EN 61347-2-13, EN 62384, EN 61547, EN 18031-1, ETSI EN 300 330, ETSI EN 301 489-1, ETSI EN 301 489-3, ETSI EN 300 328, ETSI EN 301 489-17, according to EN 50172, according to EN 60598-2-22

Specific technical data

| Type | Load | Output voltage | Output current | Max. output power (at full load) | Typ. power consumption (at full load) | Typ. current consumption | t _c point max. | Ambient temperature T _a |
|--------------------------|-------|----------------|----------------|----------------------------------|---------------------------------------|--------------------------|---------------------------|------------------------------------|
| LC 35/24V MTR SC PRE2 | 10 % | 24 V | 146 mA | 3.5 W | 5.9 W | 41 mA | 75 °C | -25 ... +60 °C |
| LC 35/24V MTR SC PRE2 | 20 % | 24 V | 292 mA | 7.0 W | 9.6 W | 57 mA | 75 °C | -25 ... +60 °C |
| LC 35/24V MTR SC PRE2 | 30 % | 24 V | 437 mA | 10.5 W | 13.4 W | 71 mA | 75 °C | -25 ... +60 °C |
| LC 35/24V MTR SC PRE2 | 40 % | 24 V | 583 mA | 14.0 W | 17.0 W | 85 mA | 75 °C | -25 ... +60 °C |
| LC 35/24V MTR SC PRE2 | 50 % | 24 V | 729 mA | 17.5 W | 20.7 W | 99 mA | 80 °C | -25 ... +60 °C |
| LC 35/24V MTR SC PRE2 | 60 % | 24 V | 875 mA | 21.0 W | 24.5 W | 114 mA | 80 °C | -25 ... +60 °C |
| LC 35/24V MTR SC PRE2 | 70 % | 24 V | 1,021 mA | 24.5 W | 28.3 W | 130 mA | 80 °C | -25 ... +60 °C |
| LC 35/24V MTR SC PRE2 | 80 % | 24 V | 1,167 mA | 28.0 W | 32.0 W | 145 mA | 75 °C | -25 ... +50 °C |
| LC 35/24V MTR SC PRE2 | 90 % | 24 V | 1,313 mA | 31.5 W | 35.7 W | 161 mA | 75 °C | -25 ... +50 °C |
| LC 35/24V MTR SC PRE2 | 100 % | 24 V | 1,453 mA | 35.0 W | 39.4 W | 176 mA | 75 °C | -25 ... +50 °C |
| LC 35/24V MTR SC PRE2 SP | 10 % | 24 V | 146 mA | 3.5 W | 5.9 W | 41 mA | 75 °C | -25 ... +60 °C |
| LC 35/24V MTR SC PRE2 SP | 20 % | 24 V | 292 mA | 7.0 W | 9.6 W | 57 mA | 75 °C | -25 ... +60 °C |
| LC 35/24V MTR SC PRE2 SP | 30 % | 24 V | 437 mA | 10.5 W | 13.4 W | 71 mA | 75 °C | -25 ... +60 °C |
| LC 35/24V MTR SC PRE2 SP | 40 % | 24 V | 583 mA | 14.0 W | 17.0 W | 85 mA | 75 °C | -25 ... +60 °C |
| LC 35/24V MTR SC PRE2 SP | 50 % | 24 V | 729 mA | 17.5 W | 20.7 W | 99 mA | 80 °C | -25 ... +60 °C |
| LC 35/24V MTR SC PRE2 SP | 60 % | 24 V | 875 mA | 21.0 W | 24.5 W | 114 mA | 80 °C | -25 ... +60 °C |
| LC 35/24V MTR SC PRE2 SP | 70 % | 24 V | 1,021 mA | 24.5 W | 28.3 W | 130 mA | 80 °C | -25 ... +60 °C |
| LC 35/24V MTR SC PRE2 SP | 80 % | 24 V | 1,167 mA | 28.0 W | 32.0 W | 145 mA | 75 °C | -25 ... +50 °C |
| LC 35/24V MTR SC PRE2 SP | 90 % | 24 V | 1,313 mA | 31.5 W | 35.7 W | 161 mA | 75 °C | -25 ... +50 °C |
| LC 35/24V MTR SC PRE2 SP | 100 % | 24 V | 1,453 mA | 35.0 W | 39.4 W | 176 mA | 75 °C | -25 ... +50 °C |

① Valid at 100 % dimming level.

② Valid for immediate change of power supply type otherwise the starting time is valid.

③ E.I.R.P.: Equivalent Isotropically Radiated Power.

④ The strain relief is included in both packaging variants. In the single packaging each Driver has also an individual packaging.

1. Standards

EN 55015
 EN 61000-3-2
 EN 61000-3-3
 EN 61347-1
 EN 61347-2-13
 EN 62384
 EN 61547
 EN 18031-1
 ETSI EN 300 330
 ETSI EN 301 489-1
 ETSI EN 301 489-3
 ETSI EN 300 328
 ETSI EN 301 489-17

According to EN 50172 for use in central battery systems

According to EN 60598-2-22 suitable for emergency lighting installations

For devices with strain-reliefs the following test marks apply:

 ... Class II luminaires

 ... Independent device

For devices without strain-reliefs the following test mark apply:

 ... Double or reinforced insulation

2. Thermal details and lifetime

2.1 Expected lifetime

| Expected lifetime | | | | | | |
|-----------------------|-------------|----------|-------------|-------------|-------------|----------|
| Type | Output load | ta | 30 °C | 40 °C | 50 °C | 60 °C |
| LC 35/24V MTR SC PRE2 | 35 – 26 W | tc | 60 °C | 65 °C | 75 °C | – |
| | | Lifetime | > 100,000 h | > 100,000 h | 55,000 h | – |
| | 25 – 16 W | tc | – | 60 °C | 70 °C | 80 °C |
| | | Lifetime | – | > 100,000 h | 95,000 h | 55,000 h |
| | ≤ 15 W | tc | – | 60 °C | 65 °C | 75 °C |
| | | Lifetime | – | > 100,000 h | > 100,000 h | 65,000 h |

The LED control gear is designed for a lifetime stated above under reference conditions and with a failure probability of less than 10 %.

The relation of tc to ta temperature depends also on the luminaire design.

If the measured tc temperature is approx. 5 K below tc max., ta temperature should be checked and eventually critical components (e.g. ELCAP) measured. Detailed information on request.

3. Installation / wiring

3.1 Circuit diagram

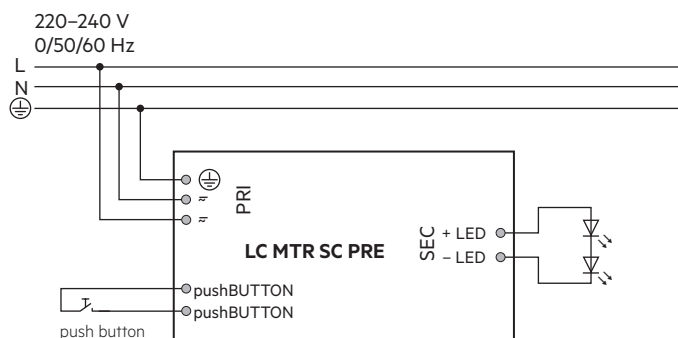

 Recommendation to check glowing at standby in combination with class I luminaires.

The used push button has to be insulated.

1.1 Glow wire test

according to EN 61347-1 with increased temperature of 850 °C passed.

3.2 Wiring type and cross section

For wiring use stranded wire with ferrules or solid wire from 0.2–1.5 mm². Strip 8.5–9.5 mm of insulation from the cables to ensure perfect operation of the push-wire terminals.

Use one wire for each terminal connector only.
 Use each strain relief channel for one cable only.

LED module/LED driver/supply

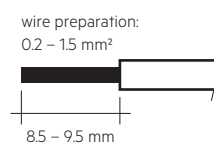

Secondary strain relief for cables with bigger cable sheath

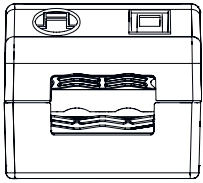

Secondary strain relief for cable with smaller cable sheath

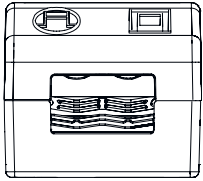

3.3 Loose wiring

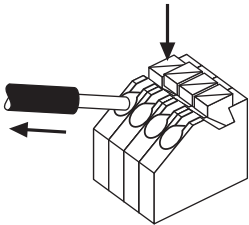

Press down the "push button" and remove the cable from front.

3.4 Fixing conditions when using as independent Driver with Clip-On

Dry, acidfree, oilfree, fatfree. It is not allowed to exceed the maximum ambient temperature (t_a) stated on the device. Minimum distances stated below are recommendations and depend on the actual luminaire. Device is not suitable for fixing in corner.

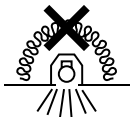
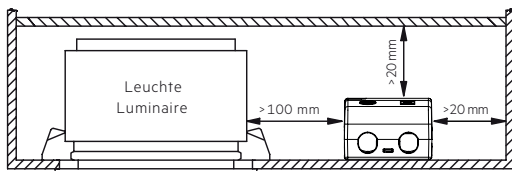

Device not suitable for covering with thermally insulating material according to IEC 60598-1 Ed.9

3.5 Wiring guidelines

- Run the secondary lines separately from the mains connections and lines to achieve good EMC performance.
- The max. secondary cable (LED module) length is 2 m (4 m circuit).
- For good EMC performance, keep the LED wiring as short as possible.
- To comply with the EMC regulations run the secondary wires (LED module) in parallel.
- Secondary switching is not permitted.
- The LED driver has no inverse-polarity protection on the secondary side. Wrong polarity can damage LED modules with no inverse-polarity protection.
- Wrong wiring of the LED driver can lead to malfunction or irreparable damage.
- To avoid damage of the Driver, the wiring must be protected against short circuits to earth (sharp edged metal parts, metal cable clips, louver, etc.).

3.6 Hot plug-in

Hot plug-in is not supported due to residual output voltage of > 0 V. When connecting an LED load, restart the device to activate the LED output. This can be done via mains reset or interface (basicDIM Wireless).

3.7 Earth connection

The earth connection is conducted as protection earth (PE). The LED driver can be earthed via earth terminal. If the LED driver will be earthed, protection earth (PE) has to be used. There is no earth connection required for the functionality of the LED driver. Earth connection is recommended to improve following behaviour:

- Electromagnetic interferences (EMI)
- LED glowing at standby
- Transmission of mains transients to the LED output

In general it is recommended to earth the LED driver if the LED module is mounted on earthed luminaire parts respectively heat sinks and thereby representing a high capacity against earth.

3.8 Commissioning

When a Matter device is not yet commissioned, it will send out BLE (Bluetooth Low Energy) handshake communication for 15 min. It's only possible to pair the device in this period of time, afterwards a power cycle is necessary.

Also of importance:

- Network is up and running
- Thread border router compatible with the Matter ecosystem is available and in the network
- Minimum requirements:
Android / Google: Android O (8.1, API level 27) or newer
iOS / Apple: iOS version 16.x
- Matter ready devices



During commissioning and use of the product, do not enter any sensitive personal information or confidential personal information.

4. Electrical values

4.1 Efficiency vs. load

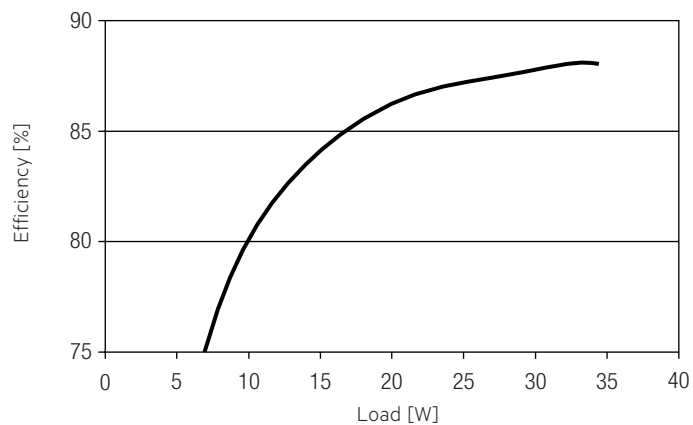

4.4 Input current vs. Load

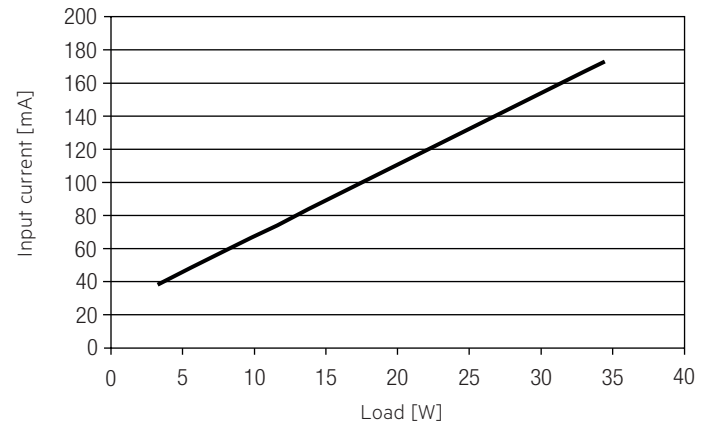

4.2 Power factor vs. Load

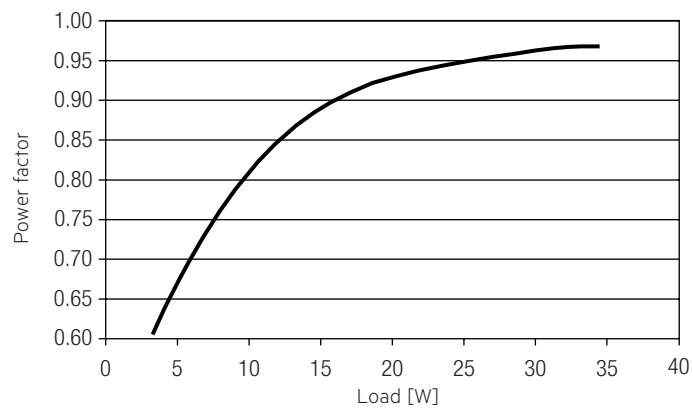

4.5 THD vs. Load

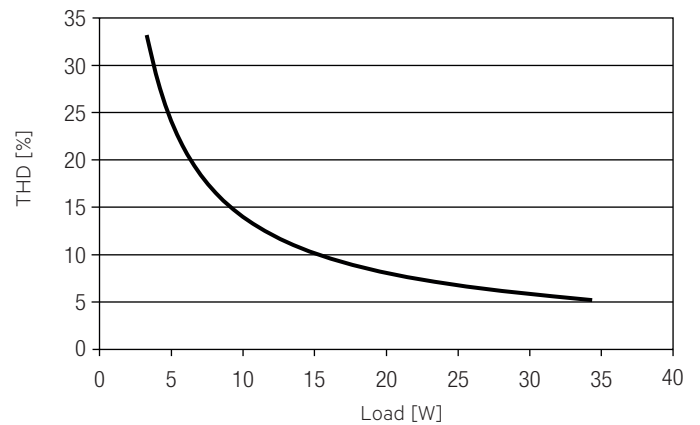

4.3 Input power vs. Load

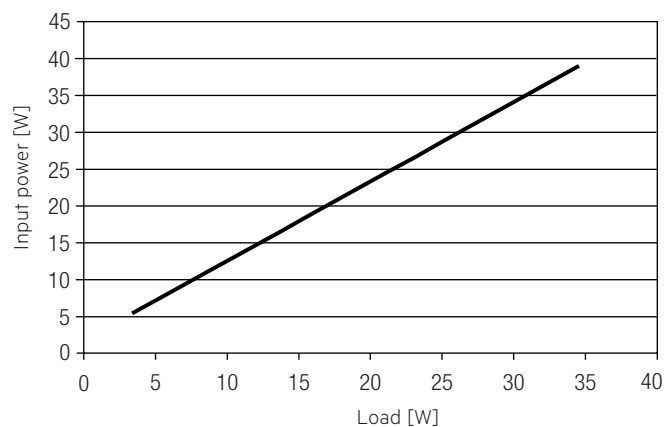

4.6 Maximum loading of automatic circuit breakers in relation to inrush current

| Automatic circuit breaker type | C10 | C13 | C16 | C20 | B10 | B13 | B16 | B20 | Inrush current | |
|--------------------------------|---------------------|---------------------|---------------------|-------------------|---------------------|---------------------|---------------------|-------------------|----------------|--------|
| Installation Ø | 1.5 mm ² | 1.5 mm ² | 2.5 mm ² | 4 mm ² | 1.5 mm ² | 1.5 mm ² | 2.5 mm ² | 4 mm ² | I_{max} | time |
| LC 35/24V MTR SC PRE2 | 27 | 37 | 47 | 60 | 16 | 22 | 28 | 36 | 21.6 A | 136 µs |

These are max. values calculated out of inrush current! Please consider not to exceed the maximum rated continuous current of the circuit breaker.

Calculation uses typical values from ABB series S200 as a reference.

Actual values may differ due to used circuit breaker types and installation environment.

4.7 Harmonic distortion in the mains supply (at 230 V / 50 Hz and full load) in %

| | THD | 3. | 5. | 7. | 9. | 11. |
|------------------------------|-----|----|----|----|----|-----|
| LC 35/24V MTR SC PRE2 | 6 | 6 | 1 | 2 | 2 | 1 |

4.8 Dimming

Dimming range 1% to 100 %

Digital control with:

- Matter

4.9 Dimming characteristics

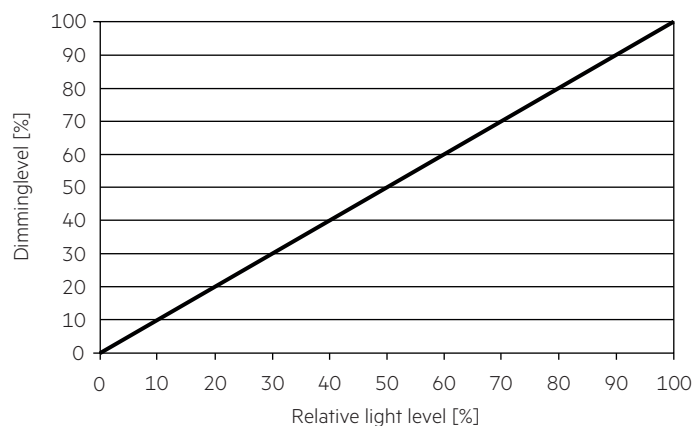

5. Interfaces / communication

5.1 Control input

A standard push button can be connected on the input terminals.

Maximum cable length of the push button is 1 meter.

This function have to be activated before using.

The control signal is not SELV. Control cable has to be installed in accordance to the requirements of low voltage installations.

5.2 QR code

The unit contains 2 QR codes that are identical. One is permanently attached to the unit and the second is to be torn off and then stuck on the luminaire or stored in the commissioning documentation.



These QR codes contain device-specific data that is required to commission the Matter luminaire. Without this, it is not possible to commission a Matter luminaire.

The QR code that is placed on the luminaire should be easy for the commissioner to reach and scan, but not visible to everyone! If this is not possible, collect and keep the QR code stickers after commissioning.

Be sure to inform the end customer of the consequences if they are lost. With the QR code it is possible to commission the unit to a network. The QR code represents access to the network itself!

6. Functions

6.1 ready2mains – configuration

The ready2mains interface can be used to configure the main parameters of LED drivers via the mains wiring, e.g. CLO and DC level. These parameters can be adjusted via ready2mains-capable configuration software.

6.2 Short-circuit behaviour

In case of a short-circuit at the LED output the LED output is switched off. After restart of the LED driver the output will be activated again. The restart can either be done via mains reset or via software or pushBUTTON.

6.3 Overload protection

If the maximum load is exceeded by a defined internal limit, the LED driver turns off the LED output. After restart of the LED driver the output will be activated again. The restart can either be done via mains reset or via software or pushBUTTON.

6.4 Overtemperature protection

The LED driver is protected against temporary thermal overheating. If the temperature limit is exceeded the output current of the LED module(s) is reduced. The temperature protection is activated above $t_{c\ max}$. The activation temperature differs depending on the LED load. On DC operation this function is deactivated to fulfill emergency requirements.

6.5 Constant light output (CLO)

The luminous flux of a LED decreases constantly over the lifetime. The CLO function ensures that the emitted luminous flux remains stable. For that purpose the LED current will increase continuously over the LED lifetime. Via ready2mains it is possible to select a start value (in percent) and an expected lifetime. The LED driver adjusts the current afterwards automatically.

6.6 Power-up/-down fading

The power-up/-down function offers the opportunity to modify the on-/off behavior. The time for fading on or off can be adjusted in a range of 0.2 to 16 seconds. According to this value, the device dims either from 0 % up to the power-on level or from the current set dim level down to 0 %.

6.7 Light level in DC operation

The LED driver is designed for operation on DC voltage and pulsed DC voltage.

Light output level in DC operation: programmable 1 – 100 % (EOFu = 0.13). Programming by ready2mains. In DC operation dimming mode can be activated.

The voltage-dependent input current of Driver incl. LED module is depending on the used load.

6.8 Software / programming

With appropriate software and an interface different functions can be activated and various parameters can be configured in the LED driver. To do so, a ready2mains programmer or utilityAPP is required.

7. Restore factory defaults

To restore the factory settings, the module must be switched on and off in the following sequence.

If the sequence was entered correctly, the luminaire (driver) flashes 2 times.

| Stage | Duration | State |
|-------|-----------|-------|
| 1 | < 5 s | ON |
| 2 | >30 s | OFF |
| 3 | 5 – 15 s | ON |
| 4 | >30 s | OFF |
| 5 | < 5 s | ON |
| 6 | >30 s | OFF |
| 7 | < 5 s | ON |
| 8 | >30 s | OFF |
| 9 | permanent | ON |



8. Miscellaneous

8.1 Insulation and electric strength testing of luminaires

Electronic devices can be damaged by high voltage. This has to be considered during the routine testing of the luminaires in production.

According to IEC 60598-1 Annex Q (informative only!) or ENEC 303-Annex A, each luminaire should be submitted to an insulation test with 500 V_{DC} for 1 second. This test voltage should be connected between the interconnected phase and neutral terminals and the earth terminal. The insulation resistance must be at least 2 MΩ.

As an alternative, IEC 60598-1 Annex Q describes a test of the electrical strength with 1500 V_{AC} (or 1.414 x 1500 V_{DC}). To avoid damage to the electronic devices this test must not be conducted.

8.2 Conditions of use and storage

Humidity: 5 % up to max. 85 %,
not condensed
(max. 56 days/year at 85 %)

Storage temperature: -40 °C up to max. +80 °C

The devices have to be acclimatised to the specified temperature range (ta) before they can be operated.

The LED driver is declared as inbuilt LED controlgear, meaning it is intended to be used within a luminaire enclosure.

If the product is used outside a luminaire, the installation must provide suitable protection for people and environment (e.g. in illuminated ceilings).

8.3 Placement

Matter device have an integrated antenna for easy integration. In order to maximize the range in every direction some design guidelines should be taken into consideration when mounting the device.

The antenna is located on the corner of the enclosure. It is on the top side of the internal PCB (Printed Circuit Board).

When the device is mounted on a metal plate (e.g. frame of a luminaire), it may efficiently block the radio frequency signal. In this case, a cut-out underneath the antenna may be needed for the RF signal to exit the structure. The cut-out area should be as large as possible. Also the device should be placed as far away from any vertical metal structures as possible.

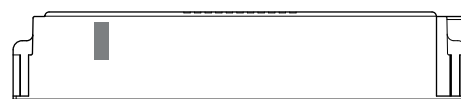

■ Antenna location

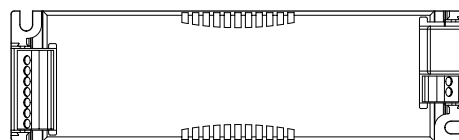

The range of the communication signal is depending on the environment e.g. luminaire, construction of the building, furnitures or humans and needs to be tested and approved in the installation.



To ensure a good radio connection, do not cover the Matter device completely with metal!

8.4 Use of Bluetooth technology

Use of Bluetooth technology: During initial phase of commissioning, the product communicates via Bluetooth technology.

8.5 Matter certified

The device is a Matter certified device and listed in the Matter product database.

There are different ecosystems available in the market.

When selecting an ecosystem, make sure with the owner of the ecosystem that all the functionalities are available and usable.

Functionalities should be tested in advance.

The product functions depend on the Matter ecosystem used.

The Connectivity Standard Alliance (CSA) offers the Certification Transfer Program for re-branding/white labeling while maintaining the Certified status of those products.

To guarantee compliance while integrating these devices into luminaires, it is recommended to verify any additional requirements with the

Connectivity Standards Alliance and the Transfer Program:

<https://csa-iot.org/certification/transfer-program/>

8.6 Maximum number of switching cycles

All LED driver are tested with 50,000 switching cycles.

The actually achieved number of switching cycles is significantly higher.

8.7 Additional information

Additional technical information at www.tridonic.com → Technical Data

Lifetime declarations are informative and represent no warranty claim.

No warranty if device was opened.