

# Product End of Life Instructions

**GP6000 Series Standard model, 5.7 VGA, Analog-single, DC**

**Advanced Operator Terminal**



**Pro-face**  
by Schneider Electric



## Potential disassembly risks

### WARNING

#### HAZARD OF ARC FLASH OR FIRE

- Disconnect battery terminals before disassembly
- Avoid any electrical connection between the terminals

**Failure to follow these instructions can result in death or serious injury.**



## End of Life Instructions

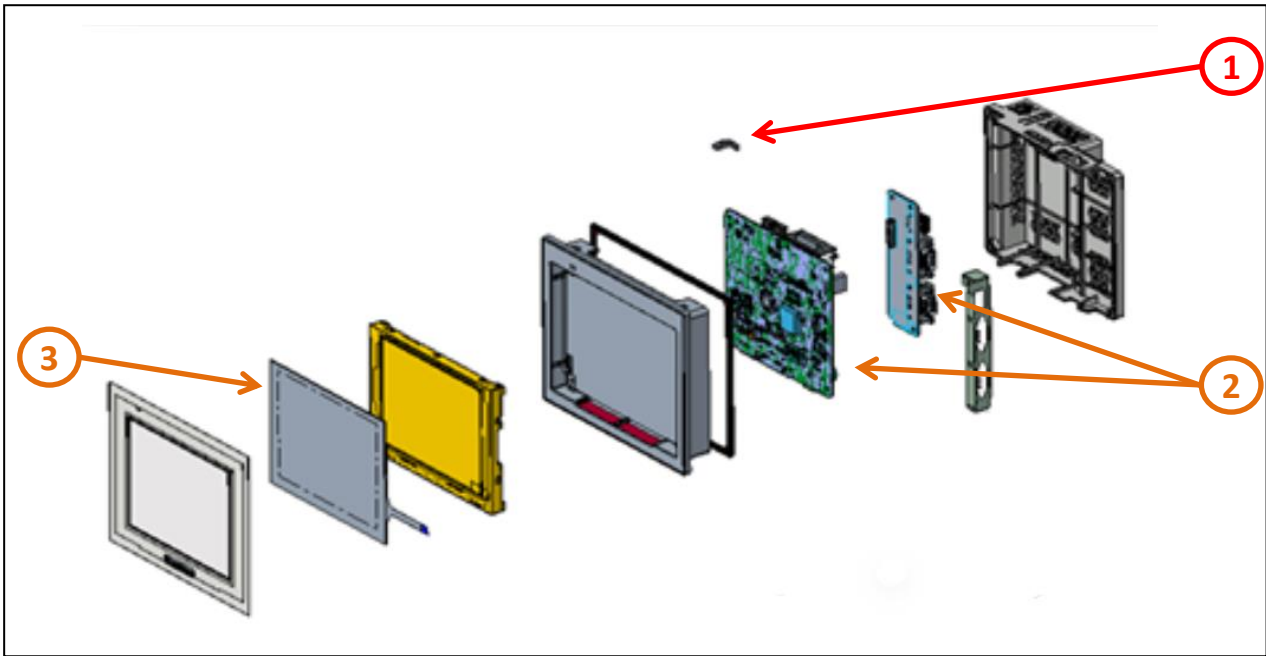

Recommendation	Number on drawing	Component / Material	Weight (in g)	Comment
Potential hazards	1	Battery	2.5	1×cell battery
To be depolluted	2	Electronic Board (Communication) > 10cm <sup>2</sup>	138.1	2×PCBAs
To be depolluted	3	LCD and all those back-lighted with gas discharge lamps	165.0	LCD screen
Other			494.4	Expect of the above parts



## Product description

Manufacturer identification	Schneider Electric Industries SAS
Brand name	Pro-face by Schneider Electric
Product function	Advanced Operator Terminal, Enhanced resolution with Analog single touch screen, High performance
Product reference	PFXGP6300TAD
Additional similar product references	PFXGP6400TAD
Total representative product mass	800 g
Representative product dimensions	169.5mm x 137.0mm x 59.5mm
Accessories	Fasteners
Date of information release	11-2024



## Additional information

Legal information	This product family is in the scope of European Union directive 2012/19/EU on Waste Electrical and Electronic Equipment (WEEE). The product family must be disposed according to the legislation of the country. This document is intended for use by end of life recyclers or treatment facilities. It provides the basic information to assure an appropriate end of life treatment for the components and materials of the product.	
In case of special transportation: transportation method	No special transportation.	
Recyclability potential	43%	Recyclability rate has been calculated based on REEECY'LAB tool developed by Ecosystem, for components/materials not covered by the tool, data from the "ECO' DEEE recyclability and recoverability calculation method" was taken. If no data was found a conservative assumption was used (0% recyclability).

Schneider Electric Industries SAS  
Country Customer Care Center  
<http://www.se.com/contact>  
35, rue Joseph Monier  
CS 30323  
F- 92500 Rueil Malmaison Cedex  
RCS Nanterre 954 503 439  
Capital social 928 298 512 €

[www.se.com](http://www.se.com)

ENVEOLI2410009\_V1

Published by Schneider Electric

© 2023 - Schneider Electric – All rights reserved

11-2024