

Product End of Life Instructions

PM8000 IO MODULE

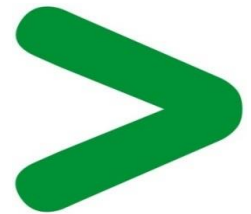



Potential disassembly risks

WARNING

HAZARD OF ARC FLASH OR FIRE

- Disconnect battery terminals before disassembly
- Avoid any electrical connection between the terminals

Failure to follow these instructions can result in death or serious injury.



End of Life Instructions

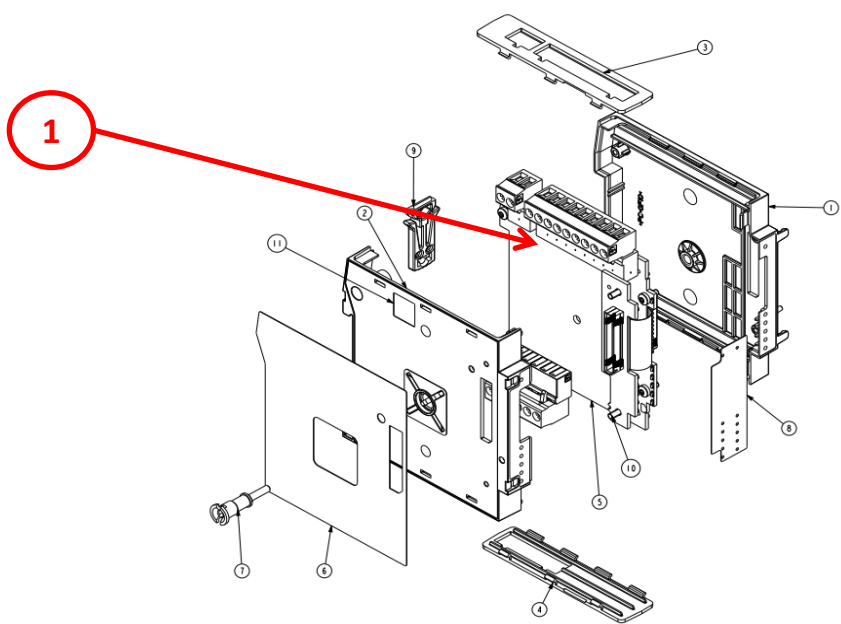

Recommendation	Number on drawing	Component / Material	Weight (in g)	Comment
To be depolluted	1	Electronic Board (Communication) > 10cm ²	63.5	Including all soldering parts



Product description

Manufacturer identification	Schneider Electric Industries SAS
Brand name	Schneider Electric
Product function	Optional Input Output module that provides additional digital inputs and relay outputs. Compatible with meters including PowerLogic PM8000, ION7400, and ION9000. This digital IO module provides 6 digital inputs that support 30VAC or 60VDC. The digital inputs can be excited by the provided wetting source or a user provided external source. Plus 4 relay outputs to provide status indication and to provide control operations. The relay outputs support loads up to 8A at 240VAC. The option modules are attached to the side of the meter providing connection for control power and interfacing bus. The PowerLogic PM8000, ION7400 and ION9000 meters allow up to 4 input/output option modules attached at the same time.
Product reference	METSEPM89M2600
Additional similar product references	METSEPM89M2600 METSEPM89M0024
Total representative product mass	140 g
Representative product dimensions	90.5mm x 90.5mm x 22mm
Date of information release	2025-09



Additional information

Legal information	This product family is in the scope of European Union directive 2012/19/EU on Waste Electrical and Electronic Equipment (WEEE). The product family must be disposed according to the legislation of the country. This document is intended for use by end of life recyclers or treatment facilities. It provides the basic information to assure an appropriate end of life treatment for the components and materials of the product.
Recyclability potential	28% The recyclability rate was calculated from the recycling rates of each material making up the product based on REEECY'LAB tool developed by Ecosystem, for components/materials not covered by the tool, data from the EIME database and the related PSR was taken. If no data was found a conservative assumption was used (0% recyclability).

Schneider Electric Industries SAS

Country Customer Care Center
<http://www.se.com/contact>

35, rue Joseph Monier
 CS 30323
 F- 92500 Rueil Malmaison Cedex
 RCS Nanterre 954 503 439
 Capital social 928 298 512 €

www.se.com

ENVEOLI2506057_V1

Published by Schneider Electric

© 2023 - Schneider Electric – All rights reserved

2025-09