

# Product End of Life Instructions

## Managed Switch standard 8TX/4GE-TX

### ConneXium - Ethernet





## Potential disassembly risks

### ⚠ WARNING

#### HAZARD OF ARC FLASH OR FIRE

- Disconnect battery terminals before disassembly
- Avoid any electrical connection between the terminals

**Failure to follow these instructions can result in death or serious injury.**



## End of Life Instructions

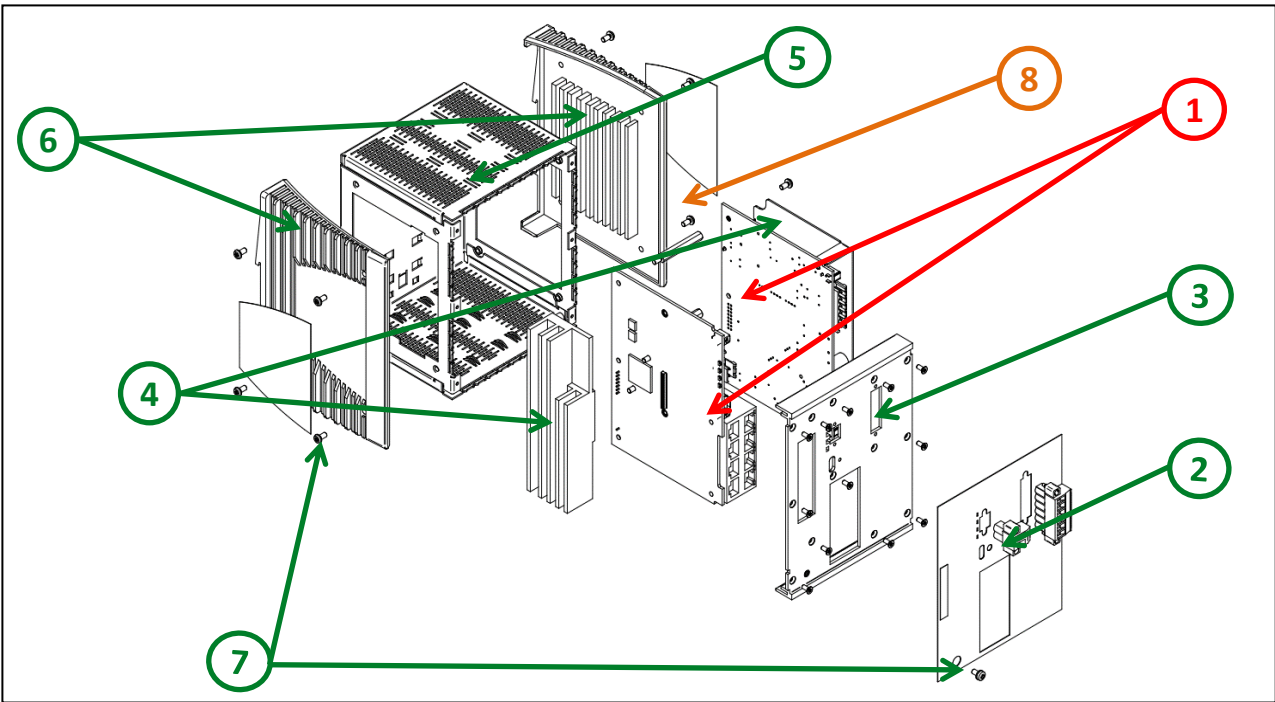

Recommendation	Number on drawing	Component / Material	Weight (in g)	Comment
Potential hazards	1	PCB	306,9	PCBAs, electrolytic capacitors
To be dismantled	2	PET	0,8	adhesive foil
To be dismantled	3 . 4. 6	Aluminium	65,8	Heat sink, front plate, housing
To be dismantled	5. 7	Stainless steal	17,4	housing, screws
To be dismantled	8	Brass	28,2	spacer
Other			260,9	

## Product description

Manufacturer identification	Schneider Electric Industries SAS
Brand name	Schneider Electric
Product function	This managed switch comes with Ethernet TCP/IP protocol. It comes with 8 copper cable transmission ports and 4 copper cable transmission ports which can support 1Gigabit transmission rate. It provides simple and complex connectivity for multiple Ethernet device, network management, enhanced cyber security and more advanced switching features.
Product reference	MCSESM123F23G0
Additional similar product references	MCSESR043F2LM0C MCSESR043F2LM0 MCSESR043F23F0C MCSESR043F23F0 MCSESP083F23G0T MCSESP083F23G0 MCSESM243F4LG0 MCSESM203F4LG0 MCSESM163F23F0 MCSESM123F2LG0 MCSESM103F2CU1H MCSESM103F2CU1 MCSESM103F2CU0H MCSESM103F2CU0 MCSESM103F2CS1H MCSESM103F2CS1 MCSESM103F2CS0H MCSESM103F2CS0 MCSESM093F1CU0 MCSESM093F1CS0 MCSESM083F23F1H MCSESM083F23F1 MCSESM083F23F0H MCSESM083F23F0 MCSESM063F2CU0 MCSESM063F2CS0 MCSESM053F1CU0 MCSESM053F1CS0 MCSESM043F23F0
Total representative product mass	680 g
Representative product dimensions	142,8 x 73 X 117,6
Accessories	Yes
Date of information release	05/11/2025

## Additional information

Legal information	This product family is in the scope of European Union directive 2012/19/EU on Waste Electrical and Electronic Equipment (WEEE). The product family must be disposed according to the legislation of the country. This document is intended for use by end of life recyclers or treatment facilities. It provides the basic information to assure an appropriate end of life treatment for the components and materials of the product.
Recyclability potential	<p>The recyclability rate was calculated from the recycling rates of each material making up the product based on REEECY'LAB tool developed by Ecosystem, for components/materials not covered by the tool, data from the EIME database and the related PSR was taken. If no data was found a conservative assumption was used (0% recyclability).</p> <p><b>16%</b></p>

Schneider Electric Industries SAS

Country Customer Care Center  
<http://www.se.com/contact>

35, rue Joseph Monier  
 CS 30323  
 F- 92500 Rueil Malmaison Cedex  
 RCS Nanterre 954 503 439  
 Capital social 928 298 512 €

[www.se.com](http://www.se.com)

ENVEOLI2003019\_V2

Published by Schneider Electric

© 2023 - Schneider Electric – All rights reserved

05/11/2025