

Product End of Life Instructions

Lexium LXM32 / LXM52 Servo Drive

LXM32M, LXM32C, LXM32A, LXM52





Potential disassembly risks

HAZARD OF ELECTRIC SHOCK, EXPLOSION OR ARC FLASH

- Disconnect all power from all equipment including connected devices prior to removing any covers or doors, or installing or removing any accessories, hardware, cables, or wires except under the specific conditions specified in the appropriate hardware guide for this equipment.
- Always use a properly rated voltage sensing device to confirm the power is off where and when indicated.
- Replace and secure all covers, accessories, hardware, cables, and wires and confirm that a proper ground connection exists before applying power to the unit.
- Use only the specified voltage when operating this equipment and any associated products.

Failure to follow these instructions will result in death or serious injury.



End of Life Instructions

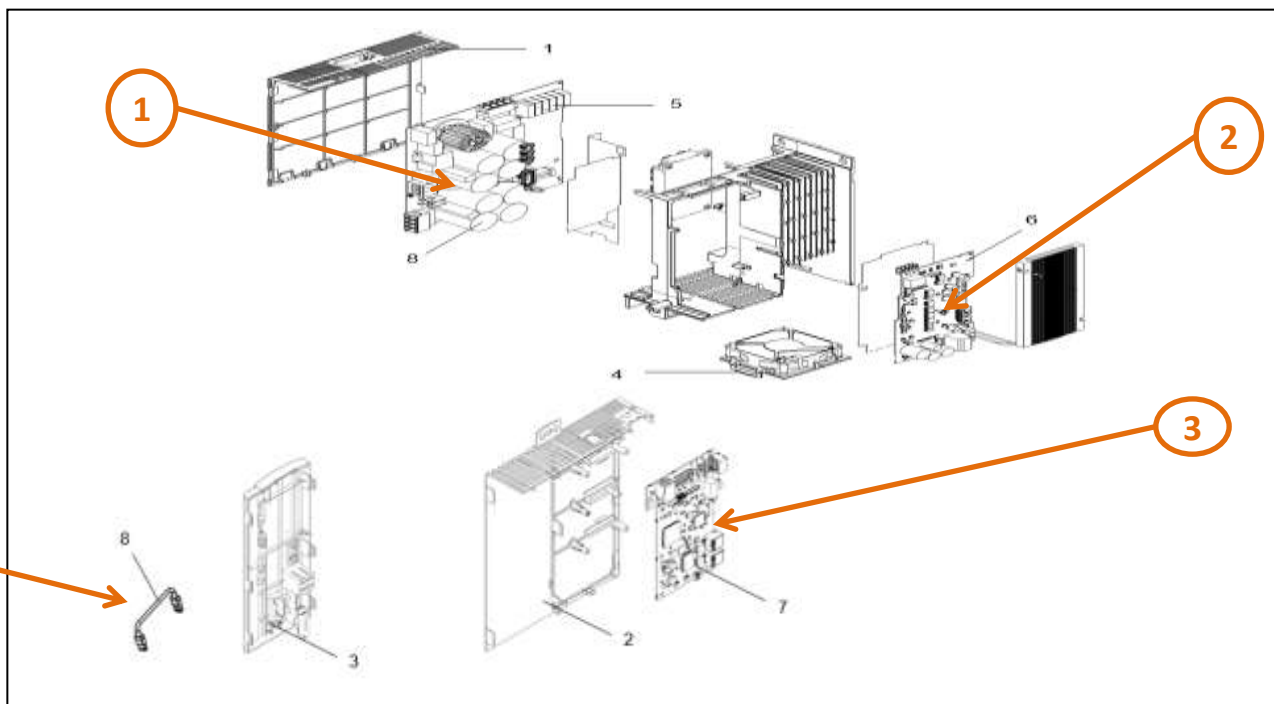

Recommendation	Number on drawing	Component / Material	Weight (in g)	Comment
To be depolluted	1, 2 & 3	Electronic Board (Power) > 10cm ²	1350	
To be depolluted	4	Cable serco Bridge	18,7	
Other			3570,30	

Product description

Manufacturer identification	Schneider Electric Industries SAS
Brand name	Schneider Electric
Product function	The Lexium LXM32 / LXM52 Servo Drives are ideally suited to implement compact, high-performance drive solutions for a wide range of power requirements.
Product reference	LXM52DD72C41000
Additional similar product references	LXM32AD12N4 LXM32AD18M2 LXM32AD18N4 LXM32AD30M2 LXM32AD30N4 LXM32AD72N4 LXM32AU45M2 LXM32AU60N4 LXM32AU90M2 LXM32CD12N4 LXM32CD18M2 LXM32CD18N4 LXM32CD30M2 LXM32CD30N4 LXM32CD72N4 LXM32CU45M2 LXM32CU60N4 LXM32CU90M2 LXM32MC10N4 LXM32MD12N4 LXM32MD18M2 LXM32MD18N4 LXM32MD30M2 LXM32MD30N4 LXM32MD72N4 LXM32MD85N4 LXM32MU45M2 LXM32MU60N4 LXM32MU90M2 LXM32SD12N4 LXM32SD18M2 LXM32SD18N4
Total representative product mass	4939 g
Representative product dimensions	274,1mm x 217mm x 108mm
Accessories	Yes
Date of information release	08/2025

Additional information

Legal information	This product family is in the scope of European Union directive 2012/19/EU on Waste Electrical and Electronic Equipment (WEEE). The product family must be disposed according to the legislation of the country. This document is intended for use by end of life recyclers or treatment facilities. It provides the basic information to assure an appropriate end of life treatment for the components and materials of the product.
In case of special transportation: transportation method	No
Recyclability potential	51% The recyclability rate was calculated from the recycling rates of each material making up the product based on REEECYLAB tool developed by Ecosystem, for components/materials not covered by the tool, data from the EIME database and the related PSR was taken. If no data was found a conservative assumption was used (0% recyclability).

Schneider Electric Industries SAS

Country Customer Care Center
<http://www.se.com/contact>

35, rue Joseph Monier

CS 30323

F- 92500 Rueil Malmaison Cedex

RCS Nanterre 954 503 439

Capital social 928 298 512 €