

# Product End of Life Instructions

## ComPacT NSX BSCM Modbus SL/ULP

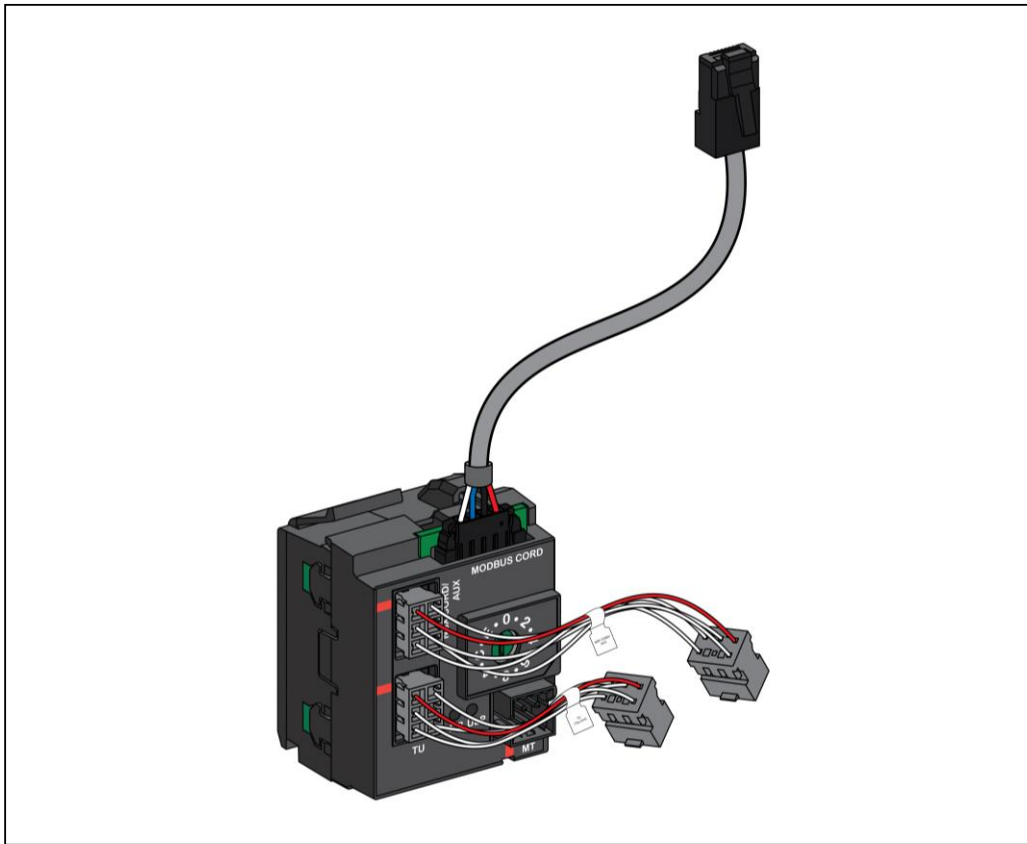



## Potential disassembly risks

### ⚠ ⚠ DANGER

#### HAZARD OF ELECTRIC SHOCK, EXPLOSION OR ARC FLASH

- Apply appropriate personal protective equipment (PPE) and follow safe electrical work practices. See NFPA 70E, CSA Z462 or local equivalent.
  - This equipment must only be installed and serviced by qualified electrical personnel.
  - Turn off all power supplying this equipment before working on or inside equipment. Lock the switchgear in the isolated position.
  - Always use a properly rated voltage sensing device to confirm power is off.
  - Install safety barriers and display a danger sign.
  - Replace all devices, doors, and covers before turning on power to this equipment.
- Failure to follow these instructions will result in death or serious injury.**



## End of Life Instructions

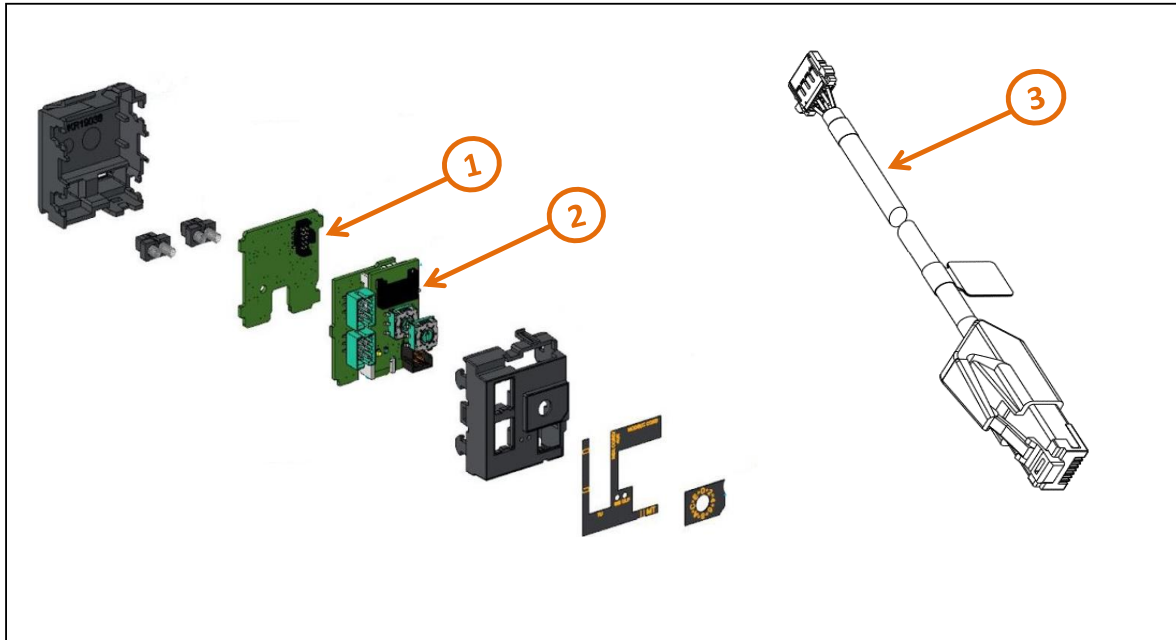

| Recommendation   | Number on drawing | Component / Material                                 | Weight (in g) | Comment     |
|------------------|-------------------|--|---------------|-------------|
| To be depolluted | 1                 | Electronic Board (Communication) > 10cm <sup>2</sup> | 2.5           | POWER PCB   |
| To be depolluted | 2                 | Electronic Board (Communication) > 10cm <sup>2</sup> | 4.82          | DIGITAL PCB |
| To be depolluted | 3                 | Cables   | 72            |             |

## Product description

|                                   |   |
|-----------------------------------|---|
| Manufacturer identification       | Schneider Electric Industries SAS   |
| Brand name                        | Schneider Electric  |
| Product function                  | BSCM Modbus SL/ULP for ComPacT NSX is used to acquire device status indications and control the communicating remote-control function and it serves as a converter between the analog outputs of the device indication contacts (O/F, SD, SDE) and the digital communicating functions. It is needed for communication of status indications, controls and measurements. The BSCM Modbus SL/ULP is installed inside the circuit breaker behind the front cover. It is connected to external Ethernet or Modbus interfaces (IFE/IFM) via the NSX cord terminal block and also can be connected to Modbus gateways via the Modbus SL Hub. |
| Product reference                 | LV434220  |
| Total representative product mass | 93 g  |
| Representative product dimensions | 34mm X 28mm X 30mm  |
| Accessories                       | Yes   |
| Date of information release       | 05-2025   |

## Additional information

|  |  |
|--|--|
| Legal information  | This product family is in the scope of European Union directive 2012/19/EU on Waste Electrical and Electronic Equipment (WEEE). The product family must be disposed according to the legislation of the country. This document is intended for use by end of life recyclers or treatment facilities. It provides the basic information to assure an appropriate end of life treatment for the components and materials of the product. |
| In case of special transportation: transportation method | No   |
| Recyclability potential                                  | <b>40%</b> The recyclability rate was calculated from the recycling rates of each material making up the product based on REEECYLAB tool developed by Ecosystem, for components/materials not covered by the tool, data from the EIME database and the related PSR was taken. If no data was found a conservative assumption was used (0% recyclability).  |

Schneider Electric Industries SAS

Country Customer Care Center  
<http://www.se.com/contact>

35, rue Joseph Monier

CS 30323

F- 92500 Rueil Malmaison Cedex

RCS Nanterre 954 503 439

Capital social 928 298 512 €

[www.se.com](http://www.se.com)

ENVEOLI2405003\_V2

Published by Schneider Electric

© 2023 - Schneider Electric – All rights reserved

05-2025