

Product End of Life Instructions

CONTROLLER PROFIBUS 1,35 27A 24VDC

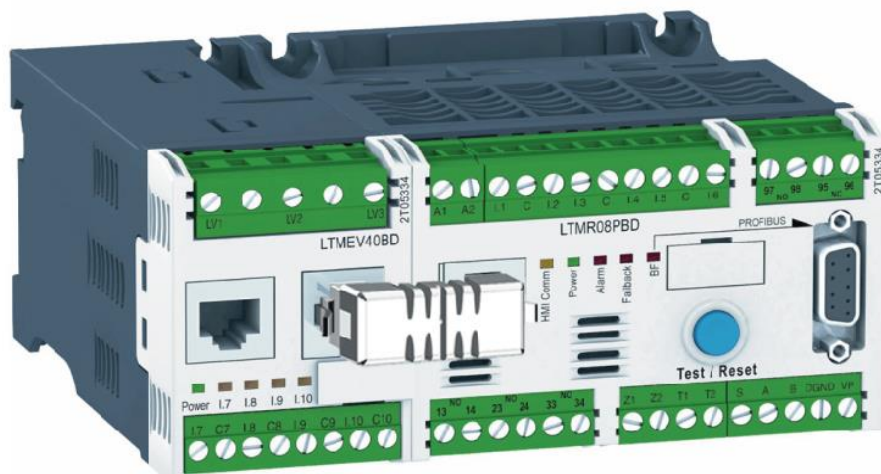



Potential disassembly risks

⚠ WARNING

HAZARD OF ELECTRIC SHOCK, EXPLOSION, AND FIRE

The Ethernet cable and Ethernet knockout cable that come with the Schneider Energy Monitor package are 600V-rated. If additional Ethernet cables are required they must be Power over Ethernet (PoE) CAT5E 600 V-rated cable (SEMONITORMTM or similar).

Failure to follow these instructions can result in death, serious injury, or equipment damage.



End of Life Instructions

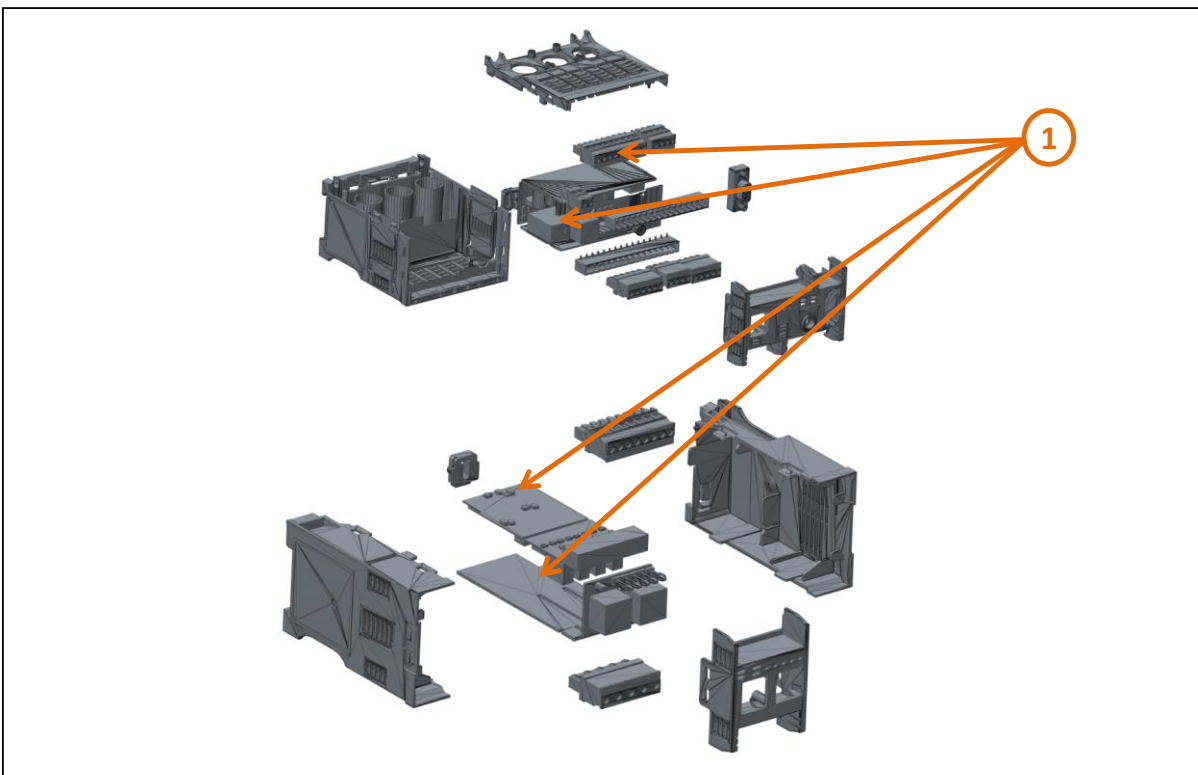

Recommendation	Number on drawing	Component / Material	Weight (in g)	Comment
To be depolluted	1	PCBA	354.07	PCBA_LTMR27PBD_MAIN, LTMRXXXPBD_FRONT, LTME40XX_UP & LTME40BD_DOWN

Product description

Manufacturer identification	Schneider Electric Industries SAS
Brand name	Schneider Electric
Product function	The product is a CONTROLLER PROFIBUS 1,35 27A 24VDC performs protection, measurement and supervision functions for single-phase and three-phase AC motors at constant speed in motor management system.
Product reference	LTMR27PBD
Total representative product mass	740 g
Representative product dimensions	72 x 136 x 100
Accessories	No
Date of information release	10-2025

Additional information

Legal information	This product family is in the scope of European Union directive 2012/19/EU on Waste Electrical and Electronic Equipment (WEEE). The product family must be disposed according to the legislation of the country. This document is intended for use by end of life recyclers or treatment facilities. It provides the basic information to assure an appropriate end of life treatment for the components and materials of the product.
In case of special transportation: transportation method	No
Recyclability potential	1% The recyclability rate was calculated from the recycling rates of each material making up the product based on REEECY'LAB tool developed by Ecosystem, for components/materials not covered by the tool, data from the EIME database and the related PSR was taken. If no data was found a conservative assumption was used (0% recyclability).

Schneider Electric Industries SAS

Country Customer Care Center
<http://www.se.com/contact>

35, rue Joseph Monier
 CS 30323
 F- 92500 Rueil Malmaison Cedex
 RCS Nanterre 954 503 439
 Capital social 928 298 512 €

www.se.com

ENVEOLI060308_V3

Published by Schneider Electric

© 2023 - Schneider Electric – All rights reserved

10-2025