

# Product End of Life Instructions

## VIGILOHM 12CH. LOCATOR 110-440VAC/DC (Without Display)





Potential disassembly risks

**⚠ WARNING**

**HAZARD OF ARC FLASH OR FIRE**

- Disconnect battery terminals before disassembly
- Avoid any electrical connection between the terminals

**Failure to follow these instructions can result in death or serious injury.**



End of Life Instructions

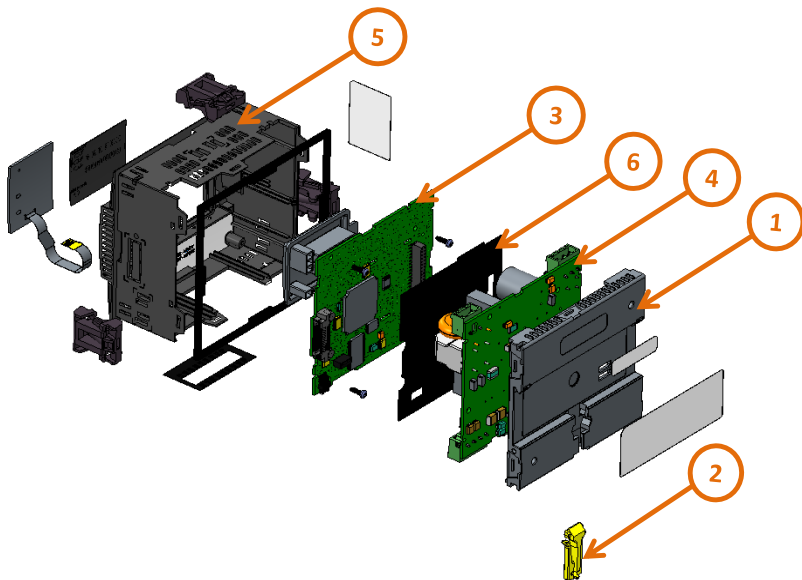

Recommendation	Number on drawing	Component / Material	Weight (in g)	Comment
To be depolluted	1	HOUSING, BACK - GREY	29.106	
To be depolluted	2	LOCKING CLIP	1.338	
To be depolluted	3	IFL_12_DIGITAL_PCBA	47.353	
To be depolluted	4	IFL12_PSU_PCBA	134.45	
To be depolluted	5	HOUSING, FRONT - GREY IFL	65.06	
To be depolluted	6	DIELECTRIC SHIELD PSU	2.54	

## Product description

Manufacturer identification	Schneider Electric Industries SAS
Brand name	Schneider Electric
Product function	<p>IFL is an insulation fault locating device with 12 channel for ungrounded power systems with isolated neutral.</p> <p>It works with Insulation monitoring device which detects that there is fault in the system and IFL locates where the fault has occurred in the system</p> <p>This device provides the following features:</p> <ul style="list-style-type: none"> <li>• Fast fault location (time &lt; 5 s).</li> <li>• Transient fault indication.</li> <li>• Relay for fault indication.</li> <li>• Transient capture using LED light</li> <li>• Configurable thresholds for alarm by manually</li> <li>• Configurable filtering times for highly disturbed ungrounded system.</li> <li>• Dedicated commissioning mode for quick installation verification.</li> <li>• Auto-detects and configures compatible toroids in commissioning mode.</li> </ul>
Product reference	IMDIFL12
Total representative product mass	333 g
Representative product dimensions	108mm x 110mm x 59mm
Date of information release	10-2025

## Additional information

Legal information	The product family must be disposed according to the legislation of the country. This document is intended for use by end of life recyclers or treatment facilities. It provides the basic information to assure an appropriate end of life treatment for the components and materials of the product.
Recyclability potential	<p><b>4%</b></p> <p>The recyclability rate was calculated from the recycling rates of each material making up the product based on REEECY'LAB tool developed by Ecosystem, for components/materials not covered by the tool, data from the EIME database and the related PSR was taken. If no data was found a conservative assumption was used (0% recyclability).</p>

Schneider Electric Industries SAS  
Country Customer Care Center  
<http://www.se.com/contact>  
35, rue Joseph Monier  
CS 30323  
F- 92500 Rueil Malmaison Cedex  
RCS Nanterre 954 503 439  
Capital social 928 298 512 €

[www.se.com](http://www.se.com)

ENVEOLI2509024\_V1

Published by Schneider Electric

© 2023 - Schneider Electric – All rights reserved

10/2025