

Product End of Life Instructions

Altivar Soft Starter ATS490 75A





Potential disassembly risks

The information provided in this document assumes that the product is completely de-energized and uninstalled (refer to the instructions provided in the appropriate product manuals).

Dismantling/disassembling the product may entail hazards caused by, for example, sharp edges, chemical aggression or ejected parts.

⚠ WARNING

HAZARD DUE TO INSUFFICIENT PROTECTION

- Implement all safety measures required by the applicable regulations and by the processes used to dismantle/disassemble and dispose of the product.
- Use all necessary personal protective equipment such as gloves and goggles.

Failure to follow these instructions can result in death or serious injury.

End of Life Instructions

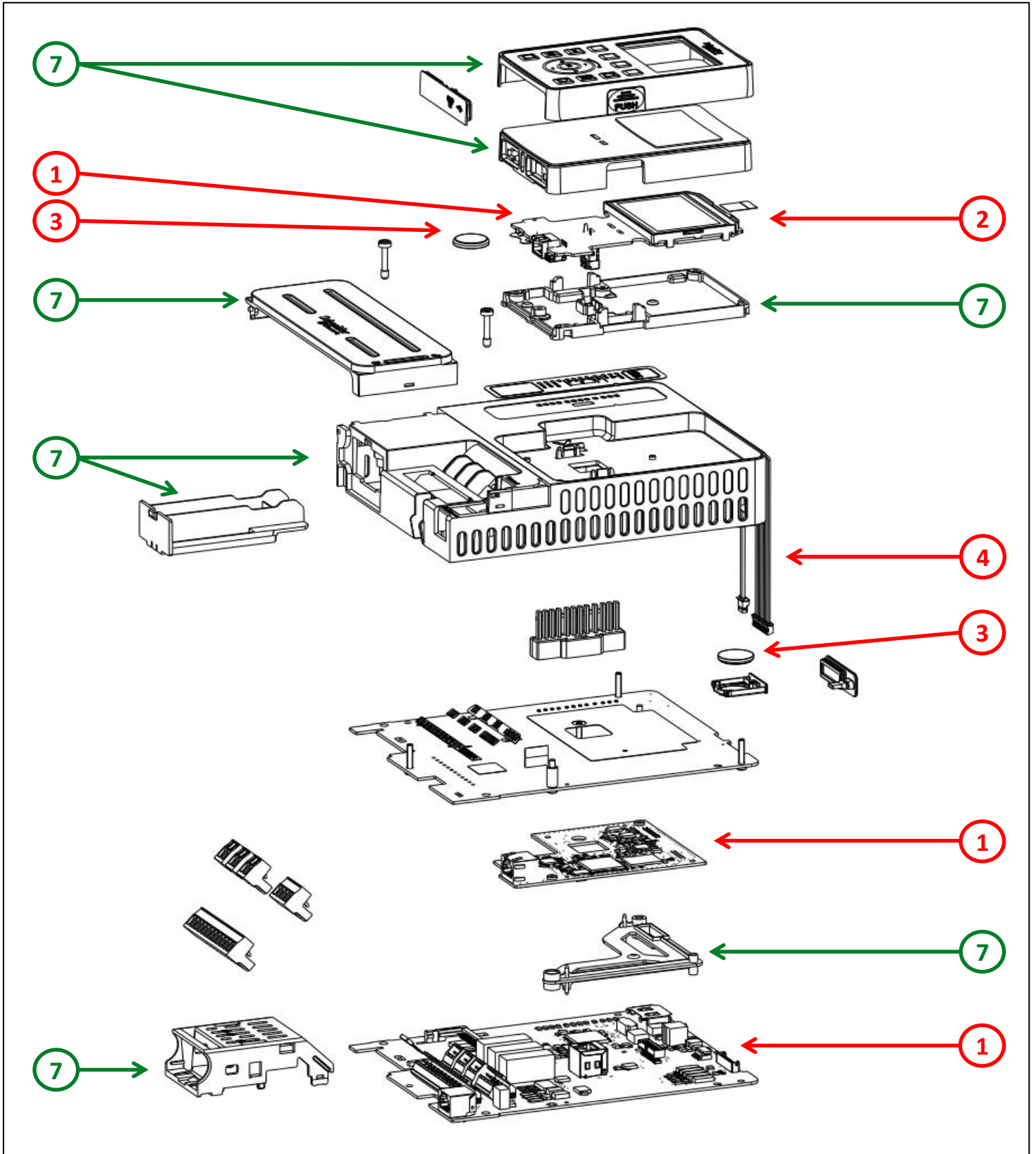

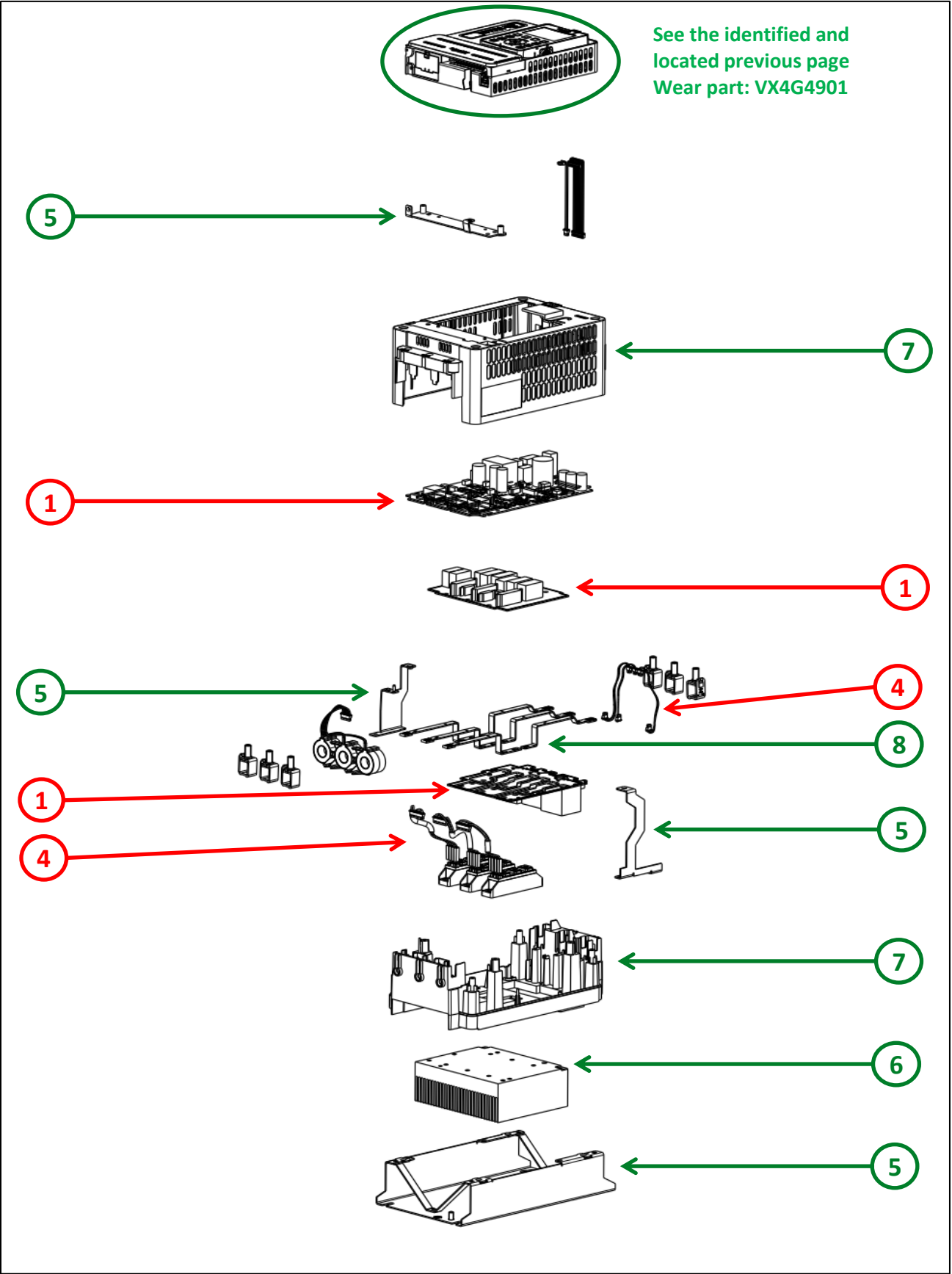

Recommendation	Number on drawing	Component / Material	Weight (in g)	Comment
To be depolluted	1	Electronic Board (Power and Communication) > 10cm²	807,2	
To be depolluted	2	LCD and all those back-lighted with gas discharge lamps	25,0	
To be depolluted	3	Other battery	5,8	2 batteries with each a lithium content of 0,07 g
To be depolluted	4	Cable (high current)	30,1	
To be dismantled	5	Steel	1058,4	Main frame, Support, Front cover and Hood
To be dismantled	6	Aluminium	2319,4	Heatsink
To be dismantled	7	PC, ABS-PC, PA, PA6, HDPE, SAN with or without additive, PP+EPDM and PP	1013,6	Support, Cover, Housing, Gasket and Control door
To be dismantled	8	Copper	277,2	Bar
Other			1963,3	

Product description

Manufacturer identification	Schneider Electric Industries SAS
Brand name	Schneider Electric
Product function	The main function of the Altivar Soft Starter product range is primarily to intend for the soft starting and breaking of the rotational speed of an asynchronous electric motor for heavy duty industry and pumps.
Product reference	ATS490D75Y
Additional similar product references	ATS490D75Y ATS490D66Y
Total representative product mass	7500 g
Representative product dimensions	275 mm x 160 mm x 234 mm
Accessories	No accessories needed.
Date of information release	01/06/2024

Additional information

Legal information	This product family is in the scope of European Union directive 2012/19/EU on Waste Electrical and Electronic Equipment (WEEE). The product family must be disposed according to the legislation of the country. This document is intended for use by end of life recyclers or treatment facilities. It provides the basic information to assure an appropriate end of life treatment for the components and materials of the product.	
In case of special transportation: transportation method	No special transportation.	
Recyclability potential	77%	The recyclability rate was calculated from the recycling rates of each material making up the product based on REEECY'LAB tool developed by Ecosystem, for components/materials not covered by the tool, data from the EIME database and the related PSR was taken. If no data was found a conservative assumption was used (0% recyclability).

Schneider Electric Industries SAS

Country Customer Care Center
<http://www.se.com/contact>

35, rue Joseph Monier
CS 30323
F- 92500 Rueil Malmaison Cedex
RCS Nanterre 954 503 439
Capital social 928 298 512 €

www.se.com

ENVEOLI2309012_V1

Published by Schneider Electric

© 2023 - Schneider Electric – All rights reserved

01/06/2024