

# Product End of Life Instructions

**Altivar Soft Starter ATS430 47A**

**Altivar Soft Starter ATS430**

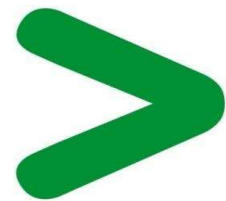



## Potential disassembly risks

The information provided in this document assumes that the product is completely de-energized and uninstalled (refer to the instructions provided in the appropriate product manuals).

Dismantling/disassembling the product may entail hazards caused by, for example, sharp edges, chemical aggression or ejected parts.

### ⚠ WARNING

#### HAZARD DUE TO INSUFFICIENT PROTECTION

- Implement all safety measures required by the applicable regulations and by the processes used to dismantle/disassemble and dispose of the product.
  - Use all necessary personal protective equipment such as gloves and goggles.
- Failure to follow these instructions can result in death or serious injury.



## End of Life Instructions

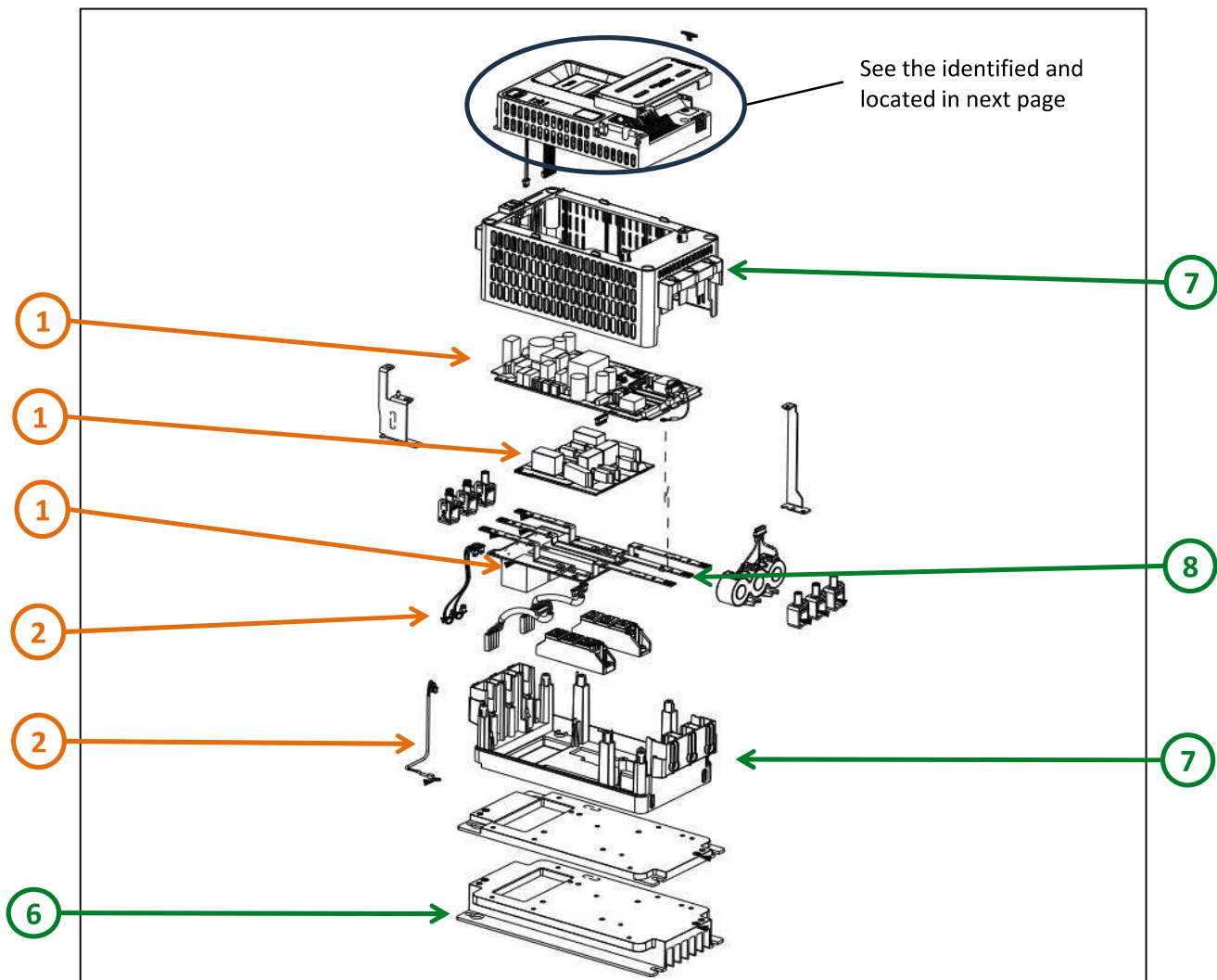

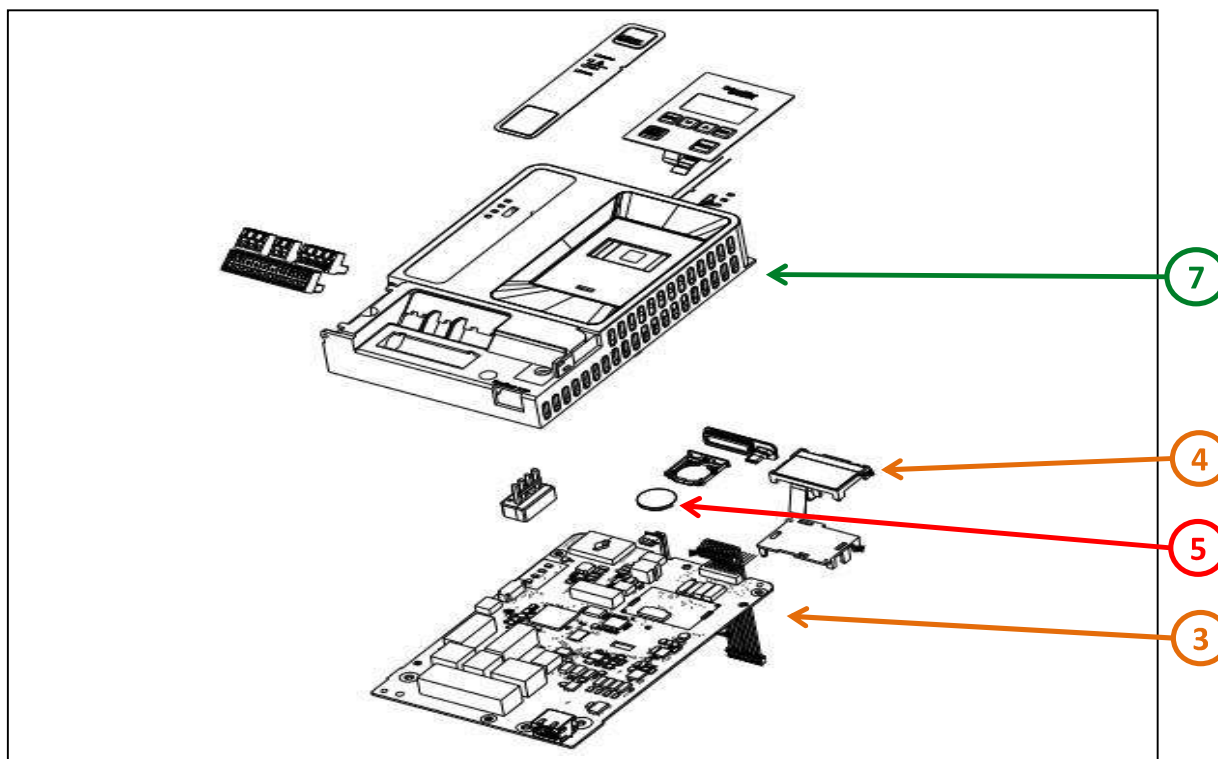

Recommendation	Number on drawing	Component / Material	Weight (in g)	Comment
To be depolluted	1	Electronic Board (Power) > 10cm <sup>2</sup>	204.87	2×PCBAs
To be depolluted	2	Cable (high current)	15.96	Cables
To be depolluted	3	Electronic Board (Communication) > 10cm <sup>2</sup>	95.66	1×PCBA
To be depolluted	4	LCD (surface > 100cm <sup>2</sup> ) and all those back-lighted with gas discharge lamps	25.00	LCD Screen
Potential hazards	5	Battery	3.00	Battery
To be dismantled	6	Aluminum	1258.34	Heatsink
To be dismantled	7	PC	644.88	Chassis、Housing
To be dismantled	8	Copper	99.43	Copper Bar
Other			1052.86	Except of the above parts

## Product description

Manufacturer identification	Schneider Electric Industries SAS
Brand name	Schneider Electric
Product function	The main function of the Altivar Soft Starter ATV430 is primarily to intend for the soft starting and breaking of the rotational speed of an asynchronous motor for normal duty industry.
Product reference	ATS430D47S6
Additional similar product references	ATS430D17S6 ATS430D32S6
Total representative product mass	3400 g
Representative product dimensions	130mm x 194mm x 273 mm
Accessories	No accessories needed.
Date of information release	05-2024

## Additional information

<b>Legal information</b>	This product family is in the scope of European Union directive 2012/19/EU on Waste Electrical and Electronic Equipment (WEEE). The product family must be disposed according to the legislation of the country. This document is intended for use by end of life recyclers or treatment facilities. It provides the basic information to assure an appropriate end of life treatment for the components and materials of the product.	
<b>In case of special transportation: transportation method</b>	No special transportation.	
<b>Recyclability potential</b>	<b>57%</b>	Recyclability rate has been calculated based on REEECYLAB tool developed by Ecosystem, for components/materials not covered by the tool, data from the "ECO' DEEE recyclability and recoverability calculation method" was taken. If no data was found a conservative assumption was used (0% recyclability).

Schneider Electric Industries SAS  
Country Customer Care Center  
<http://www.se.com/contact>  
35, rue Joseph Monier  
CS 30323  
F- 92500 Rueil Malmaison Cedex  
RCS Nanterre 954 503 439  
Capital social 928 298 512 €

[www.se.com](http://www.se.com)

Published by Schneider Electric

ENVEOLI2301004\_V1

© 2023 - Schneider Electric – All rights reserved

06-2024