

Product End of Life Instructions

Altivar Soft Starter ATS430 410A

Altivar Soft Starter ATS430

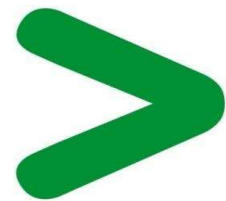



Potential disassembly risks

The information provided in this document assumes that the product is completely de-energized and uninstalled (refer to the instructions provided in the appropriate product manuals).

Dismantling/disassembling the product may entail hazards caused by, for example, sharp edges, chemical aggression or ejected parts.

⚠ WARNING

HAZARD DUE TO INSUFFICIENT PROTECTION

- Implement all safety measures required by the applicable regulations and by the processes used to dismantle/disassemble and dispose of the product.
- Use all necessary personal protective equipment such as gloves and goggles.

Failure to follow these instructions can result in death or serious injury.



End of Life Instructions

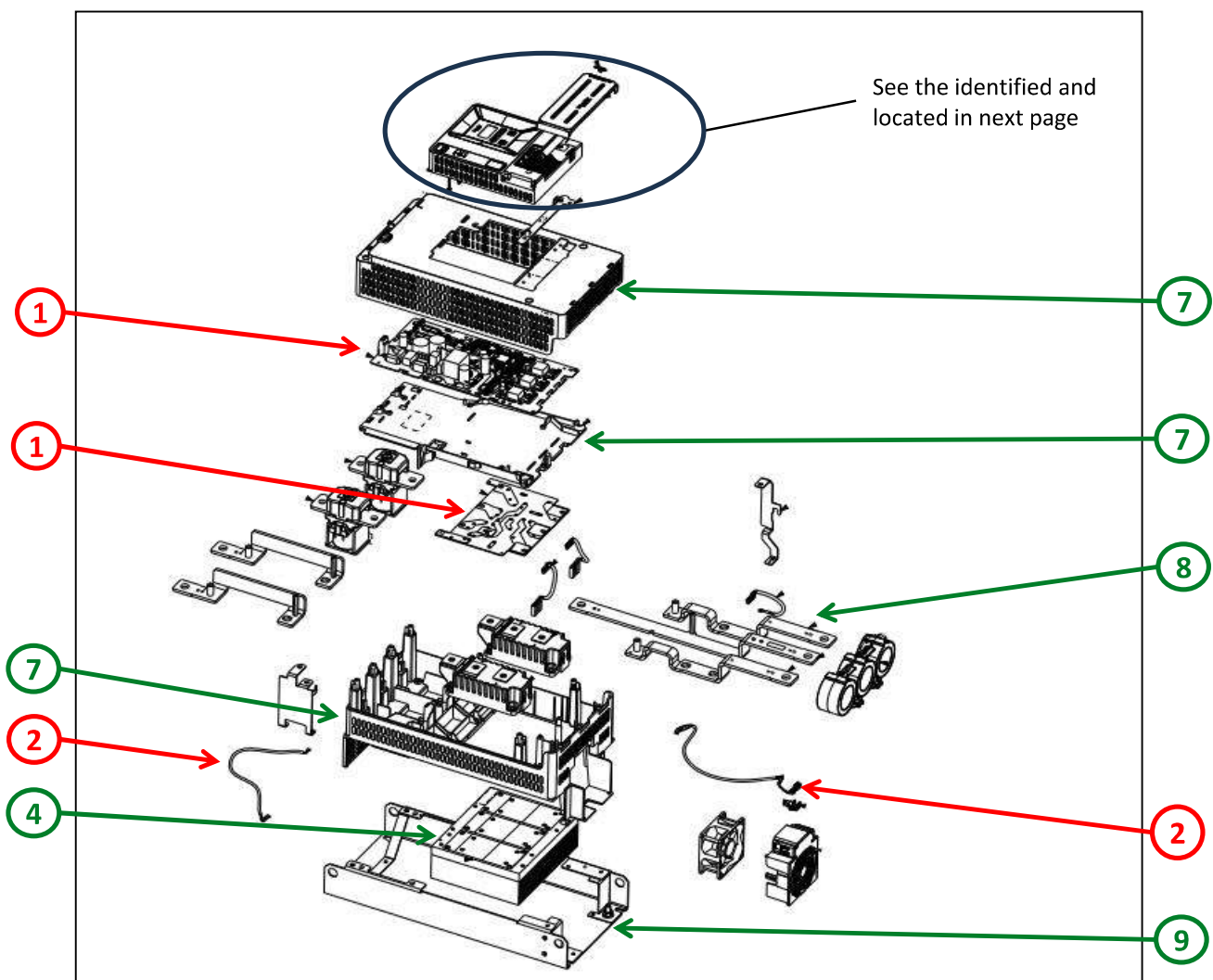

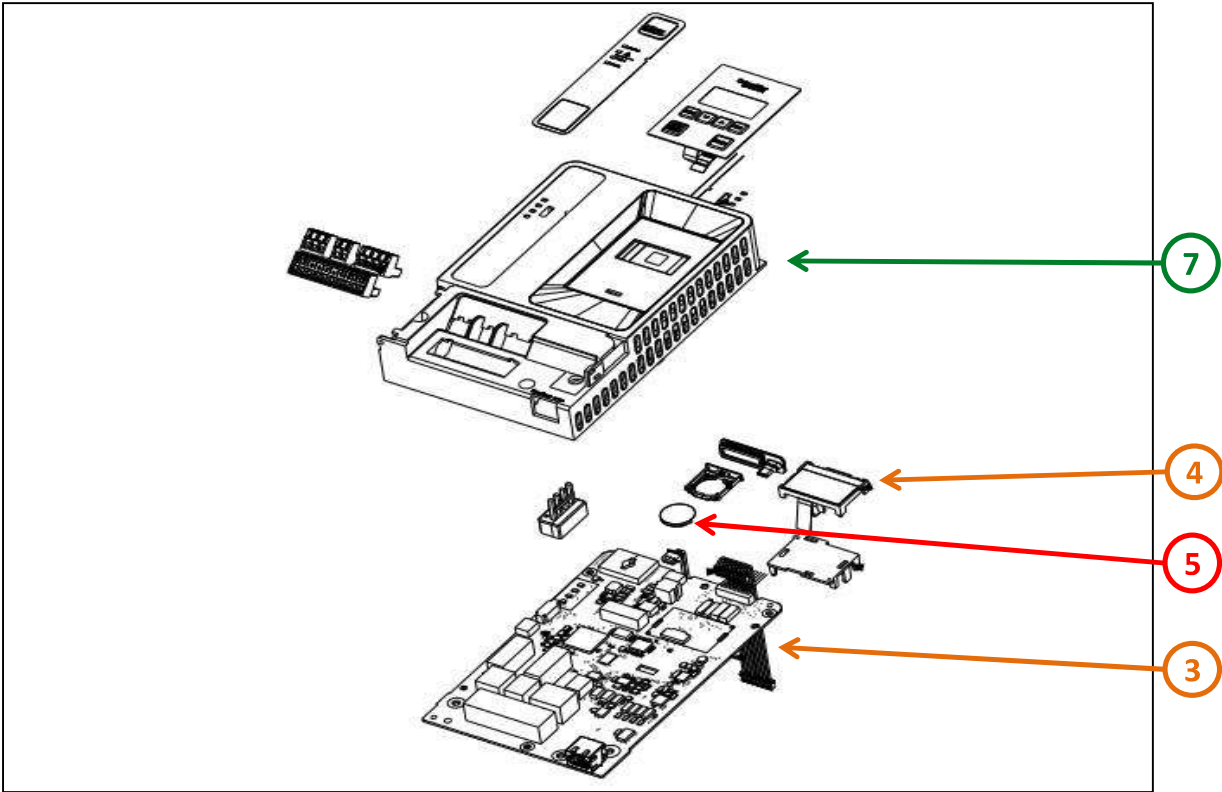

Recommendation	Number on drawing	Component / Material	Weight (in g)	Comment
To be depolluted	1	Electronic Board (Power) > 10cm²	30.44	2×PCBAs
To be depolluted	2	Cable (high current)	230.91	Cables
To be depolluted	3	Electronic Board (Communication) > 10cm²	95.66	1×PCBA
To be depolluted	4	LCD (surface > 100cm²) and all those back-lighted with gas discharge lamps	25.00	LCD Screen
Potential hazards	5	Battery	3.00	Battery
To be dismantled	6	Aluminum	2961.39	Heatsink
To be dismantled	7	PC	1978.46	Chassis、Housing
To be dismantled	8	Copper	2632.3	Copper Bar
To be dismantled	9	Steel	2578.91	Lower Housing
Other			7,563.93	Except of the obove parts

Product description

Manufacturer identification	Schneider Electric Industries SAS
Brand name	Schneider Electric
Product function	The main function of the Altivar Soft Starter ATV430 is primarily to intend for the soft starting and breaking of the rotational speed of an asynchronous motor for normal duty industry.
Product reference	ATS430C41S6
Additional similar product references	ATS430C21S6 ATS430C25S6 ATS430C32S6
Total representative product mass	18100 g
Representative product dimensions	206mm x 261mm x 443 mm
Accessories	No accessories needed.
Date of information release	06-2024

Additional information

Legal information	This product family is in the scope of European Union directive 2012/19/EU on Waste Electrical and Electronic Equipment (WEEE). The product family must be disposed according to the legislation of the country. This document is intended for use by end of life recyclers or treatment facilities. It provides the basic information to assure an appropriate end of life treatment for the components and materials of the product.	
In case of special transportation: transportation method	No special transportation.	
Recyclability potential	55%	Recyclability rate has been calculated based on REEECY [®] LAB tool developed by Ecosystem, for components/materials not covered by the tool, data from the “ECO’ DEEE recyclability and recoverability calculation method” was taken. If no data was found a conservative assumption was used (0% recyclability).

Schneider Electric Industries SAS
Country Customer Care Center
<http://www.se.com/contact>
35, rue Joseph Monier
CS 30323
F- 92500 Rueil Malmaison Cedex
RCS Nanterre 954 503 439
Capital social 928 298 512 €

www.se.com

ENVEOLI2301007_V1

Published by Schneider Electric

© 2023 - Schneider Electric – All rights reserved

06-2024