

Product End of Life Instructions

**Control unit MicroLogic 6.0E, MasterPact NT/NW, selective and
Representative of all MasterPacT NT/NW & ComPacT NS Control
Units**

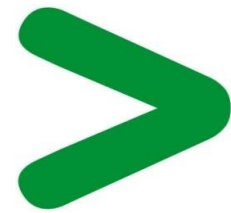

End of Life Instructions

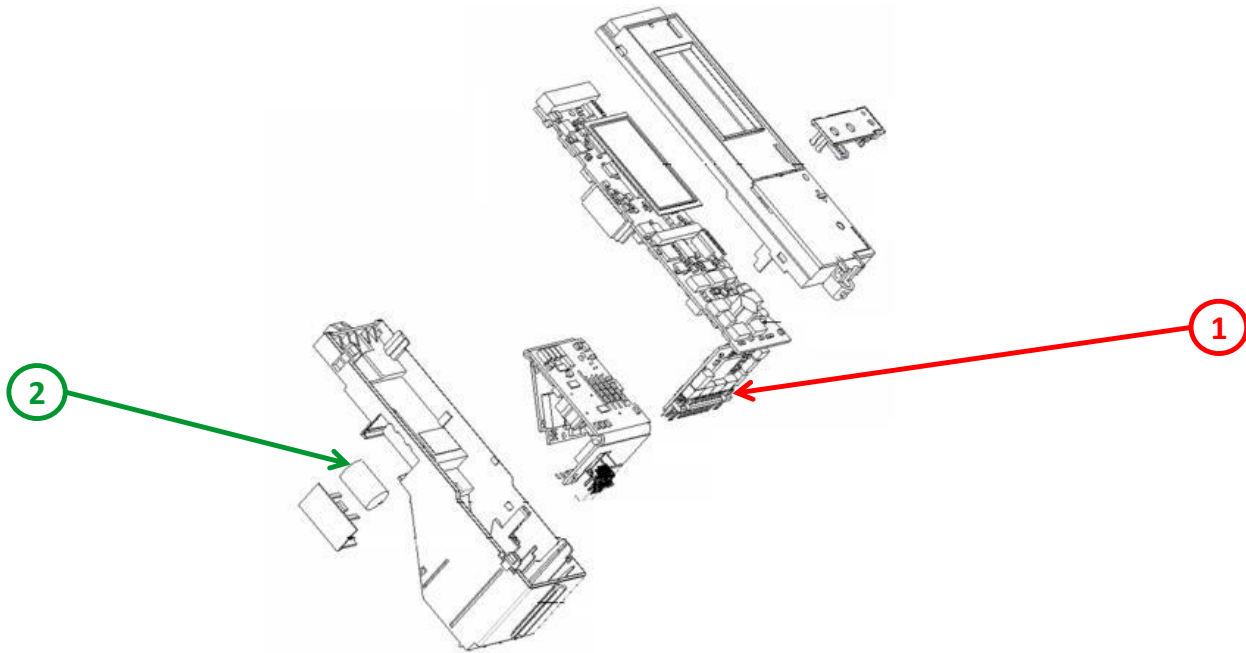

Recommendation	Number on drawing	Component / Material	Weight (in g)	Comment
To be depolluted	1	Electronic Board (Communication) > 10cm ²	90,6	PCBAs
Potential hazards	2	Electronic Board (Communication) > 10cm ²	9,6	Battery LI/SOCL2

Product description

Manufacturer identification	Schneider Electric Industries SAS
Brand name	Schneider Electric
Product function	<p>MasterPact NT/NW circuit breakers are designed to guarantee the protection of a low voltage electrical distribution system (industrial) with assigned voltage up to 690V AC and rated current up to 6300A. This protection is ensured thanks to the monitoring, control and action of the MicroLogic control units.</p> <p>The MicroLogic 6.0E control unit is a LSIG protection type control unit that offers 4 basic protection functions and some advanced protections:</p> <ul style="list-style-type: none"> * L = long time protection against overloads * S = short time protection against short-circuits * I = instantaneous protection against short-circuits * G = ground fault protection * Additional measurement = energy
Product reference	47603

Additional similar product references	47603 33021 33069 33070 33071 33072 33073 33074 33504 33504VS 33505 33511 33512 33513 33514 33515 33525 33531 33532 33533 33534 33535 33536 33537 33538 33539 33540 34471 34472 34473 34474 34475 34476 34480 35013 35053 35054 35055 35056 35057 35058 35059 35060 35061 35062 35063 35064 35065 35066 35067 35068 35069 35070 35071 35072 35080 47058 47059 47060 47061 47062 47063 47073 47280 47281 47282 47283 47284 47285 47286 47287 47288 47289 47290 47291 47292 47293 47294 47295 47297 47298 47299 47301 47302 47303 47600 47602 48358 48360 48361 48362 48363 48364 48365 48366 48367 48368 48498 48499 48500 48640 64883 65266 65267 65268 65269 65270 65271 65272 65273 65274 65275 65276 65277 65278 65279 65280 65281 65282 65283 65290 65291 65292 65293 65294 65295 65296 65297 65298 65299 65300 65301 65302 65303 65304 65305 65306 65307 65447 C20FM C20WM C2AFM C2AWM C2EFM C2EWM C33021 C50FM C50WM C5AFM C5AWM C5EFM C5EWM C5PFM C5PWM C60FM C60WM C6AFM C6AWM C6EFM C6EWM C6PFM C6PWM C7AFM C7AWM C7PFM C7PWM
Total representative product mass	216 g
Representative product dimensions	80mm x 218mm x 68mm
Accessories	No
Date of information release	11-2024

Additional information

Legal information	This product family is in the scope of European Union directive 2012/19/EU on Waste Electrical and Electronic Equipment (WEEE). The product family must be disposed according to the legislation of the country. This document is intended for use by end of life recyclers or treatment facilities. It provides the basic information to assure an appropriate end of life treatment for the components and materials of the product.
In case of special transportation: transportation method	No
Recyclability potential	3% The recyclability rate was calculated from the recycling rates of each material making up the product based on REEECY'LAB tool developed by Ecosystem, for components/materials not covered by the tool, data from the EIME database and the related PSR was taken. If no data was found a conservative assumption was used (0% recyclability).

Schneider Electric Industries SAS

Country Customer Care Center
<http://www.se.com/contact>

35, rue Joseph Monier
CS 30323
F- 92500 Rueil Malmaison Cedex
RCS Nanterre 954 503 439
Capital social 928 298 512 €

www.se.com

ENVEOLI2408039_V1

Published by Schneider Electric

© 2023 - Schneider Electric – All rights reserved

11-2024