

# Product End of Life Instructions

## Modicon TM3 Expert Counter Module - TM3XF/H







## Potential disassembly risks

### ⚠ WARNING

#### HAZARD OF ARC FLASH OR FIRE

- Disconnect battery terminals before disassembly
- Avoid any electrical connection between the terminals

**Failure to follow these instructions can result in death or serious injury.**



## End of Life Instructions

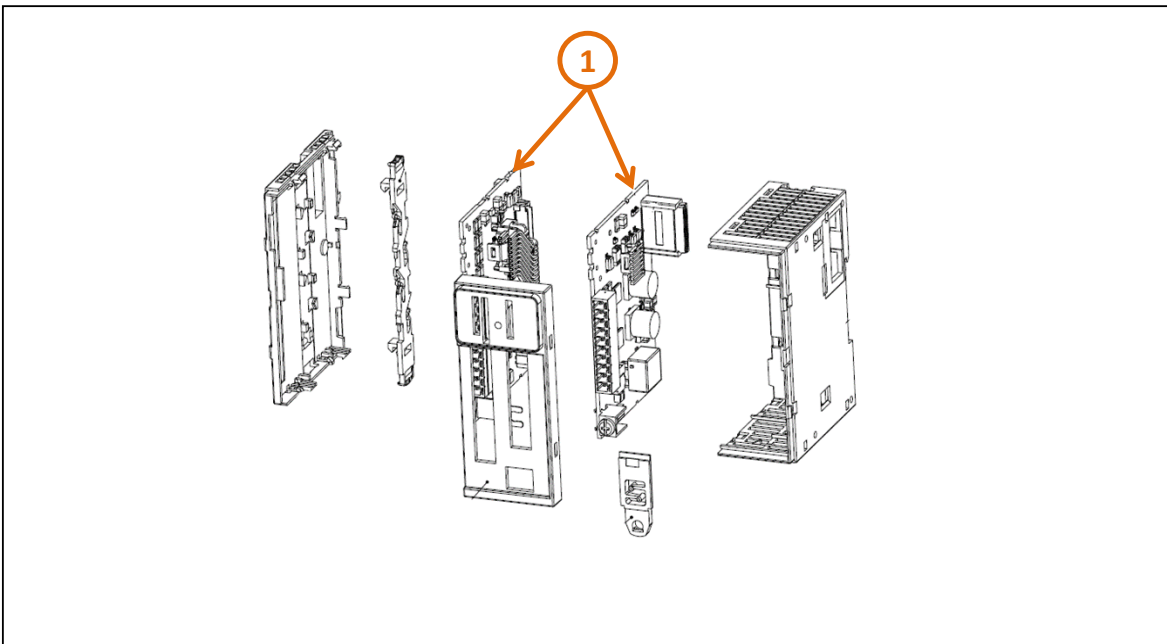

Recommendation	Number on drawing	Component / Material	Weight (in g)	Comment
To be depolluted	1	Electronic Boards	104.53302	PCBA





## Product description

Manufacturer identification	Schneider Electric Industries SAS
Brand name	Schneider Electric
Product function	This product is part of Modicon TM3, a range of expansion I/O modules for Modicon plcs. This counter module provides 10 fast inputs and 8 fast outputs. It is a high-speed counter with reflex output management and event management. It is used to count the pulses generated by a sensor or to process signals from an incremental encoder. Its counting frequency is 200kHz. It works via a 24VDC external power supply.
Product reference	TM3XFHSC202
Additional similar product references	TM3XHSC202 TM3XFHSC202G TM3XHSC202G
Total representative product mass	150 g
Representative product dimensions	88mm x 39mm x 73mm
Accessories	No
Date of information release	11-2024



## Additional information

Legal information	This product family is in the scope of European Union directive 2012/19/EU on Waste Electrical and Electronic Equipment (WEEE). The product family must be disposed according to the legislation of the country. This document is intended for use by end of life recyclers or treatment facilities. It provides the basic information to assure an appropriate end of life treatment for the components and materials of the product.	
In case of special transportation: transportation method	No	
Recyclability potential	0.5%	Recyclability rate has been calculated based on REEECY'LAB tool developed by Ecosystem, for components/materials not covered by the tool, data from the "ECO'DEEE recyclability and recoverability calculation method" was taken. If no data was found a conservative assumption was used (0% recyclability).

Schneider Electric Industries SAS  
Country Customer Care Center  
<http://www.se.com/contact>  
35, rue Joseph Monier  
CS 30323  
F- 92500 Rueil Malmaison Cedex  
RCS Nanterre 954 503 439  
Capital social 928 298 512 €

[www.se.com](http://www.se.com)

ENVEOLI1904007\_V2

Published by Schneider Electric

© 2023 - Schneider Electric – All rights reserved

11-2024