

Product End of Life Instructions

Logic Controller - Modicon M251





Potential disassembly risks

⚠ WARNING

HAZARD OF ARC FLASH OR FIRE

- Disconnect battery terminals before disassembly
- Avoid any electrical connection between the terminals

Failure to follow these instructions can result in death or serious injury.



End of Life Instructions

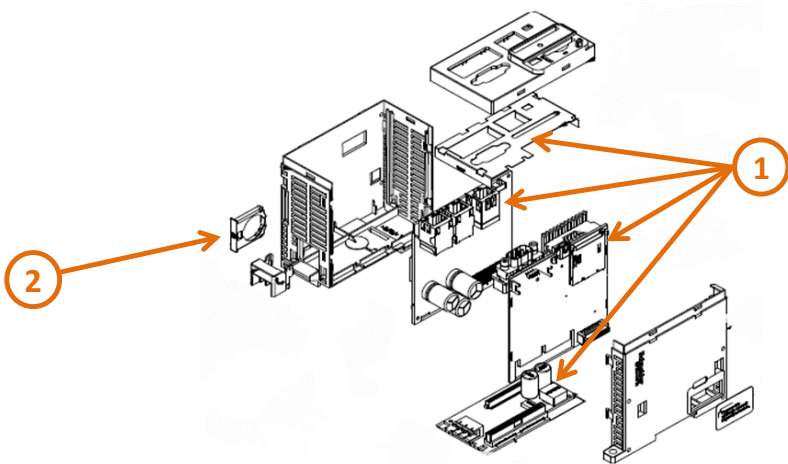

Recommendation	Number on drawing	Component / Material	Weight (in g)	Comment
To be depolluted	1	Electronic Board	141.319821	PCBA
To be depolluted	2	Battery	2.5	Coin-type battery



Product description

Manufacturer identification	Schneider Electric Industries SAS
Brand name	Schneider Electric
Product function	The main purpose of the Modicon M251 Logic Controller is to provide a new range modular Logic Controller which provide field bus such as Ethernet, CAN Open with Ethernet Switch embedded.
Product reference	TM251MESC
Additional similar product references	TM251MESE TM251MDESE
Total representative product mass	220 g
Representative product dimensions	110 mm x 54 mm x 97.3 mm
Accessories	No
Date of information release	11-2024



Additional information

Legal information	This product family is in the scope of European Union directive 2012/19/EU on Waste Electrical and Electronic Equipment (WEEE). The product family must be disposed according to the legislation of the country. This document is intended for use by end of life recyclers or treatment facilities. It provides the basic information to assure an appropriate end of life treatment for the components and materials of the product.	
In case of special transportation: transportation method	No	
Recyclability potential	11%	Recyclability rate has been calculated based on REEECY'LAB tool developed by Ecosystem, for components/materials not covered by the tool, data from the "ECO'DEEE recyclability and recoverability calculation method" was taken. If no data was found a conservative assumption was used (0% recyclability).

Schneider Electric Industries SAS

Country Customer Care Center
<http://www.se.com/contact>

35, rue Joseph Monier

CS 30323

F- 92500 Rueil Malmaison Cedex

RCS Nanterre 954 503 439

Capital social 928 298 512 €

www.se.com

Published by Schneider Electric

ENVEOLI1401009_V3

© 2023 - Schneider Electric – All rights reserved

11-2024