

Product End of Life Instructions

LT4000M Series

LT4000M

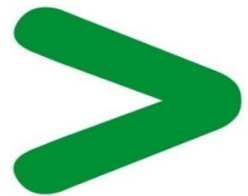

Pro-face
by Schneider Electric



Potential disassembly risks

The Circularity profile provides information about preparation for re-use and treatment. It identifies the relevant EEE components and materials as well as their location. Safety instructions for product dismantling and depollution are provided into the User manual or maintenance guide.

⚠ WARNING

HAZARD OF ARC FLASH OR FIRE

- Disconnect battery terminals before disassembly
- Avoid any electrical connection between the terminals

Failure to follow these instructions can result in death or serious injury.



End of Life Instructions

< Rear module Side >

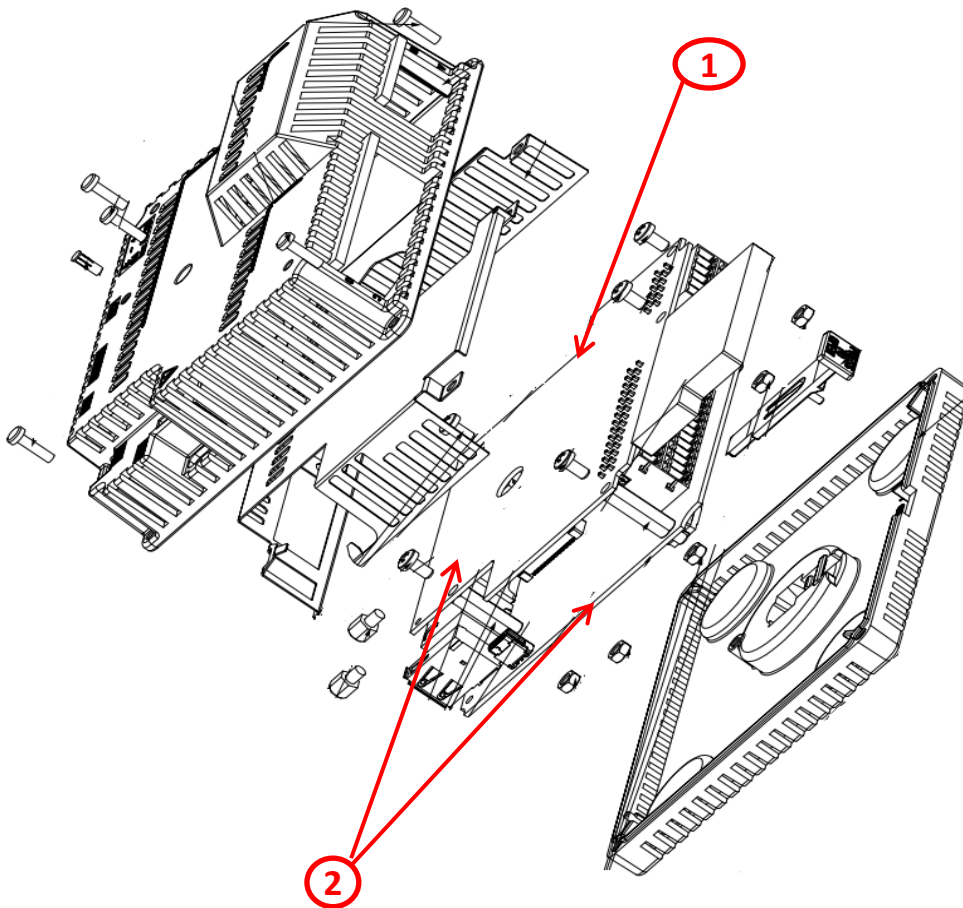

< Display module Side >

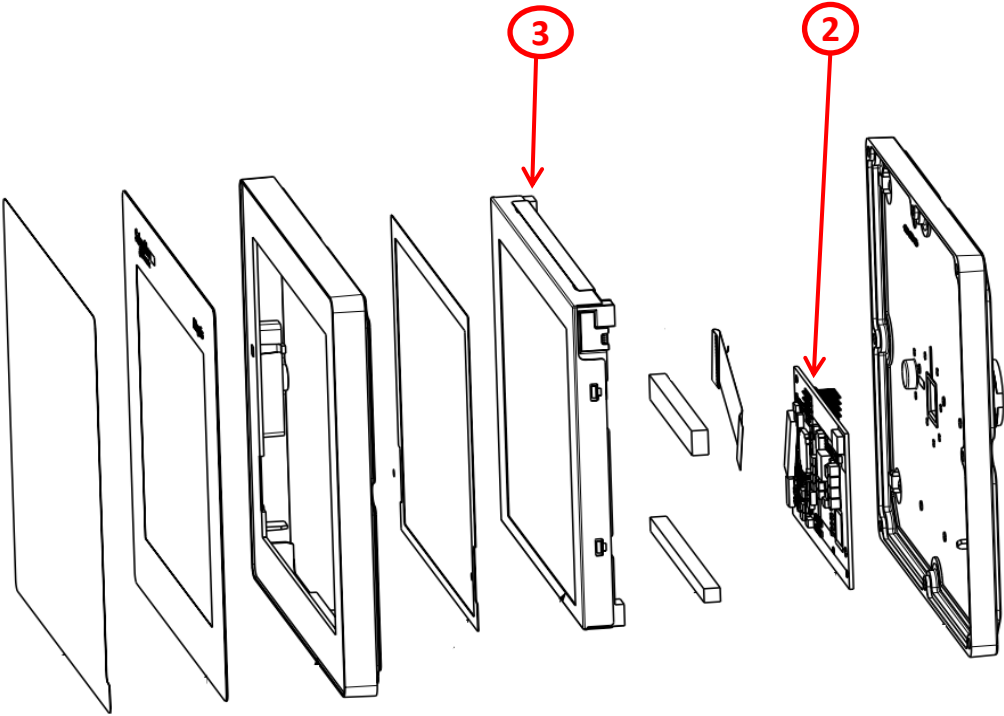

| Recommendation | Number on drawing | Component / Material | Weight (in g) | Comment |
|-------------------|-------------------|----------------------------------------------------------------------------|---------------|---------|
| Potential hazards | 1 | Batteries | 5 | |
| To be depolluted | 2 | Electronic Board (Communication) > 10cm² | 230.9 | PCBA |
| To be depolluted | 3 | LCD (surface > 100cm²) and all those back-lighted with gas discharge lamps | 165 | LCD |
| Other | | | 383.1 | |
| | | | | |
| | | | | |



Product description

| | |
|---------------------------------------|--------------------------------------------------------------------------------------------------------------------------------------------------------------|
| Manufacturer identification | Schneider Electric Industries SAS |
| Brand name | Pro-face by Schneider Electric |
| Product function | LT4000M is the touch controller panel with the HMI and I/O embedded. |
| Product reference | PFXLM4301TADAC |
| Additional similar product references | PFXLM4301TADAK PFXLM4201TADDC PFXLM4201TADDK PFXLM4301TADDC PFXLM4301TADDK PFXLM4B01DDC PFXLM4B01DDK PFXLM4201TADAC PFXLM4201TADAK PFXLM4B01DAC PFXLM4B01DAK |
| Total representative product mass | 784 g |
| Representative product dimensions | 129.4 x 163 x 76.22 |
| Accessories | No |
| Date of information release | 2023/12/01 |



Additional information

Legal information

This product family is in the scope of European Union directive 2012/19/EU on Waste Electrical and Electronic Equipment (WEEE). The product family must be disposed according to the legislation of the country. This document is intended for use by end of life recyclers or treatment facilities. It provides the basic information to assure an appropriate end of life treatment for the components and materials of the product.

Recyclability potential

7%

Recyclability rate has been calculated based on REEECY'LAB tool developed by Ecosystem, for components/materials not covered by the tool, data from the “ECO’ DEEE recyclability and recoverability calculation method” was taken. If no data was found a conservative assumption was used (0% recyclability).

Schneider Electric Industries SAS

Country Customer Care Center
<http://www.se.com/contact>

35, rue Joseph Monier
CS 30323
F- 92500 Rueil Malmaison Cedex
RCS Nanterre 954 503 439
Capital social 928 298 512 €

www.se.com

ENVEOLI2311049_V1

Published by Schneider Electric

© 2023 - Schneider Electric – All rights reserved

2023/12/01