

# Product End of Life Instructions

## PanelSeT TBP





## Potential disassembly risks

*No Risk for the disassembly in terms of electric shock.*



## End of Life Instructions

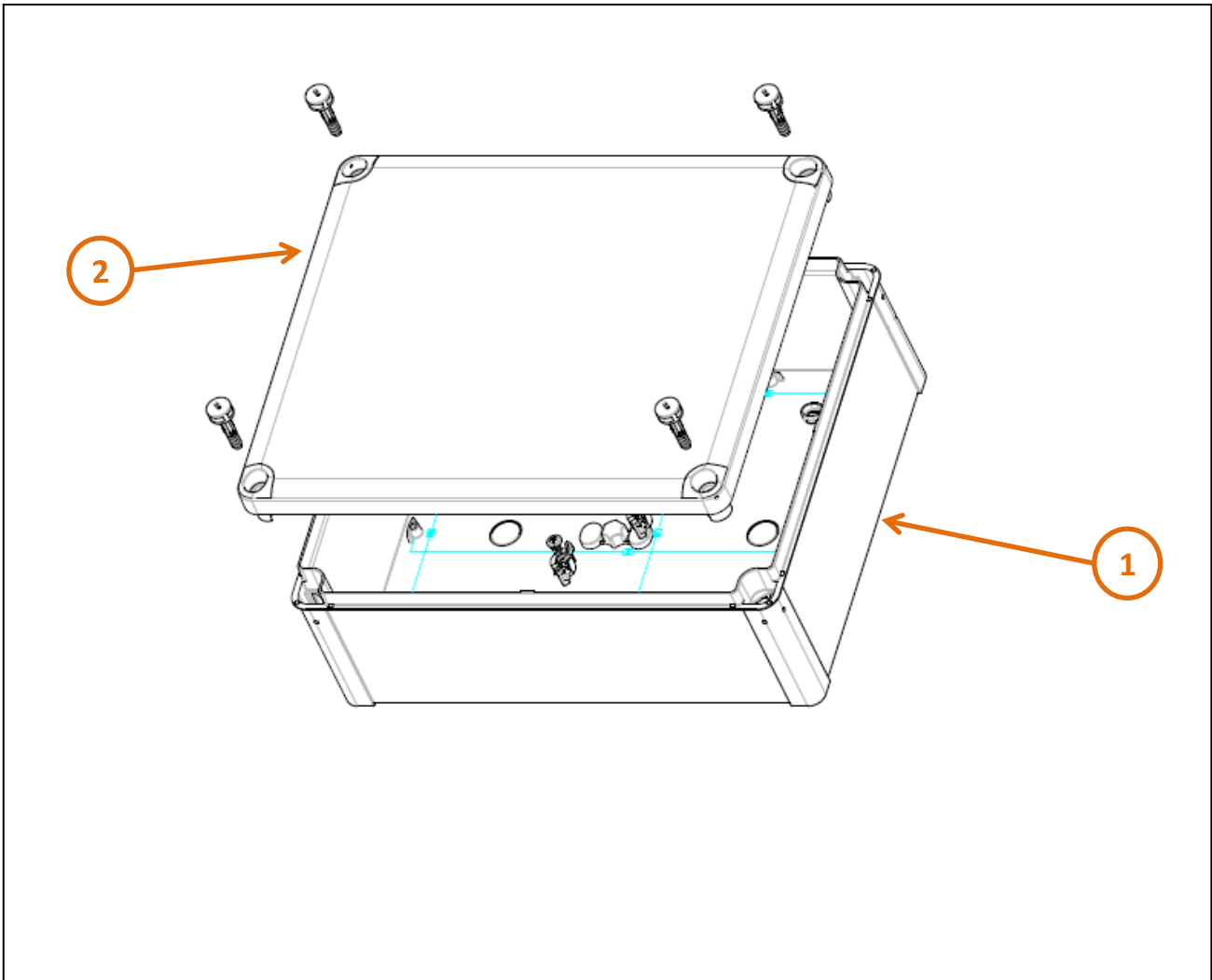

Recommendation	Number on drawing	Component / Material	Weight (in g)	Comment
To be depolluted	1	Plastic parts with Brominated FR	949 g	Body
To be depolluted	2	Plastic parts with Brominated FR	429.81 g	Cover

## Product description

Manufacturer identification	Schneider Electric Industries SAS
Brand name	Schneider Electric
Product function	PanelSeT TBP are polycarbonate class II insulated industrial boxes. The PanelSeT TBP series is a range of multifunction wall mounted, insulating, industrial enclosures that are easy to install using a flat screwdriver. The box provides 3 wall-mounting methods: directly by the holes on the base, by channels outside the sealed area or by fixing wrap-over clamps. The box have a rounded design which helps increase its robustness.
Product reference	NSYTBP342912
Total representative product mass	1435 g
Representative product dimensions	341mm x 291mm x 128mm
Date of information release	01-08-2024

## Additional information

Legal information	This product family is in the scope of European Union directive 2012/19/EU on Waste Electrical and Electronic Equipment (WEEE). The product family must be disposed according to the legislation of the country. This document is intended for use by end of life recyclers or treatment facilities. It provides the basic information to assure an appropriate end of life treatment for the components and materials of the product.	
Recyclability potential	<b>0.30%</b>	Recyclability rate has been calculated based on REEECY'LAB tool developed by Ecosystem, for components/materials not covered by the tool, data from the "ECO'DEEE recyclability and recoverability calculation method" was taken. If no data was found a conservative assumption was used (0% recyclability).

Schneider Electric Industries SAS  
Country Customer Care Center  
<http://www.se.com/contact>  
35, rue Joseph Monier  
CS 30323  
F- 92500 Rueil Malmaison Cedex  
RCS Nanterre 954 503 439  
Capital social 928 298 512 €

[www.se.com](http://www.se.com)

ENVEOLI2012016\_V2

Published by Schneider Electric

© 2023 - Schneider Electric – All rights reserved

01-08-2024