

Product End of Life Instructions

PowerLogic™ PM32xx series Power Meter





Potential disassembly risks

The information provided in this document assumes that the product is completely de-energized and uninstalled (refer to the instructions provided in the appropriate product manuals).

Dismantling/disassembling the product may entail hazards caused by, for example, sharp edges, chemical aggression or ejected parts.

⚠ WARNING

HAZARD DUE TO INSUFFICIENT PROTECTION

- Implement all safety measures required by the applicable regulations and by the processes used to dismantle/disassemble and dispose of the product.
- Use all necessary personal protective equipment such as gloves and goggles.

Failure to follow these instructions can result in death or serious injury.



End of Life Instructions

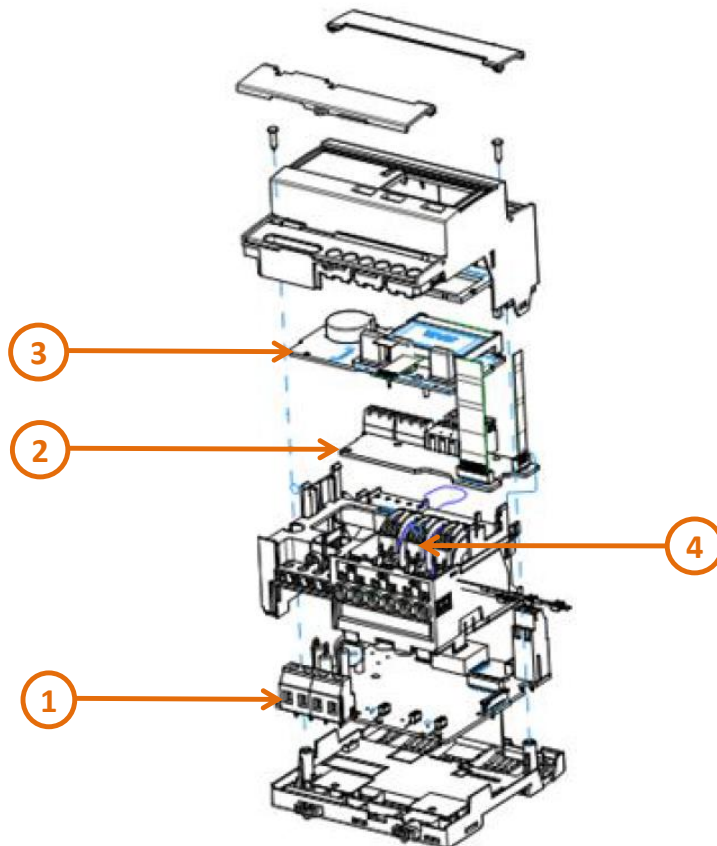

Recommendation	Number on drawing	Component / Material	Weight (in g)	Comment
To be depolluted	1	MAIN PCBA	59.88	
To be depolluted	2	COMM PCBA	10.08	
To be depolluted	3	HMI PCBA with LCD display	33.11	
To be depolluted	4	6A Current Transformer	15.6	Part of this assembly

Product description

Manufacturer identification	Schneider Electric Industries SAS
Brand name	Schneider Electric
Product function	The PowerLogic™ PM32xx series Power Meter is a cost-attractive, feature-rich range of DIN railmounted power meters ideal for power metering and network monitoring application in addition to sub-billing and cost allocation applications.
Product reference	METSEPM3255
Total representative product mass	290 g
Representative product dimensions	W90 x D70 X H95 mm
Date of information release	01-2025

Additional information

Legal information	This product family is in the scope of European Union directive 2012/19/EU on Waste Electrical and Electronic Equipment (WEEE). The product family must be disposed according to the legislation of the country. This document is intended for use by end of life recyclers or treatment facilities. It provides the basic information to assure an appropriate end of life treatment for the components and materials of the product.
Recyclability potential	9% The recyclability rate was calculated from the recycling rates of each material making up the product based on REEECYLAB tool developed by Ecosystem, for components/materials not covered by the tool, data from the EIME database and the related PSR was taken. If no data was found a conservative assumption was used (0% recyclability).

Schneider Electric Industries SAS
 Country Customer Care Center
<http://www.se.com/contact>
 35, rue Joseph Monier
 CS 30323
 F- 92500 Rueil Malmaison Cedex
 RCS Nanterre 954 503 439
 Capital social 928 298 512 €

www.se.com

ENVEOLI111258EN_V1

Published by Schneider Electric

© 2023 - Schneider Electric – All rights reserved

01-2025