

# Product End of Life Instructions

**EVlink eWallbox AC 6mA RCD Type Asi MNX MID**

**EVlink Pro AC**





## Potential disassembly risks

**⚠ WARNING**

### HAZARD DUE TO INSUFFICIENT PROTECTION

- Implement all safety measures required by the applicable regulations and by the processes used to dismantle/disassemble and dispose of the product.
  - Use all necessary personal protective equipment such as gloves and goggles.
- Failure to follow these instructions can result in death or serious injury.**



## End of Life Instructions

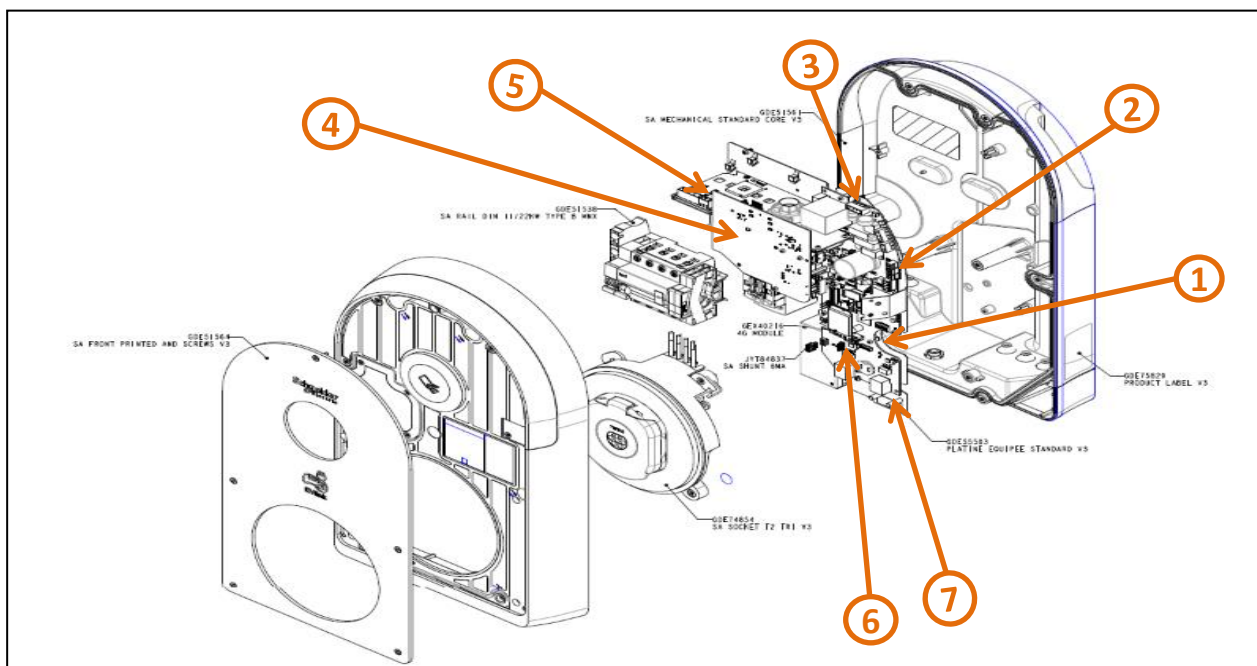

Recommendation	Number on drawing	Component / Material	Weight (in g)	Comment
To be depolluted	1	Electronic Board (Communication) > 10cm²	26g	PCBA including soldering parts
To be depolluted	2	Electronic Board (Communication) > 10cm²	325.28g	PCBA including electrolyte capacitors
To be depolluted	3	Electrolyte capacitors which size: height > 25 mm, diameter > 25 mm or proportionately similar volume	25g	Aluminum electrolyte capacitors
To be depolluted	4	Electronic Board (Communication) > 10cm²	76.85g	PCBA including soldering parts
To be depolluted	5	Electronic Board (Communication) > 10cm²	127.22g	PCBA including electrolyte capacitors
To be depolluted	6	Electronic Board (Communication) > 10cm²	135.95g	PCBA including soldering parts
To be depolluted	7	Li-thium Battery	26g	Coin-type Lithium Battery



## Product description

Manufacturer identification	Schneider Electric Industries SAS
Brand name	Schneider Electric
Product function	EVlink Pro AC is designed to enable highly reliable, flexible and sustainable smart charging for multi dwelling housing and buildings. Charging type is normal, 1 charging point. Charging mode is mode 3, presence of connected sockets is 0-2 16A 2P+T domestic sockets, reference power is 7.4kW, 32A, 1P+N, It includes one RFID control system, RCD protect module and 4G communication module etc. The elements used for connecting the station to the mains grid and to the monitoring and communication network are excluded.
Product reference	EVB3S07NCAM
Additional similar product references	EVB3I22NC0M, EVB3I22NC0MB, EVB3S07NC0, EVB3S07NCA, EVB3S11NCA, EVB3S22NC0, EVB3S22NC0M, EVB3S22NCA, EVB3S22NCB, EVB3S04NCA
Total representative product mass	8624.582 g
Representative product dimensions	530mm x 317mm x 152mm
Accessories	Pedestal, Cable locker, TIC communication card, Metal kit
Date of information release	09-2024



## Additional information

Legal information	This product family is in the scope of European Union directive 2012/19/EU on Waste Electrical and Electronic Equipment (WEEE). The product family must be disposed according to the legislation of the country. This document is intended for use by end of life recyclers or treatment facilities. It provides the basic information to assure an appropriate end of life treatment for the components and materials of the product.	
Recyclability potential	17%	Recyclability rate has been calculated based on REEECY'LAB tool developed by Ecosystem, for components/materials not covered by the tool, data from the "ECO' DEEE recyclability and recoverability calculation method" was taken. If no data was found a conservative assumption was used (0% recyclability).

Schneider Electric Industries SAS

Country Customer Care Center  
<http://www.se.com/contact>

35, rue Joseph Monier

CS 30323

F- 92500 Rueil Malmaison Cedex

RCS Nanterre 954 503 439

Capital social 928 298 512 €

[www.se.com](http://www.se.com)

Published by Schneider Electric

ENVEOLI2409036\_V1

© 2023 - Schneider Electric – All rights reserved

09-2024