

Product End of Life Instructions

Variable speed drive, Altivar Machine ATV340, 22kW, heavy duty, 400V, 3 phases, Ethernet

Altivar Machine ATV340





Potential disassembly risks

The information provided in this document assumes that the product is completely de-energized and uninstalled (refer to the instructions provided in the appropriate product manuals).

Dismantling/disassembling the product may entail hazards caused by, for example, sharp edges, chemical aggression or ejected parts.

⚠ WARNING

HAZARD DUE TO INSUFFICIENT PROTECTION

- Implement all safety measures required by the applicable regulations and by the processes used to dismantle/disassemble and dispose of the product.
- Use all necessary personal protective equipment such as gloves and goggles.

Failure to follow these instructions can result in death or serious injury.

End of Life Instructions

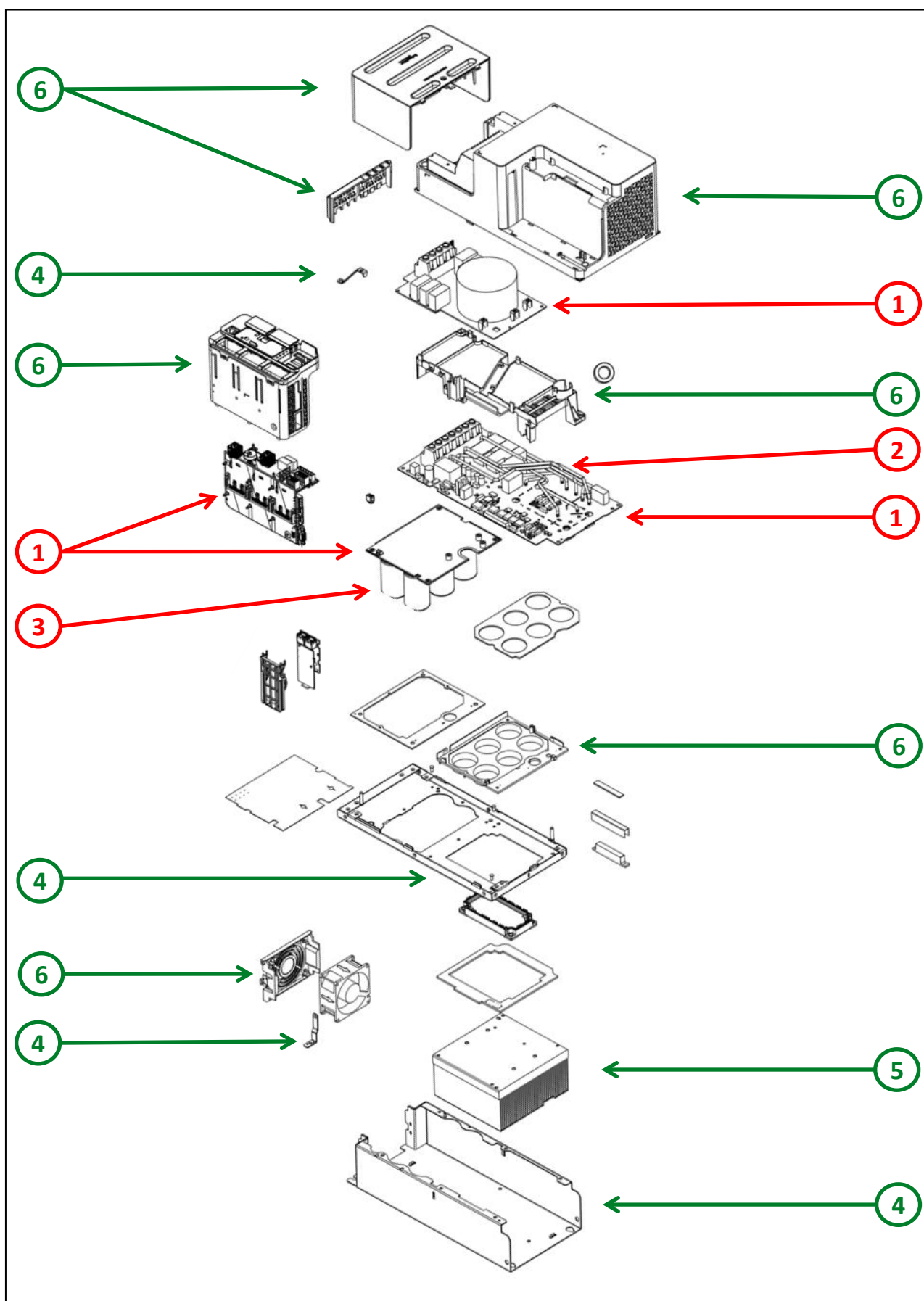

Recommendation	Number on drawing	Component / Material	Weight (in g)	Comment
To be depolluted	1	Electronic Board (Power and Communication) > 10cm ²	2231,8	
To be depolluted	2	Cable (high current)	314,5	
To be depolluted	3	Electrolyte capacitors which size: height > 25 mm, diameter > 25 mm or proportionately similar volume	955,8	
To be dismantled	4	Steel	2304,32	Lower housing - Ground bar - Chassis
To be dismantled	5	Aluminium	2872,4	Heatsink
To be dismantled	6	PC, ABS-PC, PA, PA6, HDPE, SAN with or without additive, PP+EPDM and PP	1263,45	Upper housing - Wiring cap - Support - Wiring trap - Housing control brick - Front cover
Other			257,73	



Product description

Manufacturer identification	Schneider Electric Industries SAS
Brand name	Schneider Electric
Product function	The main function of the Altivar Machine product range is the speed control and variation of a 3-phase synchronous, asynchronous or reluctance electric motor for fluid management and industrial applications. ATV340 has been designed to meet the needs of applications for harsh environments, such as vibration, shock and non-conductive dust and where high temperature resistance up to 60 °C is needed.
Product reference	ATV340D22N4E
Total representative product mass	10,2 kg
Representative product dimensions	385mm x 180mm x 249mm
Accessories	No accessories needed
Date of information release	07-2024



Additional information

Legal information	The product family must be disposed according to the legislation of the country. This document is intended for use by end of life recyclers or treatment facilities. It provides the basic information to assure an appropriate end of life treatment for the components and materials of the product.
In case of special transportation: transportation method	No special transportation
Recyclability potential	66% Recyclability rate has been calculated based on REEECY'LAB tool developed by Ecosystem, for components/materials not covered by the tool, data from the "ECO'DEEE recyclability and recoverability calculation method" was taken. If no data was found a conservative assumption was used (0% recyclability).

Schneider Electric Industries SAS
Country Customer Care Center
<http://www.se.com/contact>

35, rue Joseph Monier
CS 30323

F- 92500 Rueil Malmaison Cedex
RCS Nanterre 954 503 439
Capital social 928 298 512 €

www.se.com

Published by Schneider Electric