

NatureConnect

by  signify

# Small Island Installation guide

August 2023



# Small Island frame

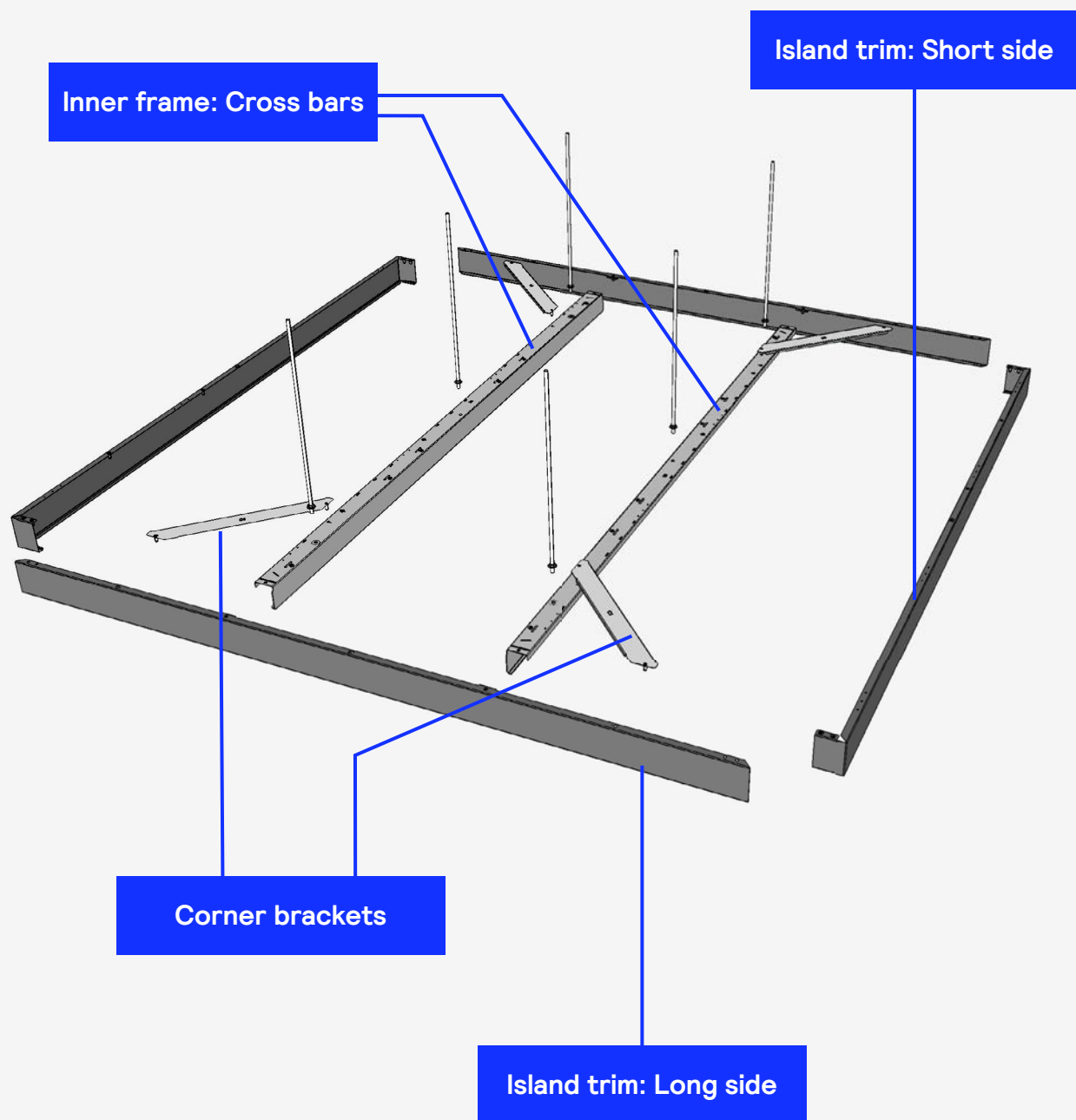

I

## Unpack and collect all material

### Frame trim

2x

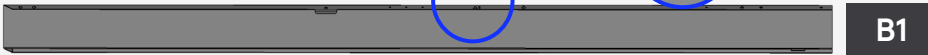

B1

2x



C1

### Inner frame

2x



B2

4x

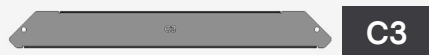

C3

20x  
M5



12x  
M8

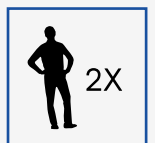
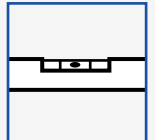

### For mounting Daylights

8x



24x

3x8



8x



24x

3x8



### For connecting Skylights and Daylights

4x

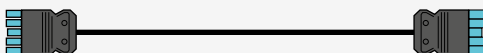

## 2

### Define suspension 6 points positions

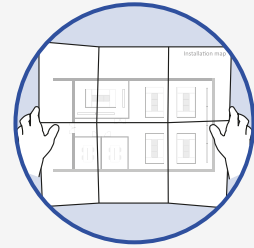
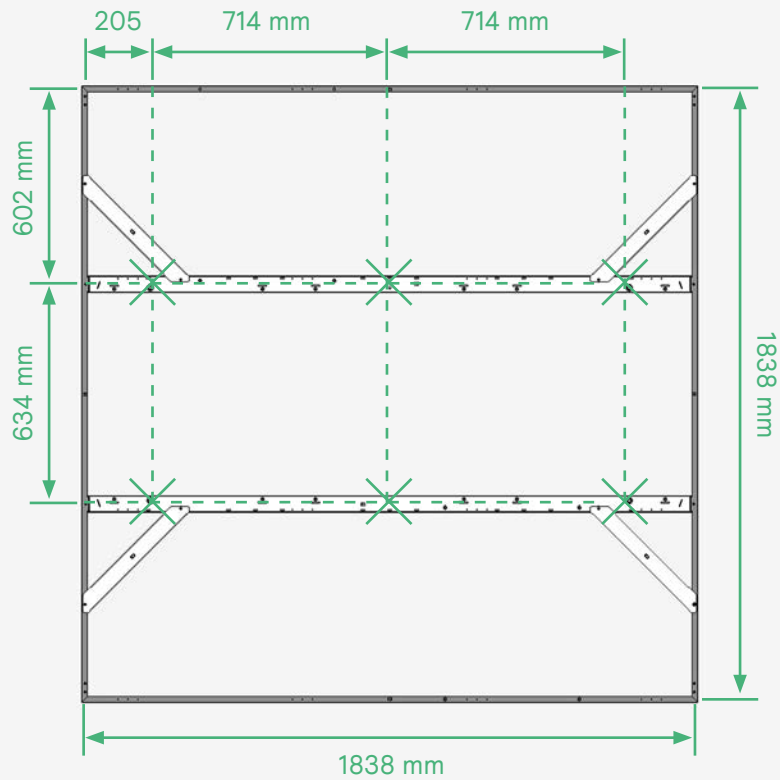

System can be suspended with steel cables with proper workload or threaded rods.

### Define suspension 4 points positions

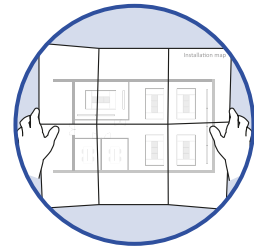
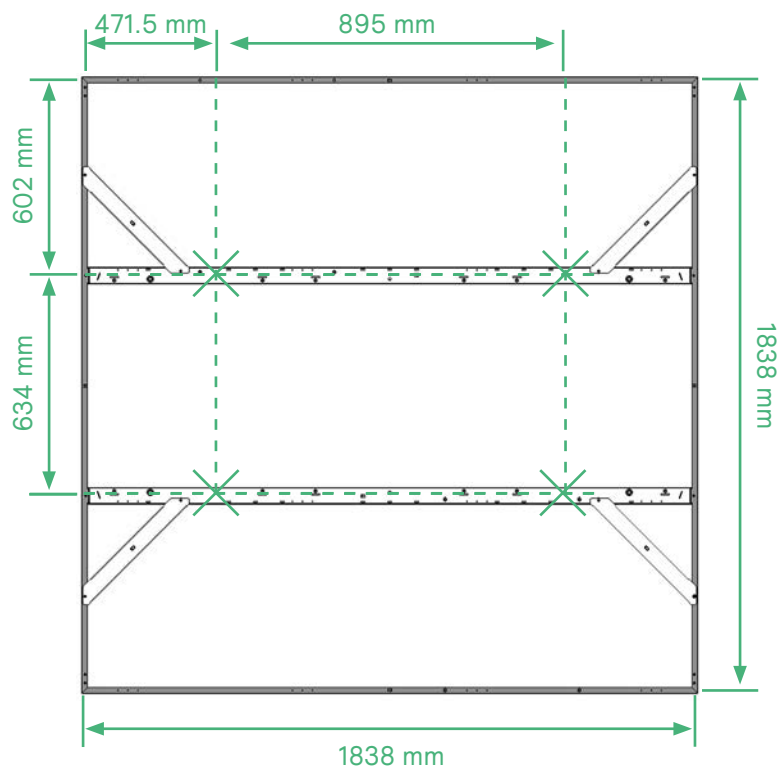

3

### Prepare suspension to the ceiling

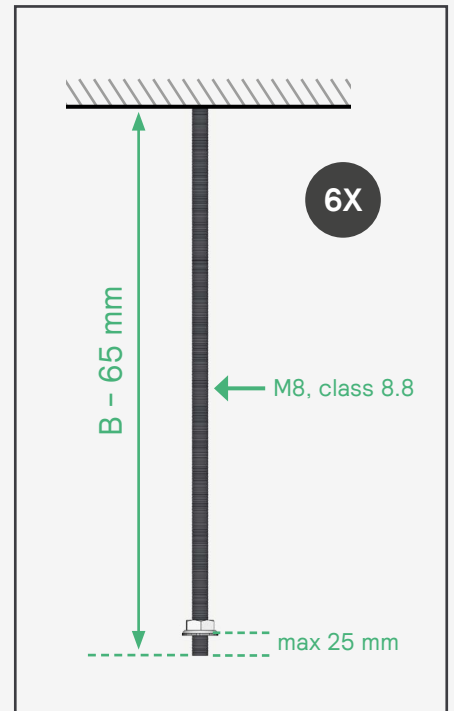
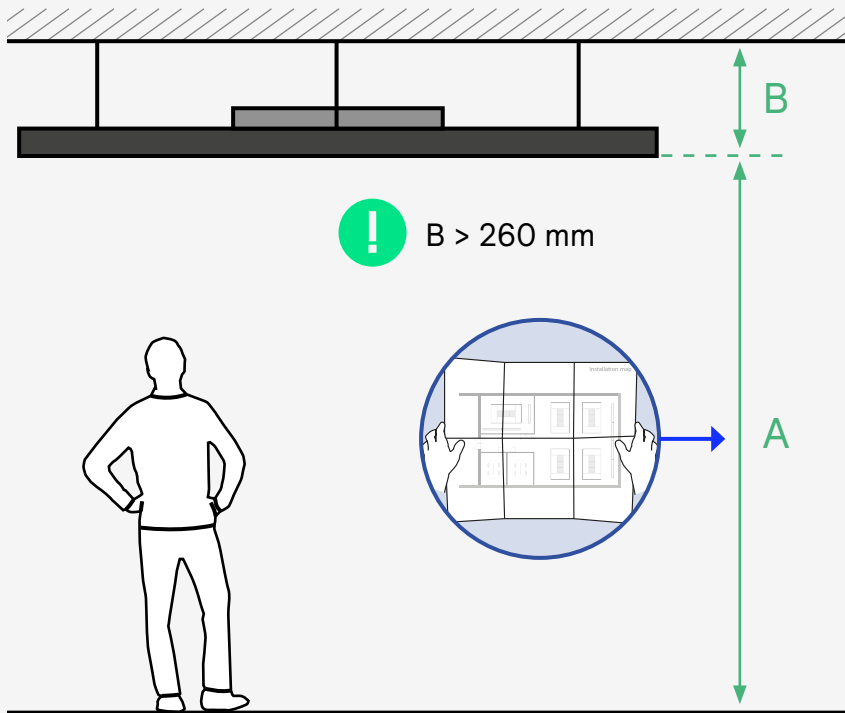

**!** Threaded rod / steel cables not included

4

### Attach main bars to ceiling suspension

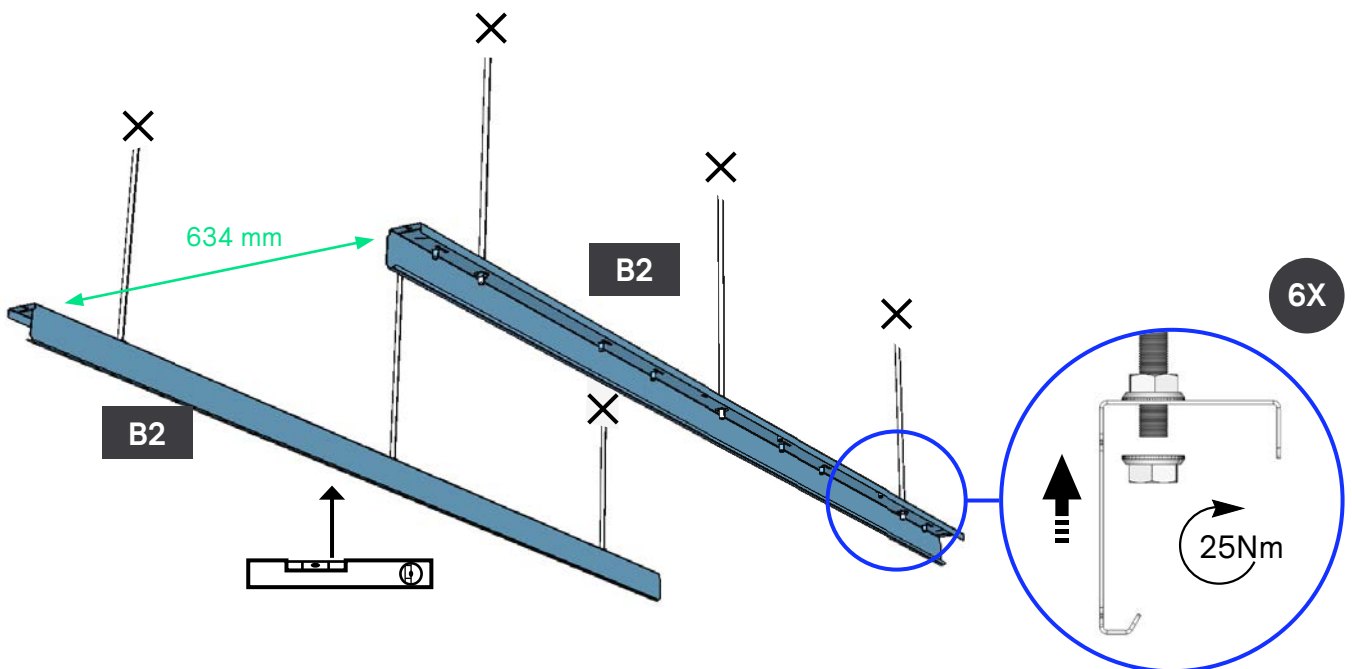

5

## Mount long trim edges

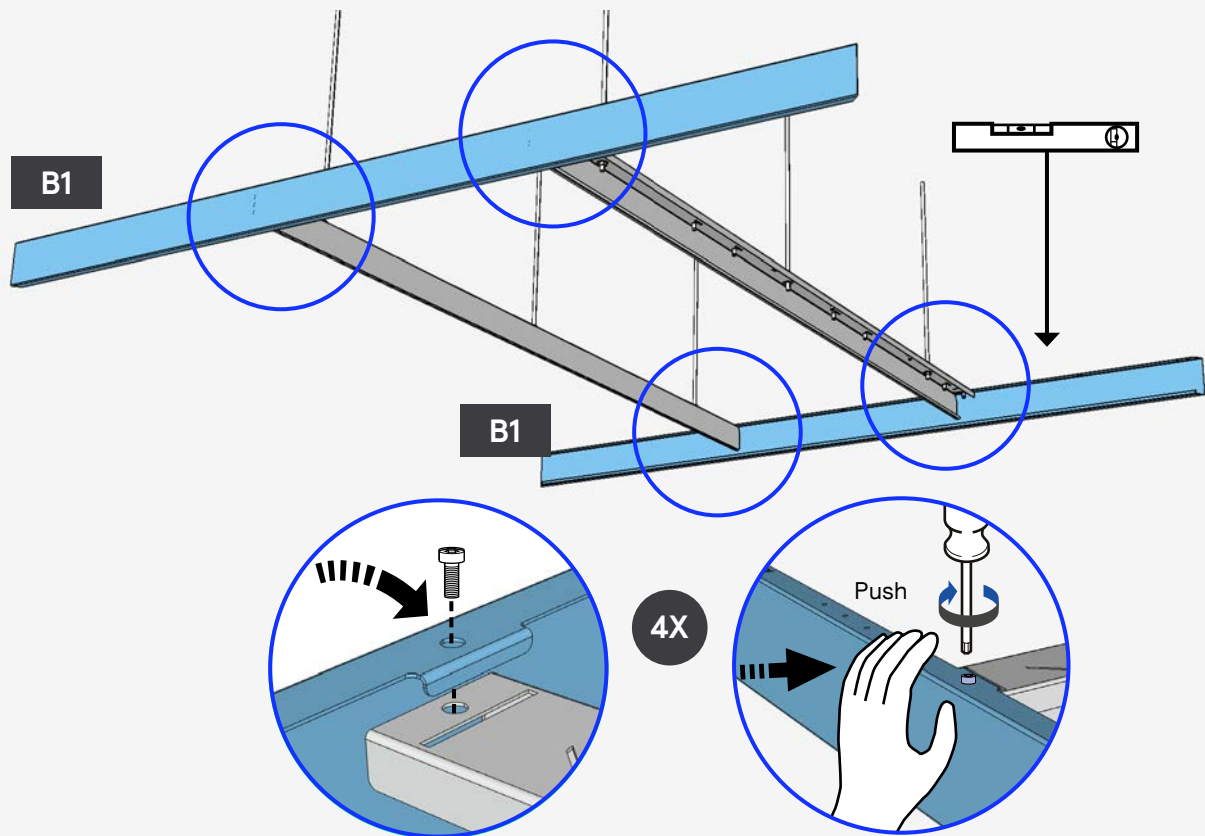

6

## Attach short trim on two sides

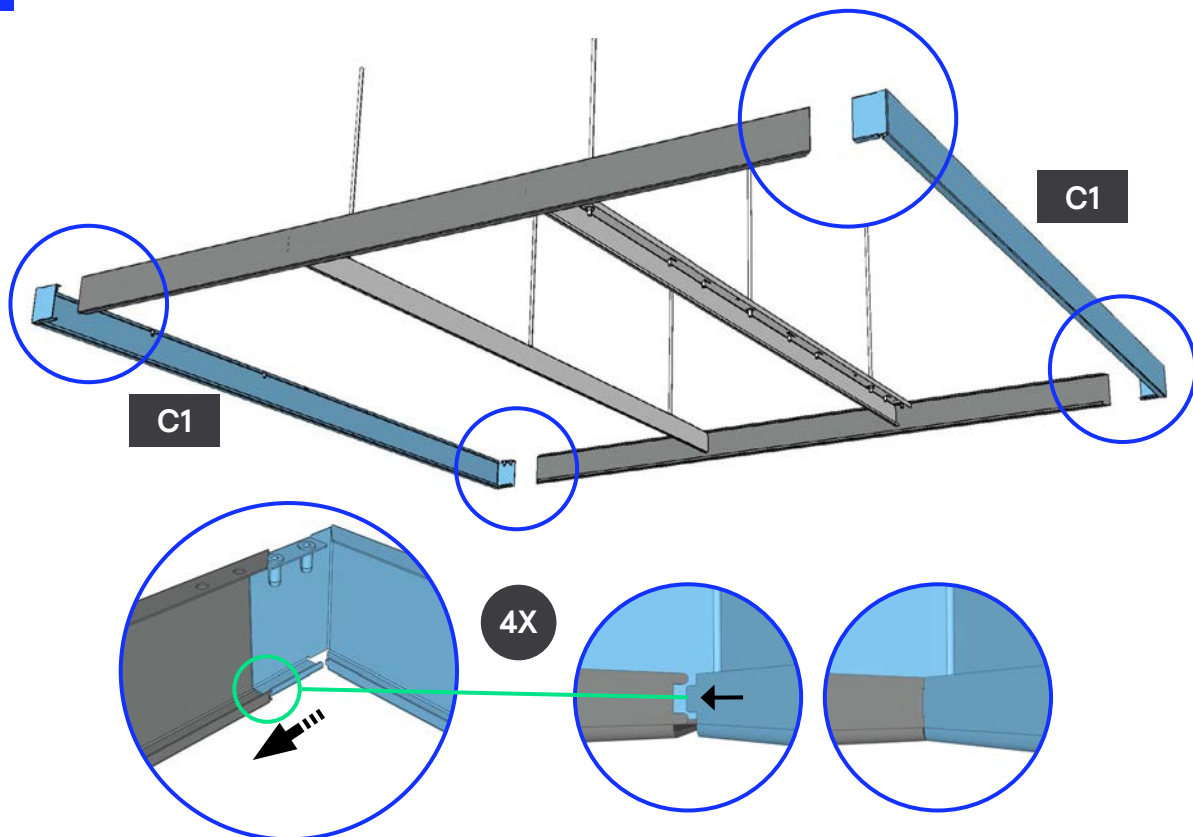

7

## Secure short trim edges

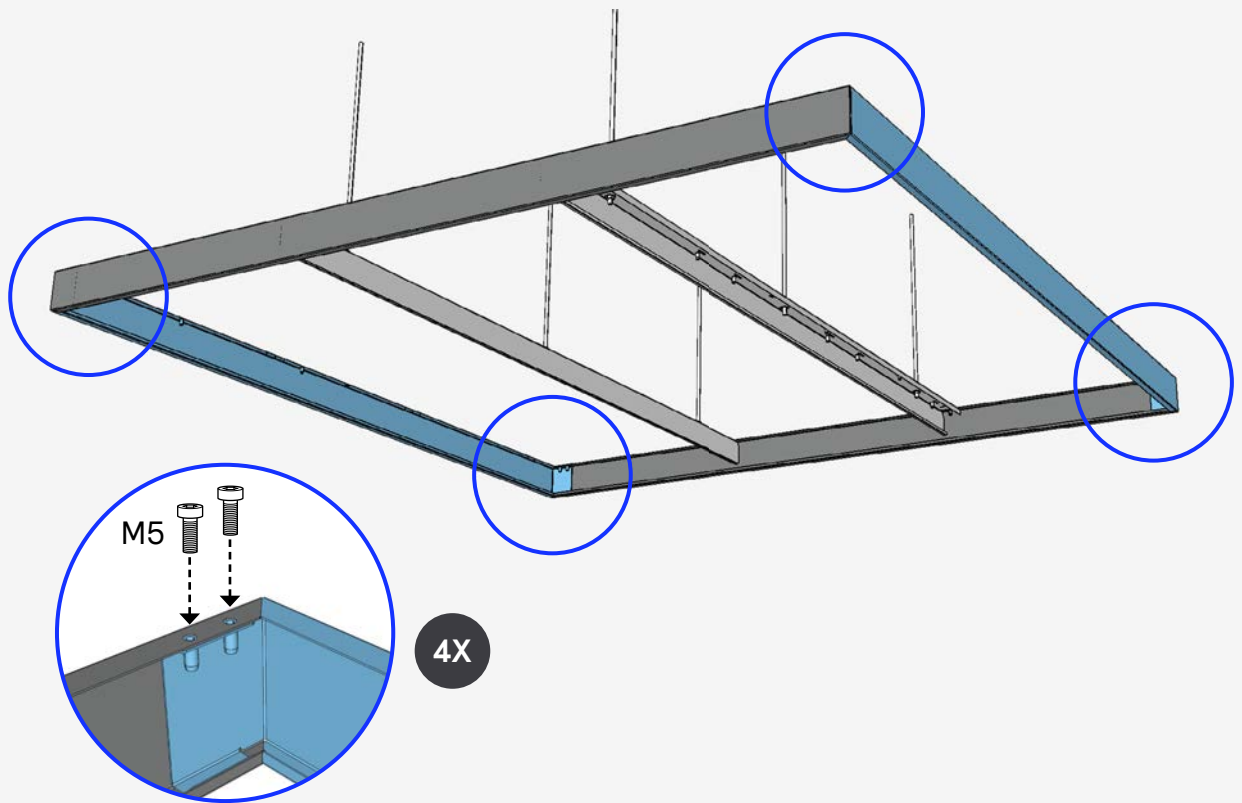

8

## Mount corner brackets

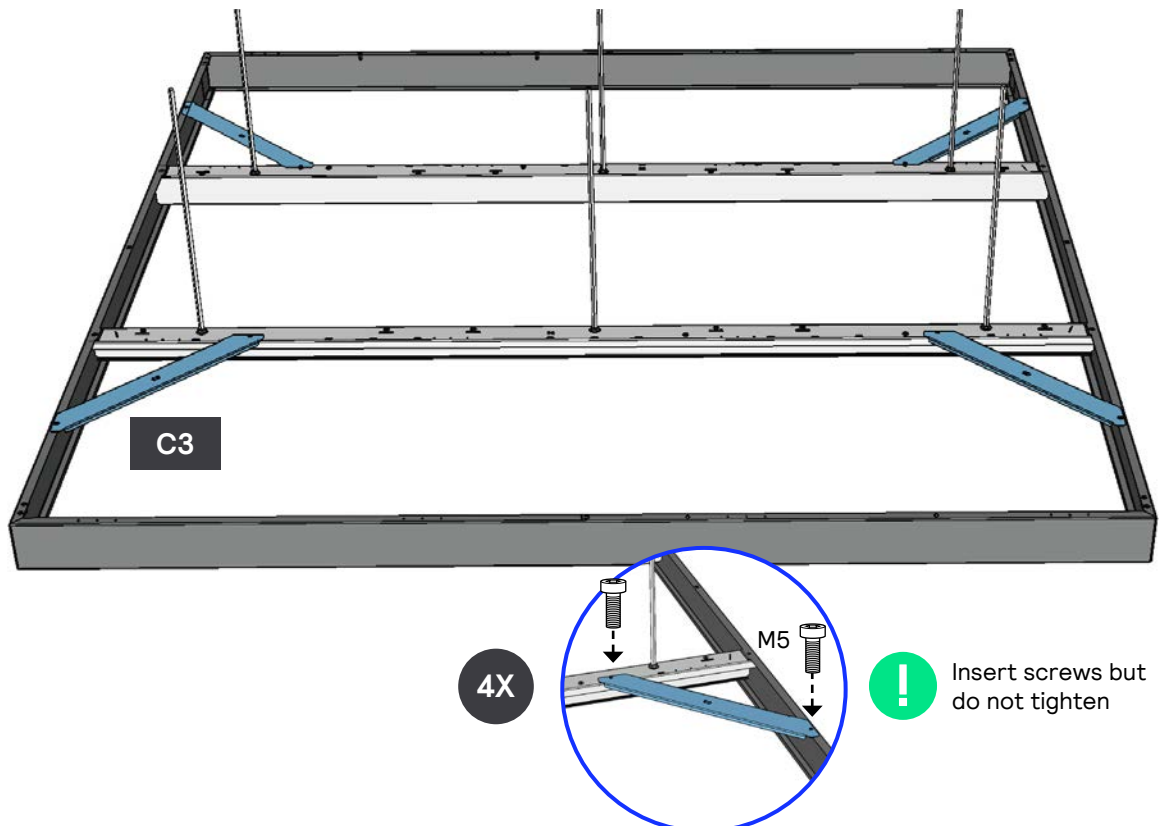

9

## Measure diagonals and tighten corner screws

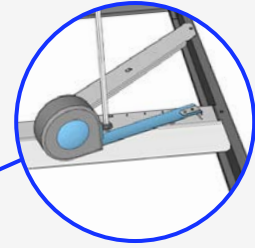
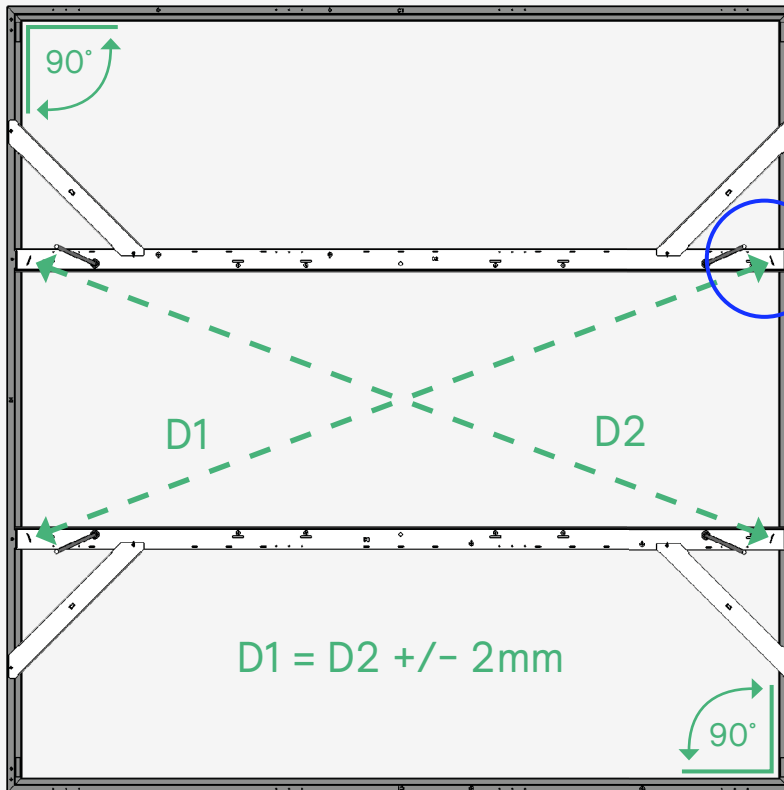

! Tighten screws

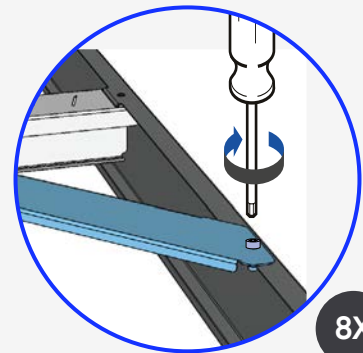

8X

## Skylights & Gear tray - Small Island

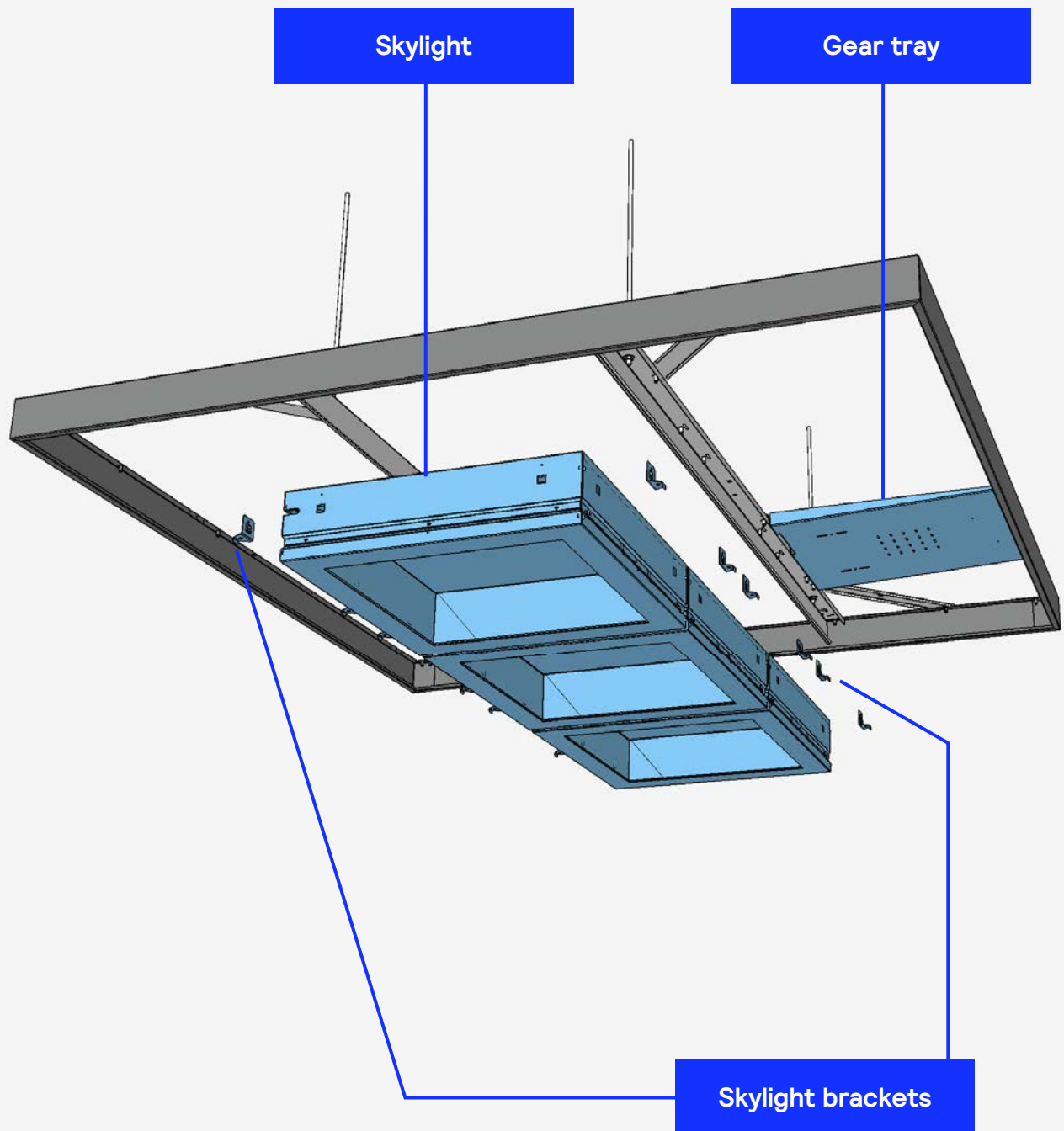

I

## Unpack and check Skylight and parts

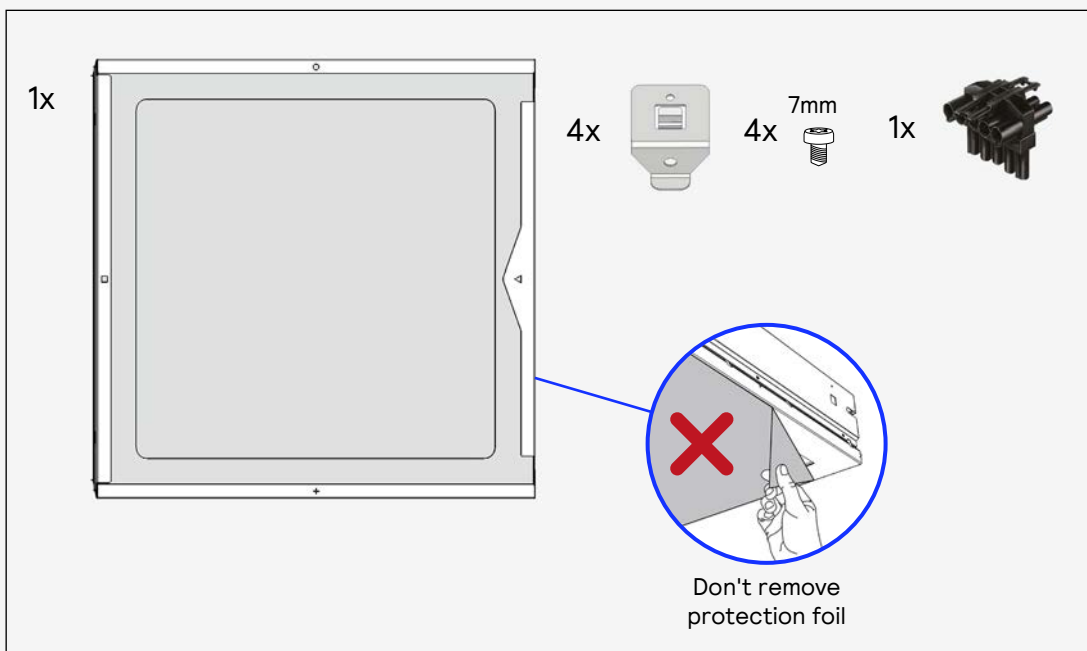
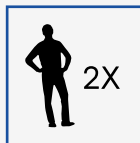

3x

2

## Define orientation of the Skylights

For correct orientation of the Skylight, please refer to the Lighting plan"

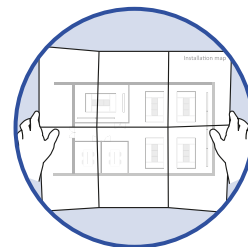

A

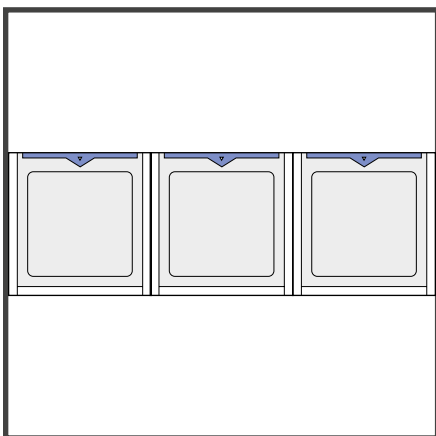

B

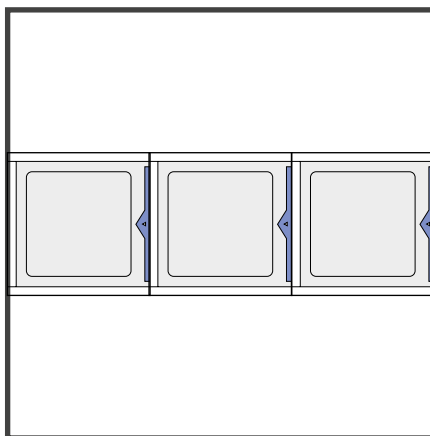

3

### Insert first Skylight and mount brackets

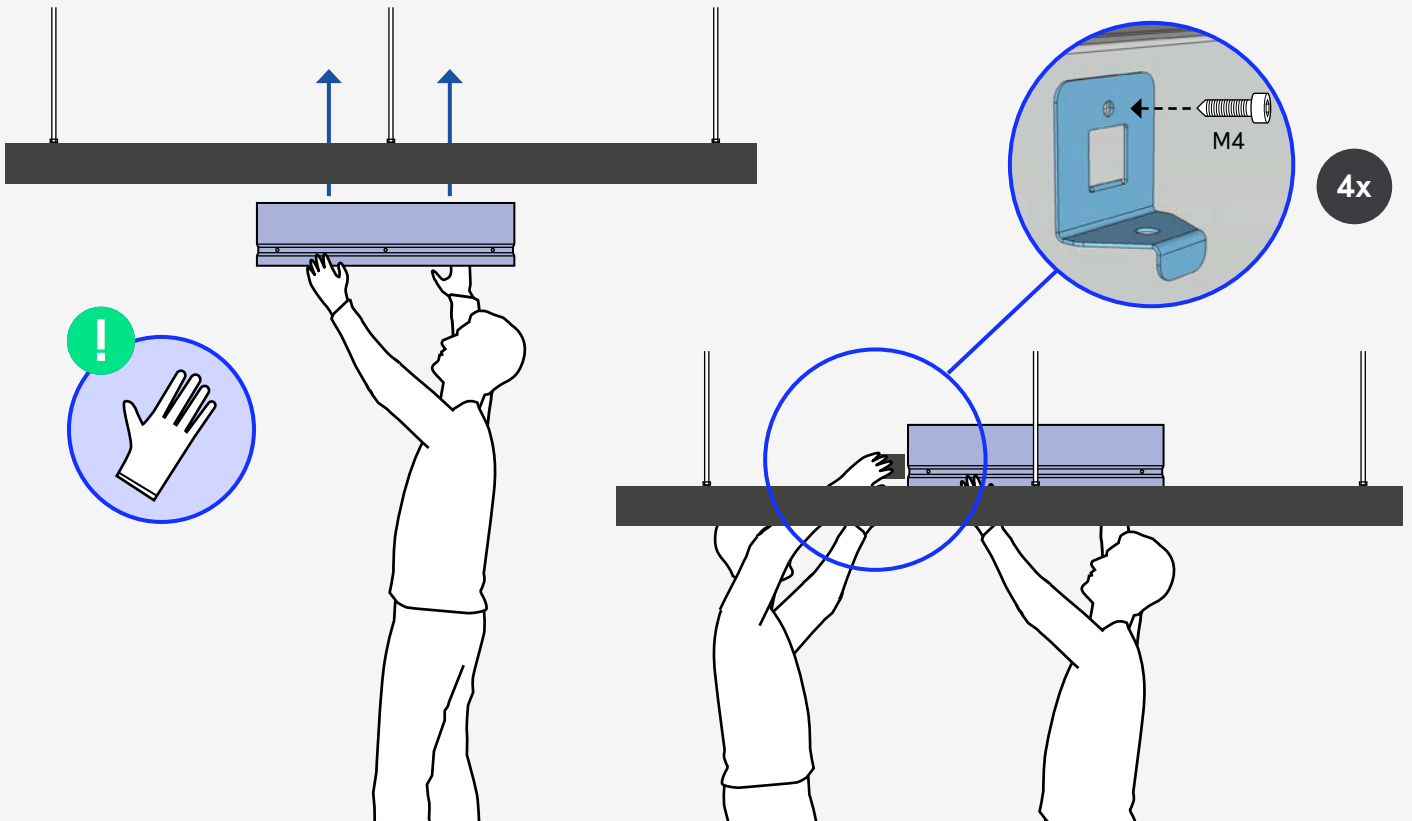

4

### Mount Skylights in the right orientation

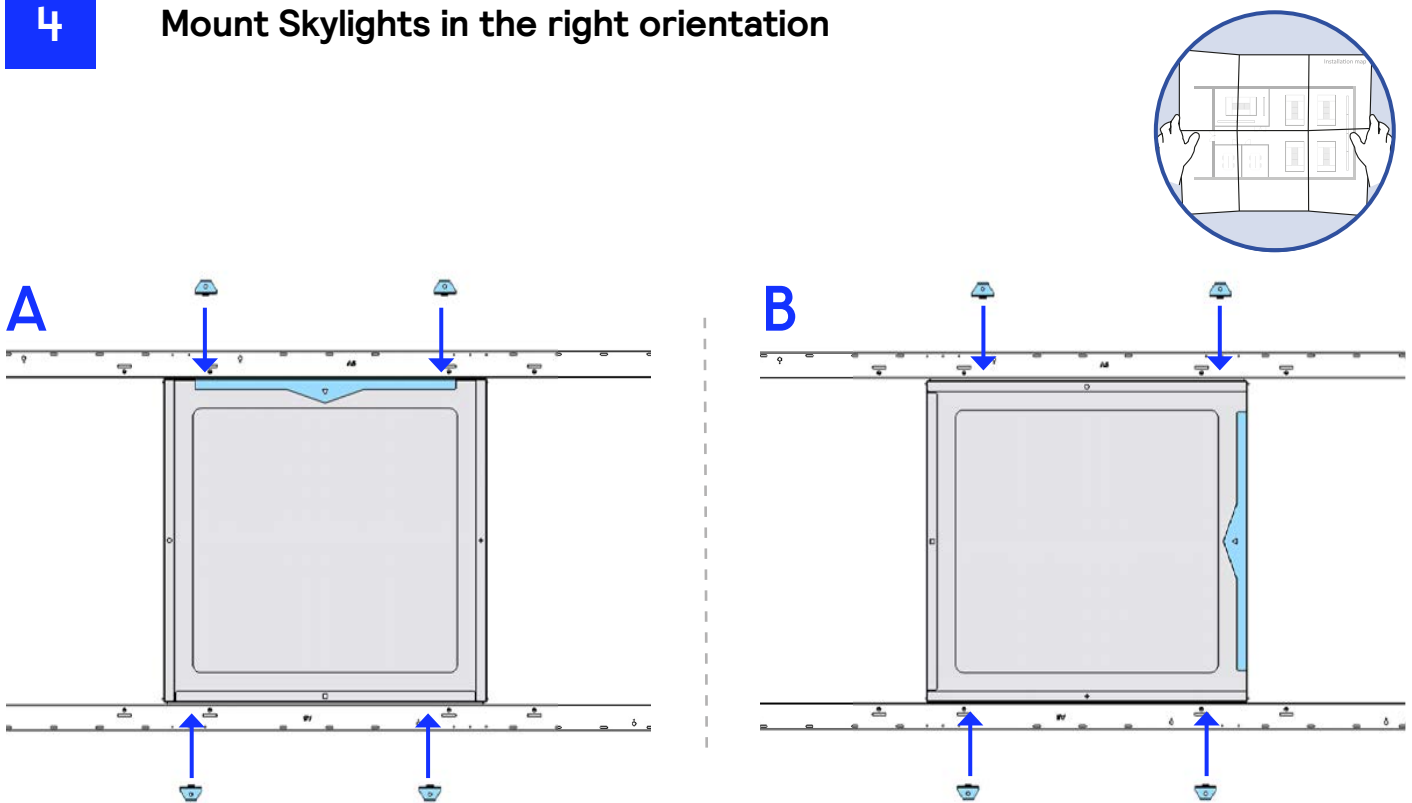

5

Insert second and third Skylight

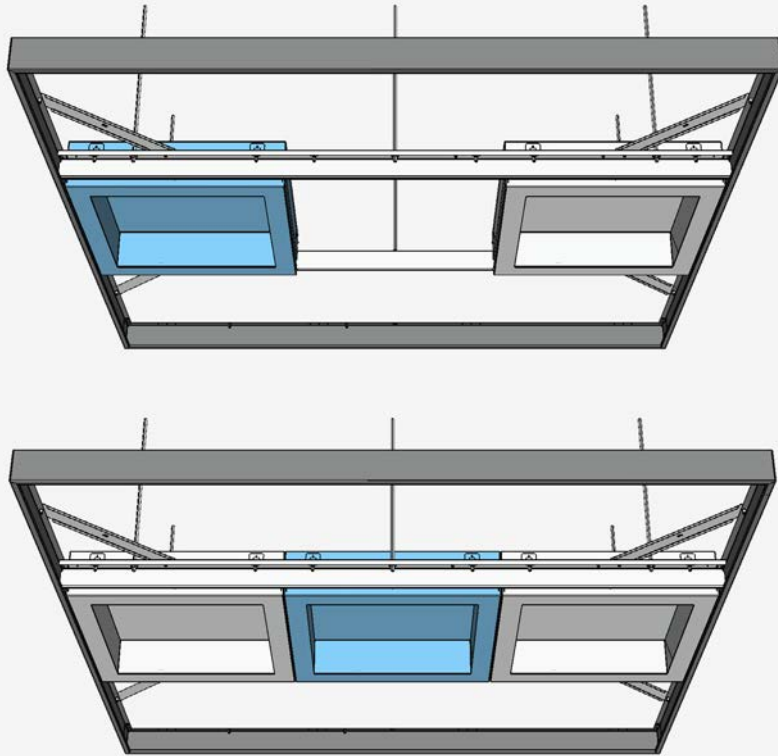

6

Check Skylight orientation

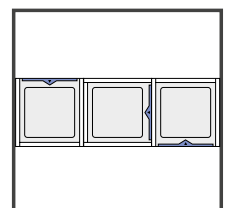
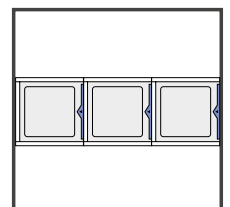
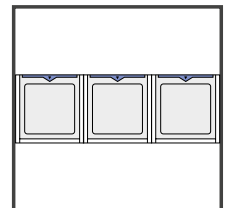
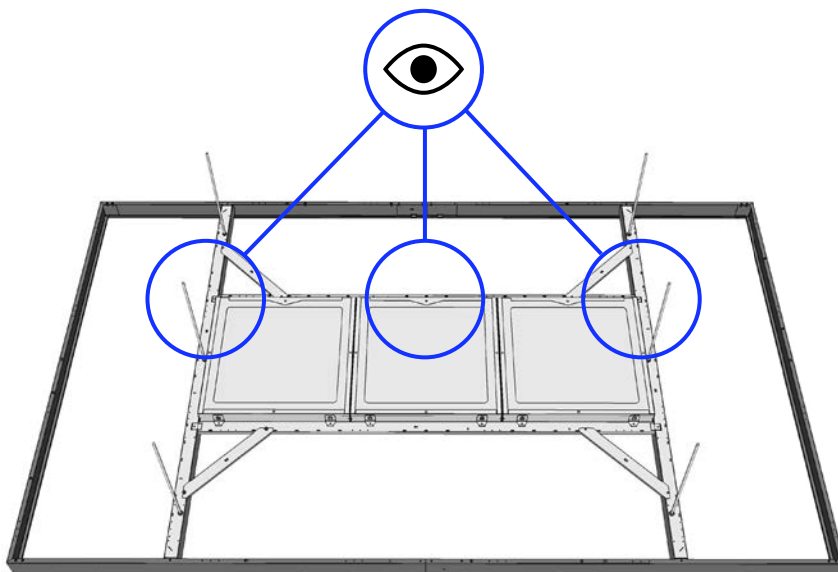

7

## Align and mount center Skylight

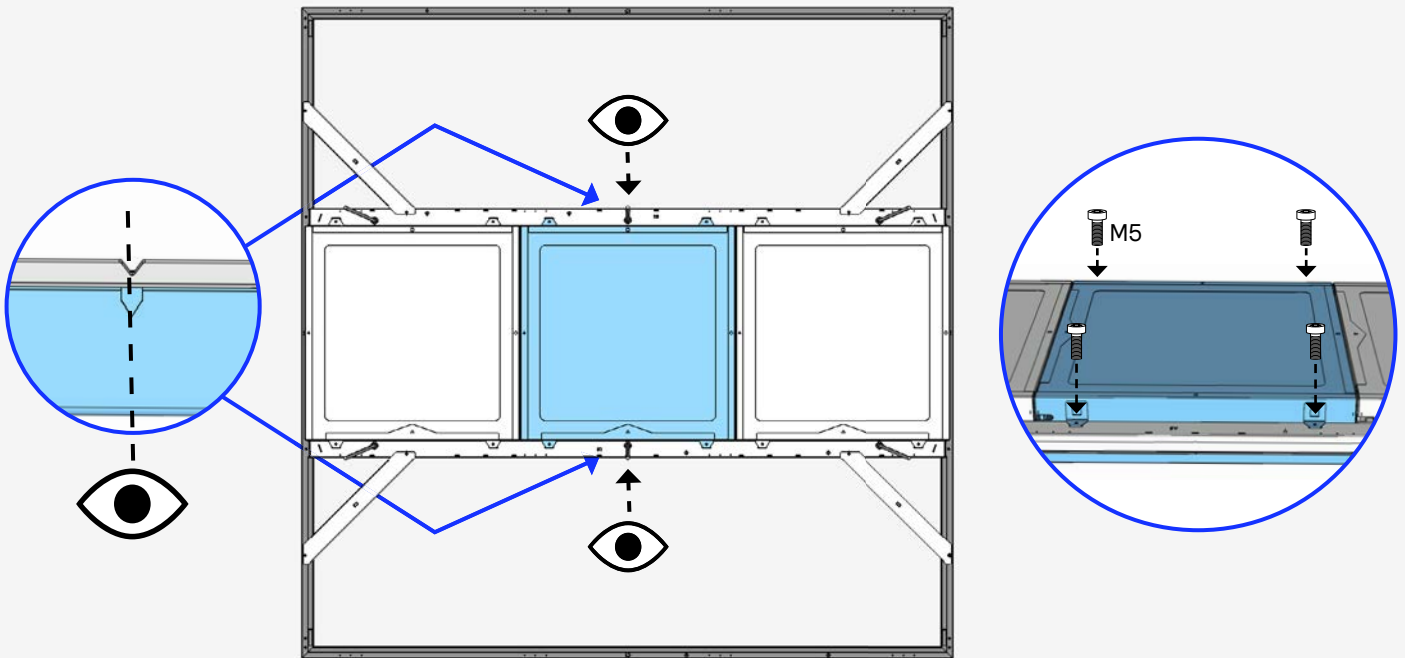

8

## Remove protection foil

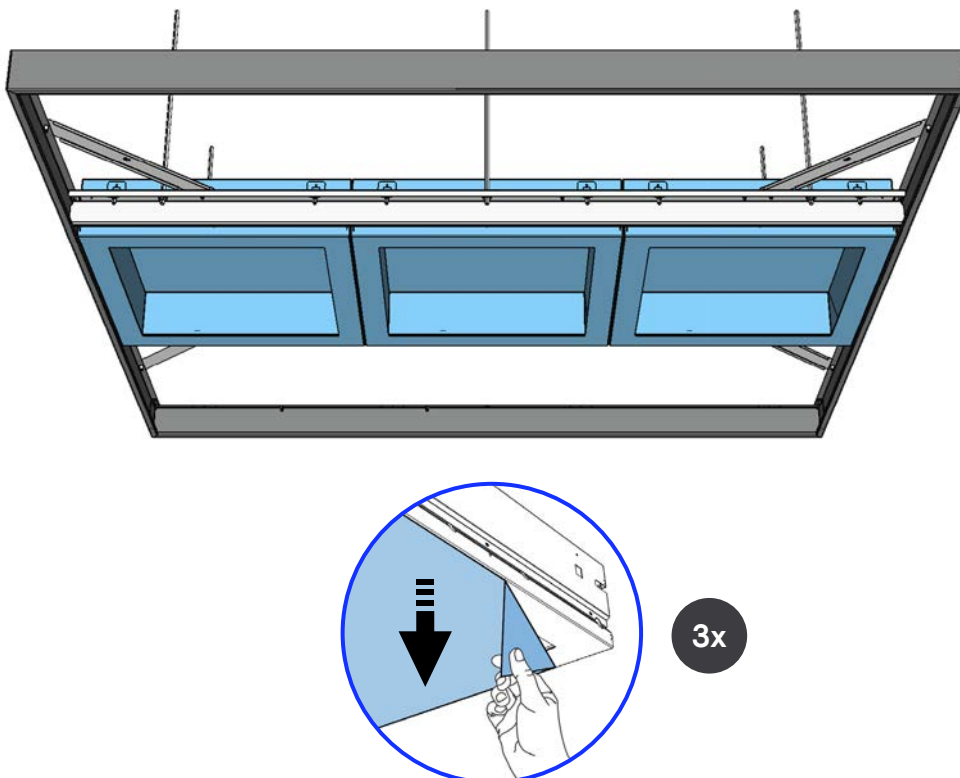

9

## Unpack and check Gear tray and accessories

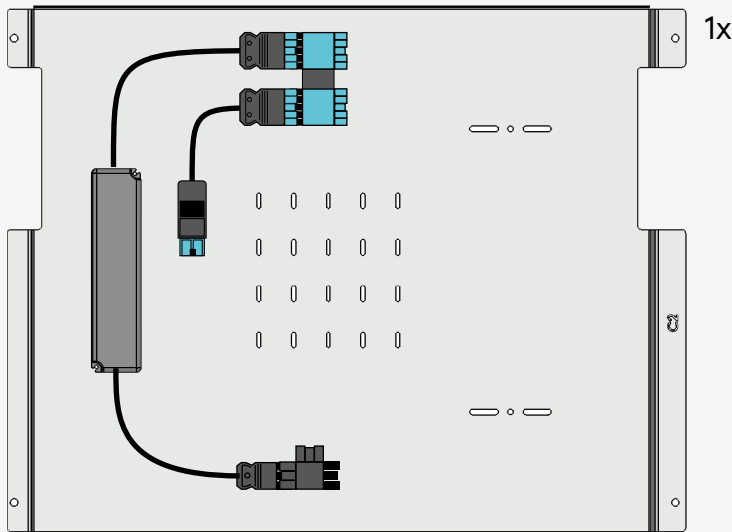
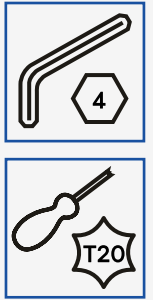

M5  
4x

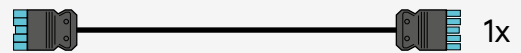

Lightscape controller (optional)

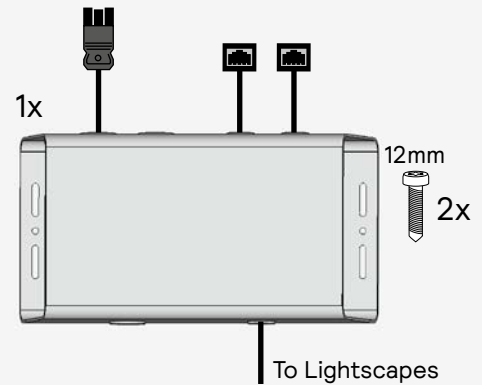

For connecting mains and Dali



10

## Mount Lightscape controller to the Gear tray (optional)

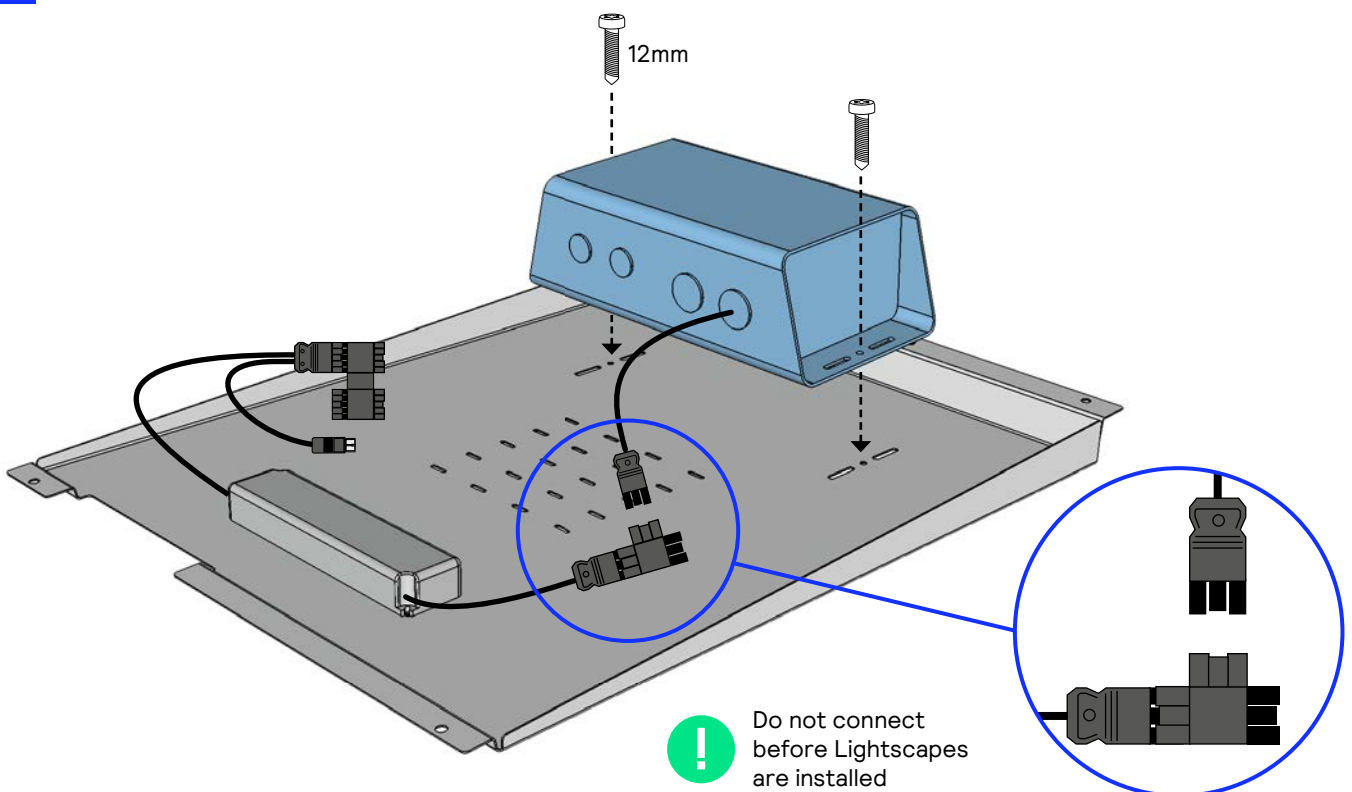

## II

### Define position on island

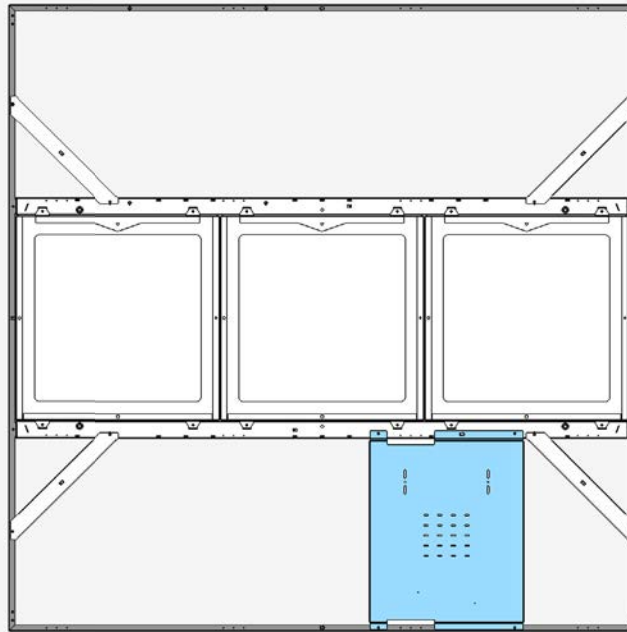

## 12

### Insert and mount Gear tray

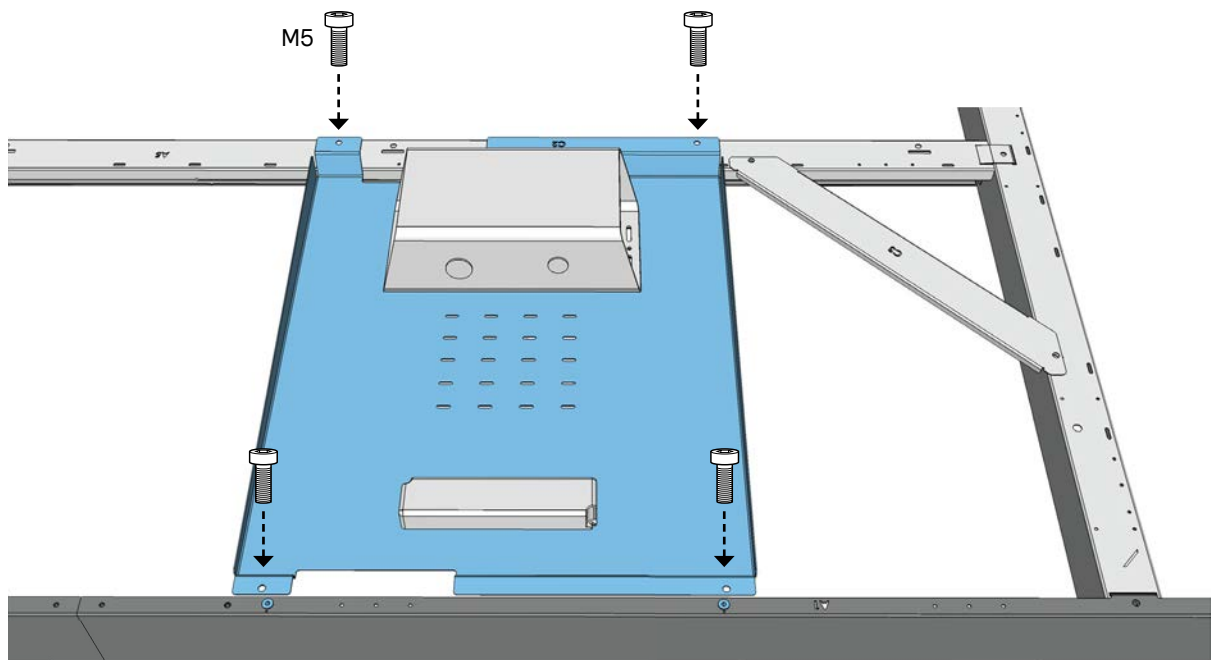

## Daylights - Small Island

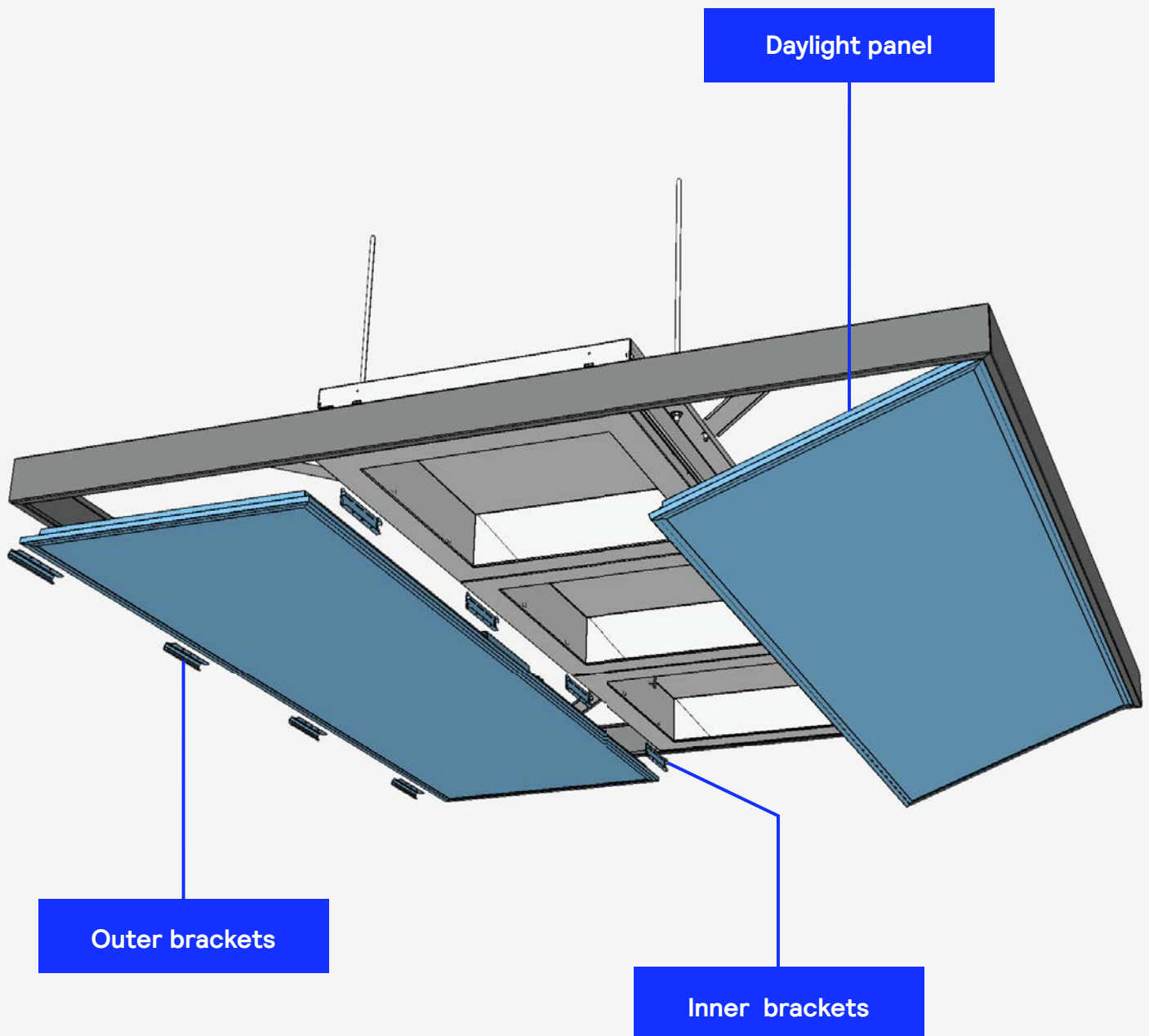

1

## Unpack and check Daylight and accessories

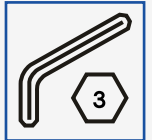

4X

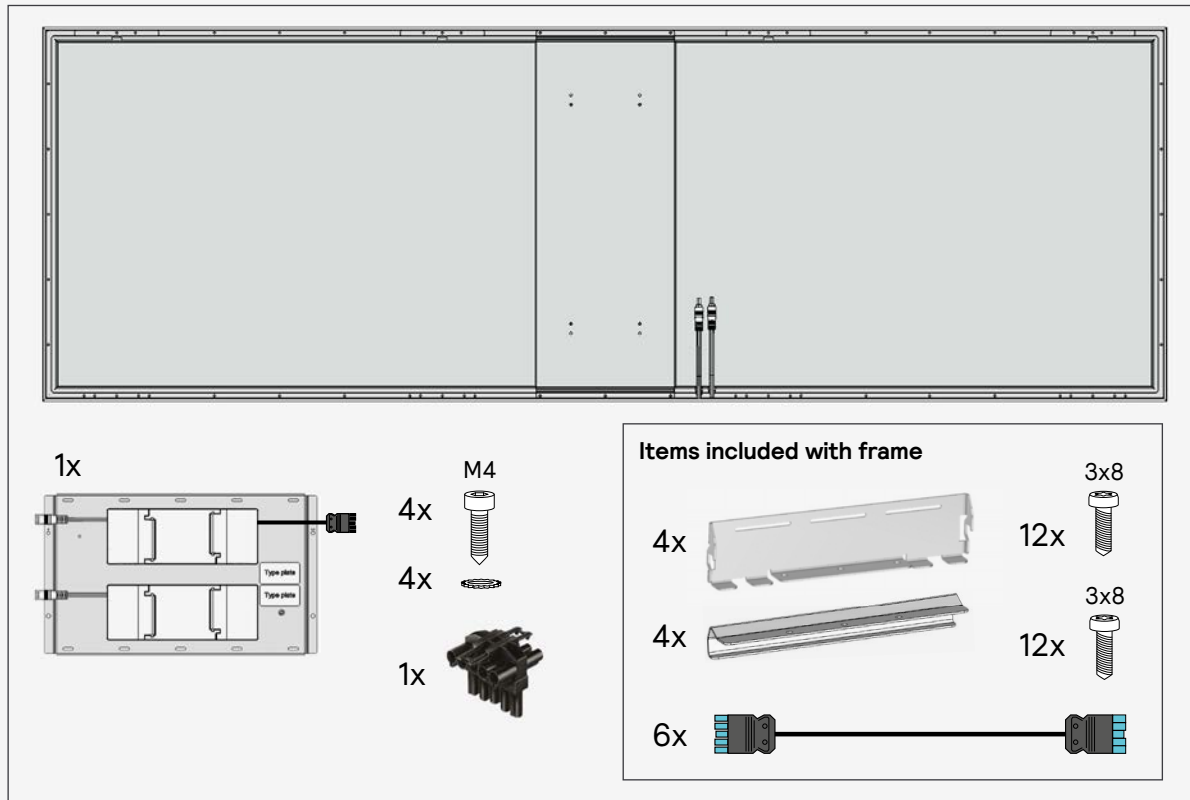

2

## Place Daylight panel on a clean, flat surface

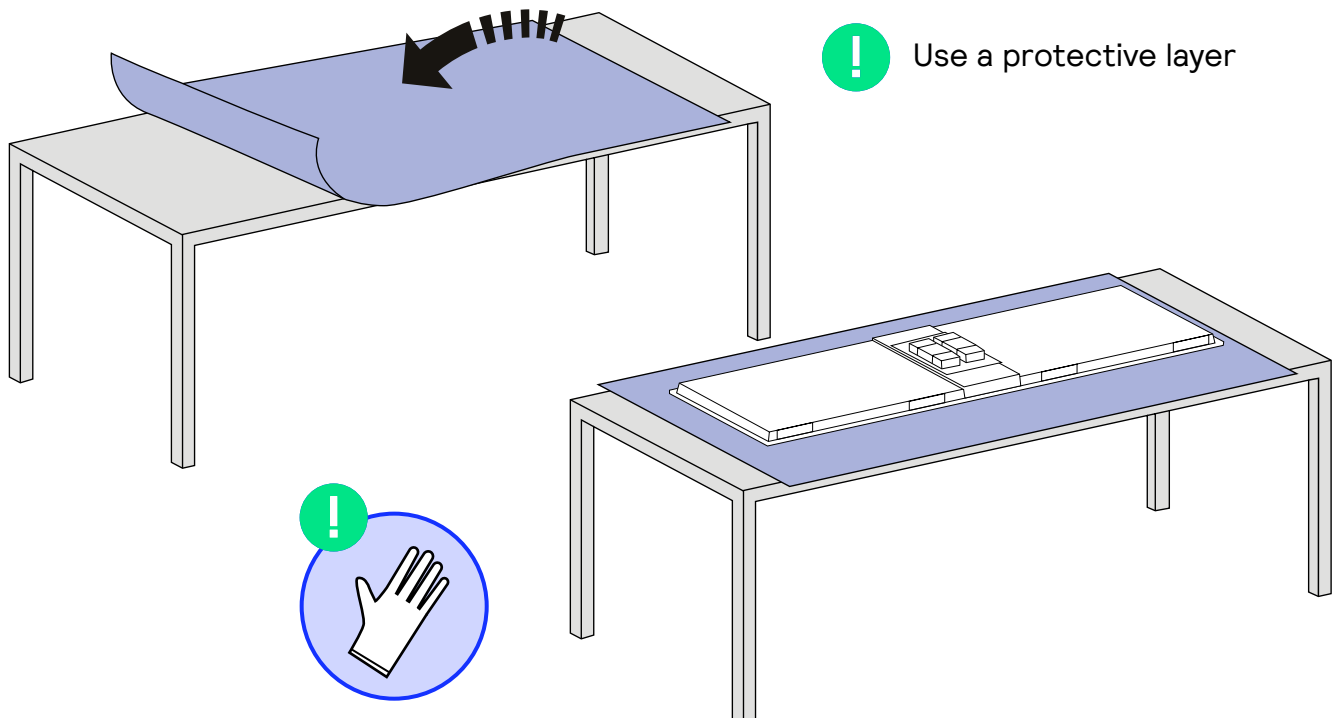

3

### Mount brackets on both sides

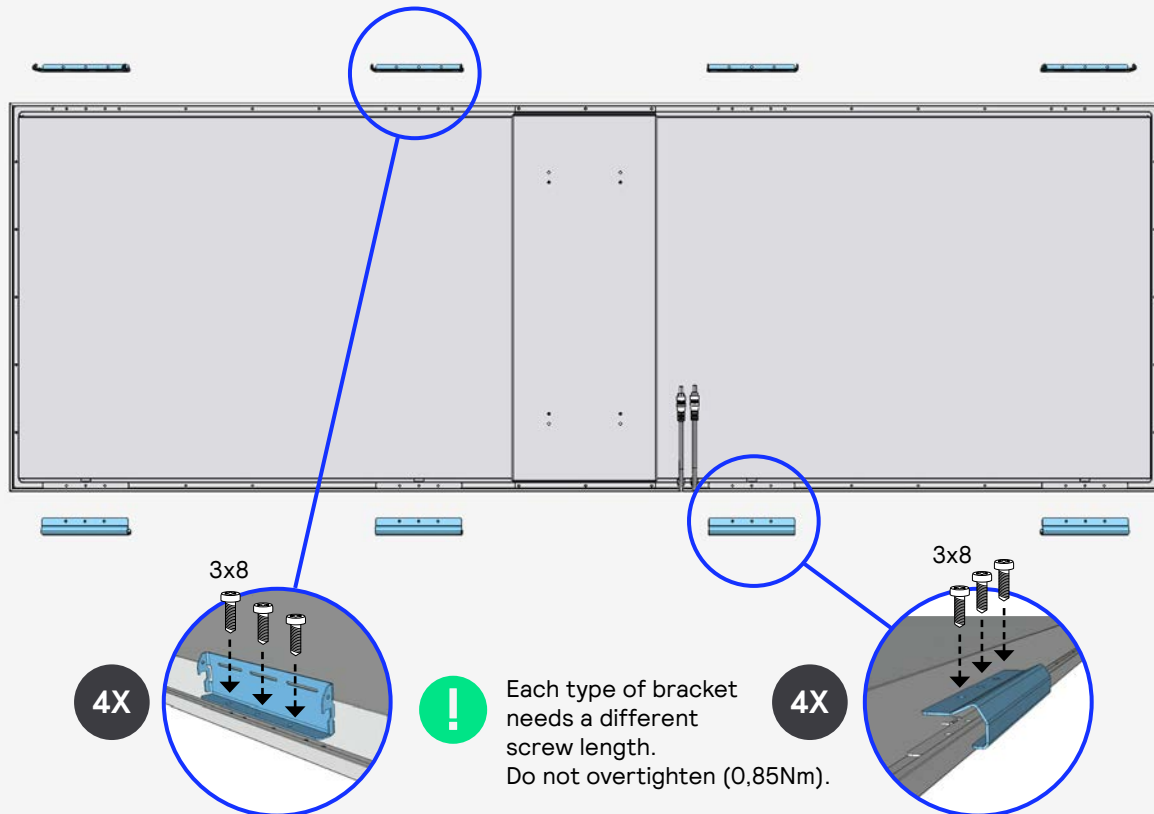

4

### Mount Daylight gear tray

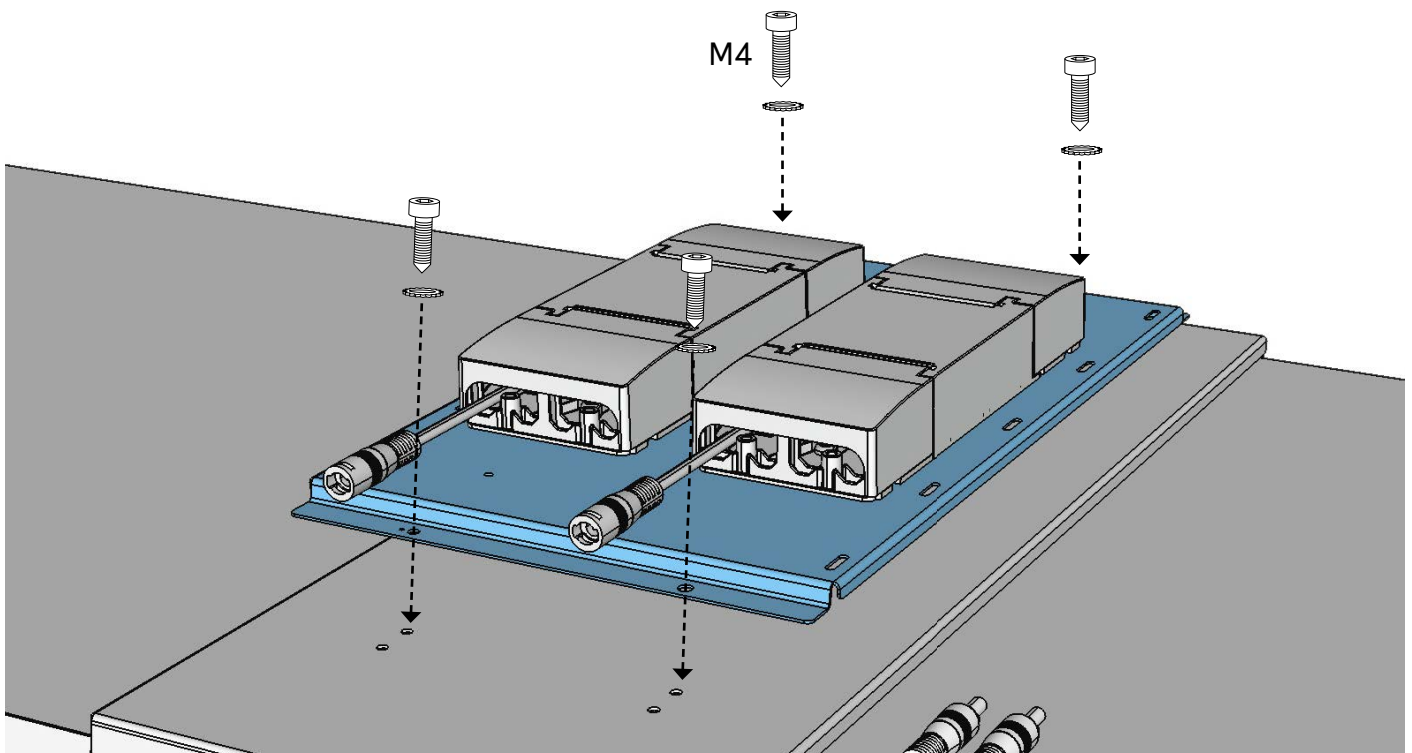

5

## Connect driver cables

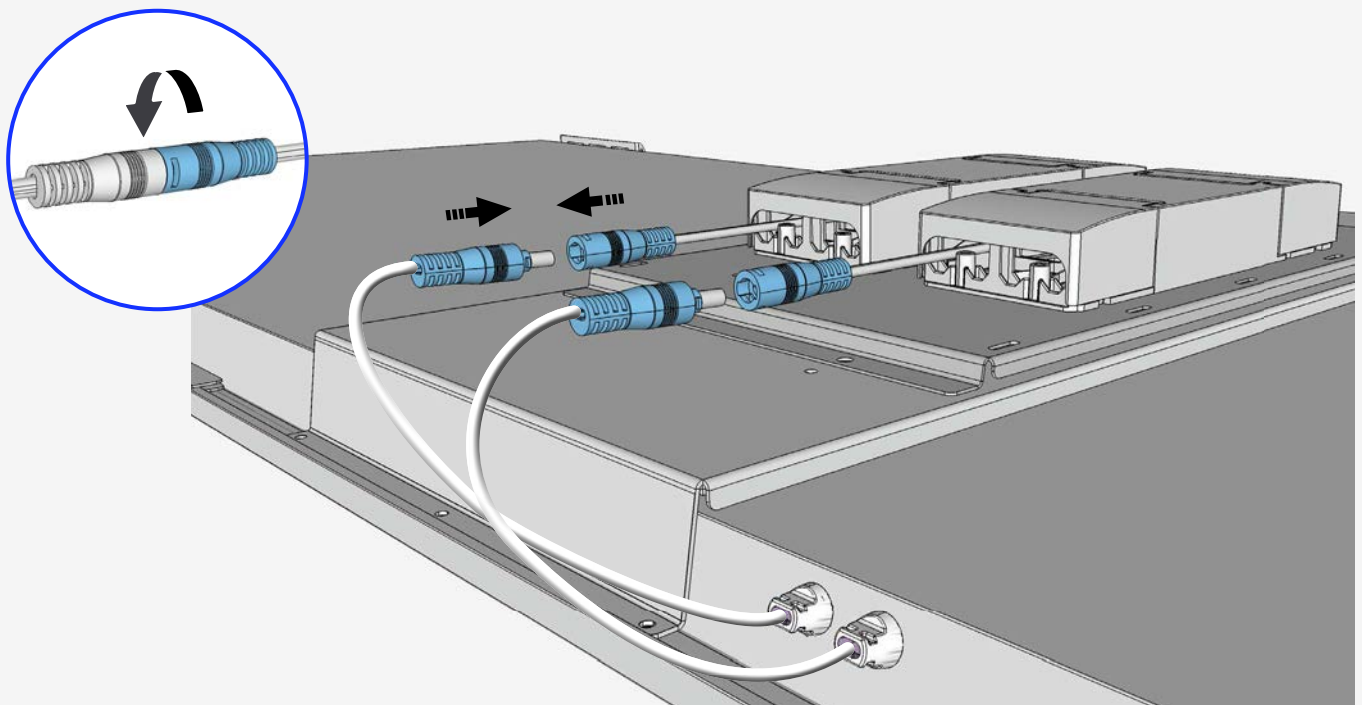

6

## Hook first panel onto the frame

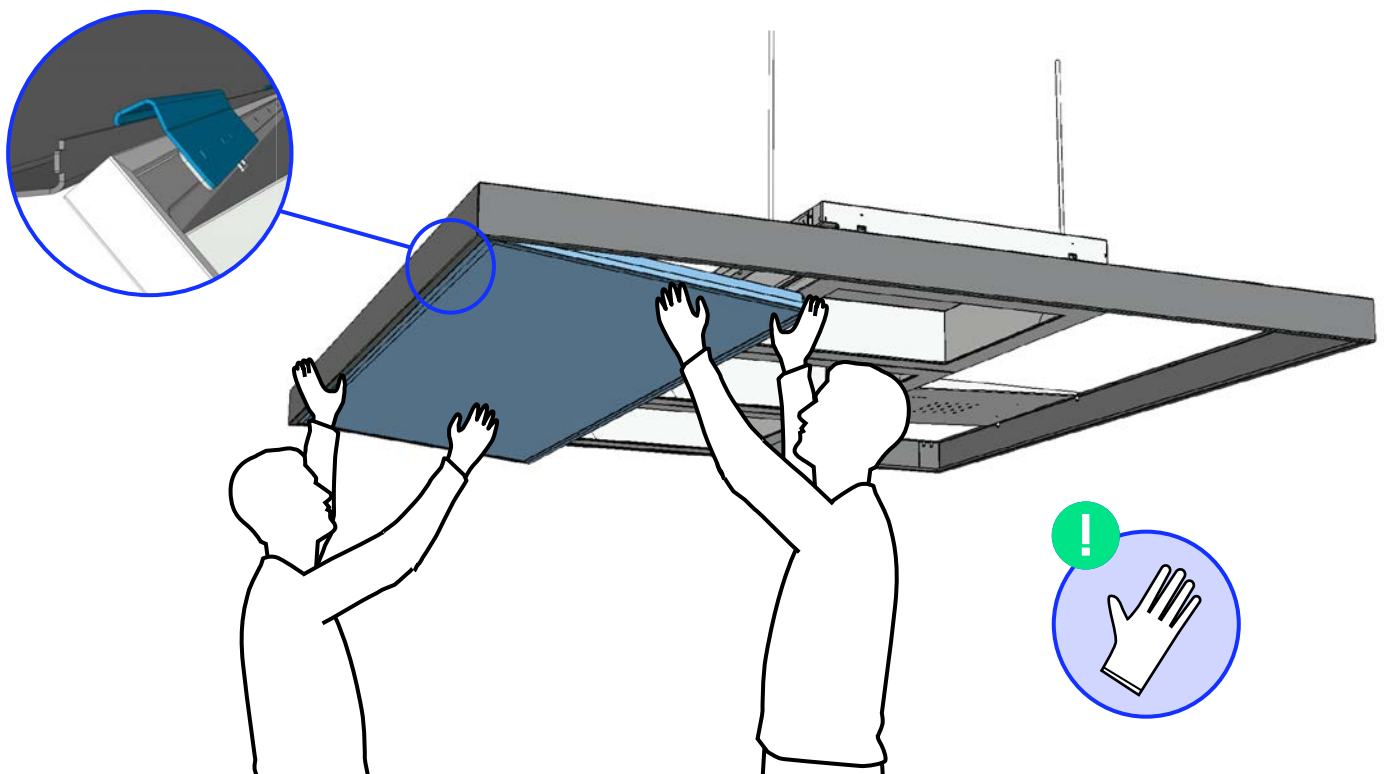

**7**

**Flip Daylight downwards in hanging position**

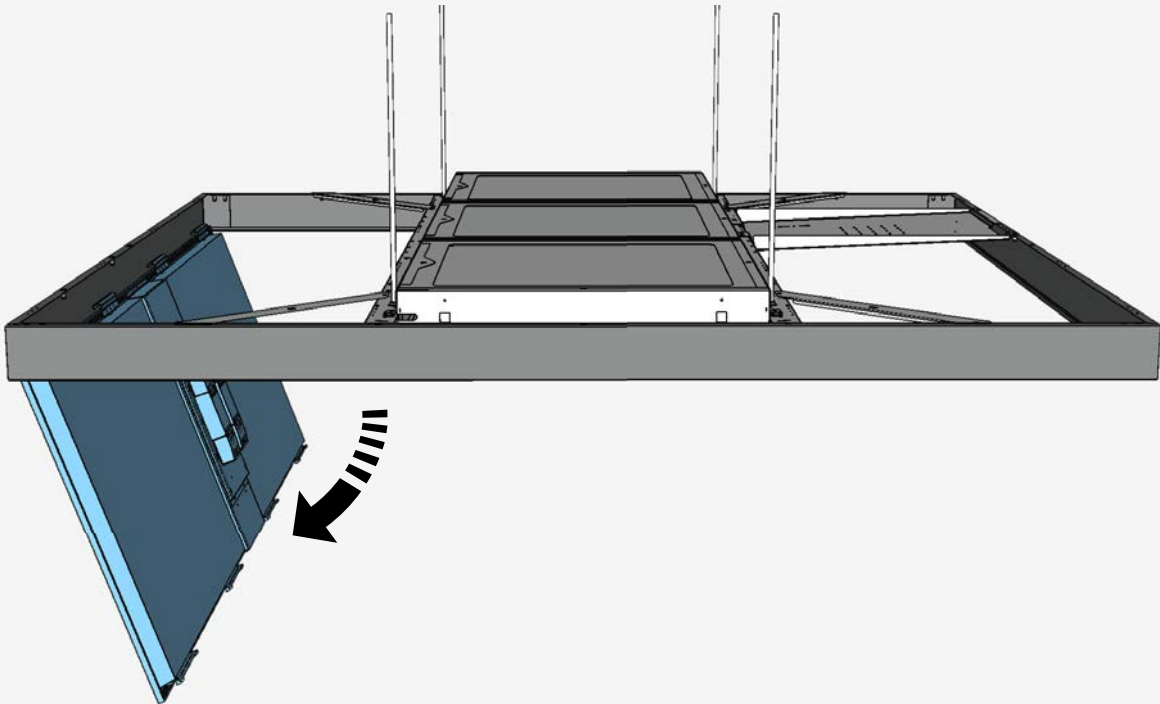

**8**

**Repeat for second Daylight**

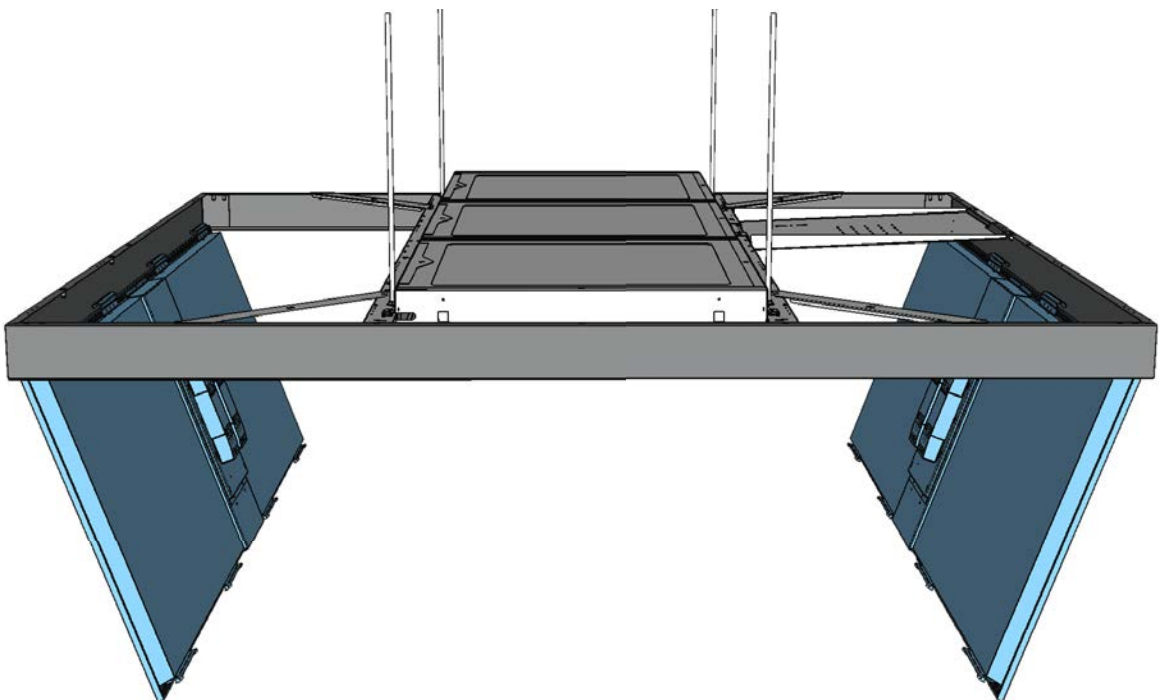

9

## Connect Skylights and Daylights

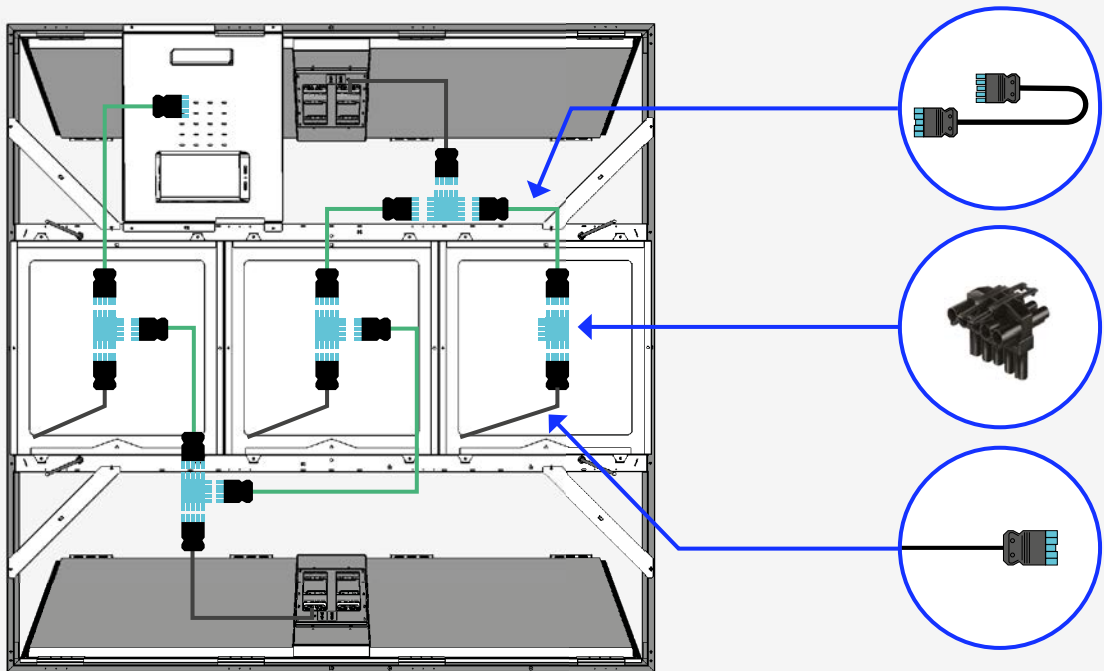

10

## Connect cables on the island gear tray

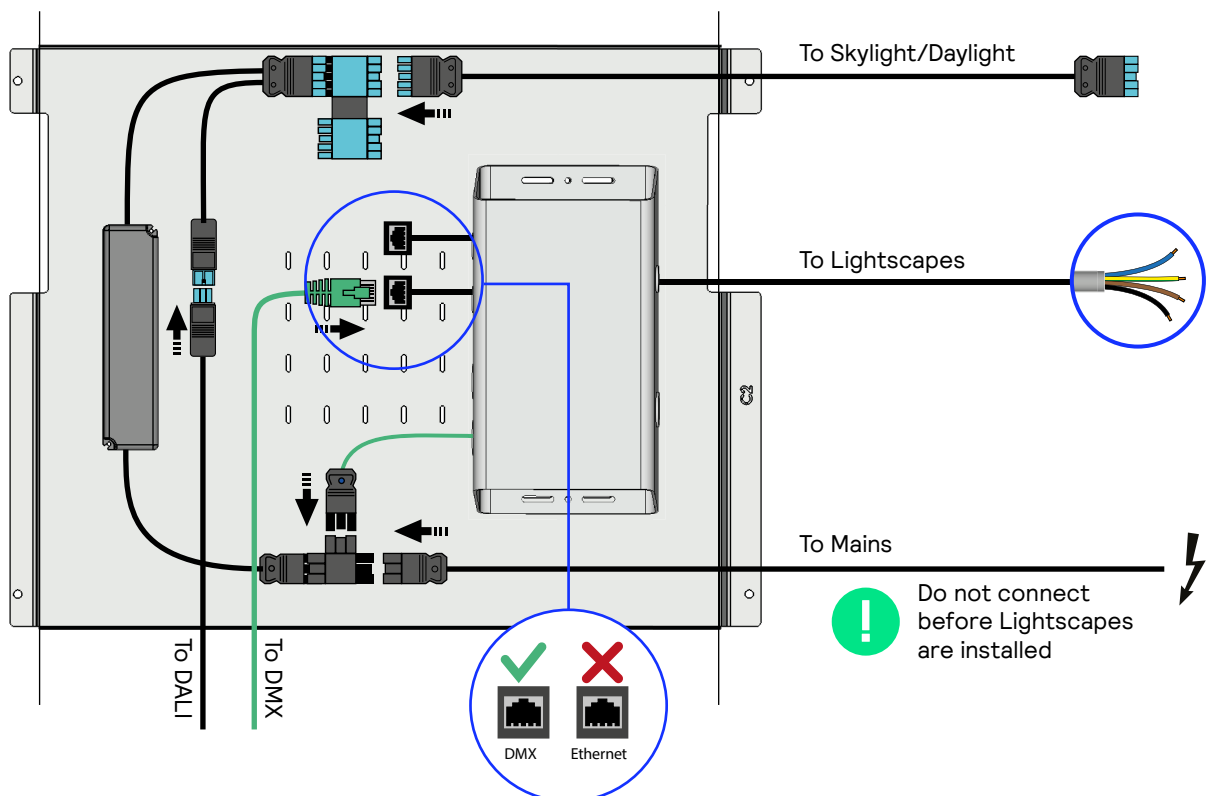

II

## Push Daylights into the frame

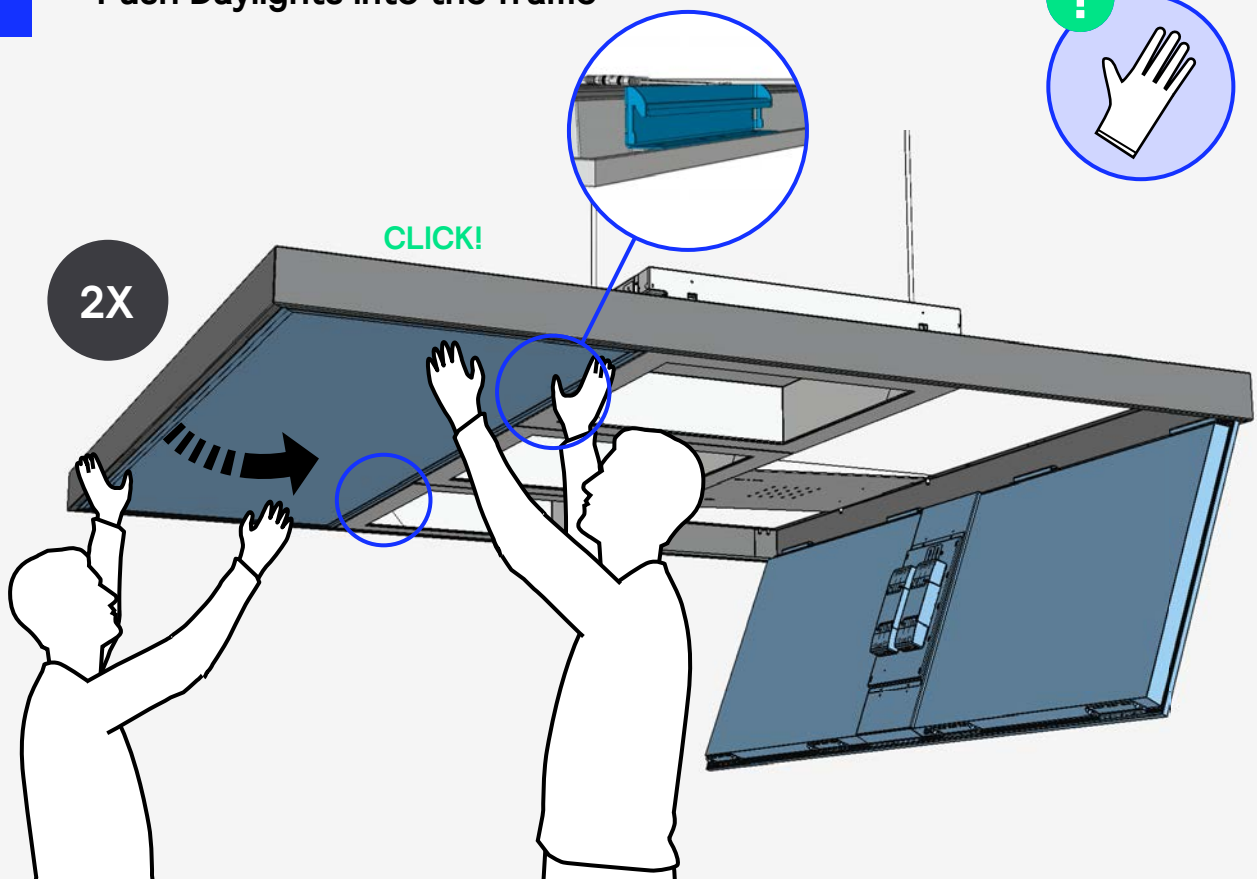

12

## Align elements

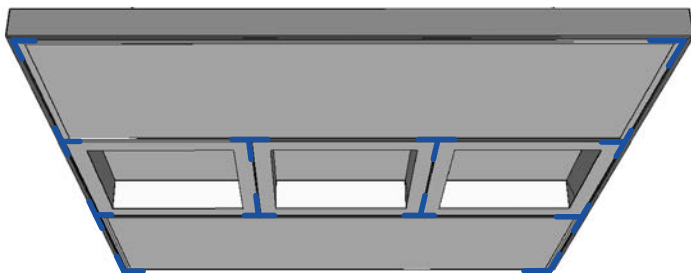

Align all corners

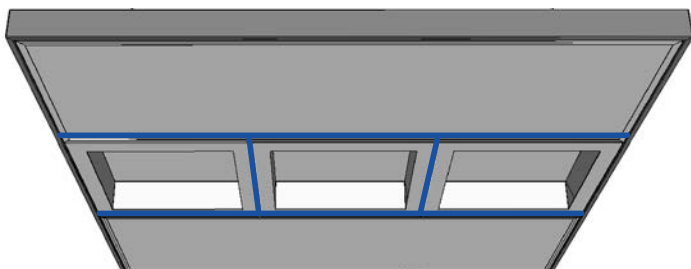

Keep a distance of  $\pm 2.5$  mm between all elements



There is a difference in height between the elements in the island.

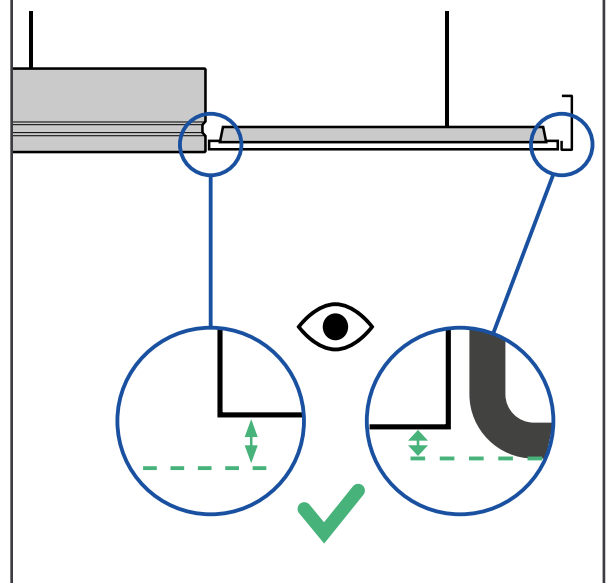



How to remove Daylights from the frame (optional)

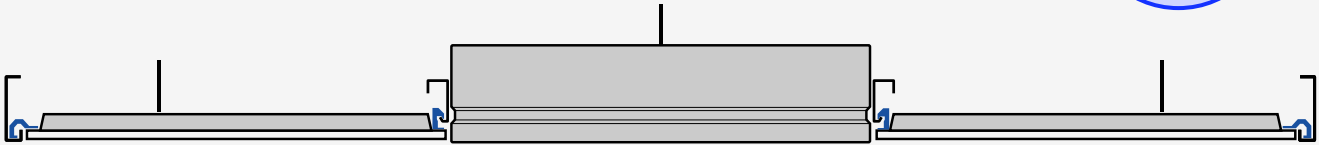

A

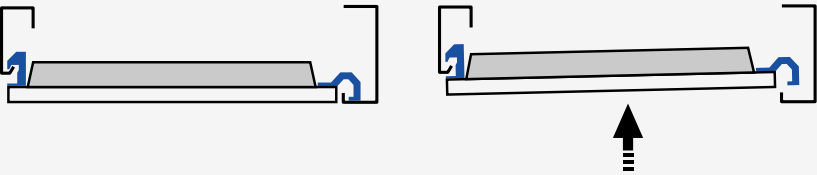

B

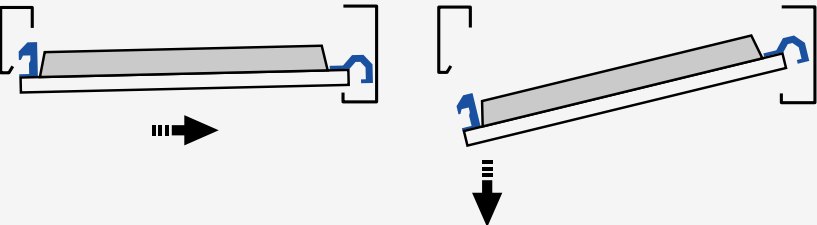

C

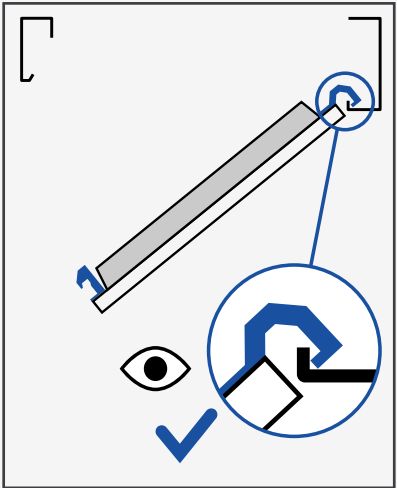



© 2022 Signify Holding. All rights reserved. The information provided herein is subject to change, without notice. Signify does not give any representation or warranty as to the accuracy or completeness of the information included herein and shall not be liable for any action in reliance thereon. The information presented in this document is not intended as any commercial offer and does not form part of any quotation or contract, unless otherwise agreed by Signify.

All trademarks are owned by Signify Holding or their respective owners