

Inductive sensor

NJ4-30GM-N-200



- 4 mm flush
- Temperature range
0 ... 200 °C (32 ... 392 °F)
- NAMUR output



Dimensions

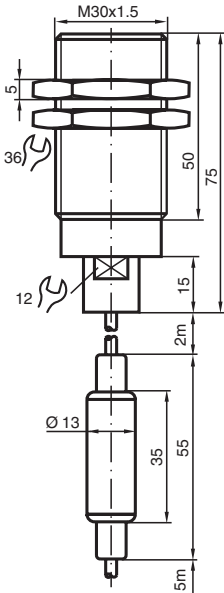

Technical Data

General specifications

Switching function		Normally closed (NC)
Output type		NAMUR
Rated operating distance	s_n	4 mm
Installation		flush
Assured operating distance	s_a	0 ... 3.04 mm
Reduction factor r_{AI}		0.15
Reduction factor r_{Cu}		0.05
Reduction factor r_{304}		0.55
Output type		2-wire

Nominal ratings

Nominal voltage	U_o	8.2 V (R_i approx. 1 k Ω)
Switching frequency	f	0 ... 1000 Hz
Hysteresis	H	$\leq 20\%$ at 200°C

Release date: 2025-06-13 Date of issue: 2025-06-17 Filename: 70133020_eng.pdf

Refer to "General Notes Relating to Pepperl+Fuchs Product Information".

Pepperl+Fuchs Group
www.pepperl-fuchs.com

USA: +1 330 486 0001
fa-info@us.pepperl-fuchs.com

Germany: +49 621 776 1111
fa-info@de.pepperl-fuchs.com

Singapore: +65 6779 9091
fa-info@sg.pepperl-fuchs.com

PEPPERL+FUCHS

Technical Data

Suitable for 2:1 technology		yes , Reverse polarity protection diode not required
Current consumption		
Measuring plate not detected		min. 3 mA
Measuring plate detected		≤ 1 mA
Compliance with standards and directives		
Standard conformity		
NAMUR		EN 60947-5-6:2000 IEC 60947-5-6:1999
Standards		EN IEC 60947-5-2
Approvals and certificates		
IECEX approval		
Equipment protection level Ga		IECEX PTB 11.0037X
Equipment protection level Gb		IECEX PTB 11.0037X
Equipment protection level Da		IECEX PTB 11.0037X
Equipment protection level Mb		IECEX PTB 11.0037X
ATEX approval		
Equipment protection level Ga		PTB 00 ATEX 2048 X
Equipment protection level Gb		PTB 00 ATEX 2048 X
Equipment protection level Da		PTB 00 ATEX 2048 X
UL approval		
Ordinary Location		E87056
Hazardous Location		E501628
Control drawing		116-0452
CCC approval		
Hazardous Location		2020322315002257
CML approval		on request
ANZEx		18.3018X
Ambient conditions		
Ambient temperature		0 ... 200 °C (32 ... 392 °F)
Mechanical specifications		
Connection type		cable
Housing material		Stainless steel 1.4305 / AISI 303
Sensing face		PPS
Degree of protection		IP65
Cable		
Cable diameter		4 mm ± 0.2 mm
Bending radius		> 7.5 x cable diameter
Material		FEP
Core cross section		0.34 mm ²
Length	L	5 m
Dimensions		
Length		75 mm
Diameter		30 mm
Note		amplifier -25°C...70°C 2 m PTFE cable between amplifier and oscillator
General information		
Use in the hazardous area		see instruction manuals

Release date: 2025-06-13 Date of issue: 2025-06-17 Filename: 70133020_eng.pdf

Connection Assignment



Release date: 2025-06-13 Date of issue: 2025-06-17 Filename: 70133020_eng.pdf

Refer to "General Notes Relating to Pepperl+Fuchs Product Information".

Pepperl+Fuchs Group
www.pepperl-fuchs.com

USA: +1 330 486 0001
fa-info@us.pepperl-fuchs.com

Germany: +49 621 776 1111
fa-info@de.pepperl-fuchs.com

Singapore: +65 6779 9091
fa-info@sg.pepperl-fuchs.com