

Inductive sensor

NRB15-30GS50-E2-IO

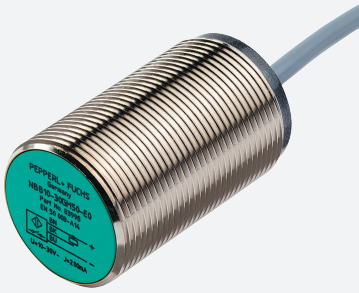

- 15 mm flush
- Reduction factor = 1
- Magnetic field resistant
- IO-Link interface for service and process data
- Switch point mode or window mode can be set
- Switching function, stability alarm and pulse extension can be set



Function

Reduction factor 1 sensors reliably detect different metals with the same switch state. The integrated IO-Link interface enables clear identification of the sensor and diagnosis of the sensor condition. When using the sensor, parameters and operating modes can be optimally configured specifically for the intended application. In addition to setting the switching function and a pulse extension, the user can select either switch point mode or window mode in combination with a stability alarm. In switch point mode, the stability alarm signals the detection of an object in the area between the assured operating distance and operating distance s_n . In window mode, it signals the detection of an object below the window between operating distance s_n and the nearest operating distance. A stability alarm is displayed to the user via a flashing LED and process data.

Dimensions

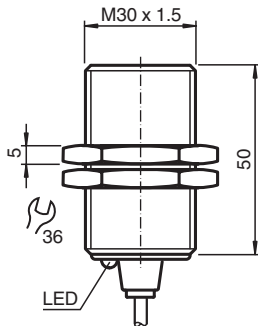

Technical Data

General specifications

| | | |
|-----------------------------|-------|---|
| Switching function | | Normally open/closed (NO/NC) programmable |
| Output type | | PNP |
| Rated operating distance | s_n | 15 mm (factory setting) |
| Near operating distance | | 10 mm (can be activated by software) |
| Installation | | flush |
| Output polarity | | DC |
| Assured operating distance | s_a | 0 ... 12.15 mm |
| Reduction factor r_{Al} | | 1 |
| Reduction factor r_{Cu} | | 1 |
| Reduction factor r_{304} | | 1 |
| Reduction factor r_{St37} | | 1 |
| Output type | | 3-wire |

Nominal ratings

Technical Data

| | | |
|---|-----------|---|
| Operating voltage | U_B | 10 ... 30 V DC |
| Switching frequency | f | 0 ... 600 Hz (switch point mode) 0 ... 25 Hz (window mode, switch point mode with stability alarm) |
| Hysteresis | H | typ. 3 % |
| Reverse polarity protection | | reverse polarity protected |
| Short-circuit protection | | pulsing |
| Voltage drop | U_d | ≤ 0.5 V |
| Operating current | I_L | 0 ... 200 mA |
| Off-state current | I_r | 0 ... 0.5 mA typ. 60 μ A at 25 °C |
| No-load supply current | I_0 | ≤ 15 mA |
| Time delay before availability | t_v | max. 150 ms |
| Constant magnetic field | B | 200 mT |
| Alternating magnetic field | B | 200 mT |
| Status indicator | | LED yellow |
| Functional safety related parameters | | |
| MTTF _d | | 362 a |
| Mission Time (T_M) | | 20 a |
| Diagnostic Coverage (DC) | | 0 % |
| Interface | | |
| Interface type | | IO-Link (via C/Q) |
| IO-Link revision | | 1.1 |
| Device ID | | 0x201003 (2101251) |
| Transfer rate | | COM2 (38.4 kBit/s) |
| Min. cycle time | | 2.3 ms |
| Process data width | | Process data input (control system side): 2 Bit Process data output (control system side): none |
| SIO mode support | | yes |
| Compatible master port type | | A |
| Compliance with standards and directives | | |
| Standard conformity | | |
| Standards | | EN IEC 60947-5-2 |
| Approvals and certificates | | |
| Protection class | | II |
| Rated insulation voltage | U_i | 60 V |
| Rated impulse withstand voltage | U_{imp} | 800 V |
| UL approval | | cULus Listed Load Type: General Purpose Circuitry: Class 2 Power Source Enclosure Type Rating: Type 1 Supply/Switching Voltage: 30 V DC Output Switching Current: 200 mA |
| CCC approval | | CCC approval / marking not required for products rated ≤ 36 V |
| Ambient conditions | | |
| Ambient temperature | | -25 ... 70 °C (-13 ... 158 °F) |
| Storage temperature | | -40 ... 85 °C (-40 ... 185 °F) |
| Mechanical specifications | | |
| Connection type | | cable |
| Housing material | | Stainless steel 1.4305 / AISI 303 |
| Sensing face | | PBT |
| Degree of protection | | IP67 |
| Cable | | |
| Wire end ferrules | | yes |
| Cable diameter | | 4.3 mm \pm 0.1 mm |
| Bending radius | | > 15 x cable diameter |
| Material | | PVC |
| Color | | black |

Release date: 2025-06-10 Date of issue: 2025-06-10 Filename: 306533-0022_eng.pdf

Refer to "General Notes Relating to Pepperl+Fuchs Product Information".

Pepperl+Fuchs Group
www.pepperl-fuchs.comUSA: +1 330 486 0001
fa-info@us.pepperl-fuchs.comGermany: +49 621 776 1111
fa-info@de.pepperl-fuchs.comSingapore: +65 6779 9091
fa-info@sg.pepperl-fuchs.com
 **PEPPERL+FUCHS**

Technical Data

| | | |
|---------------------|--|----------|
| Number of cores | | 3 |
| Core cross section | | 0.34 mm² |
| Length | L | 2 m |
| Mass | | 177 g |
| Dimensions | | |
| Length | | 40 mm |
| Diameter | | 30 mm |
| Factory settings | | |
| Default setting | operating mode = switch point mode with stability alarm switching function = Normally open (NO) switching distance = 15 mm | |
| General information | | |
| Scope of delivery | 2 self locking nuts in scope of delivery | |

Connection

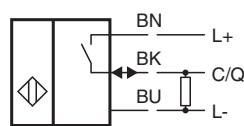

Function Principle

Switching output modes

Switch point mode at rated operating distance s_n

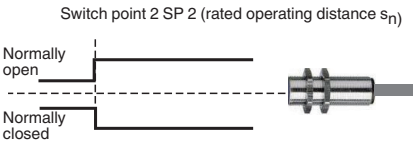

Switch point mode with near operating distance

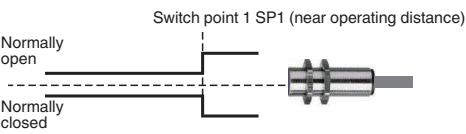

Window mode

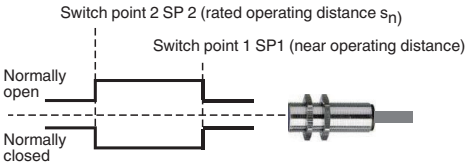

Release date: 2025-06-10 Date of issue: 2025-06-10 Filename: 306533-0022_eng.pdf

Function Principle

Stability alarm

Switch point mode with stability alarm (factory default)

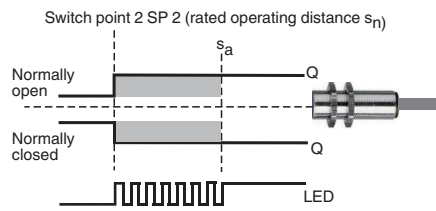

Window mode with stability alarm

