

Supporti - Serie M Ø 45 mm

Per motori tubolari senza manovra di soccorso

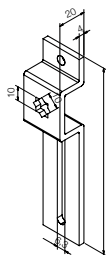

525.10094

Supporto regolabile sede a stella da 10 mm

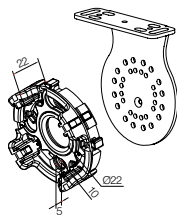

525.20096

Kit staffa bianca lato motore per rulli Acmeda S60/80 e supporto a scatto e compatto, max 30 Nm

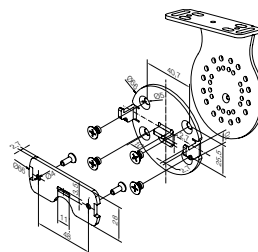

525.20098

Kit staffa bianca lato motore per rulli Acmeda S60/80 e kit supporti bianchi con flange per motori Ø 45 mm

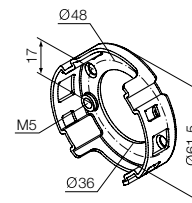

535.10010

Supporto compatto, con 2 fori M5

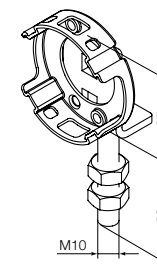

535.10011

Supporto compatto, regolabile a vite M10

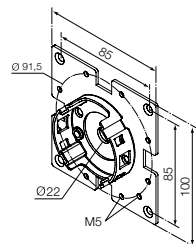

535.10012

Supporto compatto, con flangia 100x100

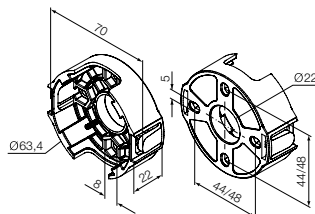

535.10013 max 30 Nm

Supporto compatto in plastica, ad esagono incassato a interasse 44/48 mm

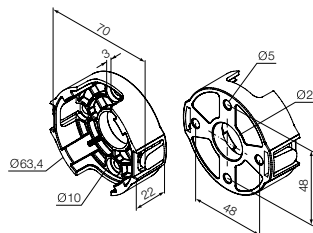

535.10014 max 30 Nm

Supporto compatto in plastica, a vite incassata a interasse 48 mm

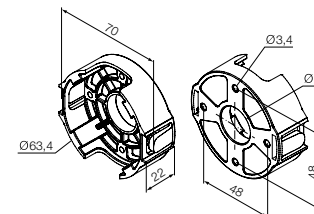

535.10015 max 30 Nm

Supporto compatto in plastica, per vite autofilettante a interasse 48 mm

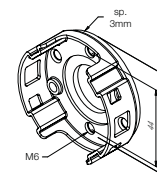

535.10016/A

Supporto compatto a 90° con 2x fori M6 a interasse 44mm

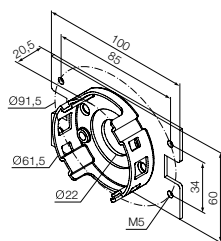

535.10017

Supporto compatto, con flangia 100x60

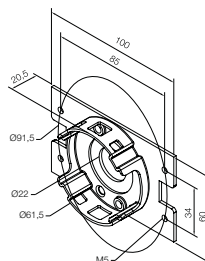

535.10017/A

Supporto compatto a 90°, con flangia 100x60

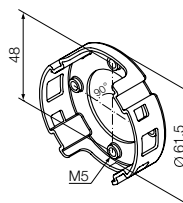

535.10022

Supporto compatto, con 4 fori M5

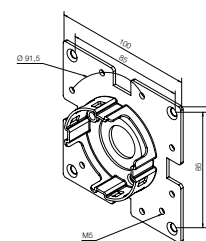

535.10027

Supporto compatto a 45°, con flangia 100x100

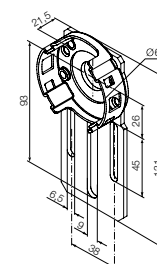

535.10037

Supporto compatto, regolabile (standard)