

SERIES | SERIES: SKYLUM RF

BRAND: i-LED

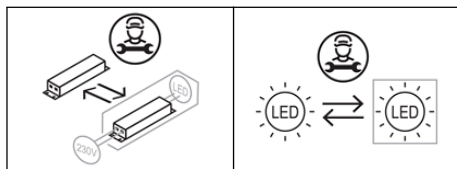

SKYLUM RF

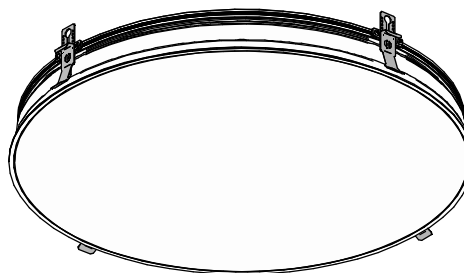
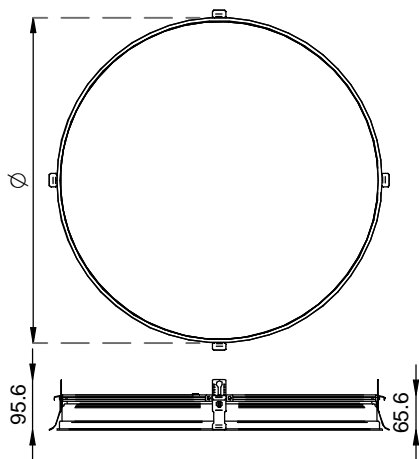

CODICE
CODE

CODE	Control	Input [V]	Height [mm]	Ø [mm]	Power [W]	Weight [Kg]	Safety Class	IP	CRI	Color Temp. [°K]			N° Light Source
										2700	3000	4000	
C01608	ON-OFF	220-240	95,6	420	27	3	1	40	90	E	E	E	1
C01609	DALI 2 PUSH	220-240	95,6	420	27	3	1	40	90	E	E	E	1
C01610	ON-OFF	220-240	95,6	615	52	5	1	40	90	E	E	E	1
C01611	DALI 2 PUSH	220-240	95,6	615	52	5	1	40	90	E	E	E	1
C01612	ON-OFF	220-240	95,6	920	99	10	1	40	90	E	E	E	1
C01613	DALI 2 PUSH	220-240	95,6	920	99	10	1	40	90	E	E	E	1
C01614	ON-OFF	220-240	95,6	1160	162	15	1	40	90	E	E	E	1
C01615	DALI 2 PUSH	220-240	95,6	1160	162	15	1	40	90	E	E	E	1

Ta
-20°C ÷ 50°C

SERIES | SERIES: SKYLUM RF

BRAND: i-L^{ED}

ACCESSORI INCLUSI | *INCLUDEL ACCESSORIES* ACCESSORI NON INCLUSI | *NOT INCLUDEL ACCESSORIES*

STAFFE DI MONTAGGIO
MOUNTING BRACKETS

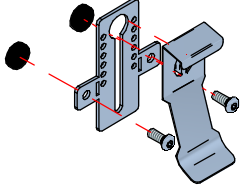

DALI Power Supply



99309
99310
C-E300002

Scene COM EVO



83146

OPTI Touch 4"



C-E700019 + 83009 (driver)

OPTI Touch 7"



C-E700020 + 83009 (driver)

DALI XC

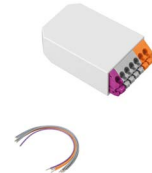

99311

PRE-INSTALLAZIONE / PRE-INSTALLATION

A

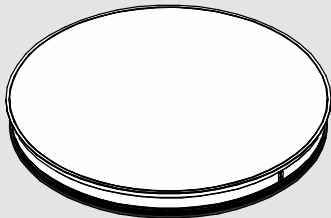

SUPERFICIE DI LAVORO
WORK SURFACE

C

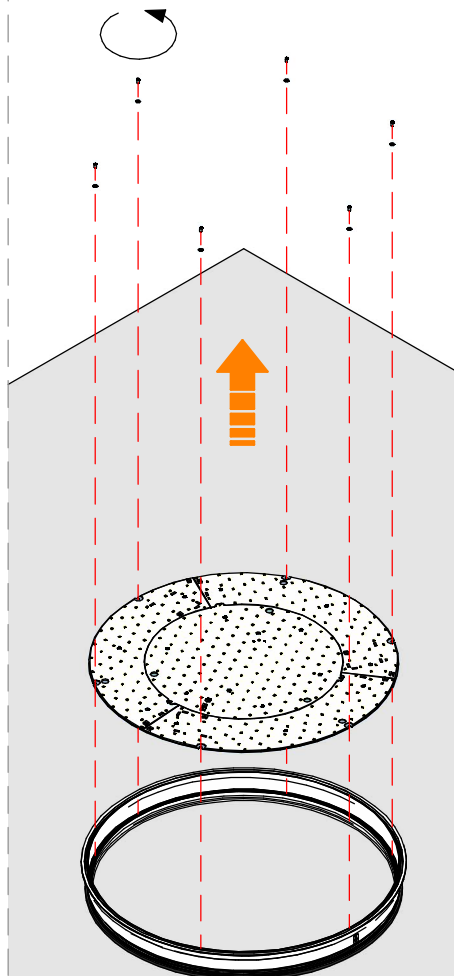

D

HEX 2.5



B

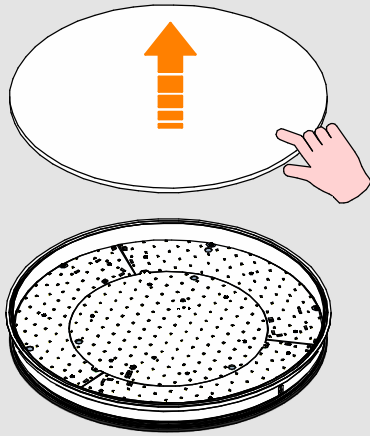

E

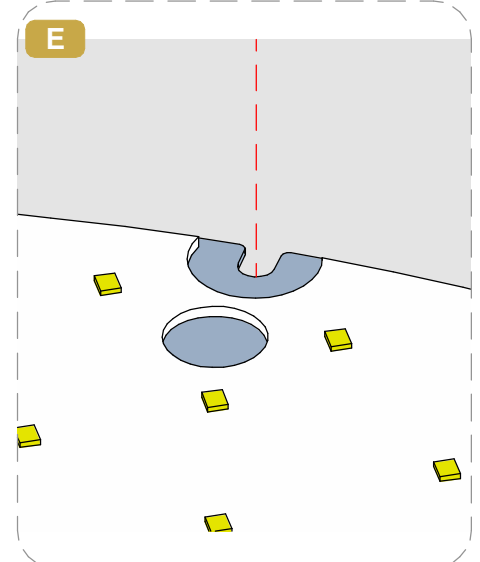

SERIES | SERIES: SKYLUM RF

BRAND: i-LèD

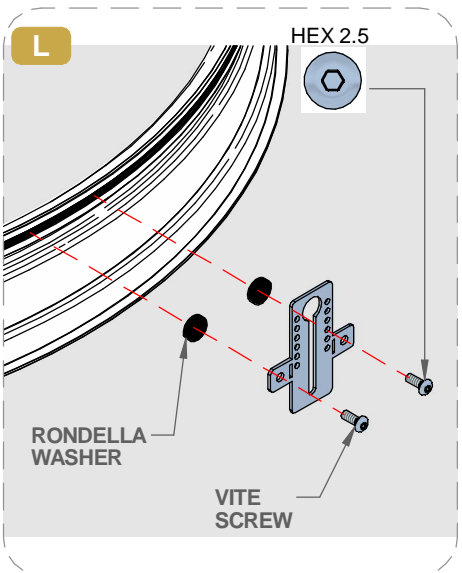
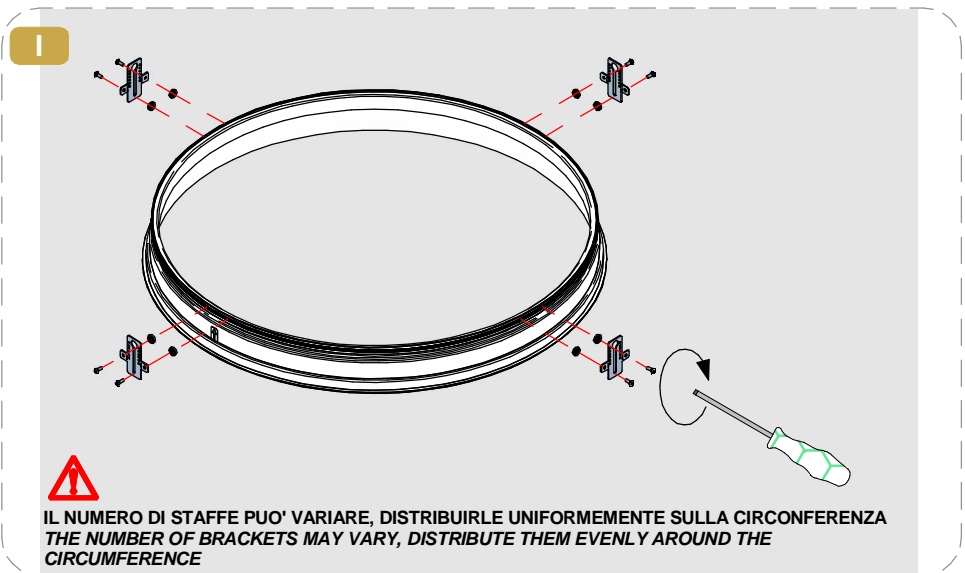
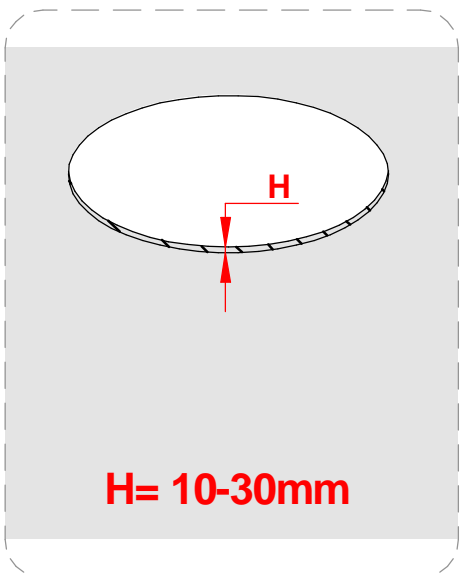
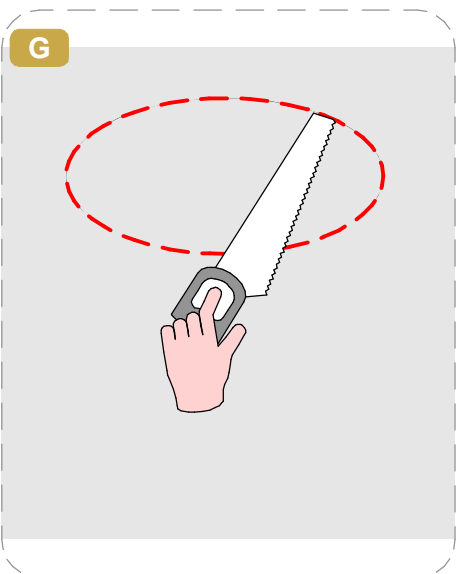
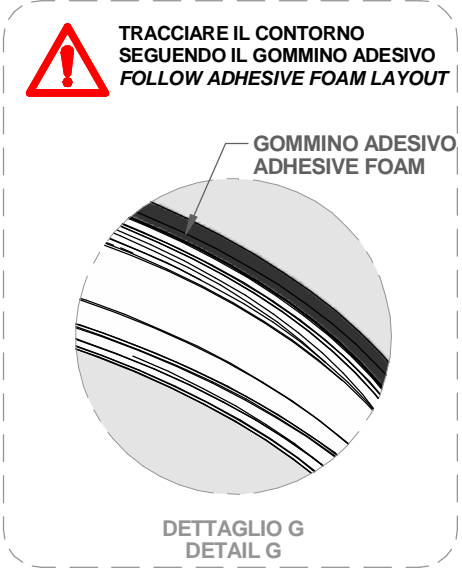
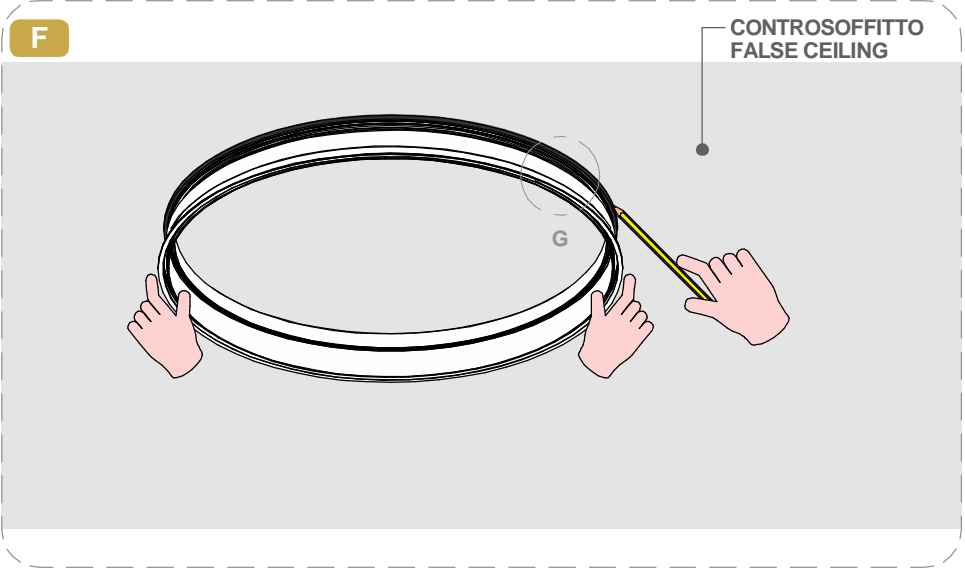

SERIES | SERIES: SKYLUM RF

BRAND: i-L^èD

M

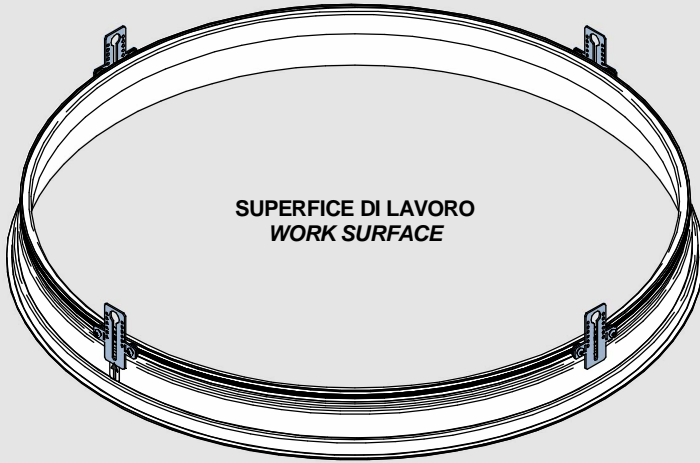

INSTALLAZIONE / INSTALLATION

1

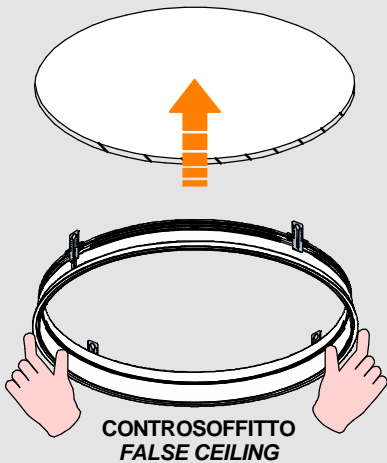

2

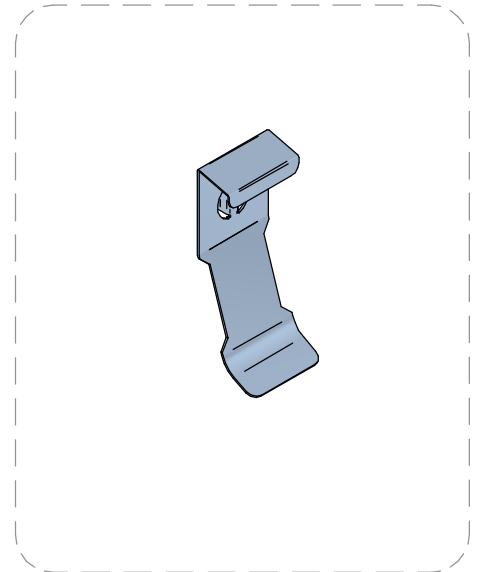

3

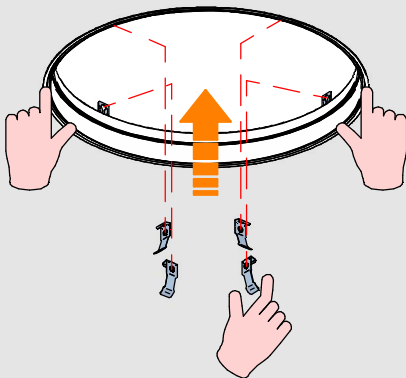

4

VISTA SUPERIORE
TOP VIEW

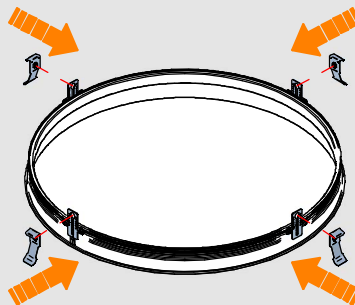

5

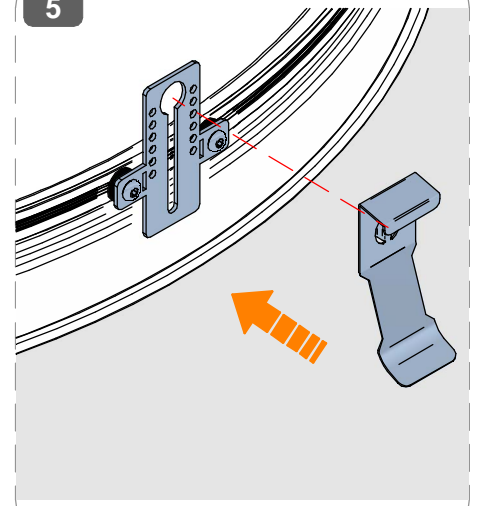

SERIES | SERIES: SKYLUM RF

BRAND: i-L^èD

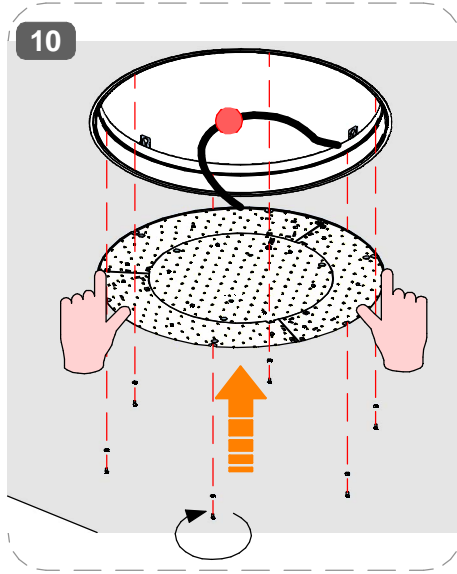
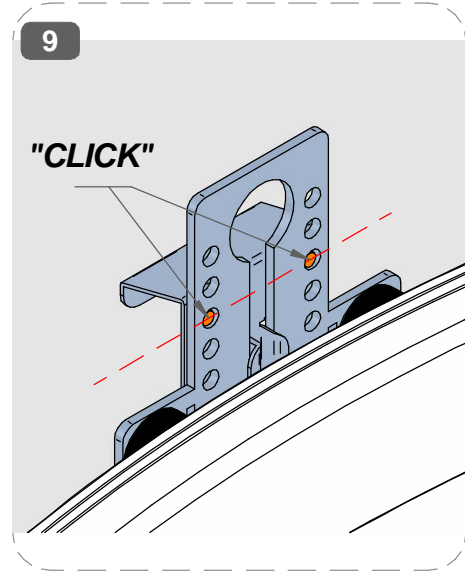
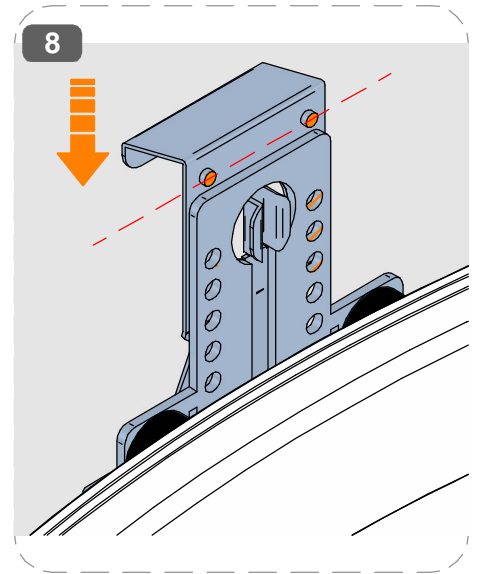
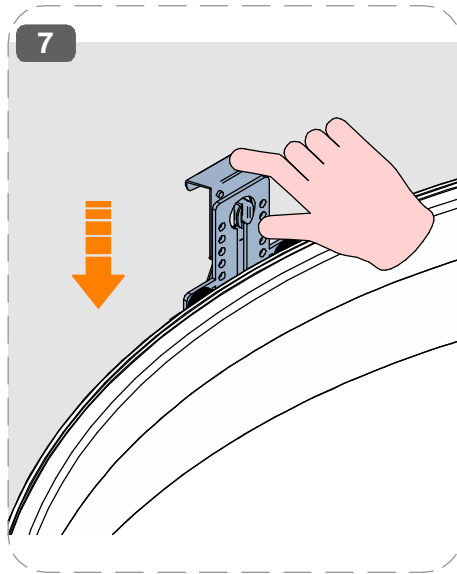
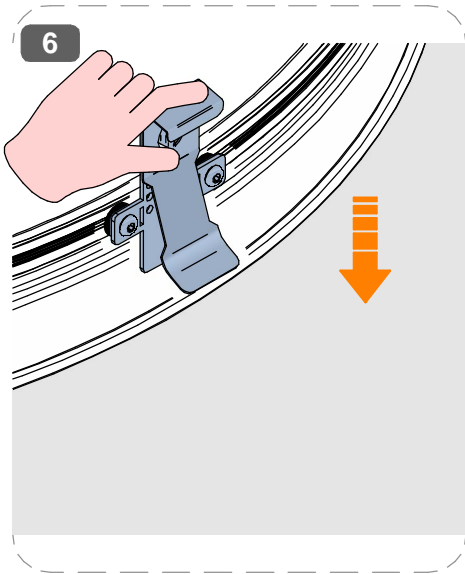

COLLEGAMENTO ELETTRICO
ELECTRICAL WIRING

NON TOCCARE I DIODI
OD I COLLEGAMENTI
INTERNI

DO NOT TOUCH THE
DIODES OR INTERNAL
CONNECTIONS

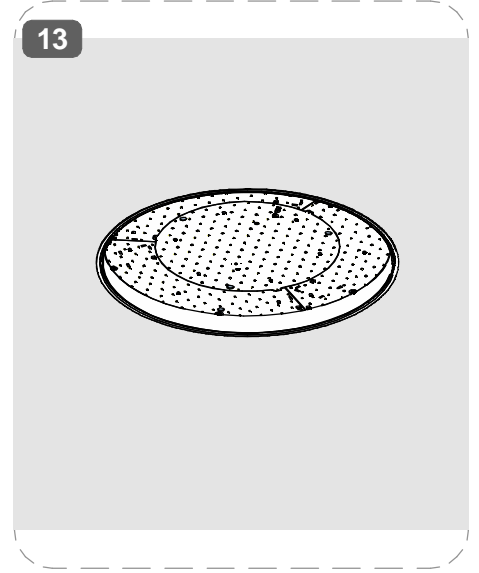
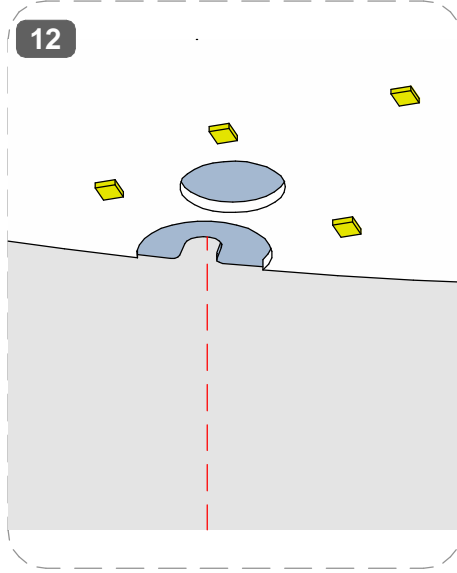
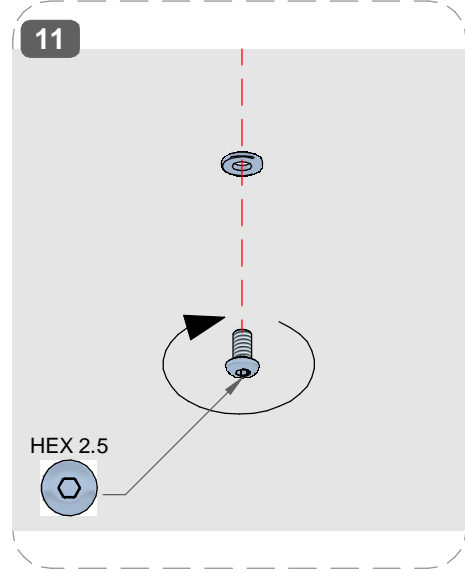

SERIES | SERIES: SKYLUM RF

BRAND: i-L^èD

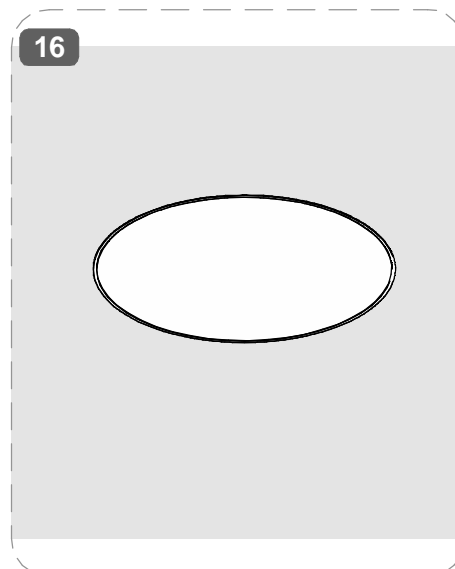
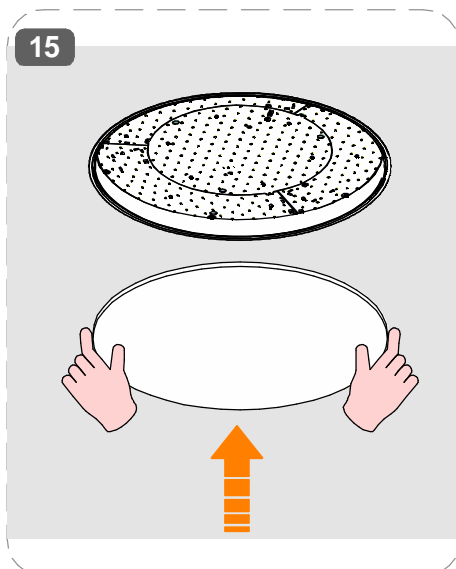
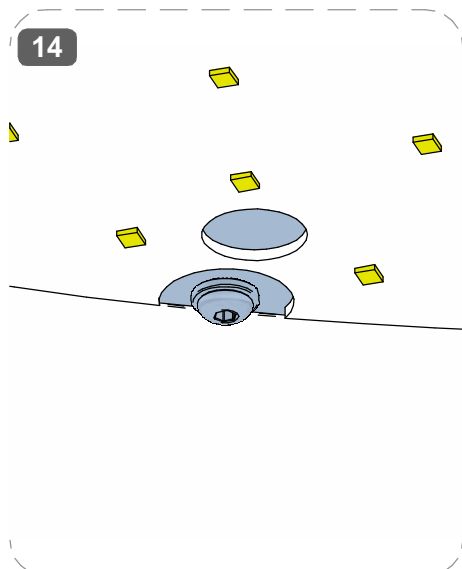

CABLAGGIO / WIRING

1

TUTTE LE OPERAZIONI DI COLLEGAMENTO ALLA RETE ELETTRICA DEVONO ESSERE CONDOTTE IN MANCANZA DI TENSIONE

ALL THE WIRING OPERATION MUST BE PERFORMED WITH MCB IN OFF POSITION

2

SE IL PRODOTTO E' DEFINITO IN CLASSE 1, IL CONDUTTORE DI MESSA A TERRA DI PROTEZIONE DEVE ESSERE SEMPRE COLLEGATO

IF THE FITTING IS CLASS 1 RATED, THE CPC | EARTH | PE CONDUCTOR MUST BE CONNECTED

3

SE L'IMPIANTO E' STATO COMPLETATO ED E' IN SICUREZZA, PUO' ESSERE ALIMENTATO

WHEN THE CIRCUIT IS COMPLETED AND SAFE, MCB CAN BE SET IN ON POSITION

SI PREGA SEGUIRE LE BUONE PRATICHE DI DIMENSIONAMENTO E SEZIONAMENTO DELL'IMPIANTO ELETTRICO, TENENDO PRESENTE: LE CARATTERISTICHE DELL'INTERRUTTORE DIFFERENZIALE ED IL NUMERO DI ARTICOLI COLLEGATI ALLA LINEA ELETTRICA; QUESTO PER AGEVOLARE L'IDENTIFICAZIONE DI EVENTUALI ANOMALIE SULLA LINEA ELETTRICA

PLEASE FOLLOW THE BEST PRACTICES IN ELECTRICAL SYSTEM DESIGN, PAING ATTENTION TO THE RCCB SWITCH CHARACTERISTICS AND THE NUMBER OF FITTINGS CONNECTED TO THE ELETRICAL LINE; THIS HELPS TO INDETIFY POSSIBLE ANOMALIES ON THE ELETRICAL LINE

AC

CORRENTE ALTERNATA

MAX. DISTANZA TRA DRIVER ED ULTIMO PRODOTTO | SEZIONE CAVO

ALTERNATE CURRENT

DRIVER TO LAST LIGHT FITTING MAX DISTANCE | WIRE SECTION

SEZIONE SECTION [mm2]	1	1.5	2.5
LUNGHEZZA LENGHT [m]	50	75	130

* Distanza massima dal driver all'ultimo articolo della linea a massimo carico.

Per lunghezze massime dei cavi effettive, fare riferimento a support@linealight.com

* Maximum distance between LED driver and last device at full load.

For effective maximum cable lengths, please refer to support@linealight.com

SERIES | SERIES: SKYLUM RF

BRAND: i-LèD

MARRONE / BROWN = LINEA / LINE

AZZURRO / LIGHT BLUE = NEUTRO / NEUTRAL

GIALLO-VERDE / YELLOW-GREEN = TERRA / EARTH CPC | PE

CABLAGGIO IN PARALLELO | PARALLEL WIRING
TENSIONE DI RETE / MAINS VOLTAGE

AC

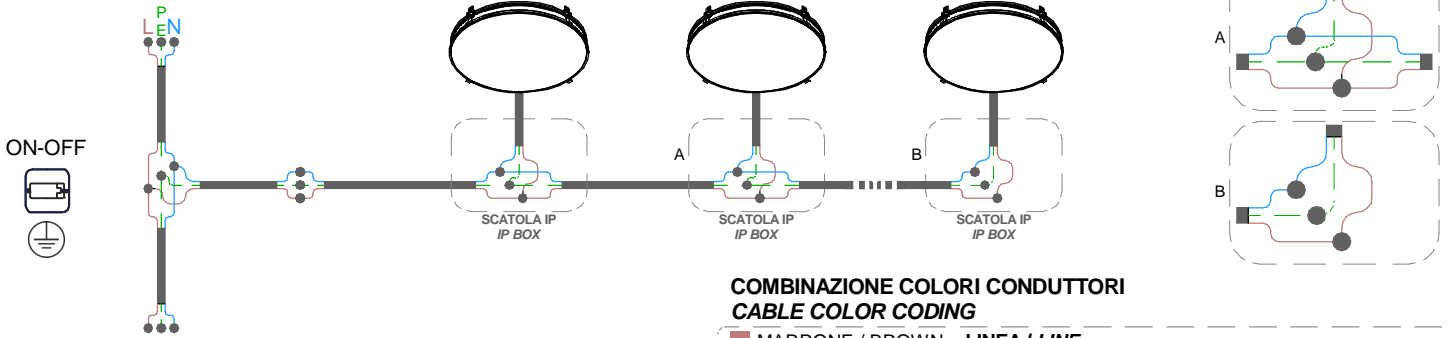

COMBINAZIONE COLORI CONDUTTORI
CABLE COLOR CODING

MARRONE / BROWN = LINEA / LINE

AZZURRO / LIGHT BLUE = NEUTRO / NEUTRAL

GIALLO-VERDE / YELLOW-GREEN = TERRA / EARTH CPC | PE

CABLAGGIO IN PARALLELO | PARALLEL WIRING
TENSIONE DI RETE / MAINS VOLTAGE

AC

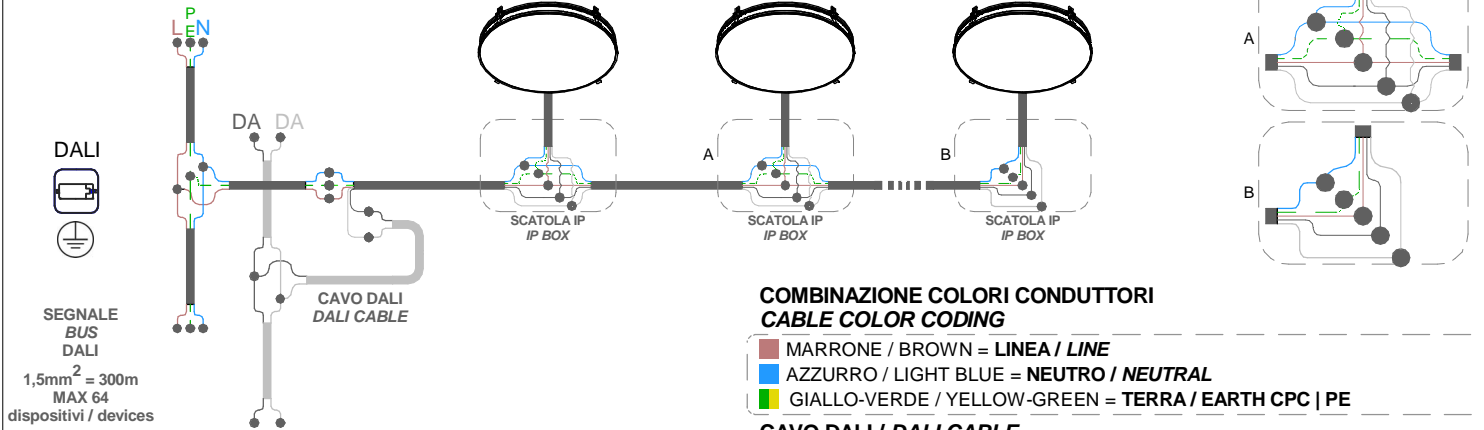

COMBINAZIONE COLORI CONDUTTORI
CABLE COLOR CODING

MARRONE / BROWN = LINEA / LINE

AZZURRO / LIGHT BLUE = NEUTRO / NEUTRAL

GIALLO-VERDE / YELLOW-GREEN = TERRA / EARTH CPC | PE

CAVO DALI / DALI CABLE

GRIGIO / GREY = DALI 1

GRIGIO CHIARO / LIGHT GREY = DALI 2

CABLAGGIO IN PARALLELO | PARALLEL WIRING
TENSIONE DI RETE / MAINS VOLTAGE

AC

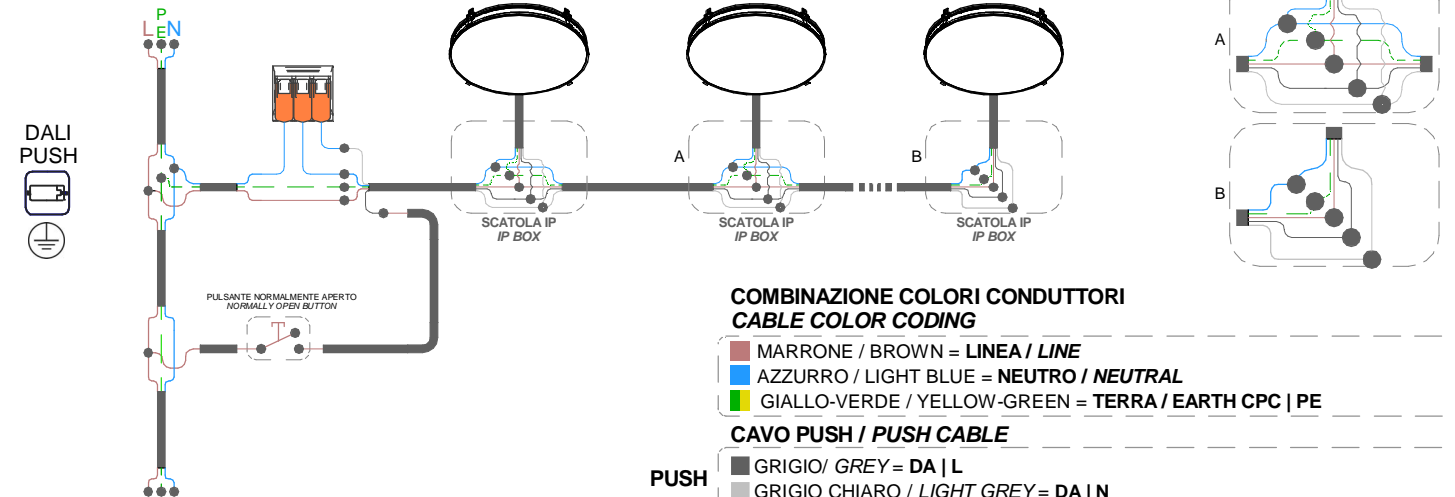

COMBINAZIONE COLORI CONDUTTORI
CABLE COLOR CODING

MARRONE / BROWN = LINEA / LINE

AZZURRO / LIGHT BLUE = NEUTRO / NEUTRAL

GIALLO-VERDE / YELLOW-GREEN = TERRA / EARTH CPC | PE

CAVO PUSH / PUSH CABLE

GRIGIO / GREY = DA | L

GRIGIO CHIARO / LIGHT GREY = DA | N