

SERIES | SERIES: PROLAMP 3.0

BRAND: i-LèD



37 W

72W

100 W

120-150 W

180-200W

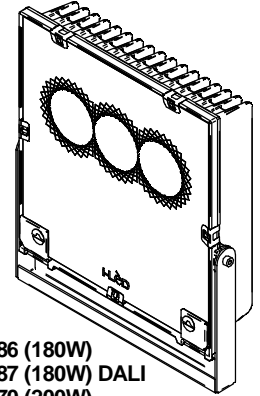
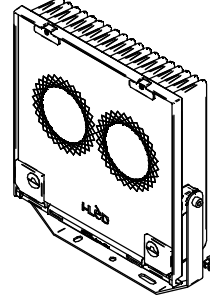
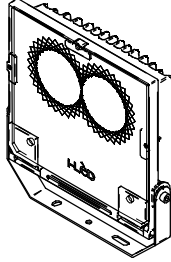
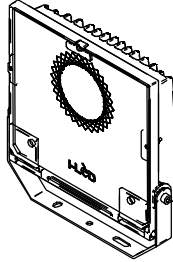
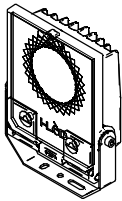

82270  
82271 DALI

82272  
82273 DALI

84068  
84441 DALI

82274 (120W)  
82275 (120W) DALI  
84069 (150W)  
84442 (150W) DALI

82286 (180W)  
82287 (180W) DALI  
84070 (200W)  
84443 (200W) DALI

CODICI / CODES

CODE	Input [V]	Dimensio- ns [mm]	Power [W]	Weight [Kg]	Walk Over	IK	Safety Class	IP	CRI	Energy Class	N° Light Source	Conn. Type
82270	220-240	240x192x75	37	1.7	No	8	1	66	80	E	1	Y
82271	220-240	240x192x75	37	1.7	No	8	1	66	80	E	1	Y
82272	220-240	300x292x78	72	3.8	No	8	1	66	80	E	1	Y
82273	220-240	300x292x78	72	3.8	No	8	1	66	80	E	1	Y
84068	220-240	300x292x78	100	3.8	No	8	1	66	80	E	1	Y
84441	220-240	300x292x78	100	3.8	No	8	1	66	80	E	1	Y
82274	220-240	348x324x78	120	4.6	No	8	1	66	80	E	1	Y
82275	220-240	348x324x78	120	4.6	No	8	1	66	80	E	1	Y
84069	220-240	348x324x78	150	4.6	No	8	1	66	80	E	1	Y
84442	220-240	348x324x78	150	4.6	No	8	1	66	80	E	1	Y
82286	220-240	439x391x94	180	7.8	No	8	1	66	80	E	1	Y
82287	220-240	439x391x94	180	7.8	No	8	1	66	80	E	1	Y

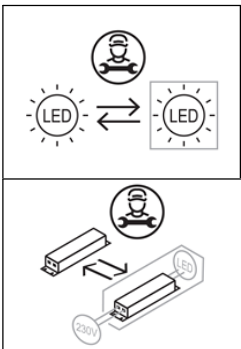

ACCESSORI NON INLUSI | NOT INCLUDED ACCESSORIES

GABBIA PROTETTIVA  
PROTECTIVE GRID

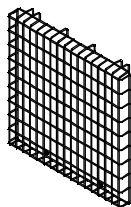

99391 (37W)  
99392 (72-100W)  
99574 (120-150W)  
83035 (180-200W)

DALI Power Supply



99309  
99310  
C-E300002

Scene COM EVO



83146

OPTI Touch 4"



C-E700019 + 83009 (driver)

OPTI Touch 7"



C-E700020 + 83009 (driver)

DALI XC

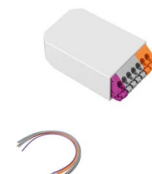

99311

SERIES | SERIES: PROLAMP 3.0

BRAND: i-LèD

**Aw** AREA ESPOSTA AL VENTO  
WIND EXPOSED AREA

**DIMENSIONI / DIMENSIONS**

82270  
82271 DALI

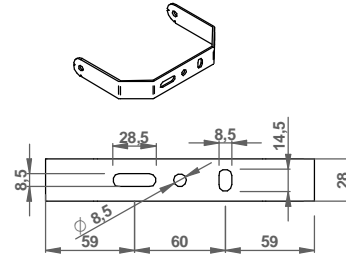
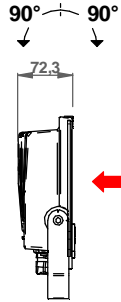
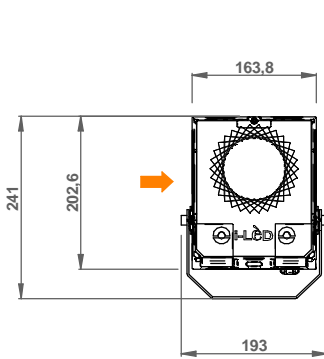

**Aw** = 0,015m<sup>2</sup>

**Aw** = 0,033m<sup>2</sup>

82272 (72W)  
82273 (72W) DALI  
84068 (100W)  
84441(100W) DALI

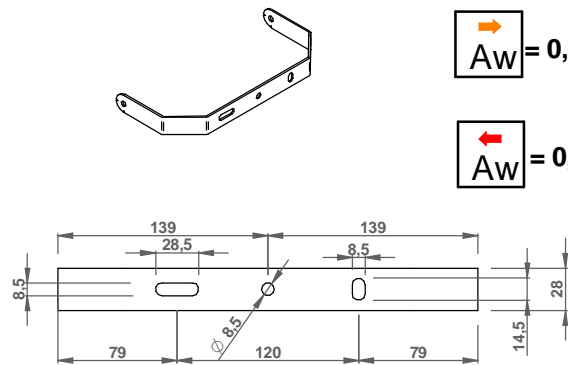
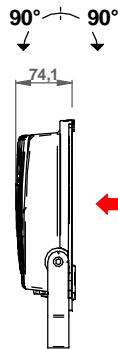
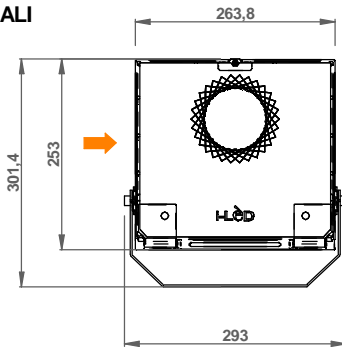

**Aw** = 0,02m<sup>2</sup>

**Aw** = 0,067m<sup>2</sup>

100W

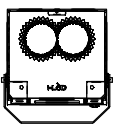

82274 (120W)  
82275 (120W) DALI  
84069 (150W)  
84442 (150W) DALI

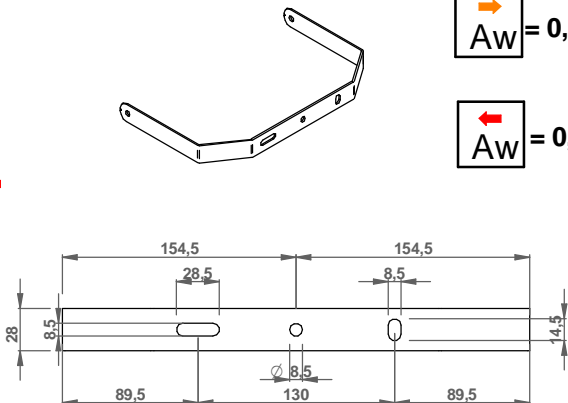
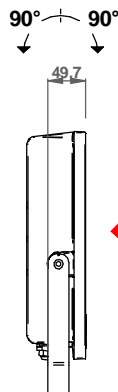
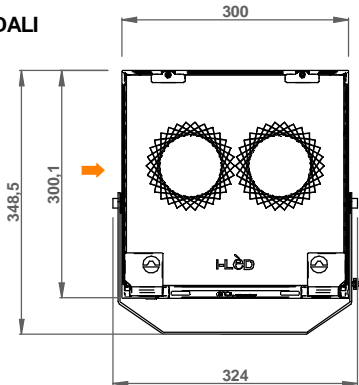

**Aw** = 0,023m<sup>2</sup>

**Aw** = 0,093m<sup>2</sup>

SERIES | SERIES: PROLAMP 3.0

BRAND: i-LèD

**Aw** AREA ESPOSTA AL VENTO  
WIND EXPOSED AREA

82286 (180W)  
82287 (180W) DALI  
84070 (200W)  
84443 (200W) DALI

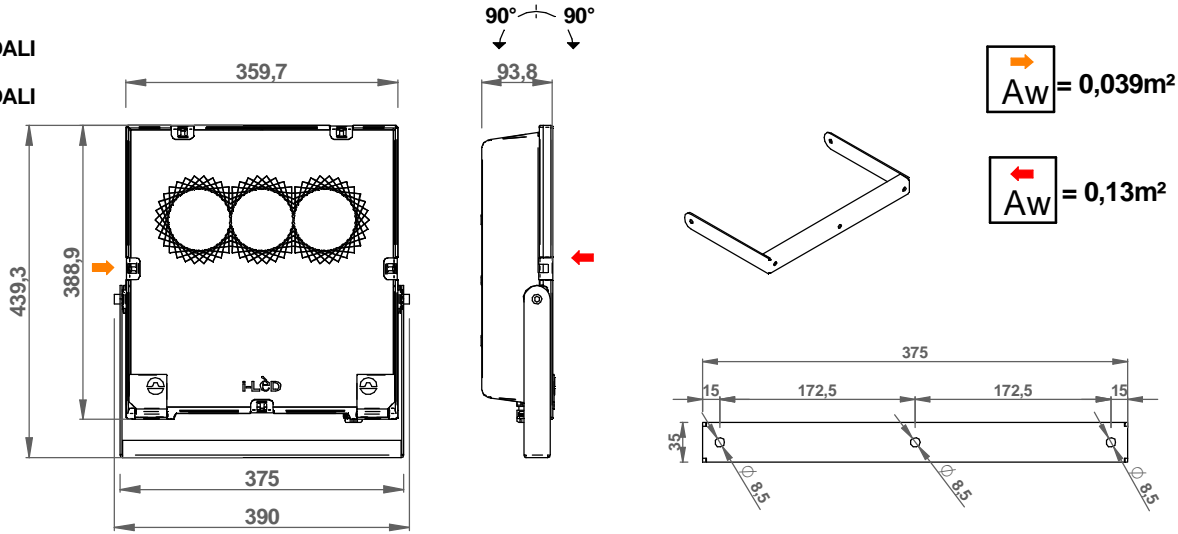

## INSTALLAZIONE / INSTALLATION

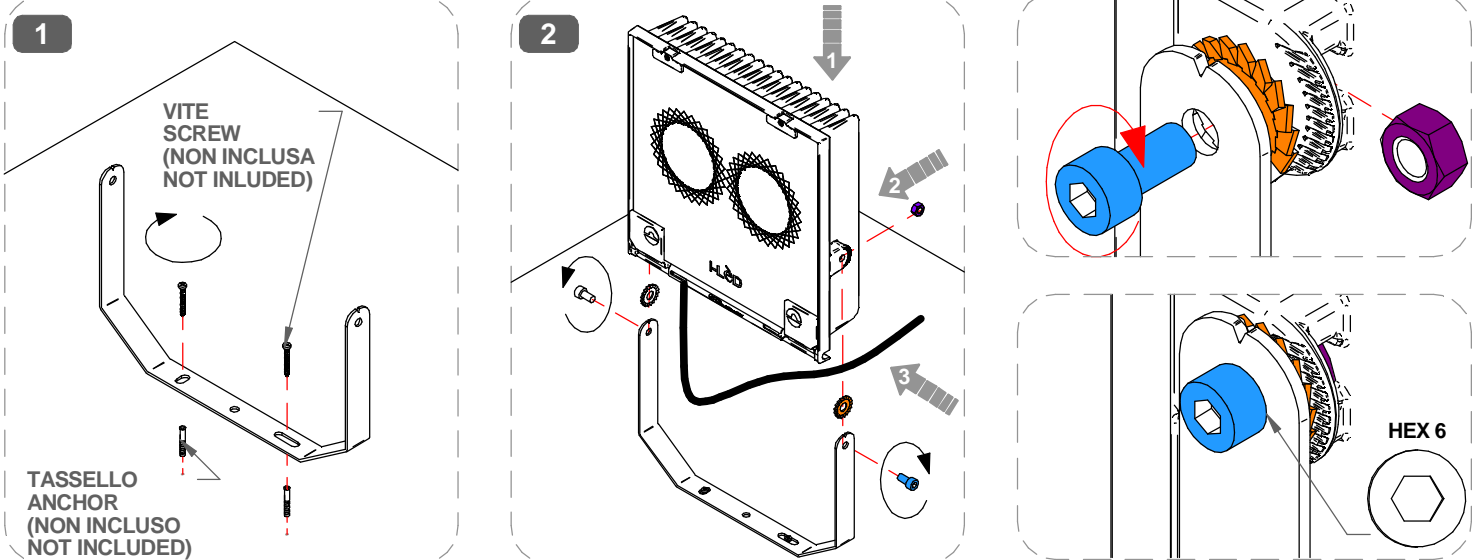

## INSTALLAZIONI APPROVATE / ALLOWED INSTALLATIONS

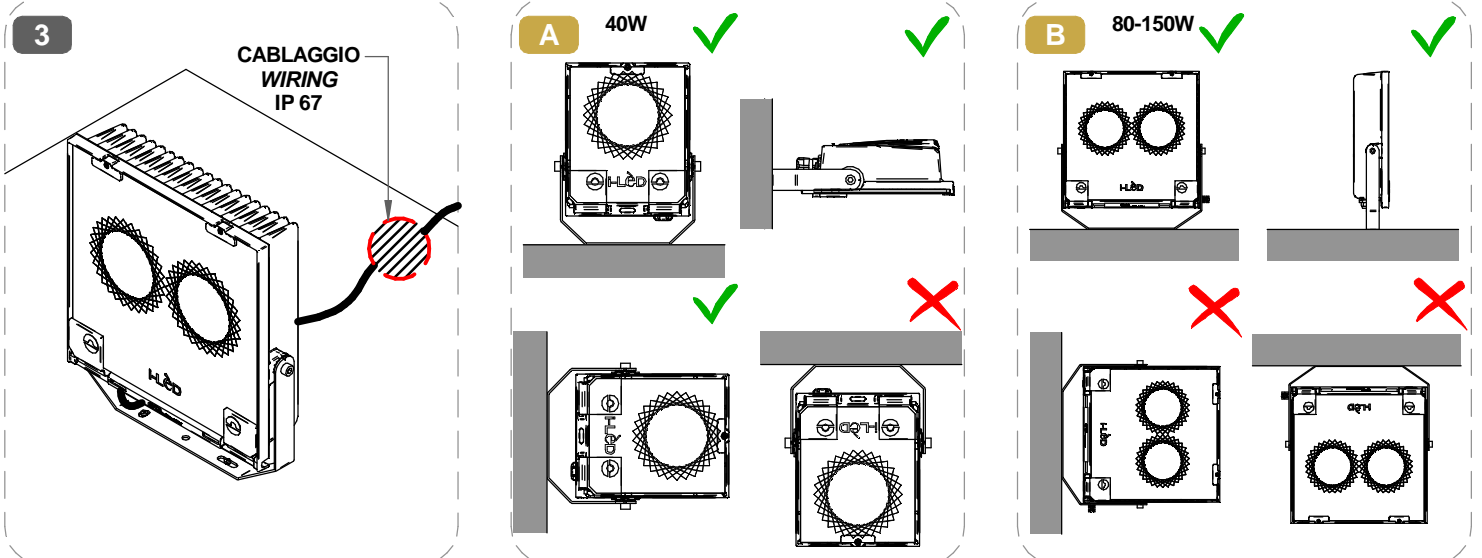

SERIES | SERIES: PROLAMP 3.0

BRAND: i-LèD

INSTALLAZIONE GABBIA / PROTECTIVE GRID INSTALLATIONS

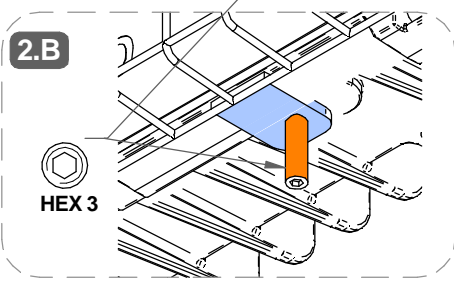
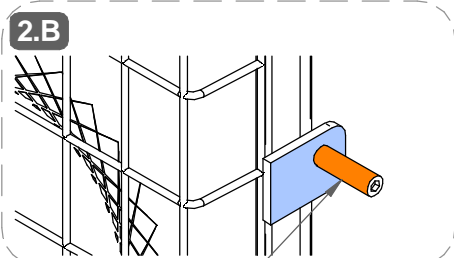
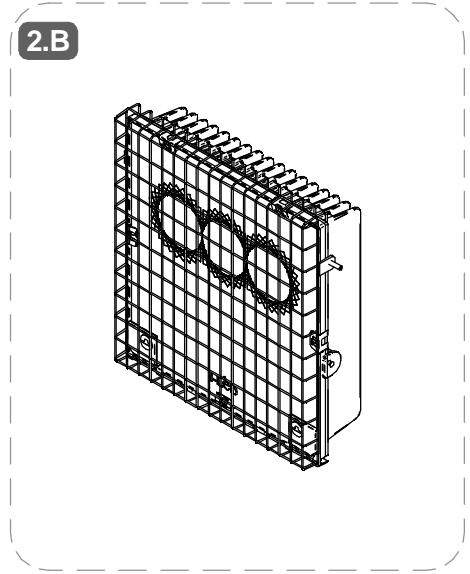
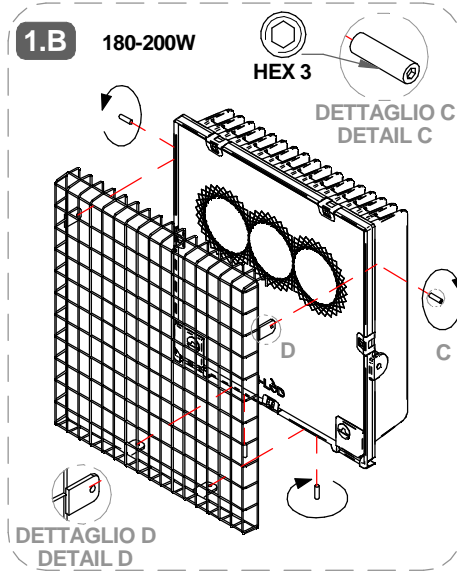
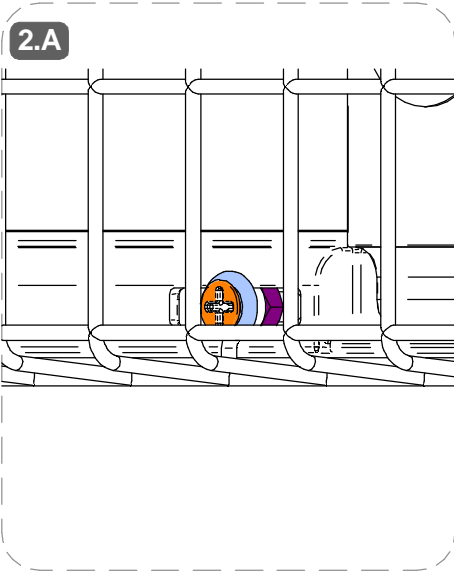
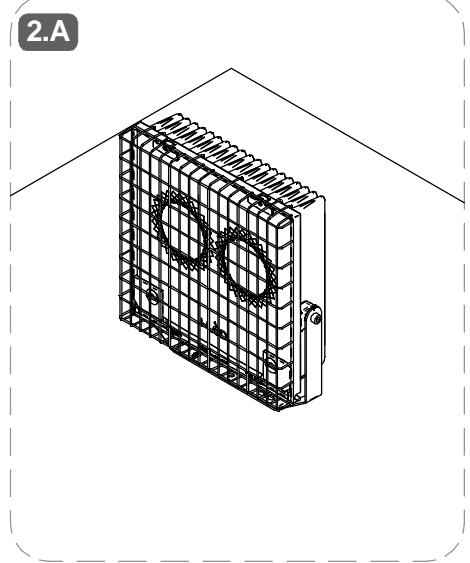
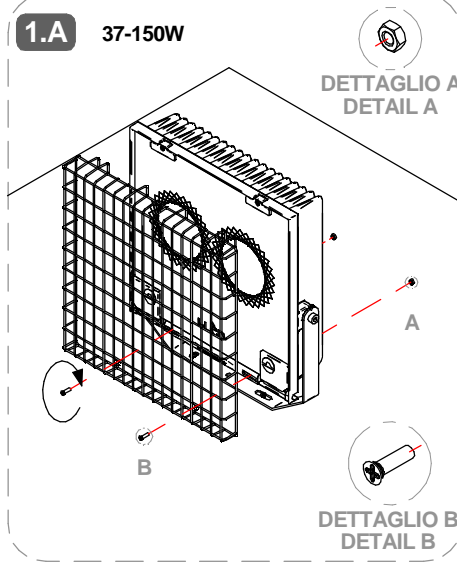
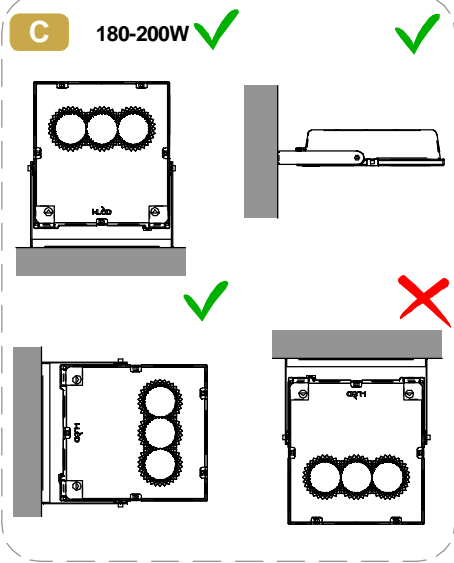

SERIES | SERIES: PROLAMP 3.0

BRAND: i-L<sup>ED</sup>

MARRONE / BROWN = LINEA / LINE

AZZURRO / LIGHT BLUE = NEUTRO / NEUTRAL

GIALLO-VERDE / YELLOW-GREEN = TERRA / EARTH CPC | PE

## CABLAGGIO / WIRING

**1**

TUTTE LE OPERAZIONI DI COLLEGAMENTO ALLA RETE ELETTRICA DEVONO ESSERE CONDOTTE IN MANCANZA DI TENSIONE

ALL THE WIRING OPERATION MUST BE PERFORMED WITH MCB IN OFF POSITION

**2**

SE IL PRODOTTO E' DEFINITO IN CLASSE 1, IL CONDUTTORE DI MESSA A TERRA DI PROTEZIONE DEVE ESSERE SEMPRE COLLEGATO

IF THE FITTING IS CLASS 1 RATED, THE CPC | EARTH | PE CONDUCTOR MUST BE CONNECTED

**3**

SE L'IMPIANTO E' STATO COMPLETATO ED E' IN SICUREZZA, PUO' ESSERE ALIMENTATO

WHEN THE CIRCUIT IS COMPLETED AND SAFE, MCB CAN BE SET IN ON POSITION



SI PREGA SEGUIRE LE BUONE PRATICHE DI DIMENSIONAMENTO E SEZIONAMENTO DELL'IMPIANTO ELETTRICO, TENENDO PRESENTE: LE CARATTERISTICHE DELL'INTERRUTTORE DIFFERENZIALE ED IL NUMERO DI ARTICOLI COLLEGATI ALLA LINEA ELETTRICA; QUESTO PER AGEVOLARE L'IDENTIFICAZIONE DI EVENTUALI ANOMALIE SULLA LINEA ELETTRICA

PLEASE FOLLOW THE BEST PRACTICES IN ELECTRICAL SYSTEM DESIGN, PAING ATTENTION TO THE RCCB SWITCH CHARACTERISTICS AND THE NUMBER OF FITTINGS CONNECTED TO THE ELECTRICAL LINE; THIS HELPS TO IDENTIFY POSSIBLE ANOMALIES ON THE ELECTRICAL LINE

**AC**

CORRENTE ALTERNATA  
MAX. DISTANZA TRA DRIVER ED ULTIMO PRODOTTO | SEZIONE CAVO ALTERNATE CURRENT  
DRIVER TO LAST LIGHT FITTING MAX DISTANCE | WIRE SECTION

SEZIONE SECTION [ mm <sup>2</sup> ]	1	1.5	2.5
LUNGHEZZA LENGHT [m]	50	75	130

\* Distanza massima dal driver all'ultimo articolo della linea a massimo carico.

Per lunghezze massime dei cavi effettive, fare riferimento a [support@linealight.com](mailto:support@linealight.com)

\* Maximum distance between LED driver and last device at full load.

For effective maximum cable lengths, please refer to [support@linealight.com](mailto:support@linealight.com)

**MCB**

N° DI PRODOTTI PER MAGNETOTERMICO  
N° OF LIGHT FITTINGS PER MCB

CODICE CODE	B10	B16	B20	C10	C16	C20
82270	22	36	44	37	59	74
82271	17	27	27	21	33	41
82272	12	20	25	20	33	41
82273	5	7	9	8	12	15
84068	5	8	10	8	14	17
84441	5	7	9	8	12	15
82274	4	7	9	7	11	14
82275	5	7	9	8	12	15
84069	2	4	6	4	8	10
84442	5	7	9	8	12	15
82286	4	7	9	7	11	14
82287	5	7	9	8	12	15
84070	2	3	4	3	6	7
84443	2	4	5	4	7	8

CABLAGGIO IN PARALLELO | PARALLEL WIRING  
TENSIONE DI RETE / MAINS VOLTAGE

**AC** ON-OFF

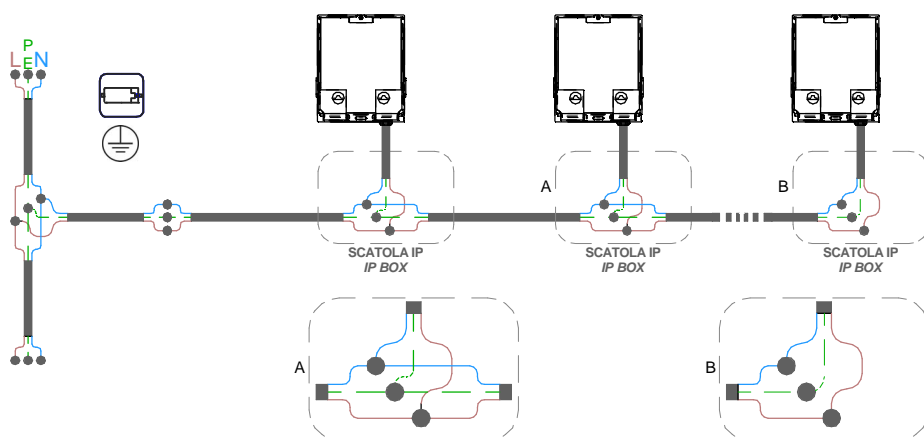

CABLAGGIO IN PARALLELO | PARALLEL WIRING  
TENSIONE DI RETE / MAINS VOLTAGE

**AC** DALI

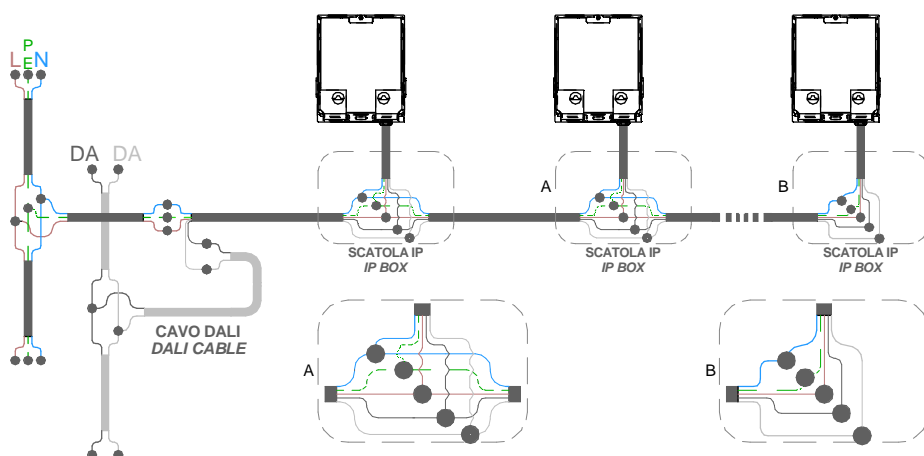

SEGNALE BUS DALI  
1,5mm<sup>2</sup> = 300m  
MAX 64 dispositivi / devices

CAVO DALI / DALI CABLE

DALI ■ GRIGIO/ GREY = DALI 1  
■ GRIGIO CHIARO / LIGHT GREY = DALI 2

## TIPO DI CONNESSIONE TYPE OF CONNECTION

X: Se il cavo flessibile esterno di questo apparecchio è danneggiato, deve essere sostituito da un cavo speciale, disponibile esclusivamente presso il fabbricante, o il suo servizio di assistenza.

X: If the external flexible cable of this appliance is damaged, it must be replaced with a special cable, which is only available from the manufacturer or its service department.

Y: Se il cavo flessibile esterno di questo apparecchio è danneggiato, deve essere sostituito esclusivamente dal fabbricante, dal suo servizio di assistenza o da personale qualificato equivalente, al fine di evitare pericoli.

Y: If the external flexible cable of this appliance is damaged, it must only be replaced by the manufacturer, its service department or equivalent qualified personell in order to avoid danger.

Z: Il cavo flessibile esterno di questo apparecchio non può essere sostituito; se il cavo è danneggiato l'apparecchio deve essere distrutto.

Z: The external flexible cable fo this appliance cannot be replaced; if the cable is damaged, the appliance must be destroyed.