









SERIE | SERIES : WARP_R, WARP_Q, VOS_R, VOS_Q, QUANTUM_R | 2-6.3 W DC
BRAND: i-L^èD

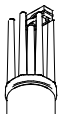

<p>A</p>  <p>WARP_R</p> <p>φ35 C01041 C01042 2W - 630mA 3W - 1000mA</p>	<p>C</p>  <p>WARP_Q</p> <p>□35 C01241 C01242 2W - 630mA 3W - 1000mA</p>	<p>E</p>  <p>VOS_R</p> <p>φ35 C01378 C01379 2W - 630mA 3W - 1000mA</p>	<p>G</p>  <p>VOS_Q</p> <p>□35 C01380 C01381 2W - 630mA 3W - 1000mA</p>	<p>I</p>  <p>QUANTUM_R</p> <p>φ24 C01038 2W - 630mA 3W - 1000mA</p>
<p>B</p>  <p>φ42 C00119 2W 630mA C00052 4.5W 500mA 6.3W 700mA C00053 4.5W 500mA 6.3W 700mA</p>	<p>D</p>  <p>□42 C00120 2W 630mA C00054 4.5W 500mA 6.3W 700mA C00055 4.5W 500mA 6.3W 700mA</p>	<p>F</p>  <p>φ42 C00064 2W 630mA C00046 4.5W 500mA 6.3W 700mA C00047 4.5W 500mA 6.3W 700mA</p>	<p>H</p>  <p>□42 C00063 2W 630mA C00040 4.5W 500mA 6.3W 700mA C00045 4.5W 500mA 6.3W 700mA</p>	<p>L</p>  <p>φ42 C00117 2W 630mA C00048 4.5W 500mA 6.3W 700mA C00049 4.5W 500mA 6.3W 700mA</p>

CODICI / CODES

CODE	Dimensions [mm]	Power [W]	Voltage [V]	Current [mA]	Weight [Kg]	Safety Class	IP	CRI	Color Temp. [°K]			N° Light Source	Conn. Type			
									2700	3000	4000					
C00040	109x□42	4,5 6,3	9	500 700	0,11	3	44	90	E	E	E	1	Y			
C00045					0,11	3			E	E	E					
C00046	109xØ42				0,11	3			E	E	E					
C00047					0,11	3			E	E	E					
C00048	114xØ42				0,11	3			E	E	E					
C00049					0,11	3			E	E	E					
C00052					0,13	3			E	E	E					
C00053					0,13	3			E	E	E					
C00054	110x□42				0,13	3			E	E	E					
C00055					0,13	3			E	E	E					
C00063	109x□42	2	3	630	0,11	3	90	80	E	E	E					
C00064					0,11	3			E	E	E					
C00117	0,11				3	E			E	E						
C00119	111xØ42				0,13	3			E	E	E					
C00120	110x□42				0,13	3			E	E	E					
C01038	79xØ24				2 3	3			630 1000	0,047	3	90	90	E	E	E
C01041	70xØ35									0,047	3			E	E	E
C01042	0,047									3	E			E	E	
C01241	70x□35									0,047	3			E	E	E
C01242	0,047									3	E			E	E	
C01378	61xØ35	0,048	3	E			E	E								
C01379		0,048	3	E			E	E								
C01380	62x□35	0,048	3	E			E	E								
C01381		0,048	3	E			E	E								

SERIE | SERIES : WARP_R, WARP_Q, VOS_R, VOS_Q, QUANTUM_R | 2-6.3 W DC

BRAND: i-LED

* LED-FG1781 FOGLIO DI INSTALLAZIONE ACCESSORIO
ACCESSORY INSTALLATION MANUAL

**ACCESSORI NON INCLUSI
NOT INCLUDED ACCESSORIES**

**CONTROCASSA PER INSTALLAZIONE A RASO
RECESSED CASING FOR FLUSH INSTALLATION**

Vos_R \varnothing 42

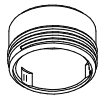

99848

* LED-FG1781

**DIMENSIONI
DIMENSIONS**

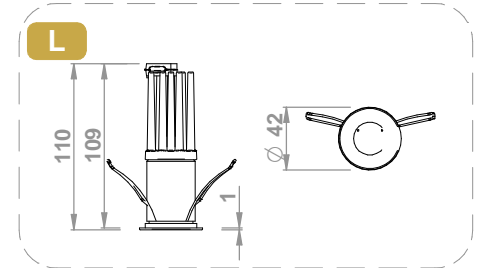
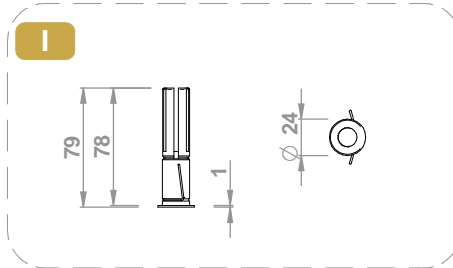
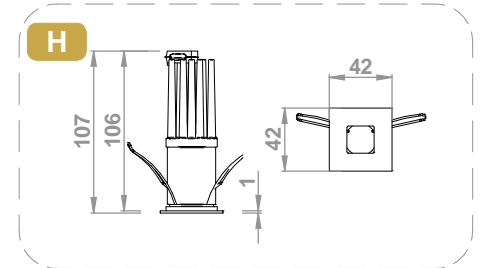
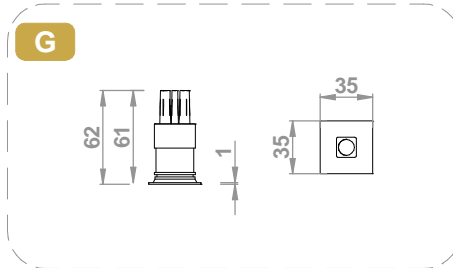
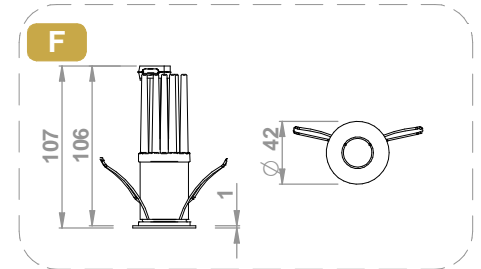
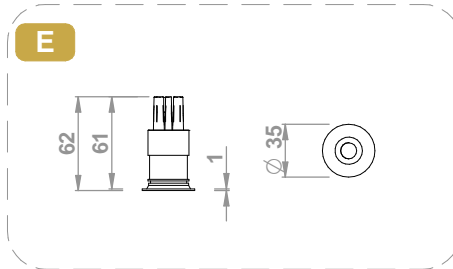
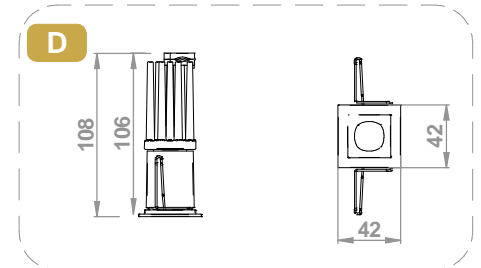
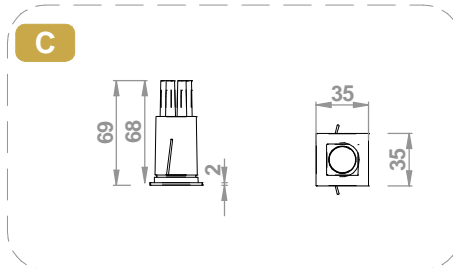
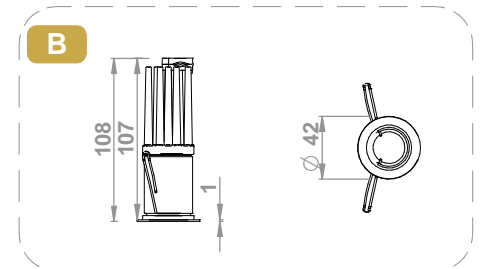
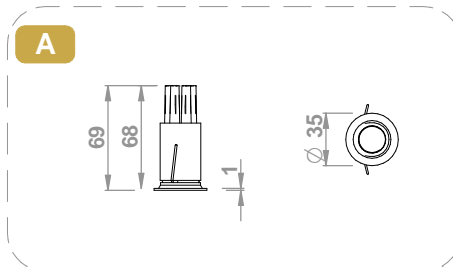

CODICI / CODES

CODE	Drywall	Solid Surfaces	H [mm]
	Installation Hole [mm]	Installation Hole [mm]	
C00040	\varnothing 35	\varnothing 36	min 5 max 20
C00045			
C00046			
C00047			
C00048			
C00049			
C00052			
C00053			
C00054			
C00055			
C00063			
C00064	\varnothing 35	\varnothing 36	
C00117			
C00119			
C00120	\square 35	\square 36	
C01038	\varnothing 20	\varnothing 21	
C01041	\varnothing 29	\varnothing 30	
C01042			
C01241			
C01242			
C01378			
C01379			
C01380			
C01381			

SERIE | SERIES : WARP_R, WARP_Q, VOS_R, VOS_Q, QUANTUM_R | 2-6.3 W DC

BRAND: i-LÈD

INSTALLAZIONE / INSTALLATION

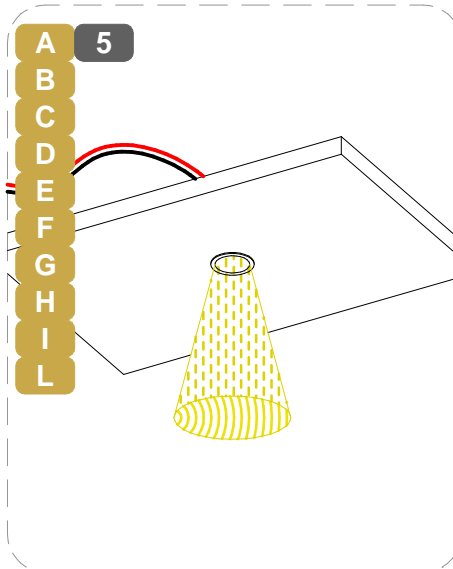
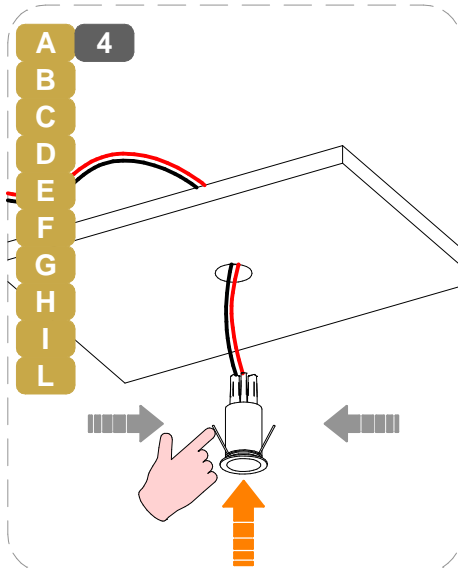
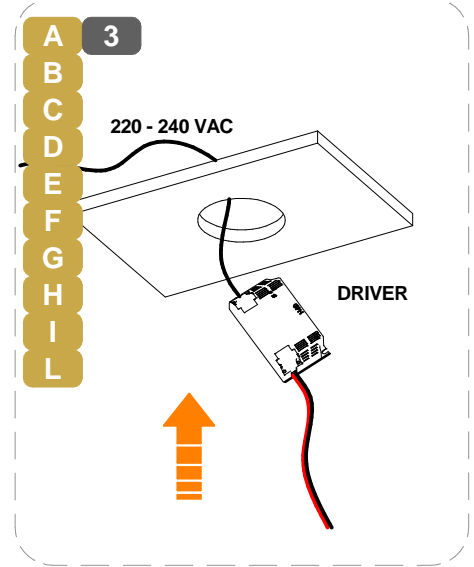
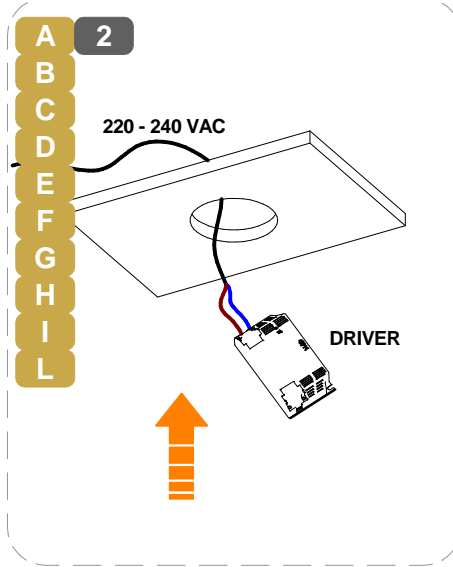
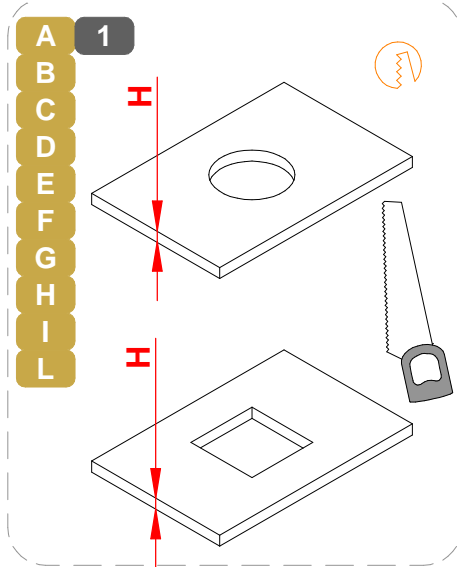

SI PREGA SEGUIRE LE BUONE PRATICHE DI DIMENSIONAMENTO E SEZIONAMENTO DELL'IMPIANTO ELETTRICO, TENENDO PRESENTE: LE CARATTERISTICHE DELL'INTERRUTTORE DIFFERENZIALE ED IL NUMERO DI ARTICOLI COLLEGATI ALLA LINEA ELETTRICA; QUESTO PER AGEVOLARE L'IDENFICAZIONE DI EVENTUALI ANOMALIE SULLA LINEA ELETTRICA

PLEASE FOLLOW THE BEST PRACTICES IN ELECTRICAL SYSTEM DESIGN, PAING ATTENTION TO THE RCCB SWITCH CHARACTERISTICS AND THE NUMBER OF FITTINGS CONNECTED TO THE ELETRICAL LINE; THIS HELPS TO INDETIFY POSSIBLE ANOMALIES ON THE ELETTRICAL LINE

PER UN'INSTALLAZIONE SICURA, E' OBBLIGATORIO SEGUIRE LE DISTANZE SPECIFICATE

IT'S MANDATORY TO FOLLOW THESE DIMENSIONS FOR A SAFE INSTALLATION

DIM.	[mm]
A	100
B	100
C	100
D	100
E	100

CORPO ILLUMINANTE CON RADIATORE INCLINATO
LIGHT FITTING TILTED HEATSINK

**TIPO DI CONNESSIONE
TYPE OF CONNECTION**

X: Se il cavo flessibile esterno di questo apparecchio è danneggiato, deve essere sostituito da un cavo speciale, disponibile esclusivamente presso il fabbricante, o il suo servizio di assistenza.
X: If the external flexible cable of this appliance is damaged, it must be replaced with a special cable, which is only available from the manufacturer or its service department.

Y: Se il cavo flessibile esterno di questo apparecchio è danneggiato, deve essere sostituito esclusivamente dal fabbricante, dal suo servizio di assistenza o da personale qualificato equivalente, al fine di evitare pericoli.
Y: If the external flexible cable of this appliance is damaged, it must only be replaced by the manufacturer, its service department or equivalent qualified personell in order to avoid danger.

Z: Il cavo flessibile esterno di questo apparecchio non può essere sostituito; se il cavo è danneggiato l'apparecchio deve essere distrutto.
Z: The external flexible cable fo this appliance cannot be replaced; if the cable is damaged, the appliance must be destroyed.

SERIE | SERIES : WARP_R, WARP_Q, VOS_R, VOS_Q, QUANTUM_R | 2-6.3 W DC

BRAND: i-L^{ED}

MARRONE / BROWN = LINEA / LINE

AZZURRO / LIGHT BLUE = NEUTRO / NEUTRAL

GIALLO-VERDE / YELLOW-GREEN = TERRA / EARTH CPC | PE

CABLAGGIO / WIRING

1

TUTTE LE OPERAZIONI DI COLLEGAMENTO ALLA RETE ELETTRICA DEVONO ESSERE CONDOTTE IN MANCANZA DI TENSIONE
ALL THE WIRING OPERATION MUST BE PERFORMED WITH MCB IN OFF POSITION

2

SE IL PRODOTTO E' DEFINITO IN CLASSE 1, IL CONDUTTORE DI MESSA A TERRA DI PROTEZIONE DEVE ESSERE SEMPRE COLLEGATO
IF THE FITTING IS CLASS 1 RATED, THE CPC | EARTH / PE CONDUCTOR MUST BE CONNECTED

3

SE L'IMPIANTO E' STATO COMPLETATO ED E' IN SICUREZZA, PUO' ESSERE ALIMENTATO
WHEN THE CIRCUIT IS COMPLETED AND SAFE, MCB CAN BE SET IN ON POSITION

SE IL PRODOTTO E' DEFINITO IN CLASSE 3, IL CIRCUITO SECONDARIO A BASSA TENSIONE DEVE ESSERE COLLEGATO ALL'ALIMENTATORE PRIMA CHE QUESTO SIA SOTTO TENSIONE
IF THE FITTING IS CLASS 3 RATED, THE LOW VOLTAGE CIRCUIT MUST BE WIRED BEFORE THE POWER SUPPLY IS POWERED ON

SE IL CARICO VENISSE COLLEGATO AD ALIMENTATORE SOTTO TENSIONE, I PRODOTTI POTREBBERO DANNEGGIARSI, SUBENDO UN DANNO DA SOVRATENSIONE
IF THE LOAD IS WIRED TO AN ALREADY ON POWER SUPPLY, THE FITTINGS COULD BE DAMAGED BY VOLTAGE SURGE

CC

N° MAX DEVICES

**N° DI PRODOTTI PER ALIMENTATORE
N° OF LIGHT FITTINGS PER DRIVER**

TIPO TYPE	ON-OFF										0/1-10V + 24V CV		0/1-10V		DALI + 24V CV		DALI2 PUSH			
CODE	89147	89146	99129	99377	99735	99105	99147	C-E100046	C-E100033	99710	99733	99713	99711	C-E100047	C-E100005	C-E100001	C-E100034	83323	C-E100011	
C00040		1		1-2	1*		2-3*				1*				1	1-2		1*	2-4*	
C00045		1		1-2	1*		2-3*				1*				1	1-2		1*	2-4*	
C00046		1		1-2	1*		2-3*				1*				1	1-2		1*	2-4*	
C00047		1		1-2	1*		2-3*				1*				1	1-2		1*	2-4*	
C00048		1		1-2	1*		2-3*				1*				2	1-3		1*	2-4*	
C00049		1		1-2	1*		2-3*				1*				2	1-3		1*	2-4*	
C00052		1		1-2	1*		2-3*				1*				2	1-3		1*	2-4*	
C00053		1		1-2	1*		2-3*				1*				2	1-3		1*	2-4*	
C00054		1		1-2	1*		2-3*				1*				2	1-3		1*	2-4*	
C00055		1		1-2	1*		2-3*				1*				2	1-3		1*	2-4*	
C00063	1-2		3-6			6-12*				1-6		1-6								
C00064	1-2		3-6			6-12*				1-6		1-6								
C00117	1-2		3-6			6-12*				1-6		1-6								
C00119	1-2		3-6			6-12*				1-6		1-6								
C00120	1-2		3-6			6-12*				1-6		1-6								
C01038	1-2		3-6			6-12*	1-6*	4-12*		1-6		1-6		1-3*			4-12*			
C01041	1-2		3-6			6-12*	1-6*	4-12*		1-6		1-6		1-3*			4-12*			
C01042	1-2		3-6			6-12*	1-6*	4-12*		1-6		1-6		1-3*			4-12*			
C01241	1-2		3-6			6-12*	1-6*	4-12*		1-6		1-6		1-3*			4-12*			
C01242	1-2		3-6			6-12*	1-6*	4-12*		1-6		1-6		1-3*			4-12*			
C01378	1-2		3-6			6-12*	1-6*	4-12*		1-6		1-6		1-3*			4-12*			
C01379	1-2		3-6			6-12*	1-6*	4-12*		1-6		1-6		1-3*			4-12*			
C01380	1-2		3-6			6-12*	1-6*	4-12*		1-6		1-6		1-3*			4-12*			
C01381	1-2		3-6			6-12*	1-6*	4-12*		1-6		1-6		1-3*			4-12*			

* NON PASSA PER IL FORO DI INCASSO DEL PRODOTTO | IT DOES NOT FIT THROUGH THE PRODUCT'S RECESSED MOUNTING HOLE

- NERO / BLACK = 500mA
- ARANCIONE / ORANGE = 630mA
- ROSSO / RED = 700mA
- BLU / BLUE = 1000mA

SERIE | SERIES : WARP_R, WARP_Q, VOS_R, VOS_Q, QUANTUM_R | 2-6.3 W DC

BRAND: i-LèD

MARRONE / BROWN = LINEA / LINE

AZZURRO / LIGHT BLUE = NEUTRO / NEUTRAL

GIALLO-VERDE / YELLOW-GREEN = TERRA / EARTH CPC | PE

CABLAGGIO IN SERIE | CORRENTE COSTANTE
SERIES WIRING / CONSTANT CURRENT

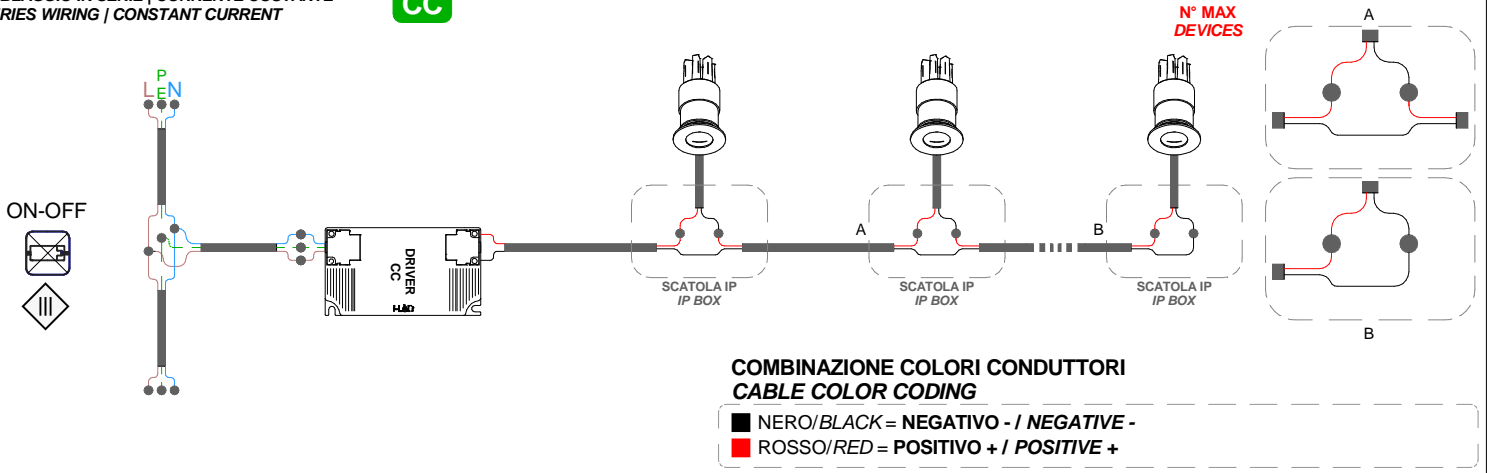

CABLAGGIO IN SERIE | CORRENTE COSTANTE
SERIES WIRING / CONSTANT CURRENT

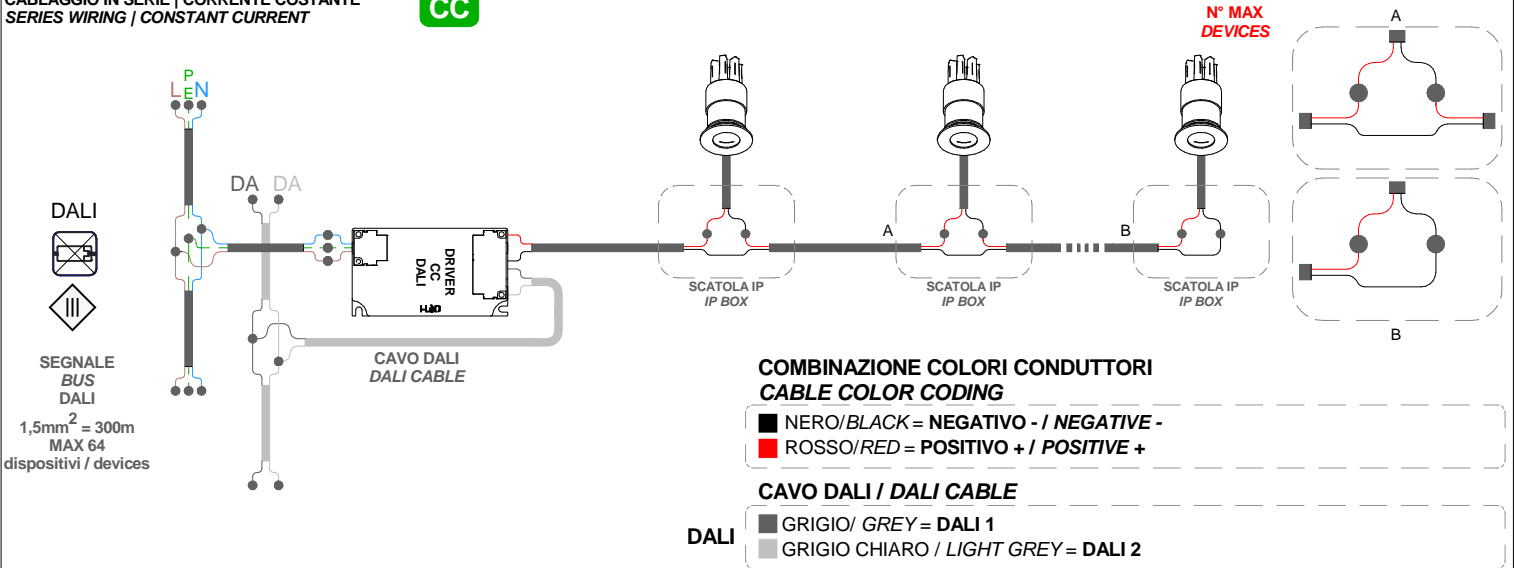

CABLAGGIO IN SERIE | CORRENTE COSTANTE
SERIES WIRING / CONSTANT CURRENT

