

BUSSOLE DI RIDUZIONE PER CONI MORSE, TEMPRATE E RETTIFICATE INTERNAMENTE ED ESTERNAMENTE *Hardened and ground morse taper sleeve/Douilles de reduction trempé et rectifié pour cône morse/Cono de reducción tratado y rectificado/Casquilho cônico morse temperado e retificado*

28150

DIN 2185

Cono esterno
External Morse
DIN 228

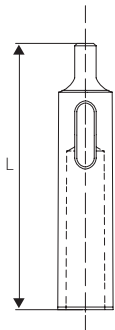

Cono interno
Internal Morse
DIN 228



Confezione
Packaging



cono morse morse taper DIN 228		L	cod.
esterno external	interno internal		
1	0	80	281500100
2	1	92	281500201
3	1	99	281500301
3	2	112	281500302
4	1	124	281500401
4	2	124	281500402
4	3	140	281500403
5	1	156	281500501
5	2	156	281500502
5	3	156	281500503
5	4	171	281500504
6	4	219	281500604
6	5	219	281500605

DIMENSIONI CARATTERISTICHE DEI CONI MORSE IN ACCORDO ALLA NORMA DIN 228

Chart for carbide grit hole saw selection and relative cutting speed/ Tableau de sélection des scies cloches au carbure et vitesse de coupe relative/Tabla de selección de sierras de corona de carburo y velocidad de corte relativa/Tabela de seleção de serras de trépano com grão de metal duro e velocidade de corte relativa

Coni morse Morse taper

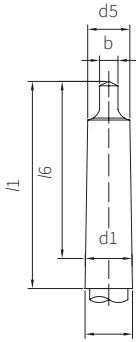

Cono Morse	l1 mm	l6 mm	d1 mm	d5 mm	b mm	d2 mm	Conicità %
0	59,5	56,5	9,045	6,1	3,9	9,2	5,205
1	65,5	62,0	12,065	9,0	5,2	12,2	4,988
2	80,0	75,0	17,780	14,0	6,3	18,0	4,995
3	99,0	94,0	23,825	19,1	7,9	24,1	5,020
4	124,0	117,5	31,267	25,2	11,9	31,6	5,194
5	156,0	149,5	44,339	36,5	15,9	44,7	5,263
6	218,0	210,0	63,348	52,4	19,0	63,8	5,214