

# FRESE PERFORTRICI A TAZZA "IMPACT" PER EDILIZIA PER MARTELLI LEGGERI

Masonry impact core bits for light hammers/Trépan pour marteau léger/  
Broca corona para martillo/Brocas de impacto para alvenaria para martelos legeros

## 21110

**Attacco filettato M16**  
M16 Threaded connection

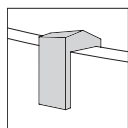

Uso rotopercussione su trapani e piccoli martelli sino 40 N  
Rotary percussion use



Confezione  
Packaging

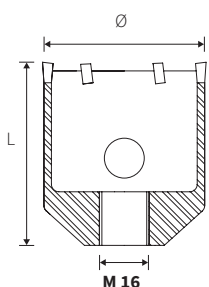

| Ø<br>fresa<br>hole cutter | L  | Z<br>n. denti<br>tips | pcs. | cod.       |
|---------------------------|----|-----------------------|------|------------|
| 25                        | 75 | 4                     | 1    | 2111002500 |
| 30                        | 75 | 4                     | 1    | 2111003000 |
| 35                        | 75 | 4                     | 1    | 2111003500 |
| 40                        | 75 | 4                     | 1    | 2111004000 |
| 45                        | 75 | 4                     | 1    | 2111004500 |
| 50                        | 75 | 6                     | 1    | 2111005000 |
| 65                        | 75 | 6                     | 1    | 2111006500 |
| 80                        | 75 | 8                     | 1    | 2111008000 |
| 90                        | 75 | 8                     | 1    | 2111009000 |
| 100                       | 75 | 8                     | 1    | 2111010000 |
| 112                       | 75 | 8                     | 1    | 2111011200 |
| 125                       | 80 | 10                    | 1    | 2111012500 |
| 150                       | 80 | 12                    | 1    | 2111015000 |

Ø ≤ 50 mm 600W  
Ø > 50 mm 800W (3J)  
F ≤ 40 N



Applicazioni  
Applications



Muro  
Masonry

Foratura a rotopercussione su trapani e piccoli martelli nel calcestruzzo, cemento, pietre.  
Massima profondità di foratura 60 mm.

Use with hammer drills up to 40 N in masonry and concrete (60 mm drill depth).

## GAMBI PER FRESE PERFORATRICI A TAZZA "IMPACT"

Chucking shanks for "Impact" core bits/Arbres de montage pour trépan "Impact"/  
Husillos para coronas perforadoras "Impact"/Veios de mandril para brocas "Impact"

### Gambo esagonale

Hex. shank



| cod.            | Attacco filettato<br>Thread attachment | Lunghezza tot.<br>Overall length |
|-----------------|--|----------------------------------|
| <b>21115501</b> | M 16 x 2                               | 100 mm                           |
| <b>21115502</b> | M 16 x 2                               | 220 mm                           |
| <b>21115503</b> | M 16 x 2                               | 370 mm                           |
| <b>21115521</b> | M 22 x 2,5                             | 100 mm                           |
| <b>21115522</b> | M 22 x 2,5                             | 220 mm                           |
| <b>21115523</b> | M 22 x 2,5                             | 370 mm                           |

### Gambo SDS PLUS

SDS PLUS shank



| cod.            | Attacco filettato<br>Thread attachment | Lunghezza tot.<br>Overall length |
|-----------------|--|----------------------------------|
| <b>21115504</b> | M 16 x 2                               | 100 mm                           |
| <b>21115505</b> | M 16 x 2                               | 220 mm                           |
| <b>21115507</b> | M 16 x 2                               | 370 mm                           |
| <b>21115509</b> | M 16 x 2                               | 460 mm                           |
| <b>21115524</b> | M 22 x 2,5                             | 100 mm                           |
| <b>21115525</b> | M 22 x 2,5                             | 220 mm                           |
| <b>21115527</b> | M 22 x 2,5                             | 370 mm                           |
| <b>21115529</b> | M 22 x 2,5                             | 460 mm                           |

### Gambo SDS MAX\*

SDS MAX shank\*



| cod.            | Attacco filettato<br>Thread attachment | Lunghezza tot.<br>Overall length |
|-----------------|--|----------------------------------|
| <b>21115520</b> | M 22 x 2,5                             | 370 mm                           |

\* Usare solo per materiali da costruzione leggeri come arenaria, mattoni forati. Non usare per cemento armato, calcestruzzo e pietre.

\* Use with light building materials only.

Punta pilota  
Pilot drill



| cod.            | ØxL<br>mm |
|-----------------|-----------|
| <b>21115506</b> | 8 x 120   |

## ESPOSITORE FRESE "IMPACT" PER EDILIZIA

Masonry core bits set/Assortiments trépan pour marteau léger/  
Surtido brocas coronas para martillo/Conjunto de brocas para alvenaria



Art. 21116112

24 pcs  
Ø 30 ÷ 100 mm

| cod.     | Attacco filettato<br>Thread attachment |  |          |                       |    |           |
|----------|--|--|----------|-----------------------|----|-----------|
| 211110   | M 16                                   |  | Ø pcs.   | 30                    | 35 | 40        |
| 211111   | M 22                                   |  | Ø pcs.   | 50                    | 65 | 80 90 100 |
| 21115501 | (M 16)                                 |  |          | L = 100 mm<br>N° 1 pc |    |           |
| 21115502 | (M 16)                                 |  |          | L = 220 mm<br>N° 1 pc |    |           |
| 21115521 | (M 22)                                 |  | HEX 12   | L = 100 mm<br>N° 1 pc |    |           |
| 21115522 | (M 22)                                 |  |          | L = 220 mm<br>N° 1 pc |    |           |
| 21115504 | (M 16)                                 |  |          | L = 100 mm<br>N° 1 pc |    |           |
| 21115505 | (M 16)                                 |  |          | L = 220 mm<br>N° 1 pc |    |           |
| 21115524 | (M 22)                                 |  | SDS PLUS | L = 100 mm<br>N° 1 pc |    |           |
| 21115525 | (M 22)                                 |  |          | L = 220 mm<br>N° 1 pc |    |           |
| 21115506 |  |  |          | Ø = 8 mm<br>N° 8 pcs  |    |           |

**VELOCITÀ DI TAGLIO PER FRESE A TAZZA PER EDILIZIA A SOLA ROTAZIONE, IN FUNZIONE DEL MATERIALE DA LAVORARE**  
*Cutting speed chart in RPM for drilling into concrete and bricks on rotation only/ Tableau des vitesses de coupe en tr/min pour le perçage du béton et des briques en rotation uniquement/Tabla de velocidades de corte en RPM para taladrar hormigón y ladrillos sólo en rotación/Tabela de velocidades de cortade em RPM para perfuração em betão e tijolos apenas com rotação*



### Frese a tazza con denti in MD Carbide tipped hole cutters

| Materiale da lavorare<br>Work-piece material   | Diametro fresa / Core bit diameter (mm)     |           |         |         |
|--|---|-----------|---------|---------|
|  | 16÷35                                       | 38÷55     | 60÷85   | 100÷150 |
|  | Velocità di taglio / Cutting speed (r.p.m.) |           |         |         |
| <b>Calcestruzzo, Muro</b><br>Concrete, Masonry | 2800÷1600                                   | 1500÷1000 | 950÷680 | 580÷380 |
| <b>Ceramica, Marmo</b><br>Tiles, Marble        | 2500÷1100                                   | 1000÷700  | 650÷450 | 400÷250 |
| <b>Pietra</b><br>Stone                         | 1800÷800                                    | 750÷500   | 470÷340 | 300÷200 |

**VELOCITÀ DI TAGLIO PER FRESE A ROTOPERCUSSIONE PER EDILIZIA IN FUNZIONE DEL MATERIALE DA LAVORARE**  
*Chart for percussion core bits selection and relative cutting speed in accordance with the materials to work/ Tableau de sélection des carottes à percussion et de la vitesse de coupe relative en fonction des matériaux à travailler/Tabla de selección de brocas de percusión y velocidad de corte relativa en función de los materiales a trabajar/Tabela de seleção de brocas de percussão e velocidade de corte relativa em função dos materiais a trabalhar*



### Rotopercussione Rotary percussion

| Materiale da lavorare<br>Work-piece material   | Diametro fresa / Core bit diameter (mm)     |          |         |         |
|--|---|----------|---------|---------|
|  | 25÷40                                       | 45÷65    | 70÷100  | 110÷130 |
|  | Velocità di taglio / Cutting speed (r.p.m.) |          |         |         |
| <b>Calcestruzzo, Muro</b><br>Concrete, Masonry | 2150÷1350                                   | 1200÷850 | 770÷550 | 500÷400 |
| <b>Cemento armato</b><br>Armoured concrete     | 1600÷1000                                   | 900÷600  | 550÷400 | 360÷300 |
| <b>Pietre dure</b><br>Hard stone               | 760÷470                                     | 420÷300  | 270÷200 | 170÷150 |

**VELOCITÀ DI TAGLIO PER FRESE A TAZZA CON DENTI RIVESTITI IN CARBURO DI TUNGSTENO IN GRANI**  
*Chart for carbide grit hole saw selection and relative cutting speed/ Tableau de sélection des scies cloches à grains en carbure et vitesse de coupe relative/Tabla de selección de sierras de corona de carburo y velocidad de corte relativa/Tabela para seleção de serras de trépano com grão de metal duro e velocidade de corte relativa*



### Frese a tazza con denti rivestiti in grani di carburo di tungsteno Carbide grit hole saws

| Materiale da lavorare<br>Work-piece material      | Diametro fresa / Core bit diameter (mm)     |       |       |       |       |       |       |         |
|---|---|-------|-------|-------|-------|-------|-------|---------|
|   | 16÷20                                       | 22÷29 | 32÷38 | 44÷51 | 54÷60 | 64÷76 | 83÷95 | 102÷114 |
|   | Velocità di taglio / Cutting speed (r.p.m.) |       |       |       |       |       |       |         |
| <b>Mattoni, Ceramica</b><br>Brick, Ceramic        | 500   | 350   | 260   | 190   | 160   | 130   | 100   | 80      |
| <b>Ardesia</b><br>Slate                           | 1200  | 850   | 650   | 480   | 400   | 320   | 260   | 220     |
| <b>Plastica rinforzata</b><br>Reinforced plastics | 1700  | 1200  | 900   | 670   | 570   | 450   | 350   | 300     |
| <b>Fibre</b><br>Fiber                             | 710   | 510   | 390   | 290   | 250   | 190   | 160   | 125     |

\*Consigli / Tips

Assicurare una continua refrigerazione ad acqua  
Keep a continuous water cooling

## CORRISPONDENZA MISURE METRICHE E MISURE IN POLLICI PER PUNTE DA EDILIZIA

Correspondence of metric and inches dimensions for construction tips/Correspondance des dimensions métriques et pouces pour les embouts de construction/Correspondencia de dimensiones métricas y en pulgadas para consejos de construcción/Correspondência de dimensões métricas e em polegadas para dicas de construção

| Dimensioni in mm<br>Dimensions (mm) | Dimensioni in pollici<br>Dimensione (inches) |
|-------------------------------------|--|
| 3,5X110                             | 9/64x4                                       |
| 3,5X135                             | 9/64x5                                       |
| 4X110                               | 5/32x4                                       |
| 4X160                               | 5/32x6                                       |
| 5X110                               | 3/16x4                                       |
| 5X160                               | 3/16x6                                       |
| 5X210                               | 13/64x8                                      |
| 5X310                               | 3/16x12                                      |
| 5,5X110                             | 7/32x4                                       |
| 5,5X160                             | 7/32x6                                       |
| 5,5X210                             | 7/32x8                                       |
| 5,5X260                             | 7/32x10                                      |
| 5,5X310                             | 7/32x12                                      |
| 5,5X460                             | 7/32x18                                      |
| 6X110                               | 15/64x4                                      |
| 6X160                               | 15/64x6                                      |
| 6X210                               | 15/64x8                                      |
| 6X260                               | 15/64x10                                     |
| 6X460                               | 15/64x18                                     |
| 6,5X110                             | 1/4x4  |
| 6,5X160                             | 1/4x6  |
| 6,5X210                             | 1/4x8  |
| 6,5X260                             | 1/4x10                                       |
| 6,5X310                             | 1/4x12                                       |
| 7X110                               | 9/32x4                                       |
| 7X160                               | 9/32x6                                       |
| 7X210                               | 9/32x8                                       |
| 8X110                               | 5/16x4                                       |
| 8X160                               | 5/16x6                                       |
| 8X210                               | 5/16x8                                       |
| 8X260                               | 5/16x10                                      |
| 8X310                               | 5/16x12                                      |
| 8X410                               | 5/16x16                                      |
| 8X460                               | 5/16x18                                      |
| 8X610                               | 5/16x24                                      |
| 9X160                               | 11/32x6                                      |
| 9X210                               | 11/32x8                                      |
| 9,5X160                             | 3/8x6  |
| 10X1000                             | 3/8x40                                       |
| 10X110                              | 3/8x4  |
| 10X160                              | 3/8x6  |
| 10X210                              | 3/8x8  |
| 10X260                              | 3/8x10                                       |
| 10X310                              | 3/8x12                                       |
| 10X360                              | 3/8x14                                       |
| 10X460                              | 3/8x18                                       |
| 10X610                              | 3/8x24                                       |
| 11X160                              | 7/16x6                                       |
| 11X210                              | 7/16x8                                       |
| 11X260                              | 7/16x10                                      |
| 11X310                              | 7/16x12                                      |
| 12X1000                             | 15/32x40                                     |
| 12X160                              | 15/32x6                                      |
| 12X210                              | 15/32x8                                      |
| 12X260                              | 15/32x10                                     |
| 12X310                              | 15/32x12                                     |

| Dimensioni in mm<br>Dimensions (mm) | Dimensioni in pollici<br>Dimensione (inches) |
|-------------------------------------|--|
| 12X360                              | 15/32x14                                     |
| 12X460                              | 15/32x18                                     |
| 12X610                              | 15/32x24                                     |
| 13X160                              | 1/2x6  |
| 13X210                              | 1/2x8  |
| 13X260                              | 1/2x10                                       |
| 13X310                              | 1/2x12                                       |
| 13X460                              | 1/2x18                                       |
| 14X1000                             | 9/16x40                                      |
| 14X160                              | 9/16x6                                       |
| 14X210                              | 9/16x8                                       |
| 14X260                              | 9/16x10                                      |
| 14X310                              | 9/16x12                                      |
| 14X460                              | 9/16x18                                      |
| 14X610                              | 9/16x24                                      |
| 15X160                              | 19/32x6                                      |
| 15X210                              | 19/32x8                                      |
| 15X260                              | 19/32x10                                     |
| 15X460                              | 19/32x18                                     |
| 16X1000                             | 5/8x40                                       |
| 16X160                              | 5/8x6  |
| 16X210                              | 5/8x8  |
| 16X260                              | 5/8x10                                       |
| 16X310                              | 5/8x12                                       |
| 16X460                              | 5/8x18                                       |
| 16X610                              | 5/8x24                                       |
| 16X800                              | 5/8x32                                       |
| 17X210                              | 11/16x8                                      |
| 18X1000                             | 23/32x40                                     |
| 18X200                              | 23/32x8                                      |
| 18X250                              | 23/32x10                                     |
| 18X300                              | 23/32x12                                     |
| 18X450                              | 23/32x18                                     |
| 18X600                              | 23/32x24                                     |
| 19X200                              | 24/32x8                                      |
| 19X450                              | 24/32x18                                     |
| 20X1000                             | 25/32x40                                     |
| 20X200                              | 25/32x8                                      |
| 20X300                              | 25/32x12                                     |
| 20X450                              | 25/32x18                                     |
| 20X600                              | 25/32x24                                     |
| 22X1000                             | 7/8x40                                       |
| 22X250                              | 7/8x10                                       |
| 22X300                              | 7/8x12                                       |
| 22X450                              | 7/8x18                                       |
| 22X600                              | 7/8x24                                       |
| 24X250                              | 15/16x10                                     |
| 24X450                              | 31/32x18                                     |
| 25X1000                             | 1"x40  |
| 25X250                              | 1"x10  |
| 25X300                              | 1"x12  |
| 25X450                              | 1"x18  |
| 26X250                              | 1-1/32x10                                    |
| 26X450                              | 1-1/32x18                                    |
| 28X450                              | 1-1/8x18                                     |
| 30X450                              | 1-3/16x18                                    |