

# BLU7501

## WASTEPAPER BIN

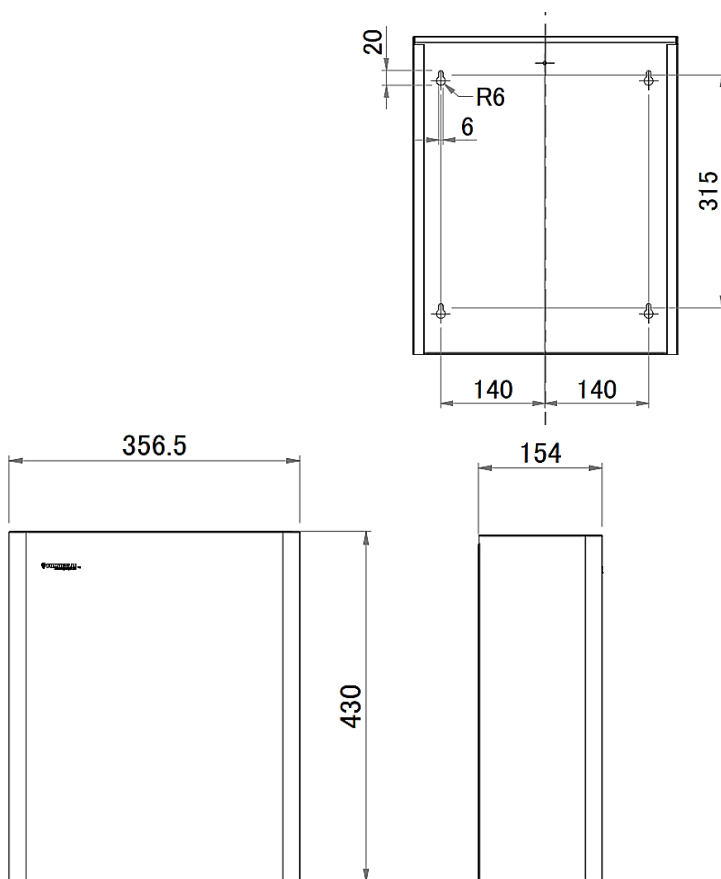

### SPECIFICATION ITEM

24 litre capacity waste bin made of AISI 430 stainless steel with polished or satin finish, equipped with bracket on the back for wall mounting.

#### ASSORTMENT

BLU7501C-P4	INOX AISI 304 POLISHED	BLU7501S-P4	INOX AISI 304 SATIN
-------------	------------------------	-------------	---------------------

### TECHNICAL SPECIFICATIONS

activation	manual
composition	AISI 304 stainless steel thickness 0.8 mm
height	430 mm
width	356.5 mm
depth	154 mm
capacity	24 liters
weight	2.5 Kg

#### INSTALLATION:

Wall mounting by means of the provided kit.

#### CLEANING:

Clean metal surfaces with a soft cloth (microfiber, no abrasive products) and neutral cleaning agents or denatured alcohol. For satin-finished surfaces, clean in the direction of the satin finish.

#### PACKAGING:

Single cardboard box packaging. The box includes:

N° 1 waste bin

N° 4 plastic plugs for wall mounting

N° 4 steel screws for wall mounting



The most correct way to dispose of the product is to throw it in the metal bin or take it to authorised recycling centres.