

BLU7402

JUMBO MAXI TOILET PAPER DISPENSER

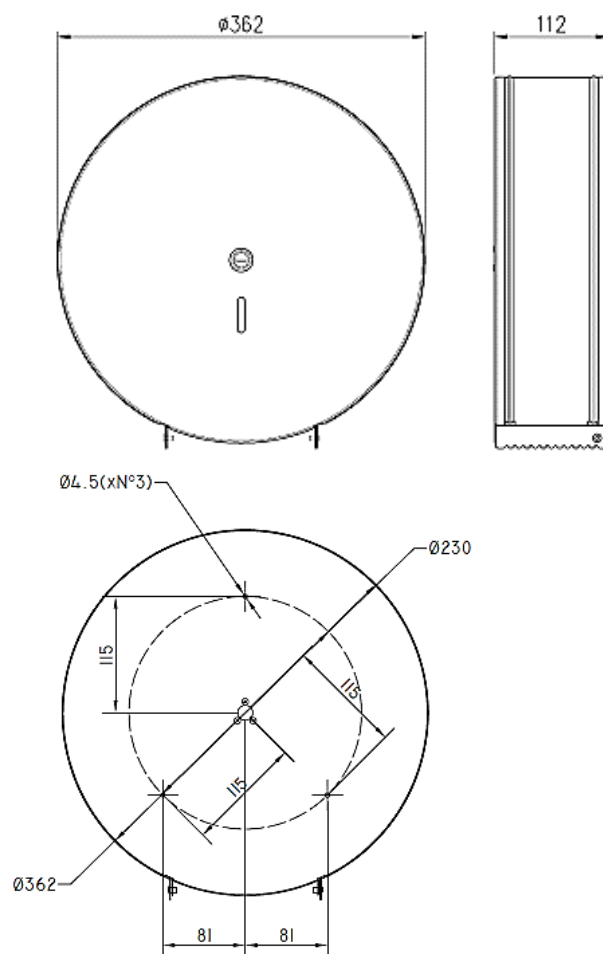

ASSORTMENT

BLU7402C-S4	INOX AISI 430 POLISHED	BLU7402S-S4	INOX AISI430 SATIN
-------------	------------------------	-------------	--------------------

SPECIFICATION ITEM

Wall-mounted large roll toilet paper dispenser made of AISI 430 stainless steel, in polished or satin finish; equipped with security locking system with key and end-of-stock control window. Suitable for holding standard roll formats with a maximum external diameter of 36 cm. Structure with reinforcement ribs for increased vandal resistance. Recommended for washrooms in hotels, restaurants, shopping centres, airports, hospitals, kindergartens and other public places.

TECHNICAL SPECIFICATIONS

lid activation	manual extraction
composition	AISI 430 stainless steel
finish	polished or satin
lock	locking system with key
size $\varnothing \times D$	362 x 112 mm
max diameter paper roll	\varnothing 360 mm
weight	2.8 kg

BLU7402

JUMBO MAXI TOILET PAPER DISPENSER

INSTALLATION

The dispenser can be fixed to the wall, subject to verification of the load-bearing capacity of the wall.

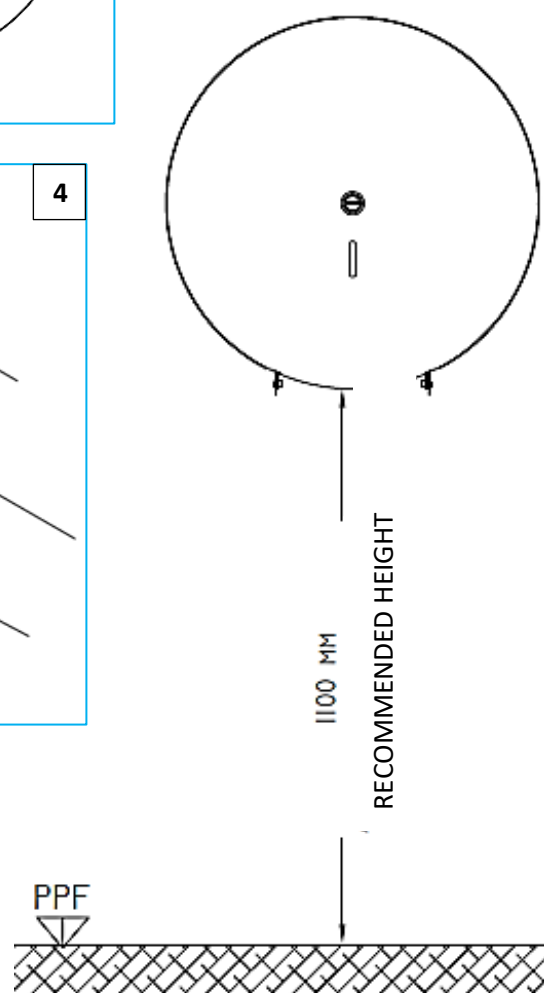
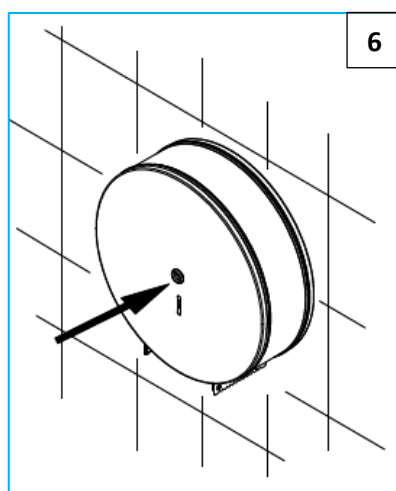
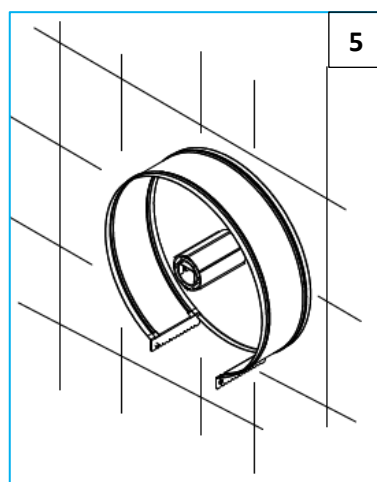
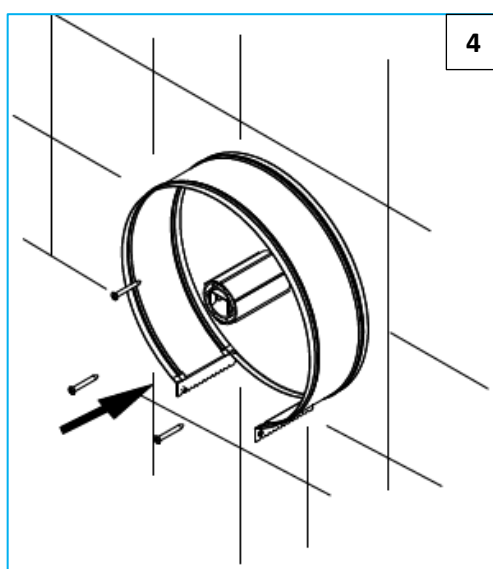
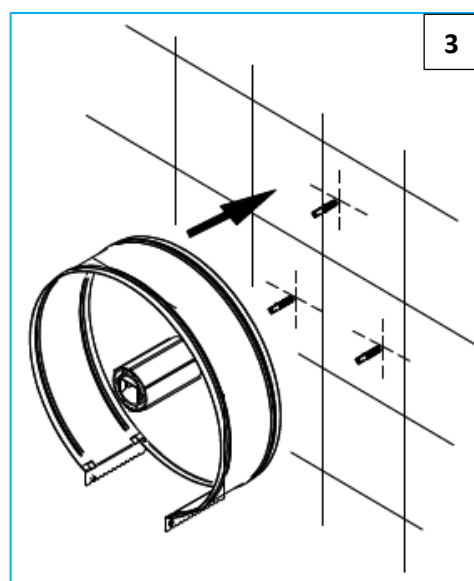
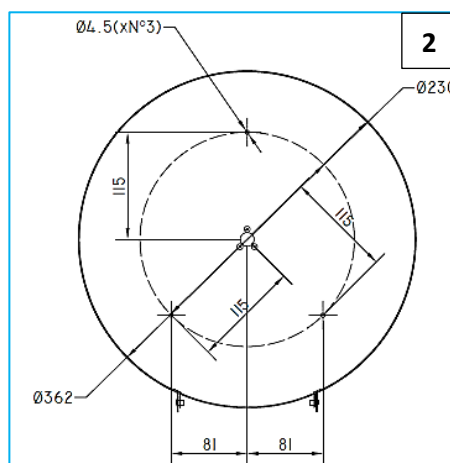
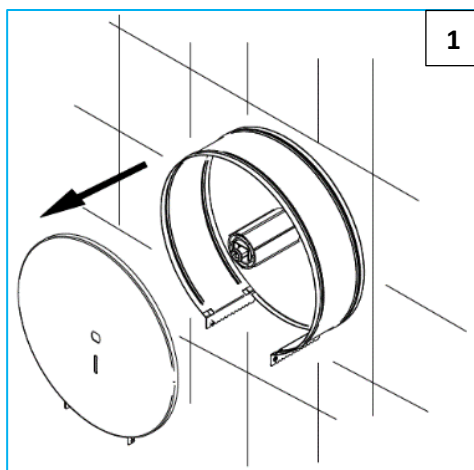

CLEANING AND MAINTENANCE

Clean metal surfaces with a soft cloth (microfiber, no abrasive products) and neutral cleaning agents or denatured alcohol. For satin-finished surfaces, clean in the direction of the satin finish.

PRODUCTS TO BE AVOIDED: acid detergents, bleach, Lysol, limescale remover, silver cleaning products, abrasive powders, wire wool, steel wool, abrasive pastes.

SPARE PARTS

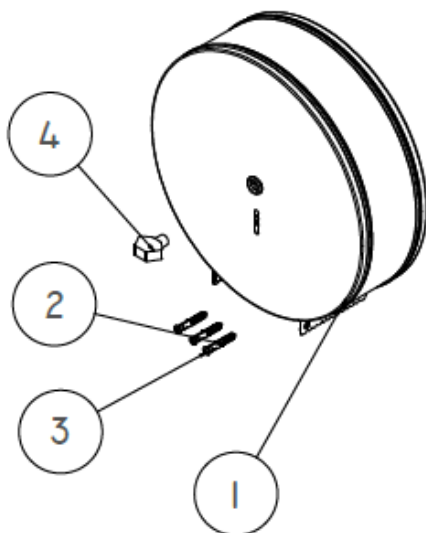

ARTICLE COMPOSITION	
1	PAPER DISPENSER
2	FASTENING PLUGS
3	FASTENING SCREWS
4	KEY LOCK

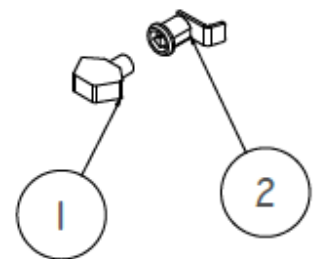

COD SPARE PARTS	DESCRIPTION
1-2 BLUSERRA7520_SW	COMPLETE LOCK + TRIANGLE KEY FOR C7520.S

PACKAGING AND EQUIPMENT

N°1	Main unit (WASTE BIN)
N°3	Plastic plugs for wall mounting
N°3	Steel screws for wall mounting
N°2	Keys for lock
N°1	Cardboard box
N°1	Instruction manual



The most correct way to dispose of the product is to throw it in the metal bin or take it to authorised recycling centres.