

BLU7201 triplex

TRIPLE INTERLEAVED TOILET PAPER DISPENSER

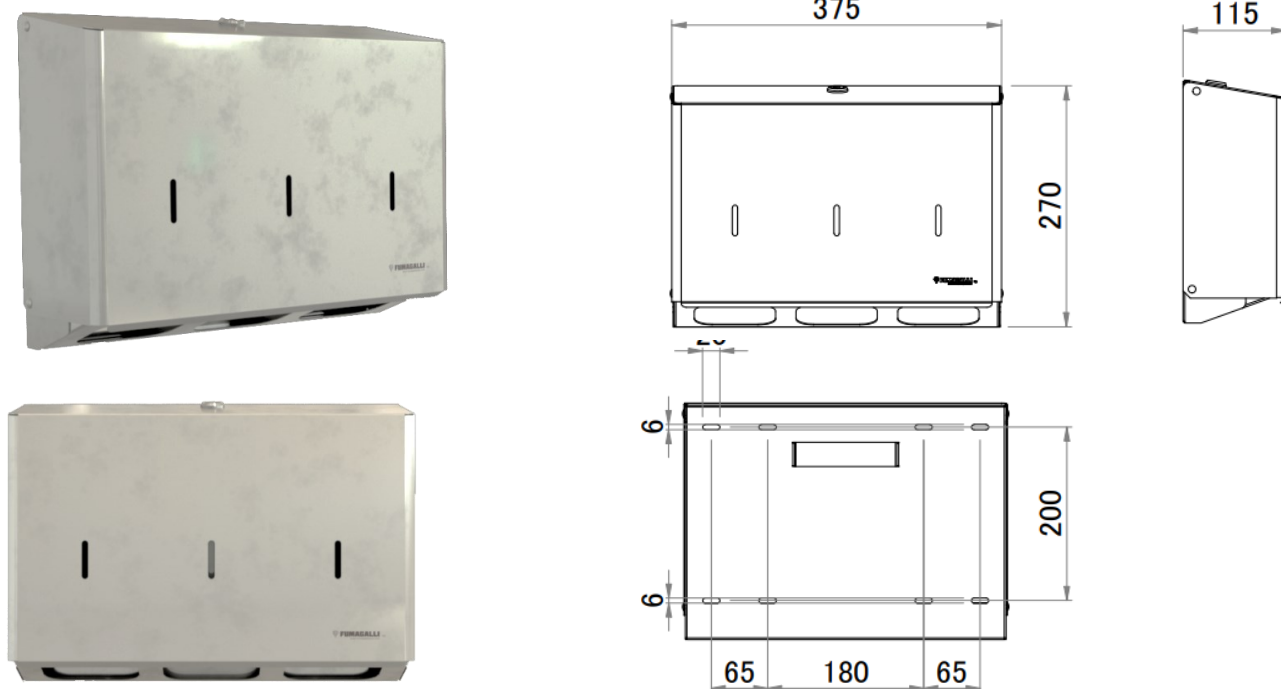

SPECIFICATION ITEM

Triple wall-mounted interleaved toilet paper dispenser, equipped with single-sheet dispensing system with anti-cut edges. Made of AISI 304 stainless steel in polished or satin finish. Operation: manual extraction. General locking with single key lock.

ASSORTMENT

BLU7201TRIPLEX.C	INOX AISI 304 POLISHED	BLU7201TRIPLEX.S	INOX AISI 304 SATIN
------------------	------------------------	------------------	---------------------

TECHNICAL SPECIFICATIONS

activation	manual
composition	AISI 304 stainless steel bottom thickness 1 mm – AISI 304 stainless steel cover thickness 1 mm
height	270 mm
width	375 mm
depth	115 mm
capacity	6 standard packs of sheets (2 packs per compartment)
weight	4.5 Kg

INSTALLATION:

Wall mounting by means of the provided kit.

CLEANING:

Clean metal surfaces with a soft cloth (microfiber, no abrasive products) and neutral cleaning agents or denatured alcohol. For satin-finished surfaces, clean in the direction of the satin finish.

PACKAGING:

Single cardboard box packaging. The box includes:

N° 1 dispenser

N° 8 plastic plugs for wall mounting

N° 8 steel screws for wall mounting

N° 1 key for lock

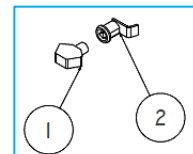

COD SPARE PARTS	DESCRIPTION
1-2 BLUSERRA7520_SW	COMPLETE LOCK + TRAINGLE KEY



The most correct way to dispose of the product is to throw it in the metal bin or take it to authorised recycling centres.