

BLU7201

INTERLEAVED TOILET PAPER DISPENSER

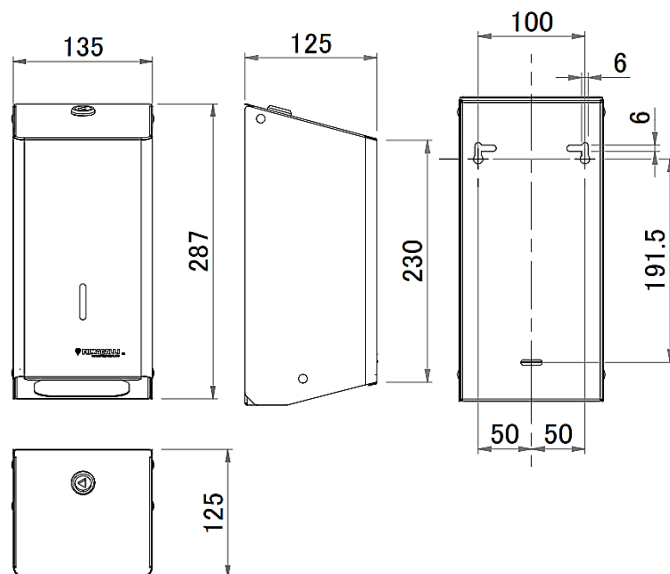

SPECIFICATION ITEM

Wall-mounted interleafed toilet paper dispenser made of AISI 430 stainless steel, in polished or satin finish; equipped with security locking system, end-of-stock control window and opening with plastic gasket with rounded edges to facilitate sheets extraction. Suitable for holding standard sized toilet paper sheets.

ASSORTMENT

BLU7201C-S4	INOX AISI 430 POLISHED	BLU7201S-S4	INOX AISI 430 SATIN
-------------	------------------------	-------------	---------------------

TECHNICAL SPECIFICATIONS

activation	manual
composition	AISI430 stainless steel bottom thickness 1 mm - AISI430 stainless steel cover thickness 1 mm
height	287 mm
width	135 mm
depth	125 mm
capacity	2 standard packs of sheets
weight	1.2 Kg

INSTALLATION:

Wall mounting by means of the provided kit.

CLEANING:

Clean metal surfaces with a soft cloth (microfiber, no abrasive products) and neutral cleaning agents or denatured alcohol. For satin-finished surfaces, clean in the direction of the satin finish.

PACKAGING:

Single cardboard box packaging. The box includes:

N° 1 dispenser

N° 3 plastic plugs for wall mounting

N° 3 steel screws for wall mounting

N° 1 key for lock

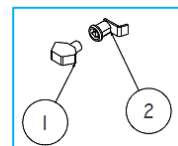

COD SPARE PARTS	DESCRIPTION
1-2 BLUSERRA7520_SW	COMPLETE LOCK + TRIANGLE KEY



The most correct way to dispose of the product is to throw it in the metal bin or take it to authorised recycling centres.