

# BLU7101

## FOLDED OR INTERLEAVED PAPER TOWEL DISPENSER

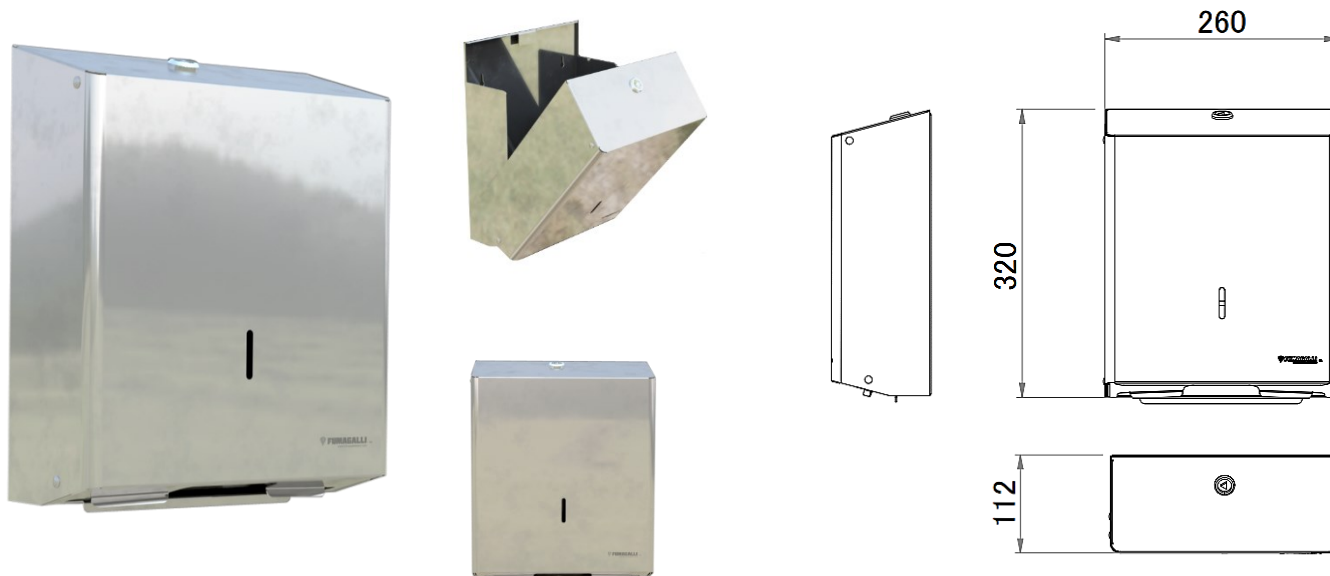

### SPECIFICATION ITEM

Wall-mounted paper towel dispenser with folded or interleaved sheets made of AISI 430 stainless steel, in polished or satin finish; equipped with security locking system, end-of-stock control window and opening with rounded edges to facilitate sheets extraction. Suitable for holding standard sized paper towels.

### ASSORTMENT

BLU7101C-S4	INOX AISI 430 POLISHED	BLU7101S-S4	INOX AISI 430 SATIN
-------------	------------------------	-------------	---------------------

### TECHNICAL SPECIFICATIONS

activation	manual
composition	AISI 430 stainless steel bottom thickness 0.8 mm – AISI 430 stainless steel cover thickness 0.8 mm
height	320 mm
width	260 mm
depth	112 mm
weight	1.2 Kg

### INSTALLATION:

Wall mounting by means of the provided kit.

### CLEANING:

Clean metal surfaces with a soft cloth (microfiber, no abrasive products) and neutral cleaning agents or denatured alcohol. For satin-finished surfaces, clean in the direction of the satin finish.

### PACKAGING:

Single cardboard box packaging. The box includes:

N° 1 dispenser

N° 3 plastic plugs for wall mounting

N° 3 steel screws for wall mounting

N° 1 key for lock

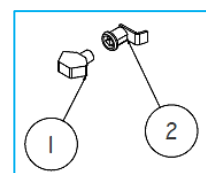

COD SPARE PARTS	DESCRIPTION
1-2 BLUSERRA7520_SW	COMPLETE LOCK + TRIANGLE KEY



The most correct way to dispose of the product is to throw it in the metal bin or take it to authorised recycling centres.