

BLU7011D7201

DOUBLE DISPENSER OF INTERLEAVED AND HYGIENIC TOILET PAPER

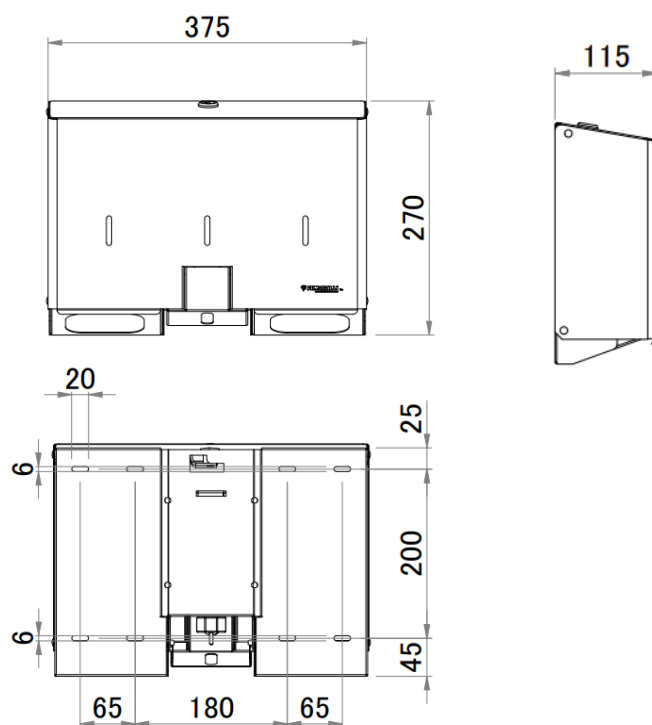
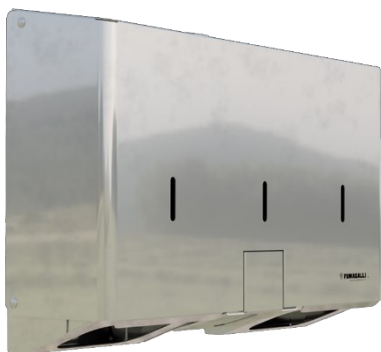

SPECIFICATION ITEM

Combined sanitising toilet seat dispenser and double interleaved toilet paper dispenser. Sanitising pump with compression system, liquid control light. Sanitising operation: manual button. Refill: topping up. Toilet paper operation: manual extraction. General locking with single key lock.

ASSORTMENT

BLU7011D7201.C	INOX AISI 304 POLISHED	BLU7011D7201.S	INOX AISI 304 SATIN
----------------	------------------------	----------------	---------------------

TECHNICAL SPECIFICATIONS

activation	manual
composition	AISI 304 stainless steel bottom thickness 1 mm – AISI 304 stainless steel cover thickness 1 mm
height	270 mm
width	375 mm
depth	115 mm
capacity	4 standard packs of sheets (2 packs per compartment)
weight	4.5 Kg
sanitising dispenser capacity	1 litre

INSTALLATION:

Wall mounting by means of the provided kit.

CLEANING:

Clean metal surfaces with a soft cloth (microfiber, no abrasive products) and neutral cleaning agents or denatured alcohol. For satin-finished surfaces, clean in the direction of the satin finish.

PACKAGING:

Single cardboard box packaging. The box includes:

N° 1 dispenser

N° 8 plastic plugs for wall mounting

N° 8 steel screws for wall mounting

N° 1 key for lock

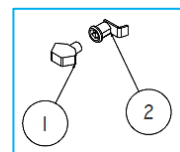

COD SPARE PARTS	DESCRIPTION
1-2 BLUSERRA7520_SW	COMPLETE LOCK + TRAINGLE KEY



The most correct way to dispose of the product is to throw it in the metal bin or take it to authorised recycling centres.