

DC1G05MWBA01

DC centrifugal fans

> CONTACT US



Blowers provide forced-air cooling solution to temperature-sensitive applications. Blowers with brushless DC motor produce concentrated airflow and are suitable to work with high impedance systems. Available in different sizes, air volumes and pressure.

Technical data		
APPROVALS		
Approvals	CE; cURus	
PERFORMANCE		
Max Airflow	48	m³/h
	28	CFM
Max Static Pressure	220	Pa
	0.88	in H2O
RPM	2300	RPM
ELECTRICAL DATA		
Rated Voltage	24	V d.c.
Rated Current	0.39	A
Rated Power	9.4	W
Operating Voltage	21.6-26.4	V d.c.
Starting Voltage	17	V d.c.
Insulation Class	A	
Motor Protection	Electronically Protected	
MECHANICAL DATA		
Diameter	120	mm
	4.72	in
Bearing	Ball Bearing	
GENERIC DATA		
Casing Material	Plastic UL94-V0	

Image is for illustrative purpose only. All specifications, data and drawing are subject to change without notice. Please refer to our terms of sales including our warranty and limited liabilities clauses.

DC1G05MWBA01

DC centrifugal fans

> CONTACT US

VENTILATION SYSTEMS

Technical data		
Electrical Connection	Wires	
Life Expectancy	70000	h at 40 °C
	70000	h at 104 °F
Fan Noise	49	dB(A)
Cable Length	285	mm
	11.22	in
Fixing System	Screws	
ENVIRONMENTAL AND THERMAL DATA		
IP Protection Degree	IP20	
Operating Temperature	-10÷70	°C
	14÷158	°F
Storage Temperature	-40÷70	°C
	-40÷158	°F
UL DATA		
UL File Number Recognized Component	E223195	

Image is for illustrative purpose only. All specifications, data and drawing are subject to change without notice. Please refer to our terms of sales including our warranty and limited liabilities clauses.

DC1G05MWBA01

DC centrifugal fans

> CONTACT US

VENTILATION SYSTEMS

Technical drawing mm (in)

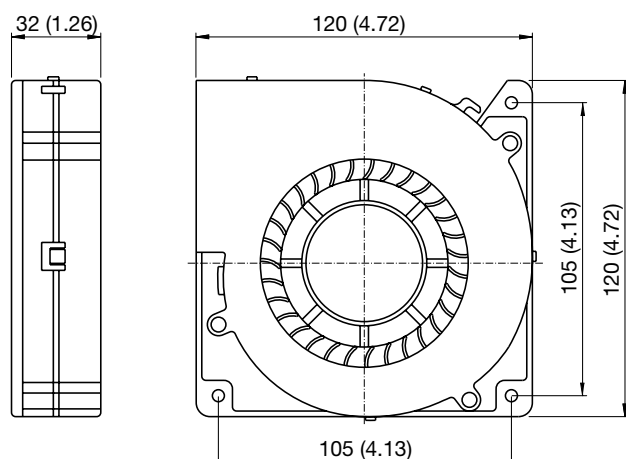

Air Performance

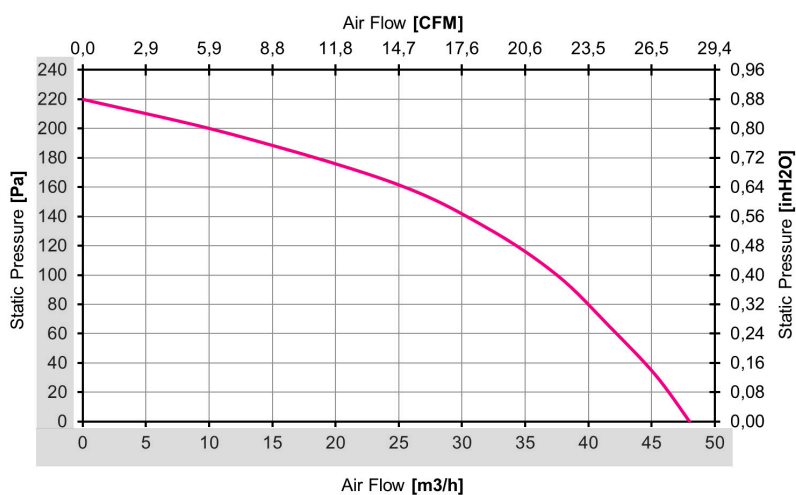

Image is for illustrative purpose only. All specifications, data and drawing are subject to change without notice. Please refer to our terms of sales including our warranty and limited liabilities clauses.