

GG BS88 Centre bolted tags fuse links



Product description

Eaton's Bussmann® series GG British Standard fuse links are specifically designed for the protection of general industrial applications e.g. power distribution and cable protection.

Standard features

- Good peak let-through current limitation
- 1:1:6 Selective coordination ratio between "minor" and "major" fuse
- Power loss values well within the limits of IEC 60269-2

Catalogue symbol:

- GG(Amps)

Technical data:

- Rated voltage: 550 V a.c. / 250 V d.c.
- Rated current: 710 to 1250 A
- Breaking capacity: 80 kA a.c. / 40 kA d.c.
- Breaking range and utilisation category: gG

Standards/Approvals:

- BS88-1
- IEC 60269-1
- Suitable for use in RoHS compliant applications

Packaging:

- MOQ 1

Table 1. Technical data

Part number	Rated voltage	Rated current (Amps)	Energy integrals I²t (A²S)		Watts loss W	Dimensions (mm)										Product class	Weight
			Pre-arcing	Total at 415 V a.c.		A	B	C	D	E	F	G	H	J			
GG710	550 V a.c. 250 V d.c.	710	3500	8100	53	262	231	77.5	10.5	15.5	38	165	83	6.4	gG	2.7Kg	
GG800	550 V a.c. 250 V d.c.	800	5000	11,500	64	262	231	77.5	10.5	15.5	38	165	83	6.4	gG	2.7Kg	
GG1000	550 V a.c.	1000	6800	16,000	69	262	228.5	84	10.5	15.5	38	165	100	12.7	gG	2.8Kg	
GG1250	550 V a.c.	1250	14,000	30,000	85	262	228.5	84	10.5	15.5	38	165	100	12.7	gG	2.8Kg	

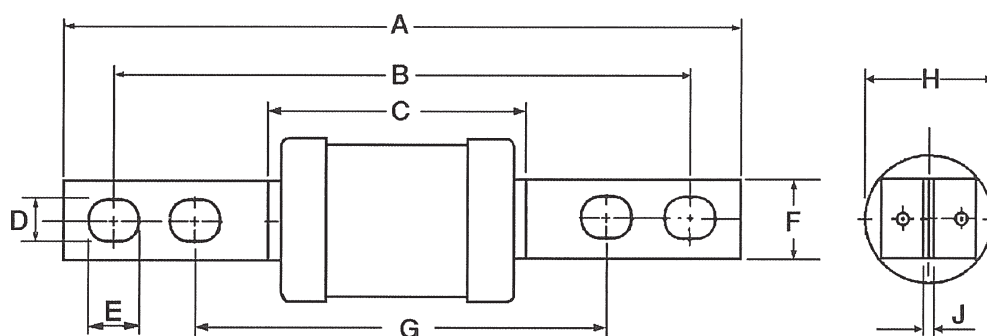
Outline drawing

Time-current curve

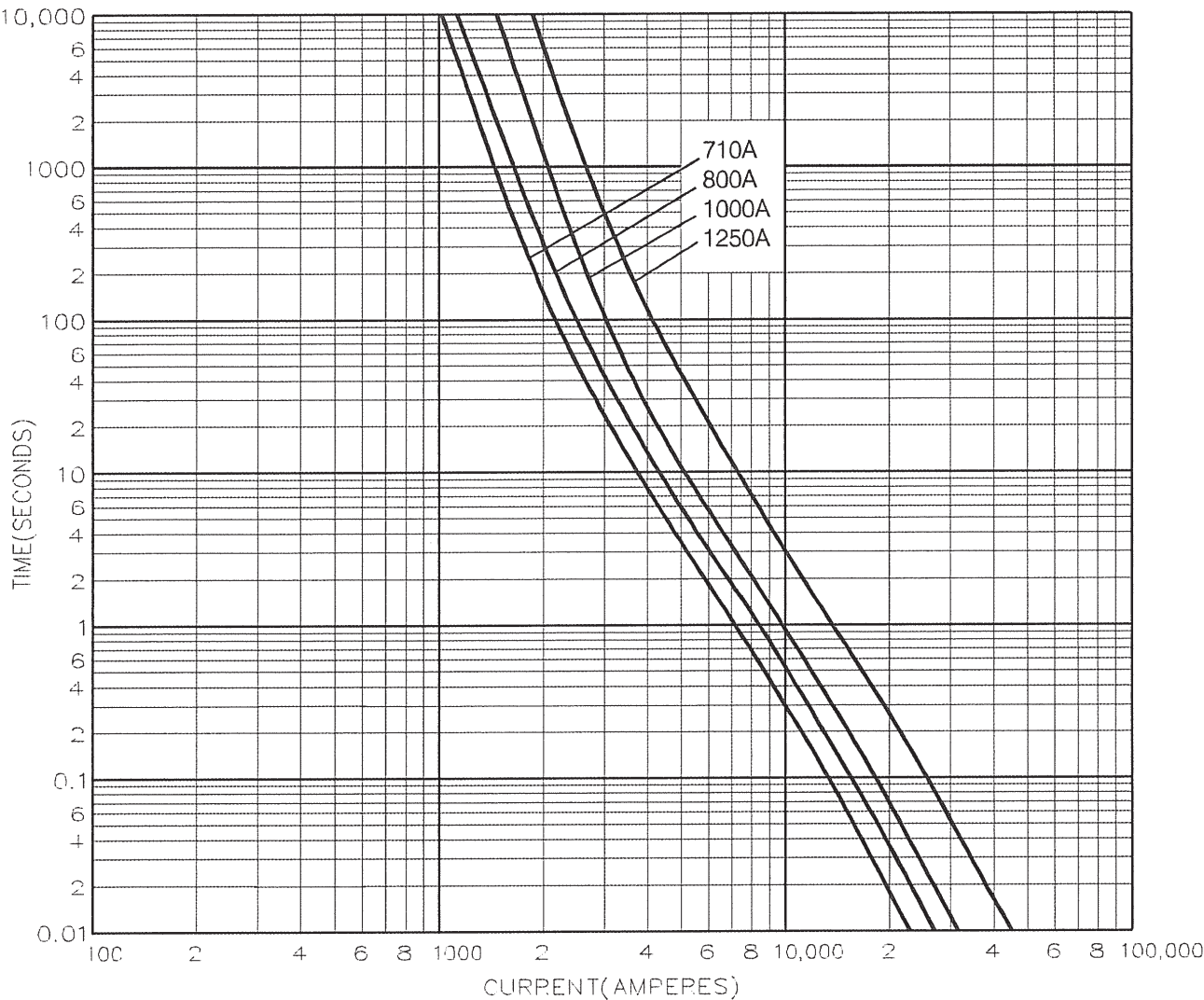

Changes to the products, to the information contained in this document, and to prices are reserved; so are errors and omissions. Only order confirmations and technical documentation by Eaton is binding. Photos and pictures also do not warrant a specific layout or functionality. Their use in whatever form is subject to prior approval by Eaton. The same applies to Trademarks (especially Eaton, Moeller, and Cutler-Hammer). The Terms and Conditions of Eaton apply, as referenced on Eaton Internet pages and Eaton order confirmations.

Eaton
EMEA Headquarters
Route de la Longeraie 7
1110 Morges, Switzerland

Eaton Electrical Products Limited
Melton Road
Burton-on-the-Wolds
Leicestershire, LE12 5TH
United Kingdom

© 2017 Eaton
All Rights Reserved
PDF Only
Publication No. 4104
October 2017