

MatixGo

150700W - 150710W - 150725 - 150726

Turrets

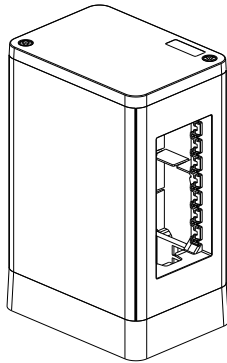

150700W

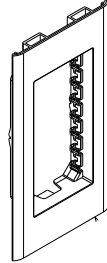

150710W

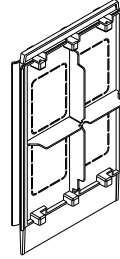

150725

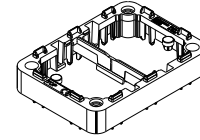

150726

Use

Turret 4 modules for surface mounting installation.
Can be extended to 8,16 or more modules thanks to the accessories (additional support and joining kits).
Compatible with Matix GO wiring devices.

Range

Designation	Item
Turret - white case	<input type="checkbox"/> 150700W

Color code:

White (RAL 9003) and grey.

Overall dimensions (mm)

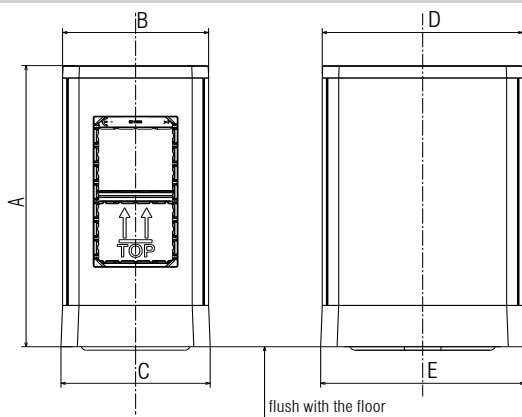

	A	B	C	D	E
150700W	170	80	82	110	112

Accessory

Supporting frame 4m	<input type="checkbox"/> 150710W
---------------------	----------------------------------

Accessory

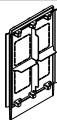
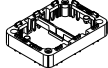
Horizontal junction		<input type="checkbox"/> 150725
Vertical junction		<input type="checkbox"/> 150726

Color code:

White (RAL 9003) Grey

Technical characteristics

- Protection index

(considering a complete installation)
Penetration by solid bodies/liquid: IP40

- Mechanical characteristics

Impact test: IK 08

- Material characteristics

Materials:

- White covers: ABS
- Internal structure: PA6 with fiber glass
- Grey covers: PC (polycarbonate)
- Yellow separator: PP (polypropylene)

UV resistant. Halogen free.

Self-extinguishing:

650° C / 30 s for parts made of insulating materials

- Climatic characteristics

Storage temperature: - 10° C to + 70° C

Use temperature: - 5° C to + 35° C

Cleaning

Clean the surface with a cloth.

Do not use acetone, tar-removing cleaning agents or trichloroethylene.

Caution: Always test before using special cleaning products.

Standards and approvals

Compliance with standards CEI EN 50085-2-4

Refer to e.catalogue.