

MatixGO

Cat. 6 RJ45 sockets

Cat. Nos: JW4279C6 - JG4279C6 - JB4279C6
JW4279C6S - JG4279C6S - JB4279C6S - JW4279C6SAB - JW4279C6AB

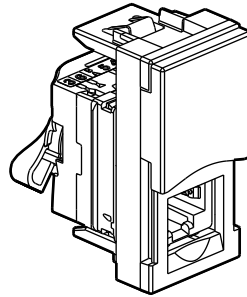

1. USE

Category 6 RJ 45 socket for high speed transmission (Gigabit Ethernet). The mechanism can be flush-mounted or surface-mounted in 40 mm depth box min. To be equipped with frame and plates. Fixing with clips.

Sockets JW4279C6SAB - JW4279C6AB: This product is made of silver-ion based antibacterial* material. This technology eliminates bacteria, fungi and viruses without creating any immunisation or resistance effects (physical, rather than chemical, destruction). Particularly suitable for healthcare establishments (hospitals, clinics, nursing homes, laboratories, waiting rooms, etc.) and more generally for areas subject to hygiene restrictions (industrial, shared and restaurant kitchens, waste, etc.).

This product offers an additional way of ensuring the non-proliferation of bacteria, fungi and viruses without interfering with cleaning protocols.

2. RANGE

Category	Cat. Nos.	Color
6 STP	JW4279C6S JG4279C6S JB4279C6S	<input type="checkbox"/> White <input checked="" type="checkbox"/> Grey <input checked="" type="checkbox"/> Black
6 STP antibacterial*	JW4279C6SAB*	<input type="checkbox"/> White
6 UTP	JW4279C6 JG4279C6 JB4279C6	<input type="checkbox"/> White <input checked="" type="checkbox"/> Grey <input checked="" type="checkbox"/> Black
6 UTP antibacterial*	JW4279C6AB*	<input type="checkbox"/> White

3. OVERALL DIMENSIONS (mm)

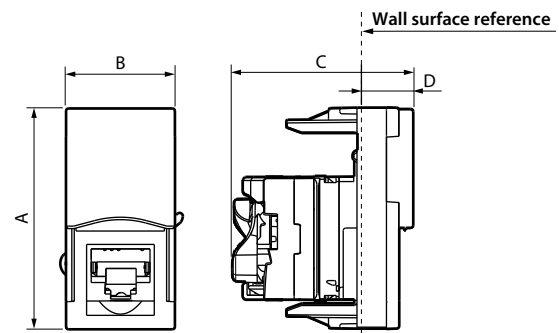

A	B	C	D
45	22.5	37	10.5

4. CONNECTION

Accepts the following cable connectors:
RJ 11 (4 contacts), RJ 12 (6 contacts), RJ 45 (9 contacts).
Double colour T568A and T568B on terminals:
UTP 8 contacts
FTP 9 contacts
STP 9 contacts 360° screen

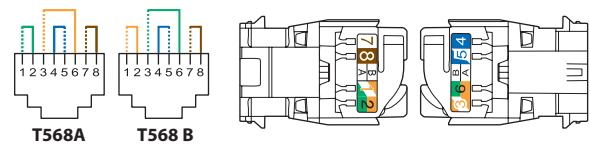

Conductors supported:
Solid/stranded: 0.4 to 0.65 mm, AWG 22 to 26.
Polyethylene conductor insulation: max. Ø 0.85 to 1.7 mm on insulation.

4. CONNECTION (continued)

RJ 45 connectors are equipped with a locking nut that does not require the use of a specific tool and which enables re-wiring in the event of error.

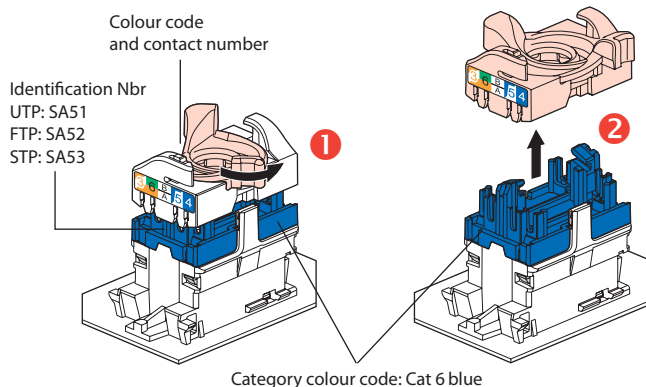

This system allows you to spread pairs before fitting them onto the connector.

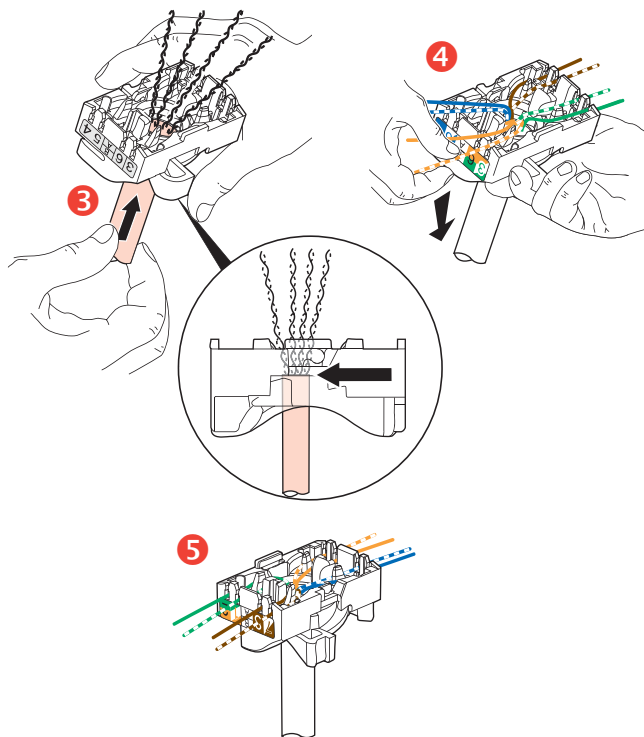

Spreading the cables ensures that a pair-breakage distance of 13 mm is kept between each pair.
Spreading pairs at 90° to the cable ensures the best possible performance.

5. TECHNICAL CHARACTERISTICS

■ 5.1 Mechanical characteristics

Impact resistance: IK 04
Penetration against solid bodies and liquids: IP 20
Max. number of connections and disconnections: 5 without refreshing the wiring.
Endurance: 2500 movements (plug insertion/withdrawal).

■ 5.2 Material characteristics

Contacts: gold/nickel, thickness of gold > 0.8 µm minimum
Metal parts: bronze, nickel, platinum, gold
For the STP products the body and the spreader are made of metal alloy with copper/nickel coating.

Polycarbonate PBT

Cover plates:

ABS

ABS + antibacterial* treatment for Cat. Nos JW4279C6SAB and JW4279C6SAB

Halogen-free

UV-resistant

Self-extinguishing:

850°C/30 s for insulating components holding live parts in place
650°C/30 s for other insulating components

■ 5.3 Electrical characteristics

Breakdown voltage ≥ 1000 V

Contact resistance ≤ 20 MΩ

Insulation resistance ≥ 500 MΩ at 100 VDC

Tested and independently certified to comply with IEC 60512-99-001 and IEC 60512-99-002 for PoE support up to 90 W (Type 4).

■ 5.4 Climate characteristics

Storage temperature: -10°C to +70°C

Usage temperature: -5°C to +35°C

6. MAINTENANCE

Surface cleaning with a cloth.

Do not use: acetone, tar remover, trichloroethylene.

Resistance to cleaning products: Hexane, methylated spirit, soapy water, diluted ammonia, pure bleach diluted to 10%, window-cleaning products, pre-impregnated wipes.

Resistance to hospital grade cleaning products: Anios, Surfanios, Bactilycine, diluted hydrogen peroxide (35%).

Caution: Always test before using other special cleaning products

7. STANDARDS AND APPROVALS

Connectors are compliant to requirements for the following remote powering applications IEEE 802.3af, IEEE 802.3at, IEEE 802.3bt: "Power over Ethernet", Types 1 to 4, up to 90 W.

Compliant with installation and manufacturing standards.
See e-catalogue.

* Contains a silver compound to antagonize the growth of bacteria on the surface.

8. PERFORMANCE

■ **8.1 Component performance (RJ 45 connectors)**

Return loss

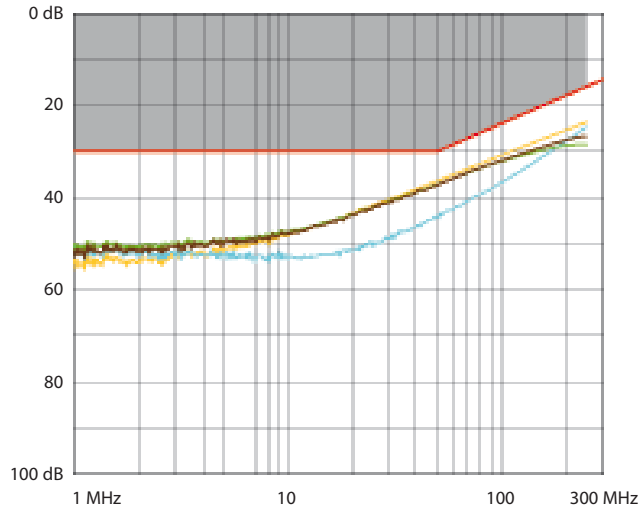

Attenuation

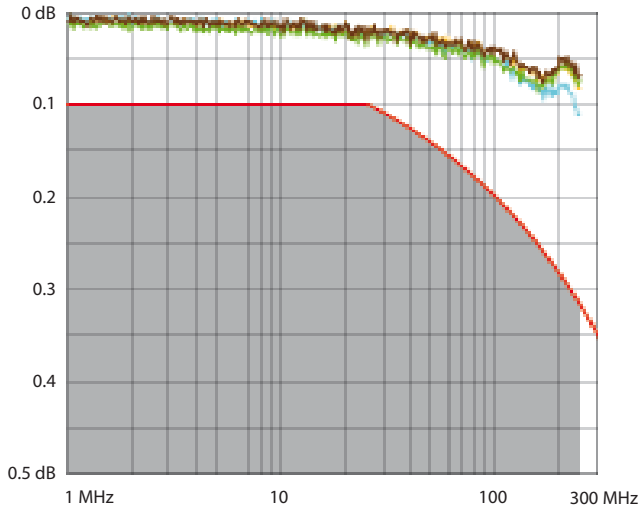

NEXT (Near end Crosstalk Attenuation)

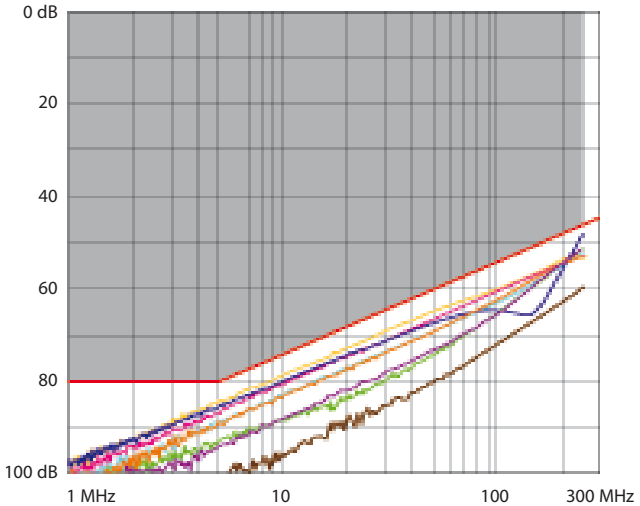

8. PERFORMANCE (Cont.)

■ **8.1 Component performance (RJ 45 connectors) (cont.)**

FEXT (Far end Crosstalk Attenuation)

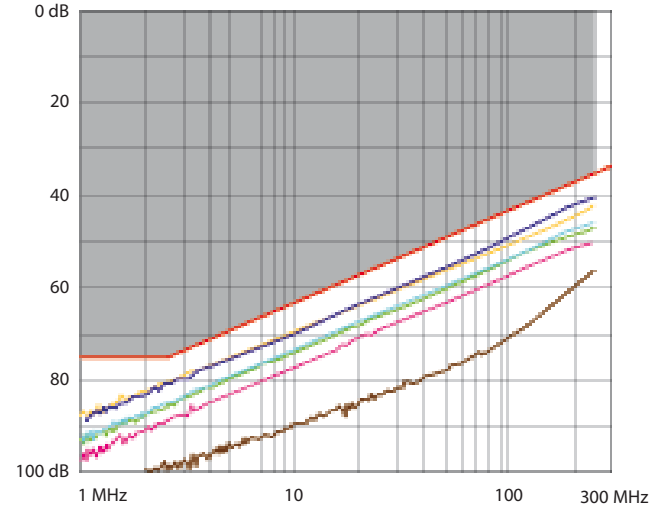

■ **8.2 Performance of permanent link with F/UTP cable**

Return loss

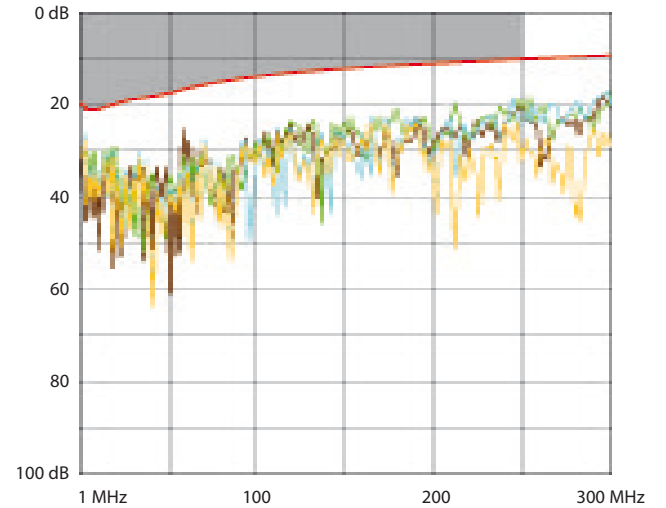

Attenuation

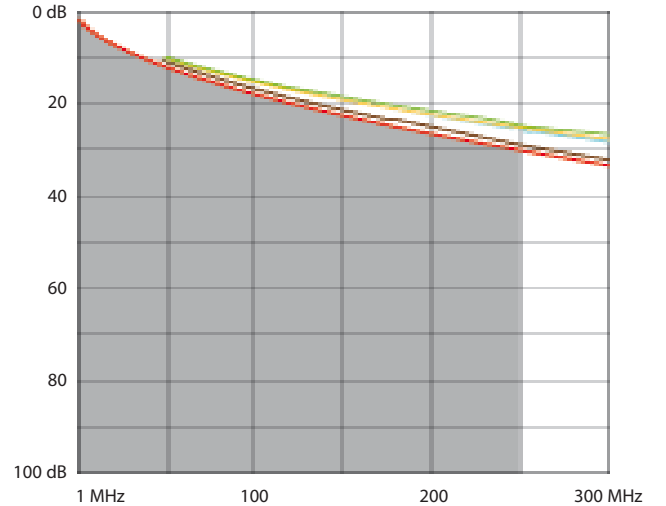

8. PERFORMANCE (Cont.)

■ **8.2 Performance of permanent link with F/UTP cable (Cont.)**
 NEXT (Near end Crosstalk Attenuation)

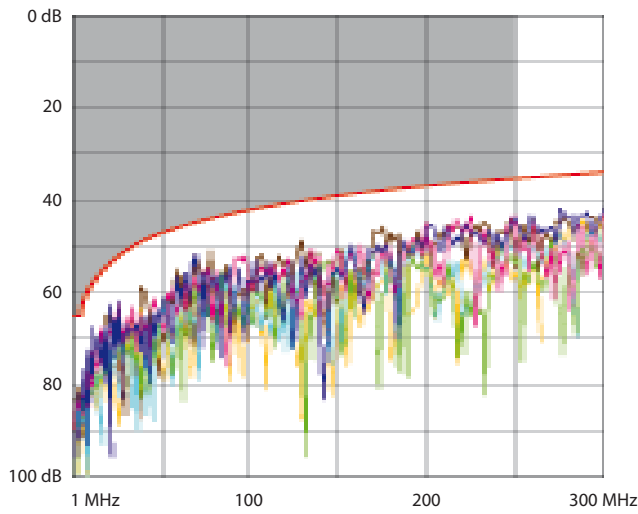

8. PERFORMANCE (Cont.)

■ **8.2 Performance of permanent link with F/UTP cable (Cont.)**
 ELFEXT (Equal Level End Crosstalk Attenuation)

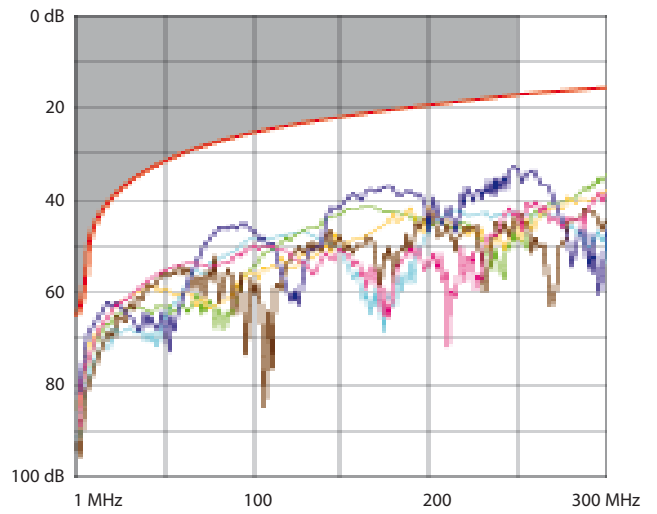

PS NEXT (Power Sum NEXT)

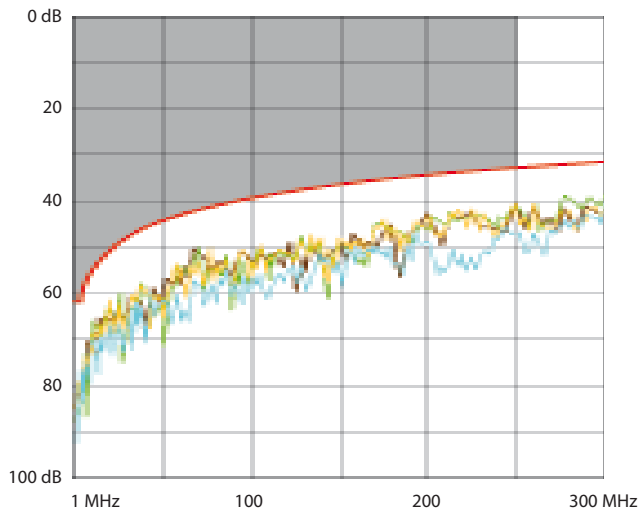

Delay skew

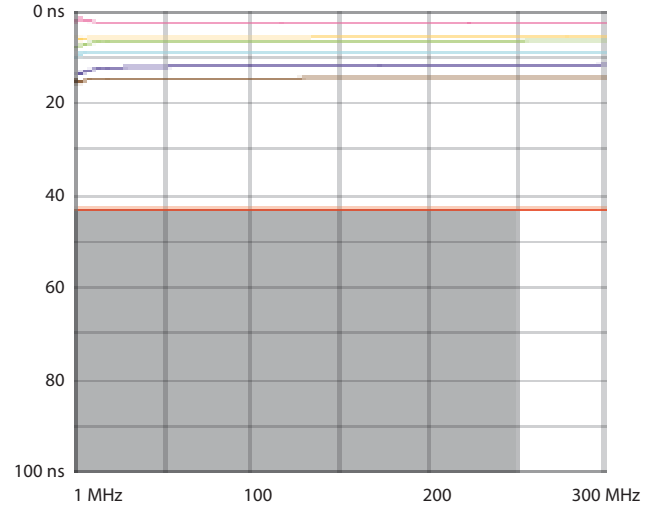

ACR (Attenuation to Crosstalk Ratio)

