

DC Disconnect Switch
DX Series



Bremas Ersce S.p.A.
Via Castellazzo 9 – 20040 Cambiago (MI)
Tel +39 02 95651611 Fax +39 02 95651639
www.bremas.it info@bremas.it
ISO 9001 Certified Quality System

DX150301EPADRLE



Technical data according to IEC 60947-3:2015/A2 AnnexD				
Utilization category			PV1 (DC21B)	PV2
Rated operational voltage	Ue	V dc	1500	1500
Rated operational current	Ie	A dc	30	12
Rated operational voltage (second rating)	Ue	V dc	1000	1500
Rated operational current (second rating)	Ie	A dc	60	25
Rated operational voltage (third rating)	Ue	V dc	-	-
Rated operational current (third rating)	Ie	A dc	-	-
Rated operational voltage (fourth rating)	Ue	V dc	-	-
Rated operational current (fourth rating)	Ie	A dc	-	-
Rated operational voltage (fifth rating)	Ue	V dc	-	-
Rated operational current (fifth rating)	Ie	A dc	-	-
Rated operational voltage (sixth rating)	Ue	V dc	-	-
Rated operational current (sixth rating)	Ie	A dc	-	-
Rated thermal current	Ith	A	60	
DC Poles		Nr.	2	
Rated conditional short-circuit current		kA	5	
Rated insulation voltage	Ui	V dc	1500	
Rated impulse withstand voltage	Uimp	kV	8	
Rated short-time withstand current (1s)	Icw	A	780	
Rated short-circuit making capacity	Icm	kA	1,4	
Power loss per layer at 20A/50A		W	0,2/1,25	
Max fuse size for short-circuit protection	gPV	A	63	
Mechanical characteristics				
Type of mounting			Base mounting. Back-side for DIN rail or 2 screws fixing, for standard distribution boards (45 mm window). With pre-mounted knob	
Layers		Nr.	3	
Screwdriver orientation for terminals			Head up	
External metal parts (screws, shaft)			Stainless steel	
Cross-section of flexible/solid wires	Max	mm ² AWG	2x 6 2x 10	
Cross-section of wires with fork lug	Max	mm ² AWG	1x 16 1x 6	
Screws thread dimensions			M4	
Terminal screws tightening torque		Nm	1,7 ±10%	
Actuator operation force		Nm	1,5	
Net weight		g	149	
Protection degree IEC 529 EN 60529				
To the terminal			IP20	
With product mounted on panel			----	
Ambient conditions				
Pollution degree ins.			2	
Operational ambient temperature		°C	-40 ÷ +70	
Storage ambient temperature		°C	-40 ÷ +85	
Damp heat test IEC60068-2-30			90-100% RH at +55 °C	



Screwdriver orientation
for terminals

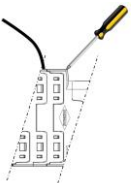

Knob

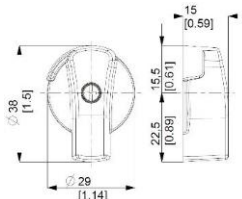

Positions

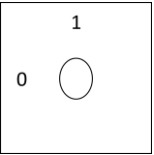

Electrical Diagram

Layer	1	2	3	4	5	6	7	8	9	10	11	12	13	14	15	16
Marking	-1	+1														
			E M P T Y													
Marking	-1	+1														
0/OFF																
I/ON	X	X														

Dimensions

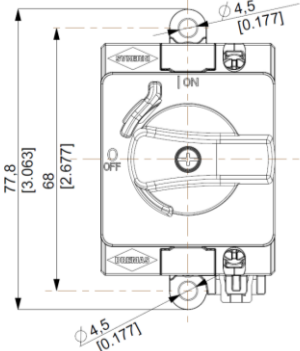
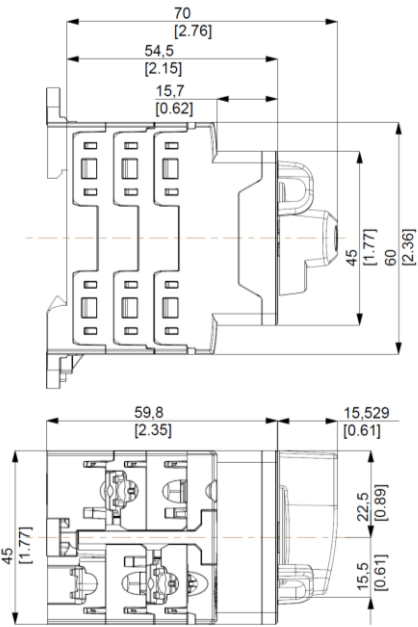

Drilling Templates

