

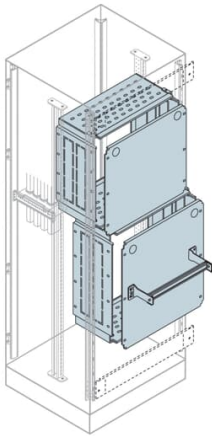

PRODUCT-DETAILS

IS2-EH5080

IS2-EH5080 Control and Automation Board



General Information	
Extended Product Type	IS2-EH5080
Product ID	EH5080
EAN	8015646679734
Catalog Description	IS2-EH5080 Control and Automation Board
Long Description	Compartment cubicle 500x800mm (HxW)

Technical	
Standards	See code for structure
Suitable For	IS2 Enclosures for Automation
Suitable for Product Class	Control and Automation Board
Accessory Type	11. Configuration with compartments
Mounting Type	Kit Pre assembled
Product Type	5B5B30B370
Door Type	Single
Surface Finishing	Orange Peel, RAL 7035
Door Surface Finishing	Opaque
Material	Pickled steel sheet

Options Provided	Compartment cubicle
Remarks	ETIM
RAL Number	RAL 7035 - Light Grey

Material Compliance

RoHS Information	1STC860065
RoHS Date	20140108

Environmental

Environmental Information	1STC804013D0209
---------------------------	-----------------

Dimensions

Product Net Width	698 mm
Product Net Height	453 mm
Product Net Depth / Length	229.4 mm
Product Net Weight	32.10 kg
Reference Depth/Length	300 mm
	400 mm
	500 mm
	600 mm
	800 mm
	1000 mm
Reference Height	1400 mm
	1600 mm
	1800 mm
	2000 mm
	2200 mm
Reference Width	800 mm

Ordering

Package Level 1 Units	1 piece
Package Level 1 Gross Weight	32.750 kg

Certificates and Declarations

Declaration of Conformity - CE	1STC860113
--------------------------------	------------

Installation

Instructions and Manuals	1STM604121R0006
--------------------------	-----------------

Popular Downloads

Data Sheet, Technical Information	1STC804013D0209
-----------------------------------	-----------------

Classifications

ETIM 8	EC000747 - Door/operating panel (enclosure/cabinet)
WEEE Category	5. Small Equipment (No External Dimension More Than 50 cm)
WEEE B2C / B2B	Business To Business
CN8	85381000
eClass	V11.1 : 27182204
Object Classification Code	U

Categories

Low Voltage Products and Systems → Enclosures → Automation and Control Enclosures (System pro E control) → Enclosures - Baying (Horizontal Joining) → IS2

