

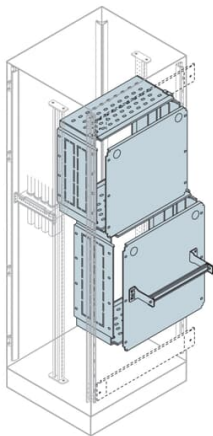

PRODUCT-DETAILS

IS2-EH4063

IS2-EH4063 Control and Automation Board



| General Information | |
|----------------------------|---|
| Extended Product Type | IS2-EH4063 |
| Product ID | EH4063 |
| EAN | 8015646699848 |
| Catalog Description | IS2-EH4063 Control and Automation Board |
| Long Description | Compartment cubicle 400x600mm (HxW) |
| Technical | |
| Standards | See code for structure |
| Suitable For | IS2 Enclosures for Automation |
| Suitable for Product Class | Control and Automation Board |
| Accessory Type | 11. Configuration with compartments |
| Mounting Type | Kit Pre assembled |
| Product Type | 5B5B30B370 |
| Door Type | Single |
| Surface Finishing | Orange Peel, RAL 7035 |
| Door Surface Finishing | Opaque |
| Material | Pickled steel sheet |

| | |
|------------------|-----------------------|
| Options Provided | Compartment cubicle |
| Remarks | ETIM |
| RAL Number | RAL 7035 - Light Grey |

Material Compliance

| | |
|------------------|------------|
| RoHS Information | 1STC860065 |
| RoHS Date | 20140108 |

Environmental

| | |
|---------------------------|-----------------|
| Environmental Information | 1STC804013D0209 |
|---------------------------|-----------------|

Dimensions

| | |
|----------------------------|-----------|
| Product Net Width | 498 mm |
| Product Net Height | 353 mm |
| Product Net Depth / Length | 229.4 mm |
| Product Net Weight | 19.260 kg |
| Reference Depth/Length | 300 mm |
| | 400 mm |
| | 500 mm |
| | 600 mm |
| | 800 mm |
| | 1000 mm |
| Reference Height | 1400 mm |
| | 1600 mm |
| | 1800 mm |
| | 2000 mm |
| | 2200 mm |
| Reference Width | 600 mm |

Ordering

| | |
|------------------------------|-----------|
| Package Level 1 Units | 1 piece |
| Package Level 1 Gross Weight | 19.650 kg |

Certificates and Declarations

| | |
|--------------------------------|------------|
| Declaration of Conformity - CE | 1STC860113 |
|--------------------------------|------------|

Installation

| | |
|--------------------------|-----------------|
| Instructions and Manuals | 1STM604121R0006 |
|--------------------------|-----------------|

Popular Downloads

| | |
|-----------------------------------|-----------------|
| Data Sheet, Technical Information | 1STC804013D0209 |
|-----------------------------------|-----------------|

Classifications

| | |
|----------------------------|--|
| ETIM 8 | EC000747 - Door/operating panel (enclosure/cabinet) |
| WEEE Category | 5. Small Equipment (No External Dimension More Than 50 cm) |
| WEEE B2C / B2B | Business To Business |
| CN8 | 85381000 |
| eClass | V11.1 : 27182204 |
| Object Classification Code | U |

Categories

Low Voltage Products and Systems → Enclosures → Automation and Control Enclosures (System pro E control) → Enclosures - Baying (Horizontal Joining) → IS2

