

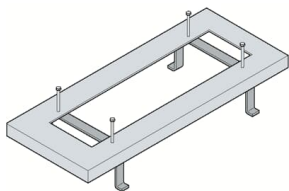

PRODUCT-DETAILS

GMA1SL0436A00**GMA1SL0436A00 IP66 Insulating switchboards accessories****General Information**

Extended Product Type	GMA1SL0436A00
Product ID	1SL0436A00
EAN	8000126266931
Catalog Description	GMA1SL0436A00 IP66 Insulating switchboards accessories
Long Description	GEMINI CONCRETE FLOOR METAL FRAME – SIZE 6

Technical

Suitable For	Gemini - Boxes Gemini - Switchboards
Suitable for Product Class	IP66 Insulating switchboards
Accessory Type	Fixed frame
Enclosure Material	thermoplastic
Material	Steel
RAL Number	RAL 7035 - Light Grey
Color	grey

Material Compliance

RoHS Information	9AKK107046A4790
RoHS Status	Following EU Directive 2011/65/EU and Amendment 2015/863 July 22, 2019
RoHS Date	20221015
Conflict Minerals Reporting Template (CMRT)	9AKK108468A3363

Environmental

Environmental Information	1SLC805001D0907
---------------------------	-----------------

Dimensions

Product Net Width	578 mm
Product Net Height	31 mm
Product Net Depth / Length	696 mm
Product Net Weight	4.58 kg
Size	6

Ordering

Package Level 1 Units	box 1 piece
Package Level 1 Gross Weight	4.58 kg

Certificates and Declarations

Declaration of Conformity - CE	9AKK107046A4790
--------------------------------	-----------------

Installation

Instructions and Manuals	9AKK107992A4361
--------------------------	-----------------

Popular Downloads

Data Sheet, Technical Information	1SLC805001D0907
-----------------------------------	-----------------

Classifications

ETIM 8	EC002625 - Mounting accessories (enclosure/cabinet)
ETIM 9	EC002625 - Mounting accessories (enclosure/cabinet)
WEEE Category	Product Not in WEEE Scope
eClass	V11.0 : 27182807
Object Classification Code	U

Categories

Low Voltage Products and Systems → Enclosures → General Purpose Enclosures → Gemini

